

STATE OF NEW MEXICO
ENERGY AND MINERALS DEPARTMENT

OIL CONSERVATION DIVISION
P. O. BOX 2088
SANTA FE, NEW MEXICO 87501

Form C-103
Revised 10-1-79

NO. OF COPIES RECEIVED	
DISTRIBUTION	
SANTA FE	
FILE	
U.S.G.S.	
LAND OFFICE	
OPERATOR	

API No. 30-025-26857

3a. Indicate Type of Lease	
State <input checked="" type="checkbox"/>	Fee <input type="checkbox"/>
5. State Oil & Gas Lease No.	
B-1389-21	

SUNDRY NOTICES AND REPORTS ON WELLS
(DO NOT USE THIS FORM FOR PROPOSALS TO DRILL OR TO DEEPEN OR PLUG BACK TO A DIFFERENT RESERVOIR.
USE "APPLICATION FOR PERMIT -" (FORM C-101) FOR SUCH PROPOSALS.)

1. OIL WELL <input type="checkbox"/> GAS WELL <input type="checkbox"/> OTHER- Water Injection	7. Unit Agreement Name East Vacuum Gb/SA Unit
2. Name of Operator Phillips Petroleum Company	8. Farm or Lease Name East Vacuum Gb/SA Unit, Tract 1911
3. Address of Operator Room 401, 4001 Penbrook, Odessa, Texas 79762	9. Well No. 002
4. Location of Well UNIT LETTER 0, 50 FEET FROM THE South LINE AND 2470 FEET FROM THE East LINE, SECTION 19 TOWNSHIP 17-S RANGE 35-E NMPM.	10. Field and Pool, or Wildcat Vacuum Gb/SA
15. Elevation (Show whether DF, RT, GR, etc.) 3988' GR	12. County Lea

16. Check Appropriate Box To Indicate Nature of Notice, Report or Other Data	
NOTICE OF INTENTION TO:	SUBSEQUENT REPORT OF:
PERFORM REMEDIAL WORK <input type="checkbox"/>	REMEDIAL WORK <input type="checkbox"/>
TEMPORARILY ABANDON <input type="checkbox"/>	COMMENCE DRILLING OPS. <input type="checkbox"/>
PULL OR ALTER CASING <input type="checkbox"/>	CASING TEST AND CEMENT JOB <input type="checkbox"/>
OTHER <input type="checkbox"/>	OTHER <input type="checkbox"/>
PLUG AND ABANDON <input type="checkbox"/>	ALTERING CASING <input type="checkbox"/>
CHANGE PLANS <input type="checkbox"/>	PLUG AND ABANDONMENT <input type="checkbox"/>
	Water Injection <input checked="" type="checkbox"/>

17. Describe Proposed or Completed Operations (Clearly state all pertinent details, and give pertinent dates, including estimated date of starting any proposed work) SEE RULE 1103.

07-13-80--MI Cactus Drlg. Spudded w/12-1/4" bit to 365'. Ran 8-5/8", 24#, H-40 csg set at 364'. Cmtd w/400 sxs Cl "H" w/2% CaCl₂, 1/4#/sx Flocele. Circ 85 sxs to surface. Left cmt standing under fluid column static pressure. Tested BOP and csg 1400#, OK. Drld ahead w/7-7/8" bit.

07-25-80--Reached 4800' TD. Logged.

07-26-80--Ran 4-1/2" 11.6#, N-80 csg set at 4800'. Cmtd w/900 sxs TLW, 12#/sx salt, 10% DD, 3#/sx Gilsonite, 1/4#/sx Flocele, followed w/350 sxs Cl "H", 5#/sx salt. Circ 180 sxs to surface. WOC 14 hrs. Tested csg and BOP, OK.

07-27-80--Released rig, prep to complete.

18. I hereby certify that the information above is true and complete to the best of my knowledge and belief.

SIGNED W. J. Mueller TITLE Senior Engineering Specialist DATE July 28, 1980

APPROVED BY Jerry Serton
Dist. & Recd.

CONDITIONS OF APPROVAL, IF ANY:

TITLE _____ DATE _____

JUL 31 1980

30-025-26857

NEW MEXICO OIL CONSERVATION COMMISSION

Form C-101
Revised 1-1-65

NO. OF COPIES RECEIVED	
DISTRIBUTION	
SANTA FE	
FILE	
U.S.G.S.	
LAND OFFICE	
OPERATOR	

5A. Indicate Type of Lease	
STATE <input checked="" type="checkbox"/>	FEE <input type="checkbox"/>
5. State Oil & Gas Lease No.	
B-1398-21	

APPLICATION FOR PERMIT TO DRILL, DEEPEN, OR PLUG BACK

1a. Type of Work		7. Unit Agreement Name	
DRILL <input checked="" type="checkbox"/> DEEPEN <input type="checkbox"/> PLUG BACK <input type="checkbox"/>		East Vacuum Gb/SA Unit	
b. Type of Well		8. Farm or Lease Name	
OIL WELL <input type="checkbox"/> GAS WELL <input type="checkbox"/> OTHER <input checked="" type="checkbox"/> Water Injection		East Vacuum Gb/SA Unit, Tract 1911	
c. Name of Operator		9. Well No.	
Phillips Petroleum Company		002	
3. Address of Operator		10. Field and Pool, or Wildcat	
Room 401, 4001 Penbrook, Odessa, Texas 79762		Vacuum Gb/SA	
4. Location of Well		12. County	
UNIT LETTER 0 LOCATED 50 FEET FROM THE South LINE		Lea	
AND 2470 FEET FROM THE East LINE OF SEC. 19 TWP. 17-S RGE. 35-E NMPM			
		19. Proposed Depth	
		4800'	
		19A. Formation	
		Gb/SA	
		20. Rotary or C.T.	
		Rotary	
21. Elevations (Show whether DF, RT, etc.)		22. Approx. Date Work will start	
3988.9' Ground (unprepared)		Upon approval	
21A. Kind & Status Plug. Bond		21B. Drilling Contractor	
Blanket		Advise later	

PROPOSED CASING AND CEMENT PROGRAM

SIZE OF HOLE	SIZE OF CASING	WEIGHT PER FOOT	SETTING DEPTH	SACKS OF CEMENT	EST. TOP
12-1/4"	8-5/8"	24#, H-40	350' (sufficient qty Cl H w/2% CaCl ₂ , 1/4#/sx (Flocele.) Circ to surface.		
7-7/8"	4-1/2"	11.6#, N-80	4800' (sufficient qty TLW w/12#/sx salt, 10% DD (3#/sx Gilsonite, 1/4#/sx Flocele followed (w/Cl H w/5#/sx salt.) Circ to surface.		

APPROVAL VALID
FOR 90 DAYS UNLESS
DRILLING COMMENCED,

Subject to NSL application filed June 3, 1980.

Use mud additives as required for control.

EXPIRES 9-17-80

BOP: Series 900, 300# WP, double w/one set pipe rams and one set blind rams.

IN ABOVE SPACE DESCRIBE PROPOSED PROGRAM; IF PROPOSAL IS TO DEEPEN OR PLUG BACK, GIVE DATA ON PRESENT PRODUCTIVE ZONE AND PROPOSED NEW PRODUCTIVE ZONE, GIVE BLOWOUT PREVENTER PROGRAM, IF ANY.

I hereby certify that the information above is true and complete to the best of my knowledge and belief.

Signed Ralph J. Papp W. J. Mueller Title Senior Engineering Specialist Date June 5, 1980

(This space for State Use)

APPROVED BY [Signature] TITLE SUPERVISOR DISTRICT I DATE JUN 17 1980

CONDITIONS OF APPROVAL, IF ANY:

NEW MEXICO OIL CONSERVATION COMMISSION
WELL LOCATION AND ACREAGE DEDICATION PLAT

Form C-102
Supersedes C-128
Effective 1-1-65

All distances must be from the outer boundaries of the Section

Operator Phillips Petroleum Co.			Lease EVGSAU Tract 1911		Well No. 002
Unit Letter O	Section 19	Township 17 South	Range 35 East	County Lea	
Actual Well Location of Well: 50 feet from the South line and 2470 feet from the East line					
Ground Level Elev. 3988.9	Producing Formation Grayburg/San Andres		Pool Vacuum Grayburg/ San Andres	Dedicated Acreage: None - line injection well	

- (Unprepared)
- Outline the acreage dedicated to the subject well by colored pencil or hachure marks on the plat below.
 - If more than one lease is dedicated to the well, outline each and identify the ownership thereof (both as to working interest and royalty).
 - If more than one lease of different ownership is dedicated to the well, have the interests of all owners been consolidated by communitization, unitization, force-pooling, etc?

☐ Yes ☐ No If answer is "yes," type of consolidation _____

If answer is "no," list the owners and tract descriptions which have actually been consolidated. (Use reverse side of this form if necessary.) _____

No allowable will be assigned to the well until all interests have been consolidated (by communitization, unitization, forced-pooling, or otherwise) or until a non-standard unit, eliminating such interests, has been approved by the Commission.

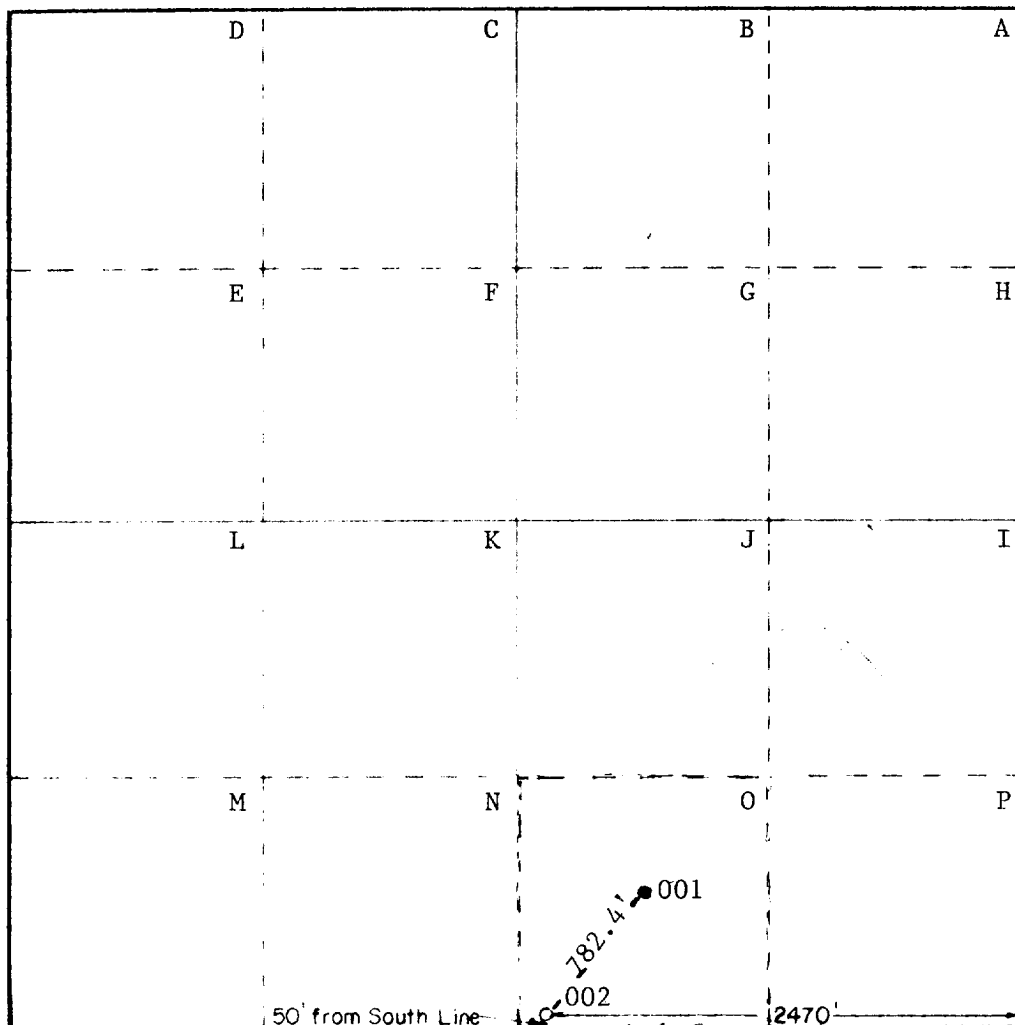

CERTIFICATION

I hereby certify that the information contained herein is true and complete to the best of my knowledge and belief.

Ralph J. Roper

Name
Ralph J. Roper

Position

Senior Engineering Specialist

Company

Phillips Petroleum Company

Date

June 2, 1980

I hereby certify that the well location shown on this plat was plotted from field notes of actual surveys made by me or under my supervision, and that the same is true and correct to the best of my knowledge and belief.

March 14, 1980

Registered Professional Engineer
in the State of New Mexico

John W. West

Certification No. **JOHN W. WEST 676**
PATRICK A. ROMERO 6883
Ronald J. Eidson 3239

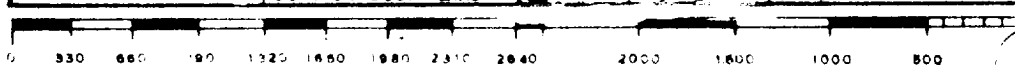

DOUBLE PREVENTER OPTION

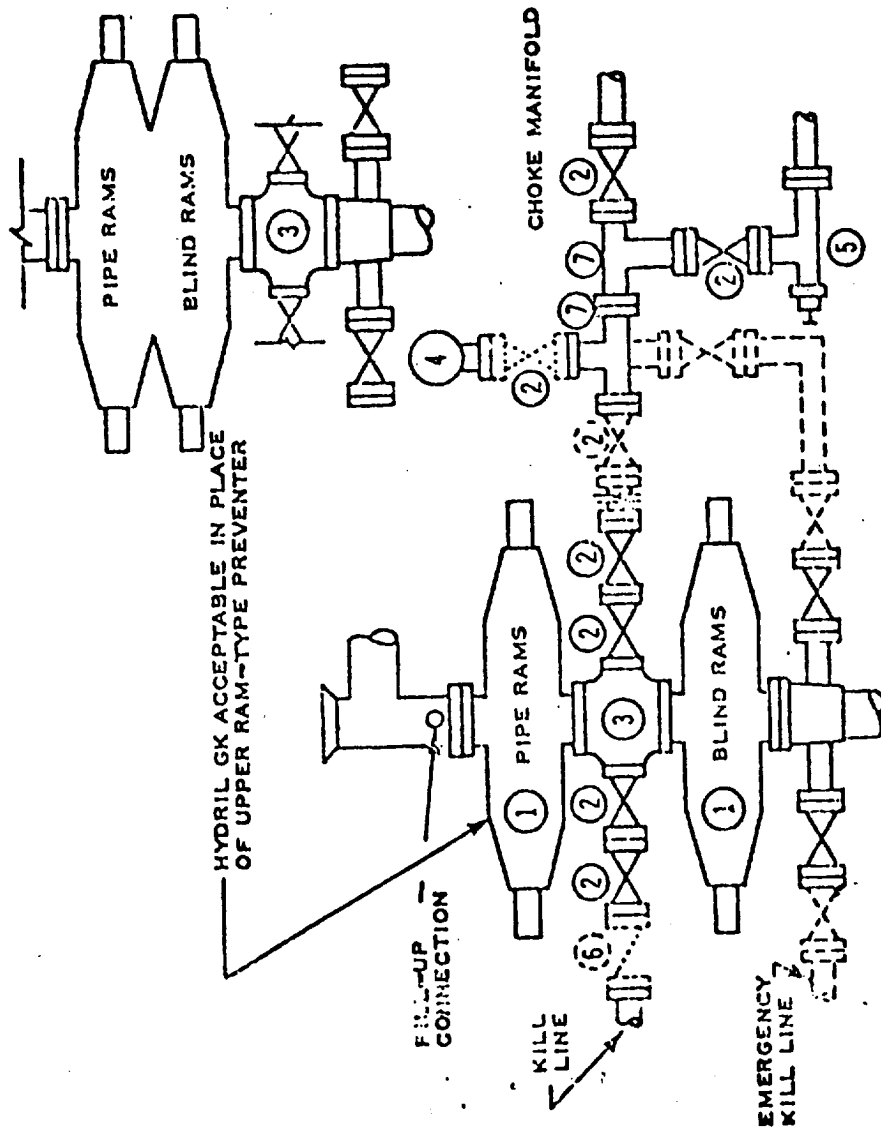

- ① SERIES 900 RAM-TYPE BOP
- ② 2" SERIES 900 VALVE
- ③ SERIES 900 DRILLING SPOOL
- ④ 2" MUD PRESSURE GAUGE
- ⑤ 2" SERIES 900 CHOKE
- ⑥ 2" SERIES 900 CHECK VALVE
- ⑦ 2" SERIES 900 STEEL TEE

NOTES:

1. 3000 PSI WP CLAMP
HUSS MAY BE SUBSTITUTED
FOR FLANGES
2. VALVES MAY BE EITHER HAND OR POWER
OPERATED BUT, IF POWER OPERATED,
THE VALVES FLANGED TO THE BOP RUN
MUST BE CAPABLE OF BEING OPENED AND
CLOSED MANUALLY OR CLOSE ON POWER
FAILURE AND BE CAPABLE OF BEING
OPENED MANUALLY

..... OPTIONAL EQUIPMENT

PHILLIPS PETROLEUM COMPANY
3000 PSI WORKING PRESSURE
BLOWOUT PREVENTER HOOK-UP
(SERIES 900 FLANGES OR BETTER)

RECEIVED

JUN 9 1980

OIL CONSERVATION DIV

