

30-025-26862

NO. OF COPIES RECEIVED	
DISTRIBUTION	
SANTA FE	
FILE	
U.S.G.S.	
LAND OFFICE	
OPERATOR	

NEW MEXICO OIL CONSERVATION COMMISSION

Form C-101
Revised 1-1-65

5A. Indicate Type of Lease STATE <input checked="" type="checkbox"/> FEE <input type="checkbox"/>
5. State Oil & Gas Lease No. B-1527
7. Unit Agreement Name East Vacuum Gb/SA Unit
8. Farm or Lease Name East Vacuum Gb/SA Unit, Tract 3127
9. Well No. 005
10. Field and Pool, or Wildcat Vacuum Gb/SA
12. County Lea
19. Proposed Depth 4800'
19A. Formation Gb/SA
20. Rotary or C.T. Rotary
21. Elevations (Show whether DE, RT, etc.) 3966.5' Ground (unprepared)
21A. Kind & Status Plug. Bond Blanket
21B. Drilling Contractor Advise later
22. Approx. Date Work will start Upon approval

APPLICATION FOR PERMIT TO DRILL, DEEPEN, OR PLUG BACK

1a. Type of Work b. Type of Well OIL WELL <input type="checkbox"/> GAS WELL <input type="checkbox"/> OTHER <input checked="" type="checkbox"/> Water Injection	DRILL <input checked="" type="checkbox"/> DEEPEN <input type="checkbox"/> PLUG BACK <input type="checkbox"/>
2. Name of Operator Phillips Petroleum Company	
3. Address of Operator Room 401, 4001 Penbrook, Odessa, Texas 79762	
4. Location of Well UNIT LETTER <u>P</u> LOCATED <u>10</u> FEET FROM THE <u>South</u> LINE AND <u>10</u> FEET FROM THE <u>East</u> LINE OF SEC. <u>31</u> TWP. <u>17-S</u> RGE. <u>35-E</u> NMPM	
19. Proposed Depth 4800'	19A. Formation Gb/SA
20. Rotary or C.T. Rotary	
21. Elevations (Show whether DE, RT, etc.) 3966.5' Ground (unprepared)	21A. Kind & Status Plug. Bond Blanket
21B. Drilling Contractor Advise later	22. Approx. Date Work will start Upon approval

PROPOSED CASING AND CEMENT PROGRAM

SIZE OF HOLE	SIZE OF CASING	WEIGHT PER FOOT	SETTING DEPTH	SACKS OF CEMENT	EST. TOP
17-1/2"	13-3/8"	48#, H-40	350' (sufficient qty Cl H w/2% CaCl ₂ , 1/4#/sx Flocele.) Circ to surface.		
12-1/4"	10-3/4"	40.5#, K-55	1560' (sufficient qty Cl H w/2% CaCl ₂ , 1/4#/sx Flocele.) Circ to surface.		
(Second intermediate string to run if salt water flow is encountered.)					
9-3/4"	7-5/8"	26.4#, N-80	2985' (IF) LWFR-Single stage (sufficient Cl C (10% salt, 1/4#/sx Flocele, 3#/sx Gilsonite) Circ to surface.		
			(OR) HWFR-Second stage & block squeeze (sufficient Cl C, 10% salt, 1/4#/sx Flocele, 3#/sx Gilsonite.) Circ to surface.		
6-1/4"	5-1/2"	15.5#, K-55	4800' (sufficient qty TLW w/12#/sx salt, 10% (DD, 3#/sx Gilsonite, 1/4#/sx Flocele followed (w/Cl H w/5#/sx salt.) Circ to surface.		

Subject to NSL application filed June 3, 1980.
Use mud additives as required for control.

BOP: Series 900, 300# WP, double w/one set pipe rams and one set blind rams.

APPROVAL VALID

FOR 90 DAYS UNLESS

DRILLING COMMENCED,

EXPIRES

9-17-80

IN ABOVE SPACE DESCRIBE PROPOSED PROGRAM: IF PROPOSAL IS TO DEEPEN OR PLUG BACK, GIVE DATA ON PRESENT PRODUCTIVE ZONE AND PROPOSED NEW PRODUCTIVE ZONE. GIVE BLOWOUT PREVENTER PROGRAM, IF ANY.

I hereby certify that the information above is true and complete to the best of my knowledge and belief.

Signed W. J. Mueller Title Senior Engineering Specialist Date June 5, 1980

(This space for State Use)

APPROVED BY

TITLE

SUPERVISOR DISTRICT

DATE

CONDITIONS OF APPROVAL, IF ANY:

**NEW MEXICO OIL CONSERVATION COMMISSION
WELL LOCATION AND ACREAGE DEDICATION PLAT**

Form C-102
Supersedes C-128
Effective 1-1-65

All distances must be from the outer boundaries of the Section.

Operator Phillips Petroleum Co.			Lease EVGSAU Tract 3127		Well No. 005
Unit Letter P	Section 31	Township 17 South	Range 35 East	County Lea	
Actual Footage Location of Well: 10 feet from the South line and 10 feet from the East line					
Ground Level Elev. 3966.5 (unprepared)	Producing Formation Grayburg/San Andres		Pool Vacuum Grayburg/ San Andres	Dedicated Acreage: None - line injection well	

1. Outline the acreage dedicated to the subject well by colored pencil or hachure marks on the plat below.
2. If more than one lease is dedicated to the well, outline each and identify the ownership thereof (both as to working interest and royalty).
3. If more than one lease of different ownership is dedicated to the well, have the interests of all owners been consolidated by communitization, unitization, force-pooling, etc?

☐ Yes ☐ No If answer is "yes," type of consolidation _____

If answer is "no," list the owners and tract descriptions which have actually been consolidated. (Use reverse side of this form if necessary.) _____

No allowable will be assigned to the well until all interests have been consolidated (by communitization, unitization, forced-pooling, or otherwise) or until a non-standard unit, eliminating such interests, has been approved by the Commission.

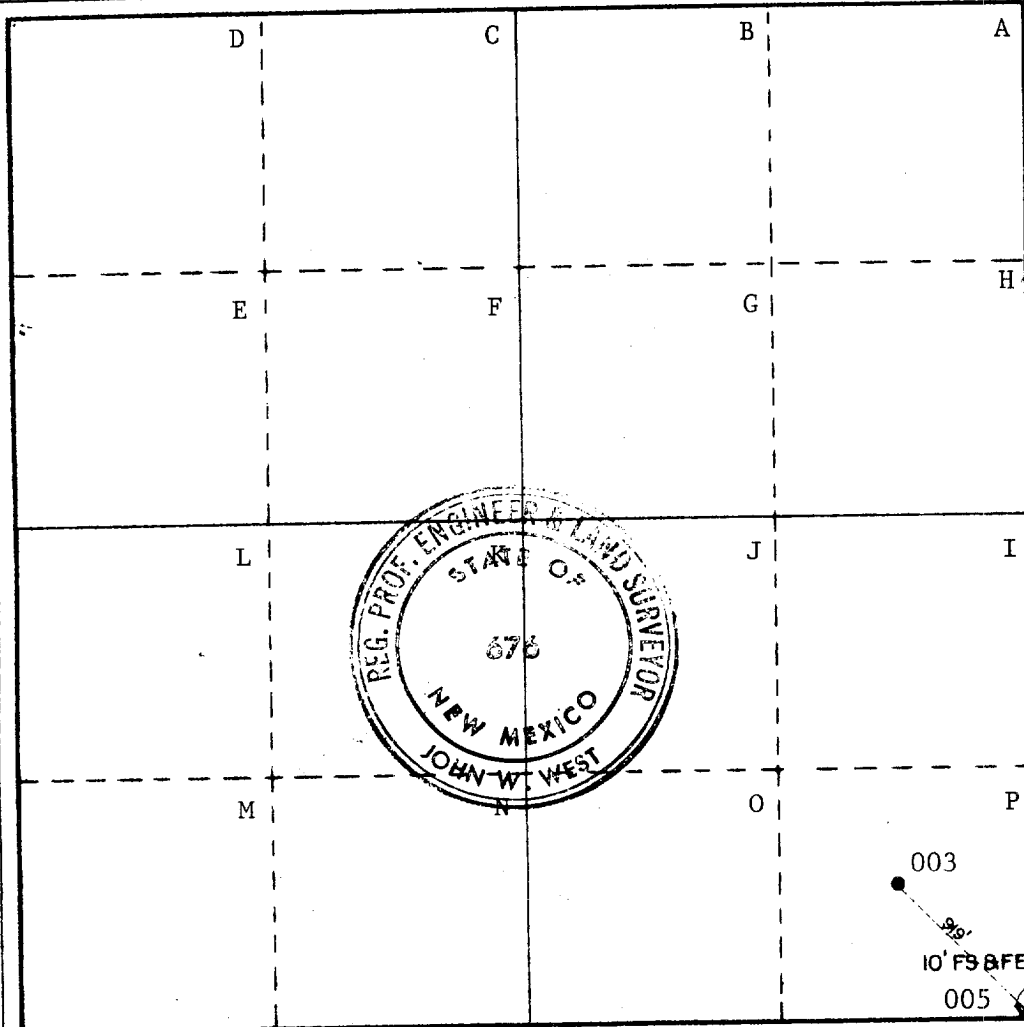

CERTIFICATION

I hereby certify that the information contained herein is true and complete to the best of my knowledge and belief.

Ralph J. Roper
Name

Ralph J. Roper

Position

Senior Engineering Specialist

Company

Phillips Petroleum Company

Date

June 2, 1980

I hereby certify that the well location shown on this plat was plotted from field notes of actual surveys made by me or under my supervision, and that the same is true and correct to the best of my knowledge and belief.

Date Surveyed

May 22, 1980

Registered Professional Engineer and/or Land Surveyor

John W. West

Certificate No. **JOHN W. WEST 676**
PATRICK A. ROMERO 6668
Ronald J. Eidson 3239

0 330 660 990 1320 1650 1980 2310 2640 2970 3300 3630 3960 4290 4620 4950 5280 5610 5940 6270 6600 6930 7260 7590 7920 8250 8580 8910 9240 9570 9900

DOUBLE PREVENTER OPTION

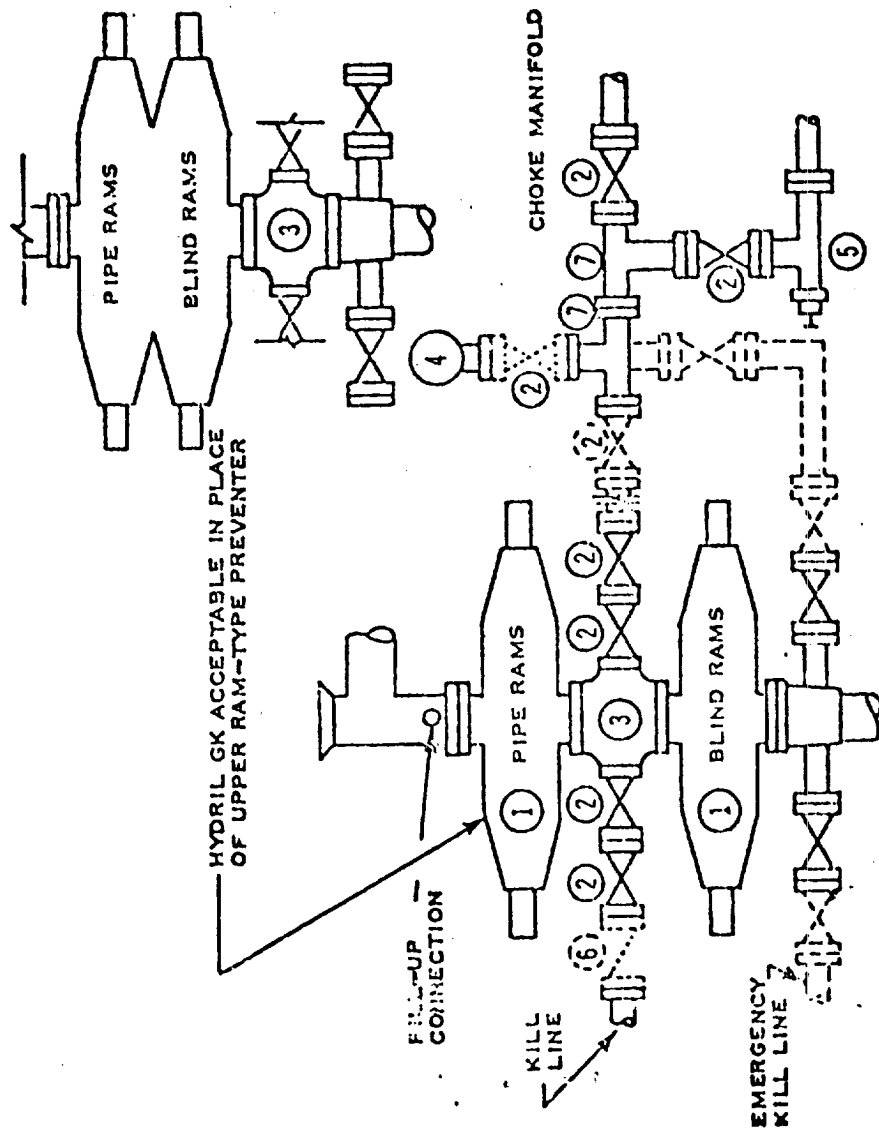

- ① SERIES 900 RAM-TYPE BOP
- ② 2" SERIES 900 VALVE
- ③ SERIES 900 DRILLING SPOOL
- ④ 2" MUD PRESSURE GAUGE
- ⑤ 2" SERIES 900 CHOKE
- ⑥ 2" SERIES 900 CHECK VALVE
- ⑦ 2" SERIES 900 STEEL TEE

NOTES:

1. 3000 PSI WP CLAMP HUBS MAY BE SUBSTITUTED FOR FLANGES
2. VALVES MAY BE EITHER HAND OR POWER OPERATED BUT, IF POWER OPERATED, THE VALVES FLANGED TO THE BOP RUN MUST BE CAPABLE OF BEING OPENED AND CLOSED MANUALLY OR CLOSE ON POWER FAILURE AND BE CAPABLE OF BEING OPENED MANUALLY

..... OPTIONAL EQUIPMENT

PHILLIPS PETROLEUM COMPANY

3000 PSI WORKING PRESSURE
BLOWOUT PREVENTER HOOK-UP
(SERIES 900 FLANGES OR BETTER)

RECEIVED

JUN 9 1980

OIL CONSERVATION DIV.

