



COUNTY LEA FIELD Scharb STATE NM  
 OPR SOUTHLAND ROYALTY CO. API 30-025-26891  
 NO 1 LEASE Scharb "4" MAP  
Sec 4, T19S, R35E CO-ORD  
660 FSL, 660 FWL of Sec 11-1-25 NM  
8 mi SE/Buckeye SPD 7-18-80 CMP 9-13-80

CSC

11 3/4-424-400 sx  
 8 5/8-4005-1325 sx  
 5 1/2-10,700-745 sx

WELL CLASS: INIT WD FIN DO LSE. CODE			
FORMATION	DATUM	FORMATION	DATUM
TD 10,706 (WFMP)		PBD	10,574

IP (Bone Spring) Perfs 9614-34 F 400 BOPD. Pot based  
 on 24 hr test thru 12/64. GOR TSTM; gty 35.4; CP Pkr;  
 TP 200

CONTR Hondo OPRSELEV 3866 GL PD 11,000 RT

F.R. 6-30-80  
 (Bone Spring)  
 11-1-80 AMEND FIELD, ZONE & LEASE: Formerly  
 reported as Wildcat (Wolfcamp) & Scharb "4"  
 7-22-80 Drlg 3233 lm & sh  
 7-29-80 TD 4005; WOC  
 8-4-80 Drlg 6962 lm & sh  
 8-12-80 Drlg 8736 lm & sh  
 8-25-80 Drlg 9970 sh  
 9-9-80 TD 10,706; WOCT  
 DST "Tight"  
 9-16-80 TD 10,706; SI  
 9-23-80 TD 10,706; PBD 10,574; Tstg  
 Perf (Bone Spring) 9614-34 (overall)  
 Acid (9614-34) 300 gals  
 Flwd 300 BO + 2 BW in 18 hrs thru 24/64 chk,  
 TP 200 (9614-34)  
 9-30-80 TD 10,706; PBD 10,574; Tstg  
 11-1-25 NM

LEA  
SOUTHLAND ROYALTY CO.

Scharb  
1 Scharb 4  
Sec 4, T19S, R35E

NM  
Page #2

9-30-80 Continued  
Flwd 204 BO + 1 BW in 24 hrs thru 12/64  
chk (9614-34)  
10-27-80 TD 10,706; PBD 10,574; Complete  
LOG TOPS: Yates 3350, Seven Rivers 3850,  
Queen 4617, Grayburg 4894, San Andres 5172,  
Bone Spring 7735, 1st Bone Spring 9373,  
2nd Bone Spring 9860, Wolfcamp 10,615  
11-1-80 COMPLETION ISSUED  
3-7-81 RE-ISSUE TO ADD GRAVITY & LOG TOPS  
11-1-25 NM  
IC 30-025-70300-80

NEW MEXICO OIL CONSERVATION COMMISSION  
WELL LOCATION AND ACREAGE DEDICATION PLAT

Form 102  
Supp. des C-128  
Effective 1-1-65

All distances must be from the outer boundaries of the Section.

Operator <b>Southland Royalty Co.</b>		Lease <b>Scharb 4</b>		Well No. <b>1</b>
Unit Letter <b>M</b>	Section <b>4</b>	Township <b>19 South</b>	Range <b>35 East</b>	County <b>Lea</b>
Actual Plotage Location of Well:				
<b>660</b>	feet from the <b>South</b>	line and	<b>660</b>	feet from the <b>West</b> line
Ground Level Elev. <b>3865.7</b>	Producing Formation <b>Bone Spring</b>	Pool <b>Scharb BS</b>	Dedicated Acreage: <b>80</b> Acres	
		<b>Undesignated</b>		

- Outline the acreage dedicated to the subject well by colored pencil or hatchure marks on the plat below.
- If more than one lease is dedicated to the well, outline each and identify the ownership thereof (both as to working interest and royalty).
- If more than one lease of different ownership is dedicated to the well, have the interests of all owners been consolidated by communitization, unitization, force-pooling, etc?

☐ Yes ☐ No If answer is "yes," type of consolidation \_\_\_\_\_

If answer is "no," list the owners and tract descriptions which have actually been consolidated. (Use reverse side of this form if necessary.) \_\_\_\_\_

No allowable will be assigned to the well until all interests have been consolidated (by communitization, unitization, forced-pooling, or otherwise) or until a non-standard unit, eliminating such interests, has been approved by the Commission.

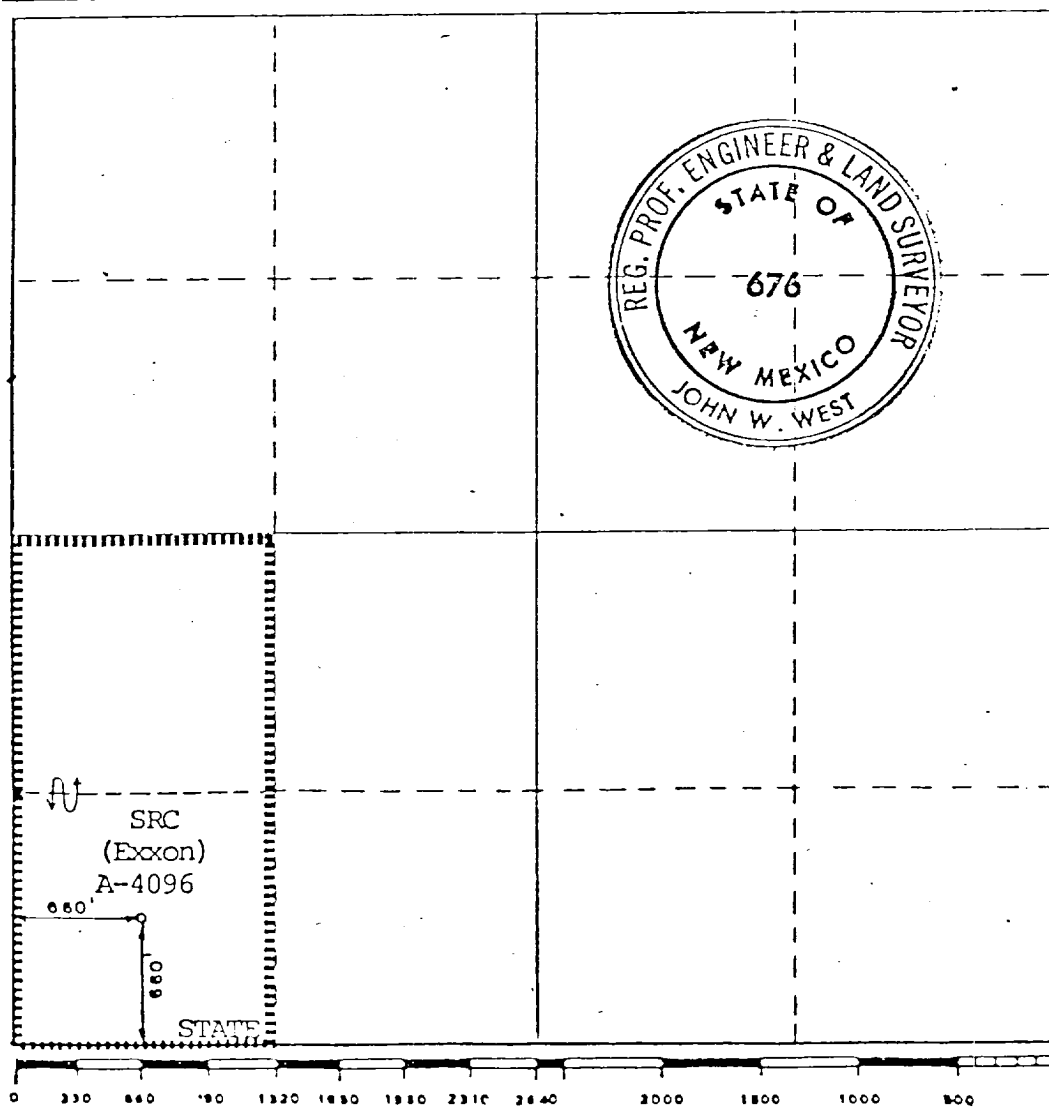

CERTIFICATION

I hereby certify that the information contained herein is true and complete to the best of my knowledge and belief.

*John W. West*  
Position

District Operation Engineer

Company

Southland Royalty Company

Date

10-8-80

I hereby certify that the well location shown on this plat was plotted from field notes of actual surveys made by me or under my supervision, and that the same is true and correct to the best of my knowledge and belief.

Date Surveyed

6-9-1980

Registered Professional Engineer and/or Land Surveyor

*John W. West*

Certificate No. **JOHN W. WEST 676**  
**PATRICK A. ROMERO 8663**  
**Ronald J. Elden 3239**