

NO. OF COPIES RECEIVED	
DISTRIBUTION	
SANTA FE	
FILE	
U.S.G.S.	
LAND OFFICE	
OPERATOR	

NEW MEXICO OIL CONSERVATION COMMISSION

Form C-101
Revised 1-1-65

API No. 30-025-26925

APPLICATION FOR PERMIT TO DRILL, DEEPEN, OR PLUG BACK

1a. Type of Work		7. Unit Agreement Name	
b. Type of Well DRILL <input checked="" type="checkbox"/> DEEPEN <input type="checkbox"/> PLUG BACK <input type="checkbox"/>		East Vacuum Gb/SA Unit	
c. Method of Operator Phillips Petroleum Company		8. Farm or Lease Name East Vacuum	
3. Address of Operator Room 401, 4001 Penbrook, Odessa, Texas 79762		Gb/SA Unit, Tract 2913	
4. Location of Well UNIT LETTER <u>J</u> LOCATED <u>2320</u> FEET FROM THE <u>South</u> LINE AND <u>2450</u> FEET FROM THE <u>East</u> LINE OF SEC. <u>29</u> TWP. <u>17-S</u> RGE. <u>35-E</u> NMPM		9. Well No. 010	
		10. Field and Pool, or Wildcat Vacuum Gb/SA	
		12. County Lea	
		13. Proposed Depth 4800'	
		14A. Formation Gb/SA	
		20. Rotary or C.T. Rotary	
21. Elevations (Show whether DE, RI, etc.) 3972.1 (ground unprepared)		21A. Kind & Status Plug. Bond blanket	
		21B. Drilling Contractor Advise later	
		22. Approx. Date Work will start Upon approval	

PROPOSED CASING AND CEMENT PROGRAM

SIZE OF HOLE	SIZE OF CASING	WEIGHT PER FOOT	SETTING DEPTH	SACKS OF CEMENT	EST. TOP
11"	8-5/8"	24#, K-55	350'	(sufficient quantity of	C1 H w/2% CaCl
				(1/4# Flocele/sx in 1st 150/sx)	circ to surface)
7-7/8"	5-1/2"	17#, K-55	4800'	(suff. TRLW w/12# salt/sx w/10% DD and	
		15.5#, K-55		(1/4#/sx Flocele plus 3# Gilsonite/sx followed	
				(by 260 sxs C1 H cmt w/8# salt/sx to circ at	
				(surface).	

(This well is in the same proration unit as Well No. 002)

Reference NSL. 1236. (Applied for by letter dated July 8, 1980.)

Use mud additives as required for control.

BOP: Series 900, 3000# WP, double w/one set pipe rams and one set blind rams.

IN ABOVE SPACE DESCRIBE PROPOSED PROGRAM: IF PROPOSAL IS TO DEEPEN OR PLUG BACK, GIVE DATA ON PRESENT PRODUCTION ZONE AND PROPOSED NEW PRODUCTION ZONE. SIZE BLOWOUT PREVENTER PROGRAM, IF ANY.

I hereby certify that the information above is true and complete to the best of my knowledge and belief.

Signature W. J. Mueller Title Senior Engineering Specialist Date July 10, 1980

(This space for State Use)

APPROVED BY [Signature] TITLE SUPERVISOR DISTRICT DATE JUL 15 1980

CONDITIONS OF APPROVAL, IF ANY:

NEW MEXICO OIL CONSERVATION COMMISSION
WELL LOCATION AND ACREAGE DEDICATION PLAT

Form O-102
Supersedes O-128
Effective 1-1-65

All distances must be from the outer boundaries of the Section

Operator Phillips Petroleum Co.		Lease EVGSAU Tract 2913		Well No. 2913-010
Unit Letter J	Section 29	Township 17 South	Range 35 East	County Lea
Actual Footage Location of Well: 2320 feet from the South line and 2450 feet from the East line				
Ground Level Elev. 3972.1	Producing Formation Grayburg/San Andres	Pool Vacuum Gb/San Andres	Dedicated Acreage: 40 Acres	

- (unprepared)
- Outline the acreage dedicated to the subject well by colored pencil or hachure marks on the plat below.
 - If more than one lease is dedicated to the well, outline each and identify the ownership thereof (both as to working interest and royalty).
 - If more than one lease of different ownership is dedicated to the well, have the interests of all owners been consolidated by communitization, unitization, force-pooling, etc?

☐ Yes ☐ No If answer is "yes," type of consolidation _____

If answer is "no," list the owners and tract descriptions which have actually been consolidated. (Use reverse side of this form if necessary.) _____

No allowable will be assigned to the well until all interests have been consolidated (by communitization, unitization, forced-pooling, or otherwise) or until a non-standard unit, eliminating such interests, has been approved by the Commission.

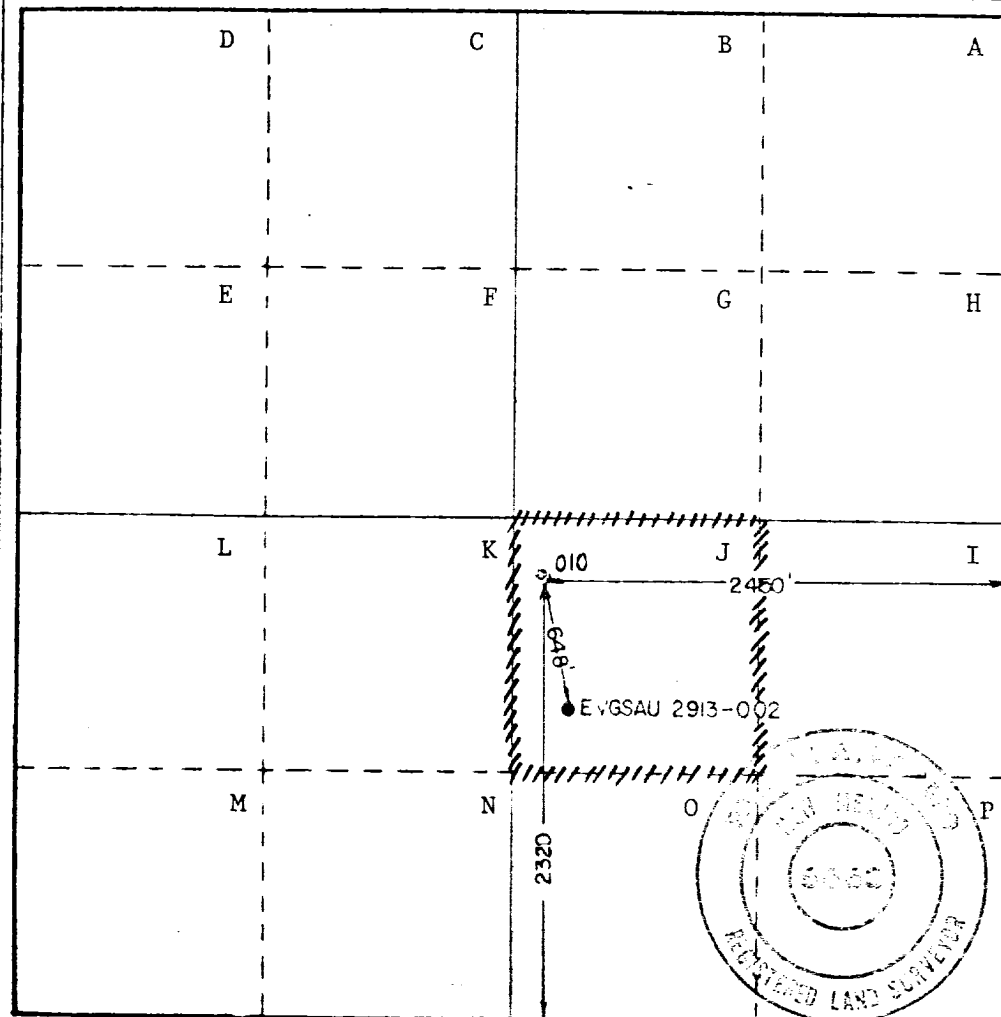

CERTIFICATION

I hereby certify that the information contained herein is true and complete to the best of my knowledge and belief.

Name
W. J. Mueller
Position
Sr. Engineering Specialist
Company
Phillips Petroleum Company
Date
July 9, 1980

I hereby certify that the well location shown on this plat was plotted from field notes of actual surveys made by me or under my supervision, and that the same is true and correct to the best of my knowledge and belief.

Date Surveyed
June 25, 1980
Registered Professional Engineer and/or Land Surveyor

Patrick A. Romero
Certificate No. **JOHN W. WEST 676**
PATRICK A. ROMERO 6463
Residence: **El Paso 7230**

DOUBLE PREVENTER OPTION

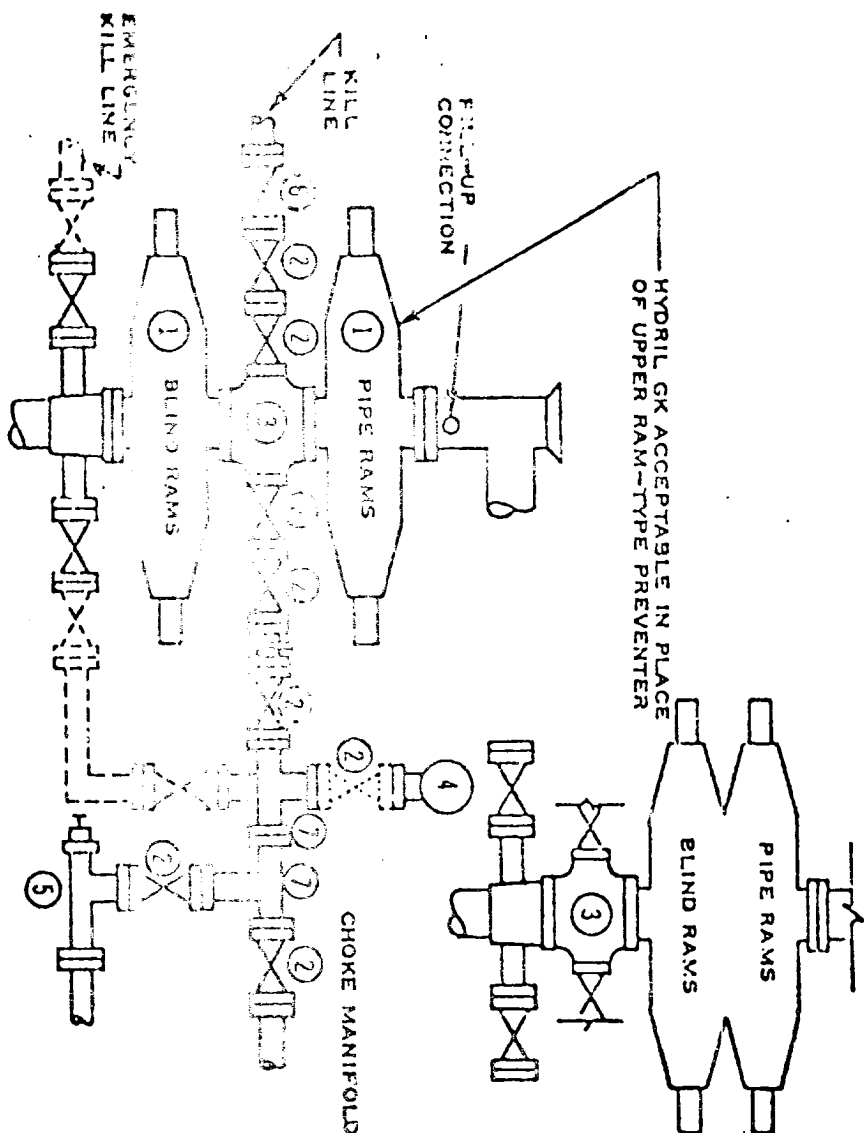

- ① SERIES 900 RAM-TYPE BOP
- ② 2" SERIES 900 VALVE
- ③ SERIES 900 DRILLING SPOOL
- ④ 2" MUD PRESSURE GAUGE
- ⑤ 2" SERIES 900 CHOKE
- ⑥ 2" SERIES 900 CHECK VALVE
- ⑦ 2" SERIES 900 STEEL TEE

NOTES:

1. 3000 PSI WP CLAMP
HUGS MAY BE SUBSTITUTED
FOR FLANGES
2. VALVES MAY BE EITHER AIR OR POWER
OPERATED BUT, IF POWER OPERATED,
THE VALVES FLANGED TO THE BOP RUN
MUST BE CAPABLE OF BEING OPENED AND
CLOSED MANUALLY OR CLOSE ON POWER
FAILURE AND BE CAPABLE OF BEING
OPENED MANUALLY

..... OPTIONAL EQUIPMENT

PHILLIPS PETROLEUM COMPANY

3000 PSI WORKING PRESSURE
BLOWOUT PREVENTER HOOK-UP
(SERIES 900 FLANGES OR BETTER)