

Submit to Appropriate
District Office
State Lease - 6 copies
Fee Lease - 5 copies
DISTRICT I
P.O. Box 1980, Hobbs, NM 88240

DISTRICT II
P.O. Drawer DD, Artesia, NM 88210

DISTRICT III
1000 Rio Brazos Rd., Aztec, NM 87410

State of New Mexico
Energy, Minerals and Natural Resources Department

OIL CONSERVATION DIVISION
P.O. Box 2088
Santa Fe, New Mexico 87504-2088

Form C-105
Revised 1-1-89

WELL API NO. 30-025-26953
5. Indicate Type of Lease STATE <input type="checkbox"/> FEE <input checked="" type="checkbox"/>
6. State Oil & Gas Lease No.

WELL COMPLETION OR RECOMPLETION REPORT AND LOG																	
1a. Type of Well: OIL WELL <input checked="" type="checkbox"/> GAS WELL <input type="checkbox"/> DRY <input type="checkbox"/> OTHER <input type="checkbox"/>						7. Lease Name or Unit Agreement Name Warren											
b. Type of Completion: NEW WELL <input type="checkbox"/> WORK OVER <input checked="" type="checkbox"/> DEEPEN <input type="checkbox"/> PLUG BACK <input type="checkbox"/> DIFF RESVR <input type="checkbox"/> OTHER <input type="checkbox"/>						8. Well No. 2											
2. Name of Operator Fasken Oil and Ranch, Ltd.						9. Pool name or Wildcat Midway Devonian											
3. Address of Operator 303 W. Wall, Suite 1900, Midland, TX 79701																	
4. Well Location Unit Letter <u>H</u> : <u>2200</u> Feet From The <u>North</u> Line and <u>880</u> Feet From The <u>East</u> Line Section <u>8</u> Township <u>17S</u> Range <u>37E</u> NMPM Lea County																	
10. Date Spudded 8-16-80		11. Date T.D. Reached 9-30-80		12. Date Compl. (Ready to Prod.) 2-23-98 (Devonian)		13. Elevations (DF & RKB, RT, GR, etc.) 3775.4' GR		14. Elev. Casinghead 3775'									
15. Total Depth 11,875'		16. Plug Back T.D. 11,872'		17. If Multiple Compl. How Many Zones? --		18. Intervals Drilled By Rotary Tools A11		Cable Tools									
19. Producing Interval(s), of this completion - Top, Bottom, Name 11,760'-11,850' Devonian						20. Was Directional Survey Made Yes											
21. Type Electric and Other Logs Run None this completion originally: CNL-FDC, DLL/MSFL, Sonic, FIL						22. Was Well Cored No											
23. CASING RECORD (Report all strings set in well)																	
CASING SIZE		WEIGHT LB/FT.		DEPTH SET		HOLE SIZE		CEMENTING RECORD		AMOUNT PULLED							
13-3/8"		48		378'		17 1/2"		250 Lite + 100 "C"		None							
8-5/8"		32 & 24		4400'		12 1/2"		1400 Lite + 200 "C"		None							
5 1/2"		17 & 20		11875'		7-7/8"		1st jts.: 375 lite + 375 "H"		None							
								2nd jts.: 1000 Lite+100 "C"		None							
24. LINER RECORD						25. TUBING RECORD											
SIZE		TOP		BOTTOM		SACKS CEMENT		SCREEN		SIZE		DEPTH SET		PACKER SET			
										2-7/8"		10903'					
26. Perforation record (interval, size, and number) 11760'-11794' (.56", 136 shots) 11808'-11850' (.56", 168 shots)						27. ACID, SHOT, FRACTURE, CEMENT, SQUEEZE, ETC.											
						DEPTH INTERVAL		AMOUNT AND KIND MATERIAL USED									
						11760'-11850'		None this completion									
28. PRODUCTION																	
Date First Production 2-23-98			Production Method (Flowing, gas lift, pumping - Size and type pump) Pumping					Well Status (Prod. or Shut-in) Prod.									
Date of Test 3-5-98		Hours Tested 24		Choke Size 2"		Prod'n For Test Period		Oil - Bbl. 47		Gas - MCF 2		Water - Bbl. 24		Gas - Oil Ratio 43			
Flow Tubing Press. 30		Casing Pressure 30		Calculated 24-Hour Rate		Oil - Bbl. 47		Gas - MCF 2		Water - Bbl. 24		Oil Gravity - API - (Corr.) 51°					
29. Disposition of Gas (Sold, used for fuel, vented, etc.) Sold										Test Witnessed By David Taylor							
30. List Attachments C-102, C-103, C-104 Logs were files upon original completion																	
31. I hereby certify that the information shown on both sides of this form is true and complete to the best of my knowledge and belief																	
Signature <u>Carl Brown</u>						Printed Name <u>Carl Brown</u>		Title <u>Petroleum Engineer</u>		Date <u>3/10/98</u>							

INSTRUCTIONS

This form is to be filed with the appropriate District Office of the Division not later than 20 days after the completion of any newly-drilled or deepened well. It shall be accompanied by one copy of all electrical and radio-activity logs run on the well and a summary of all special tests conducted, including drill stem tests. All depths reported shall be measured depths. In the case of directionally drilled wells, true vertical depths shall also be reported. For multiple completions, Items 25 through 29 shall be reported for each zone. The form is to be filed in quintuplicate except on state land, where six copies are required. See Rule 1105.

INDICATE FORMATION TOPS IN CONFORMANCE WITH GEOGRAPHICAL SECTION OF STATE

Southeastern New Mexico

T. Anhy _____ 2011
 T. Salt _____
 B. Salt _____
 T. Yates _____ 3187
 T. 7 Rivers _____
 T. Queen _____
 T. Grayburg _____
 T. San Andres _____ 4855
 T. Glorieta _____ 6324
 T. Paddock _____
 T. Blinebry _____
 T. Tubb _____ 7678
 T. Drinkard _____
 T. Abo _____
 T. Wolfcamp _____
 T. Penn _____
 T. Cisco (Bough C) _____

T. Canyon _____
 T. Strawn _____ 10669
 T. Atoka _____
 T. Miss _____ 10905
 T. Devonian _____ 11740
 T. Silurian _____
 T. Montoya _____
 T. Simpson _____
 T. McKee _____
 T. Ellenburger _____
 T. Gr. Wash _____
 T. Delaware Sand _____
 T. Bone Springs _____
 T. _____
 T. _____
 T. _____
 T. _____

Northwestern New Mexico

T. Ojo Alamo _____
 T. Kirtland-Fruitland _____
 T. Pictured Cliffs _____
 T. Cliff House _____
 T. Menefee _____
 T. Point Lookout _____
 T. Mancos _____
 T. Gallup _____
 Base Greenhorn _____
 T. Dakota _____
 T. Morrison _____
 T. Todilto _____
 T. Entrada _____
 T. Wingate _____
 T. Chinle _____
 T. Permian _____
 T. Penn "A" _____

T. Penn. "B" _____
 T. Penn. "C" _____
 T. Penn. "D" _____
 T. Leadville _____
 T. Madison _____
 T. Elbert _____
 T. McCracken _____
 T. Ignacio Otzte _____
 T. Granite _____
 T. _____
 T. _____
 T. _____
 T. _____
 T. _____
 T. _____
 T. _____
 T. _____

OIL OR GAS SANDS OR ZONES

No. 1, from _____ 11740 _____ to _____ 11871 _____
 No. 2, from _____ to _____
 No. 3, from _____ to _____
 No. 4, from _____ to _____

IMPORTANT WATER SANDS

Include data on rate of water inflow and elevation to which water rose in hole.

No. 1, from _____ None _____ to _____ feet _____
 No. 2, from _____ to _____ feet _____
 No. 3, from _____ to _____ feet _____

LITHOLOGY RECORD (Attach additional sheet if necessary)

From	To	Thickness in Feet	Lithology	From	To	Thickness in Feet	Lithology
0	255	255	Surface	5984	6350	366	Lime x Dolo
255	2011	1756	Redbed x Anhydrite	6359	6459	199	Lime x Dolo x Sand
2011	2200	189	Anhy	6450	6600	150	Lime x Dolo
2200	3187	987	Salt x anhy	6600	8184	1584	Dolo
3187	3755	568	Sand x anhy	8184	8576	392	Dolo x Chert
3755	4530	775	Anhy x Dolo	8576	8704	128	Sand x Dolo
4530	4650	120	Sand x Dolo	8704	8802	98	Dolo
4650	4676	26	Dolo	8802	11875	3073	Lime x Shale
4676	4852	176	Anhy x Dolo				
4852	5578	726	Dolo				
5578	5900	322	Lime x Dolo				
5900	5984	84	Chert x Dolo				

NEW MEXICO OIL CONSERVATION COMMISSION WELL LOCATION AND ACREAGE DEDICATION PLAT

Form 10-1
Supersedes L-1, 8
Effective 1-1-65

All distances must be from the outer boundaries of the Section.

Operator Fasken Oil and Ranch, Ltd.		Lease Warren		Well No. 2
Unit Letter H	Section 8	Township 17 South	Range 37 East	County Lea
Actual Footage Location of Well: 2200 feet from the North line and 880 feet from the East line				
Ground Level Elev. 3775.4	Producing Formation Devonian	Pool Midway (Devonian)	Dedicated Acreage: 40	

1. Outline the acreage dedicated to the subject well by colored pencil or hachure marks on the plat below.
2. If more than one lease is dedicated to the well, outline each and identify the ownership thereof (both as to working interest and royalty).
3. If more than one lease of different ownership is dedicated to the well, have the interests of all owners been consolidated by communitization, unitization, force-pooling, etc?

☐ Yes ☐ No If answer is "yes," type of consolidation _____

If answer is "no," list the owners and tract descriptions which have actually been consolidated. (Use reverse side of this form if necessary.) _____

No allowable will be assigned to the well until all interests have been consolidated (by communitization, unitization, forced-pooling, or otherwise) or until a non-standard unit, eliminating such interests, has been approved by the Commission.

CERTIFICATION

I hereby certify that the information contained herein is true and complete to the best of my knowledge and belief.

Carl Brown

Name
Carl Brown
Position
Petroleum Engineer
Company
Fasken Oil and Ranch, Ltd.
Date
3/10/98

I hereby certify that the well location shown on this plat was plotted from field notes of actual surveys made by me or under my supervision, and that the same is true and correct to the best of my knowledge and belief.

Date Surveyed
July 14, 1980

Registered Professional Engineer
Major and Surveyor

John W. West

Certificate No. JOHN W. WEST 676
PATRICK A. ROMERO 686
Ronald J. Sidson 323

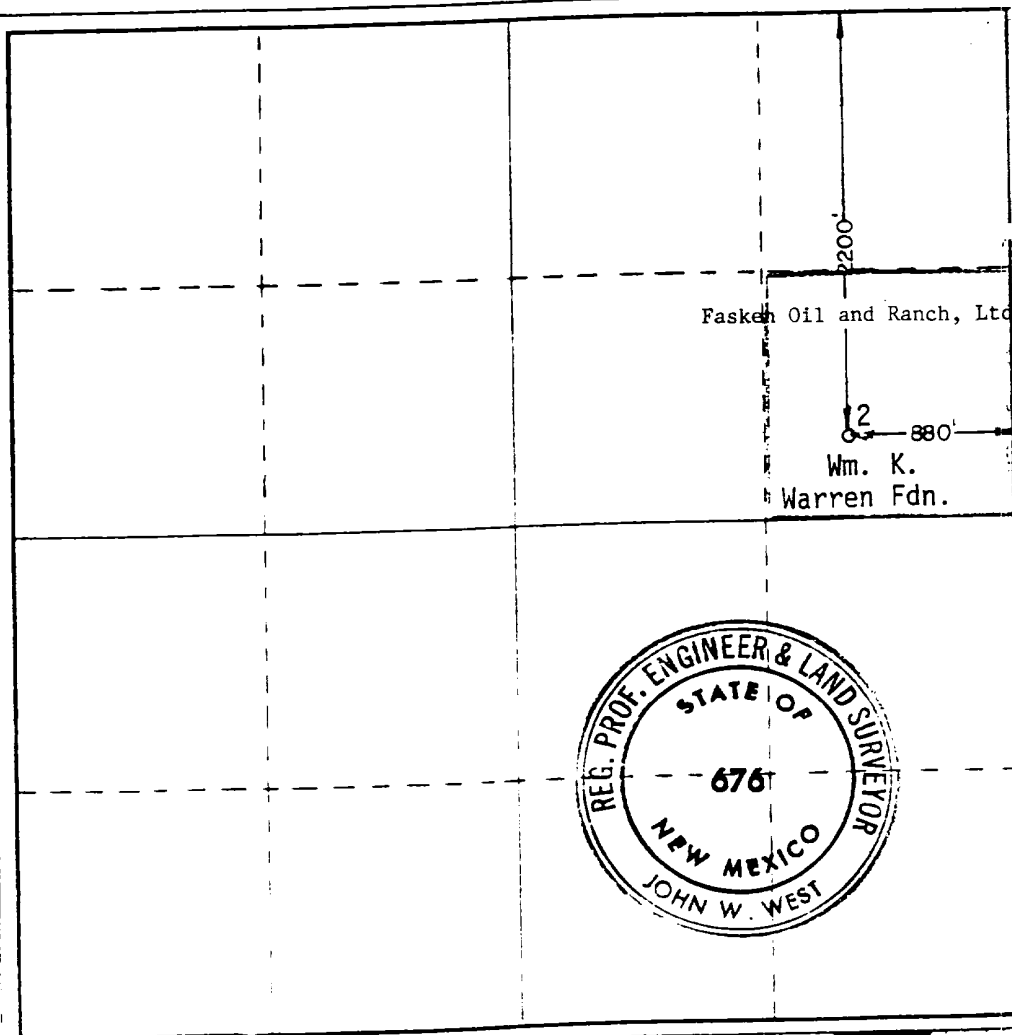

130 480 90 120 680 280 231 2640 2000 500 000 500