

NEW MEXICO OIL CONSERVATION COMMISSION
WELL LOCATION AND ACREAGE DEDICATION PLAT

Form No. 1
Supersedes Form
1-1-1-1-1-1-1-1-1-1

All distances must be from the outer boundaries of the Section.

| | | | | | | | | |
|------------------------------------|--|-----------------------------|----------------------------------|----------------------|--|--------------------------------|--|--|
| Owner David Faskin | | | Lease Warren | | | Section 2 | | |
| Section H | Section 8 | Township 17 South | Range 37 East | County Lea | | | | |
| Acreage Location of Well: | | | | | | | | |
| 2200 feet from the North line and | | | 880 feet from the East line | | | | | |
| Ground Level Elev 3775.4 | Producing Formation Devonian | | Foot Midway (Devonian) | | | Dedicated Acreage 40 | | |

1. Outline the acreage dedicated to the subject well by colored pencil or hatchure marks on the plat below.
2. If more than one lease is dedicated to the well, outline each and identify the ownership thereof (both as to working interest and royalty)
3. If more than one lease of different ownership is dedicated to the well, have the interests of all owners been consolidated by communitization, unitization, force-pooling, etc?

☐ Yes ☐ No If answer is "yes," type of consolidation _____

If answer is "no," list the owners and tract descriptions which have actually been consolidated (Use reverse side of this form if necessary.) _____

No allowable will be assigned to the well until all interests have been consolidated (by communitization, unitization, forced-pooling, or otherwise) or until a non-standard unit, eliminating such interests, has been approved by the Commission.

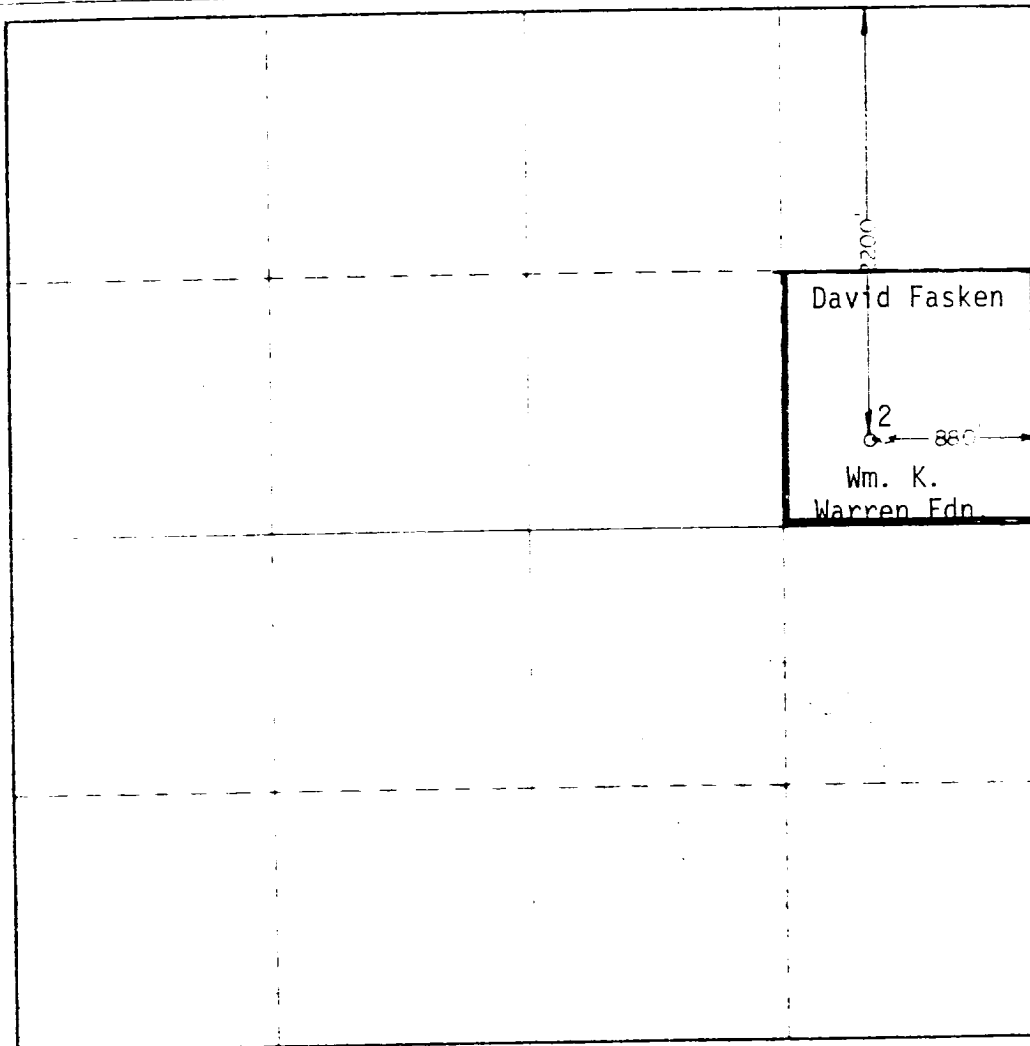

CERTIFICATION

I hereby certify that the information contained herein is true and complete to the best of my knowledge and belief.

Robert H. Angevine

Robert H. Angevine

Agent

DAVID FASKEN

7-21-80

I hereby certify that the well location shown on this plat was plotted from field notes of actual surveys made by me or under my supervision, and that the same is true and correct to the best of my knowledge and belief.

Date of Survey
July 14, 1980

Registered in the Office of the
County Clerk, Lea County, New Mexico

John W. West

Certificate No. **JOHN W. WEST** 676
PATRICK A. ROMERO 6868
Recorded in the Office of the County Clerk, Lea County, New Mexico **3239**