

STATE OF NEW MEXICO
ENERGY AND MINERALS DEPARTMENT

OIL CONSERVATION DIVISION
P. O. BOX 2088
SANTA FE, NEW MEXICO 87501

Form C-103
Revised 10-1-79

NO. OF COPIES RECEIVED	
DISTRIBUTION	
SANTA FE	
FILE	
U.S.G.S.	
LAND OFFICE	
OPERATOR	

5a. Indicate Type of Lease
State ☐ Fee ☒

5. State Oil & Gas Lease No.

SUNDRY NOTICES AND REPORTS ON WELLS

(DO NOT USE THIS FORM FOR PROPOSALS TO DRILL OR TO DEEPEN OR PLUG BACK TO A DIFFERENT RESERVOIR. USE "APPLICATION FOR PERMIT" (FORM C-101) FOR SUCH PROPOSALS.)

OIL WELL ☒ GAS WELL ☐ OTHER ☐

Name of Operator

David Fasken

Address of Operator

608 First National Bank Building, Midland, Texas 79701

Location of Well

UNIT LETTER H 2200 FEET FROM THE North LINE AND 880 FEET FROM
THE East LINE, SECTION 8 TOWNSHIP 17-S RANGE 37-E NMPM.

7. Unit Agreement Name

8. Farm or Lease Name

Warren

9. Well No.

2

10. Field and Pool, or Wildcat

Midway (Strawn)

11. Elevation (Show whether DF, RT, GR, etc.)

3775.4 GR

12. County

Lea

Check Appropriate Box To Indicate Nature of Notice, Report or Other Data

NOTICE OF INTENTION TO:

PERFORM REMEDIAL WORK ☐
TEMPORARILY ABANDON ☐
PULL OR ALTER CASING ☐

PLUG AND ABANDON ☐
CHANGE PLANS ☐

OTHER ☐

SUBSEQUENT REPORT OF:

REMEDIAL WORK ☒
COMMENCE DRILLING OPNS. ☐
CASING TEST AND CEMENT JOBS ☐
OTHER ☒ Plug back from Devonian to Strawn

ALTERING CASING ☐
PLUG AND ABANDONMENT ☐

13. Describe Proposed or Completed Operations (Clearly state all pertinent details, and give pertinent dates, including estimated date of starting any proposed work) SEE RULE 1103.

9-7-83 Pulled and layed down sucker rods and pump.
9-8-83 Pulled and layed down 301 jts. 2-7/8", N-80, 6.50#/ft., EUE, 8rd, thd tubing. Set 5 1/2" C.I.B.P. @ 10,950' with 2 sxs. cement on top....new P.B.T.D. is 10,932'.
9-9-83 Ran in well with 5-1/2" x 2-3/8" Baker Model "R" double grip packer on 353 jts. 2-3/8" N-80, 4.70#/ft., EUE, 8rd, thd tubing. Set packer at 10,544' K.B. meas. and installed Christmas tree.
9-10 & 11 Perforated Strawn formation with Schlumberger's 1-11/16" Enerjet as follows:
10,787, 784, 783, & 782' ---- 4 jet shots
10,776' up to 10,720' with 1 jet shot per foot ---- 57 jet shots
10,716, 715, 714, 712, 711, 710, 709, & 708 ---- 8 jet shots
10,705' up to 10,682' with 1 jet shot per foot ---- 24 jet shots
Flowed 36 B.O. in 5 hrs., 14/64" choke, FTP 500 psig ---- shut in for BHP build up.
9-16-83 Well on production test 30/64" choke, FTP 540 psig, 93 B.O.P.D. + 0 B.W.P.D.
9-19-83 Potential well: 136 B.O.P.D. + 0 B.W.P.D., 40/64" choke, FTP 500 psig, GOR 1743 cu.ft./barrel.

14. I hereby certify that the information above is true and complete to the best of my knowledge and belief.

Robert H. Angevine

SIGNED Robert H. Angevine TITLE Agent DATE 9/20/83

ORIGINAL SIGNED BY EDDIE SEAY
OIL & GAS INSPECTOR

SEP 22 1983

APPROVED BY _____ TITLE _____ DATE _____

CONDITIONS OF APPROVAL, IF ANY:

NEW MEXICO OIL CONSERVATION COMMISSION
WELL LOCATION AND ACREAGE DEDICATION PLAT

Form No. 1
Supersedes O-28
Effective 1-1-64

All distances must be from the outer boundaries of the Section

Owner David Faskin			Lease Warren		Section 2
Map Letter H	Section 8	Township 17 South	Range 37 East	County Lea	
Acreage Location of Well:					
2200		feet from the North	line and	880	feet from the East
Ground Level Elev. 3775.4	Producing Formation Devonian		Pool Midway (Devonian)		Dedicated Acreage 40

- 1 Outline the acreage dedicated to the subject well by colored pencil or hatchure marks on the plat below.
- 2 If more than one lease is dedicated to the well, outline each and identify the ownership thereof (both as to working interest and royalty).
- 3 If more than one lease of different ownership is dedicated to the well, have the interests of all owners been consolidated by communitization, unitization, force-pooling, etc?

☐ Yes ☐ No If answer is "yes," type of consolidation _____

If answer is "no," list the owners and tract descriptions which have actually been consolidated. (Use reverse side of this form if necessary.) _____

No allowable will be assigned to the well until all interests have been consolidated (by communitization, unitization, forced-pooling, or otherwise) or until a non-standard unit, eliminating such interests, has been approved by the Commission.

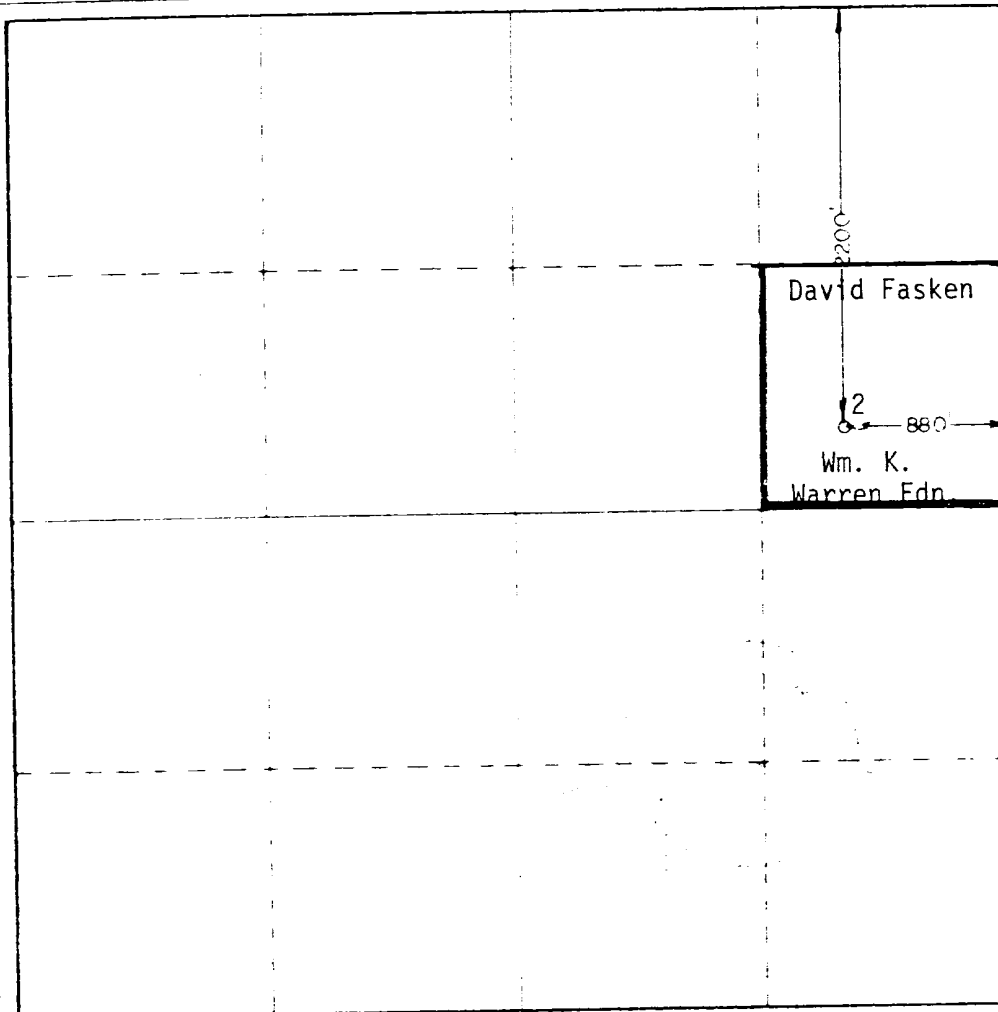

CERTIFICATION

I hereby certify that the information contained herein is true and complete to the best of my knowledge and belief.

Robert H. Angevine

Robert H. Angevine

Position

Agent

Company

DAVID FASKEN

Date

7-21-80

I hereby certify that the well location shown on this plat was plotted from field notes of actual surveys made by me or under my supervision, and that the same is true and correct to the best of my knowledge and belief.

Date Surveyed

July 14, 1980

Registered Professional Engineer and/or Professional Surveyor

John W. West

John W. West

Certificate No. **JOHN W. WEST** 676
PATRICK A. ROMERO 6662
Ranging, Bridge 3239

F

RECEIVED

SEP 3 1963

O.
HOBBBS OFFICE

U.S. DEPARTMENT OF JUSTICE
FEDERAL BUREAU OF INVESTIGATION
WASHINGTON, D.C. 20535

DISTRIBUTION			
SANTA FE			
FILE			
U.S.G.S.			
LAND OFFICE			
TRANSPORTER	OIL		
	GAS		
OPERATOR			
PRORATION OFFICE			

NEW MEXICO OIL CONSERVATION COMMISSION
REQUEST FOR ALLOWABLE
AND
AUTHORIZATION TO TRANSPORT OIL AND NATURAL GAS

Form C-104
Supersedes Old C-104 and C-11
Effective 1-1-65

I. Operator
David Fasken
Address
608 First Natl. Bank Bldg., Midland, TX 79701
Reason(s) for filing (Check proper box)
New Well ☒ Change in Transporter of:
Recompletion ☐ Oil ☒ Dry Gas ☐
Change in Ownership ☐ Casinghead Gas ☐ Condensate ☐
Other (Please explain)
Amended report filed to show Texas-New Mexico Pipeline as transporter rather than P&O Falco as originally reported.
If change of ownership give name and address of previous owner

II. DESCRIPTION OF WELL AND LEASE

Lease Name Warren	Well No. 2	Pool Name, including Formation Midway (Devonian)	Kind of Lease State, Federal or Fee	Fee	Lease No. 17476
Location Unit Letter H ; 880 Feet From The East Line and 2200 Feet From The North Line of Section 8 Township 17-South Range 37-East , NMPM, Lea County					

III. DESIGNATION OF TRANSPORTER OF OIL AND NATURAL GAS

Name of Authorized Transporter of Oil <input checked="" type="checkbox"/> or Condensate <input type="checkbox"/> Texas-New Mexico Pipeline Company	Address (Give address to which approved copy of this form is to be sent) P.O. Box 2528, Hobbs, New Mexico 88240					
Name of Authorized Transporter of Casinghead Gas <input type="checkbox"/> or Dry Gas <input type="checkbox"/> None	Address (Give address to which approved copy of this form is to be sent)					
If well produces oil or liquids, give location of tanks.	Unit G	Sec. 8	Twp. 17-S	Rge. 37-E	Is gas actually connected? No	When

If this production is commingled with that from any other lease or pool, give commingling order number:

IV. COMPLETION DATA

Designate Type of Completion - (X)	Oil Well <input checked="" type="checkbox"/>	Gas Well <input type="checkbox"/>	New Well <input checked="" type="checkbox"/>	Workover <input type="checkbox"/>	Deepen <input type="checkbox"/>	Plug Back <input type="checkbox"/>	Same Res'v. <input type="checkbox"/>	Diff. Res'v. <input type="checkbox"/>
Date Spudded 8-16-80	Date Compl. Ready to Prod. 10-15-80		Total Depth 11,875'		P.B.T.D. 11,871'			
Elevations (DF, RKB, RT, GR, etc.) 3775.4' GR	Name of Producing Formation Devonian		Top Oil/Gas Pay 11,760'		Tubing Depth 95'			
Perforations 11,760'-11,794' 11,808'-11,850'					Depth Casing Shoe 11,875'			
TUBING, CASING, AND CEMENTING RECORD								
HOLE SIZE	CASING & TUBING SIZE		DEPTH SET		SACKS CEMENT			
17-1/2"	13-3/8"		378'		350			
12-1/4"	8-5/8"		4400'		1600			
7-7/8"	5-1/2"		11875'		1850			

V. TEST DATA AND REQUEST FOR ALLOWABLE OIL WELL

(Test must be after recovery of total volume of load oil and must be equal to or exceed top allowable for this depth or be for full 24 hours)

Date First New Oil Run To Tanks 10-27-80 (test allow)	Date of Test 12/11/80	Producing Method (Flow, pump, gas lift, etc.) Pump	
Length of Test 24	Tubing Pressure -0-	Casing Pressure -0-	Choke Size None
Actual Prod. During Test	Oil - Bbls. 223	Water - Bbls. 12	Gas - MCF -0-

GAS WELL

Actual Prod. Test - MCF/D	Length of Test	Bbls. Condensate/MMCF	Gravity of Condensate
Testing Method (pitot, back pr.)	Tubing Pressure (shut-in)	Casing Pressure (shut-in)	Choke Size

VI. CERTIFICATE OF COMPLIANCE

I hereby certify that the rules and regulations of the Oil Conservation Commission have been complied with and that the information given above is true and complete to the best of my knowledge and belief.

Charles E Mobley
(Signature)
Charles E. Mobley, Agent
(Title)
August 30, 1983
(Date)

OIL CONSERVATION COMMISSION

APPROVED SEP 1 1983, 19
BY ORIGINAL SIGNED BY JERRY SEXTON
DISTRICT SUPERVISOR
TITLE

This form is to be filed in compliance with RULE 1104.
If this is a request for allowable for a newly drilled or deepened well, this form must be accompanied by a tabulation of the deviation tests taken on the well in accordance with RULE 111.
All sections of this form must be filled out completely for allowable on new and recompleted wells.
Fill out only Sections I, II, III, and VI for changes of owner, well name or number, or transporter, or other such change of condition.
Separate Forms C-104 must be filed for each pool in multiple