

30-025-26755

NO. OF COPIES RECEIVED	
DISTRIBUTION	
SANTA FE	
FILE	
U.S.G.S.	
LAND OFFICE	
OPERATOR	

NEW MEXICO OIL CONSERVATION COMMISSION

Form C-101
Revised 1-1-65

5A. Indicate Type of Lease
STATE <input checked="" type="checkbox"/> FEE <input type="checkbox"/>
5. State Oil & Gas Lease No.
L-5391

APPLICATION FOR PERMIT TO DRILL, DEEPEN, OR PLUG BACK

1a. Type of Work		7. Unit Agreement Name	
b. Type of Well OIL WELL <input checked="" type="checkbox"/> GAS WELL <input type="checkbox"/> OTHER <input type="checkbox"/>		State ZZ Com	
DRILL <input checked="" type="checkbox"/> DEEPEN <input type="checkbox"/> PLUG BACK <input type="checkbox"/>		8. Farm or Lease Name	
2. Name of Operator		9. Well No.	
Mobil Producing TX. & N.M. Inc.		1	
3. Address of Operator		10. Field and Pool or Wholly	
Nine Greenway Plaza, Suite 2700; Houston, Texas 77046		UNDESIGNATED Vacuum Middle Penn	
4. Location of Well		12. County	
UNIT LETTER <u>F</u> LOCATED <u>1980</u> FEET FROM THE <u>North</u> LINE		Lea	
AND <u>1770</u> FEET FROM THE <u>West</u> LINE OF SEC. <u>7</u> TWP. <u>17-S</u> RGE. <u>35-E</u> NMPN			
19. Proposed Depth		19A. Formation	20. Rotary or C.T.
11,000'		Middle Pennsylvanian	Rotary
21. Elevations (Show whether DF, RT, etc.)		22. Approx. Date Work will start	
4007.5 - Ground		As soon as possible	
21A. Kind & Status Plug. Bond		21B. Drilling Contractor	
On File		Unknown	

PROPOSED CASING AND CEMENT PROGRAM

SIZE OF HOLE	SIZE OF CASING	WEIGHT PER FOOT	SETTING DEPTH	SACKS OF CEMENT	EST. TOP
17½"	13-3/8"	48# H-90	0 - 350'	Circulate	Surface
12½"	9-5/8"	36# & 40# J-55	0-5000'	200 sx	Surface
8-3/4"	7" (liner)	23# S-95	4800-10900'	Circulate over top of liner	4800'

Blowout Preventers: Power or Manually Actuated

Casing String	Equipment Size	API x Series	Number and Type	Test Press. psi
Surface	10"	x 600	1 Hydril	1000
Int.	8"	x 1500	1 Blank & 1 pipe ram & 1 Hydril	5000

 APPROVAL VALID FOR 180 DAYS
 PERMIT EXPIRES 8/6/81
 UNLESS DRILLING UNDERWAY

NOTE: This is a resubmittal of Application for Permit to Drill.
 Original permit was granted July 23, 1980, and expired October 23, 1980.

IN ABOVE SPACE DESCRIBE PROPOSED PROGRAM: IF PROPOSAL IS TO DEEPEN OR PLUG BACK, GIVE DATA ON PRESENT PRODUCTIVE ZONE AND PROPOSED NEW PRODUCTIVE ZONE. GIVE BLOWOUT PREVENTER PROGRAM, IF ANY.

I hereby certify that the information above is true and complete to the best of my knowledge and belief.

Signed A. D. Bond A. D. Bond Title Regulatory Engineering Coordinator Date January 22, 1981

(This space for State Use)

APPROVED BY Jeslin H. Clement TITLE OIL & GAS INSPECTOR DATE FEB 6 1981
 CONDITIONS OF APPROVAL, IF ANY:

NEW MEXICO OIL CONSERVATION COMMISSION
WELL LOCATION AND ACREAGE DEDICATION PLAT

Form C-102
Supersedes C-108
Effective 1-1-83

All distances must be from the outer boundaries of the Section

Operator Mobil Producing TX. & N.M. Inc.			Lease State ZZ Com		Well No. 1
Unit Letter F	Section 7	Township 17-S	Range 35-E	County Lea	
Actual Footage Location of Well: 1980 feet from the North line and 1770 feet from the West line					
Ground Level Elev. 4007.5	Producing Formation Middle Pennsylvanian		Pool UNDERSIGNED		Dedicated Acreage: 40-80 Acres

- Outline the acreage dedicated to the subject well by colored pencil or hatchure marks on the plat below.
- If more than one lease is dedicated to the well, outline each and identify the ownership thereof (both as to working interest and royalty).
- If more than one lease of different ownership is dedicated to the well, have the interests of all owners been consolidated by communitization, unitization, force-pooling, etc?

☒ Yes ☐ No If answer is "yes," type of consolidation Communitization Pending

If answer is "no," list the owners and tract descriptions which have actually been consolidated. (Use reverse side of this form if necessary.)

No allowable will be assigned to the well until all interests have been consolidated (by communitization, unitization, forced-pooling, or otherwise) or until a non-standard unit, eliminating such interests, has been approved by the Commission. S89° 32'E - 2575.0'

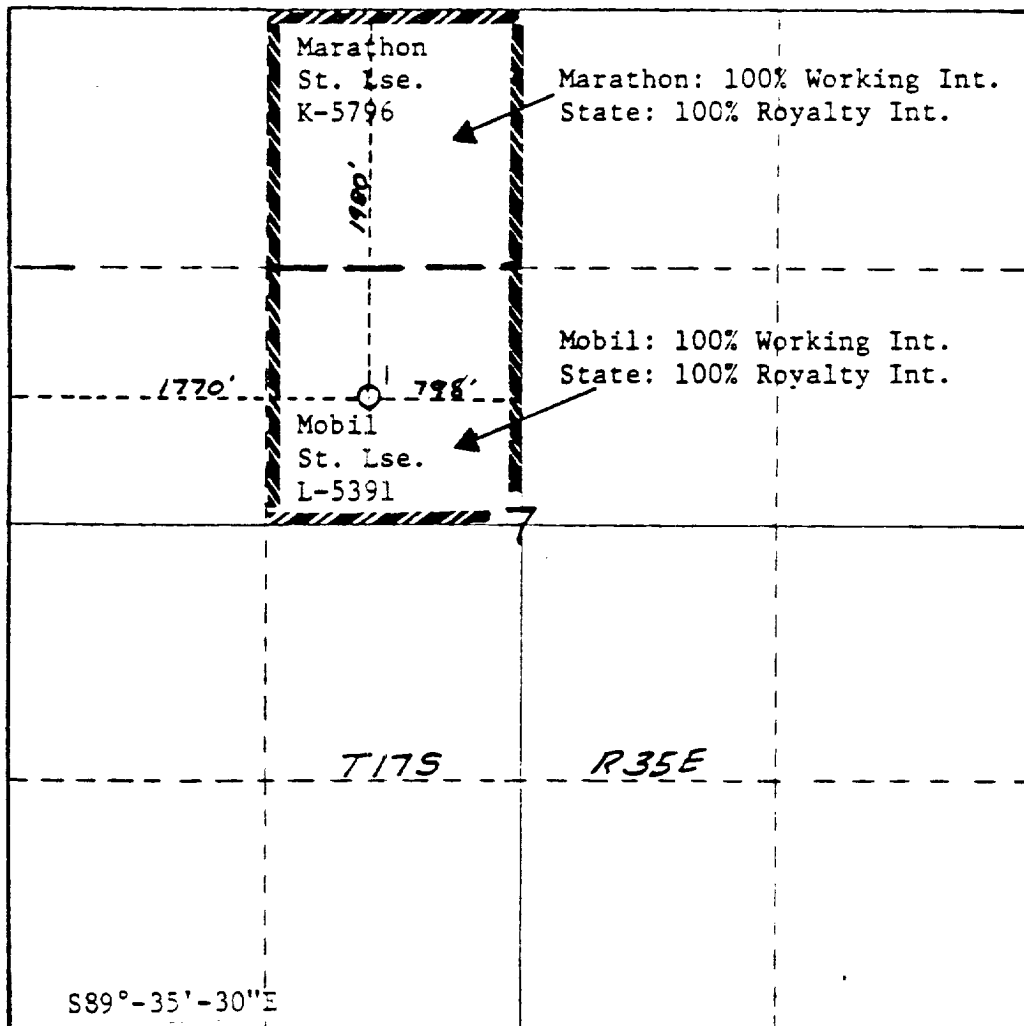

CERTIFICATION

I hereby certify that the information contained herein is true and complete to the best of my knowledge and belief.

Name
A. D. Bond
Position **Regulatory Engineering Coordinator II**
Company **Mobil Producing TX. & N.M. Inc.**
Date
January 22, 1981

I hereby certify that the well location shown on this plat was plotted from field notes for actual surveys made by me or under my supervision, and that the same is true and correct to the best of my knowledge and belief.

H. A. Carson, Jr.
Date Surveyed
June 27, 1980
Registered Professional Engineer and/or Land Surveyor

H. A. Carson, Jr.
Certificate No.

5063