

30-025-26955

NO. OF COPIES RECEIVED	
DISTRIBUTION	
SANTA FE	
FILE	
U.S.G.S.	
LAND OFFICE	
OPERATOR	

NEW MEXICO OIL CONSERVATION COMMISSION

Form C-101
Revised 1-1-65

5A. Indicate Type of Lease STATE <input checked="" type="checkbox"/> FEE <input type="checkbox"/>
5. State Oil & Gas Lease No. L-5391
7. Unit Agreement Name State ZZ Com
8. Farm or Lease Name
9. Well No. 1
10. Field and Pool, or Wildcat Undesignated
12. County Lea
19. Proposed Depth 11,000'
19A. Formation Middle Pennsylvanian
20. Rotary or C.T. Rotary
21. Elevations (Show whether DF, RT, etc.) 4007.5 - Ground
21A. Kind & Status Plug. Bond On File
21B. Drilling Contractor Unknown
22. Approx. Date Work will start As soon as possible

APPLICATION FOR PERMIT TO DRILL, DEEPEN, OR PLUG BACK

1a. Type of Work b. Type of Well OIL WELL <input checked="" type="checkbox"/> GAS WELL <input type="checkbox"/> OTHER <input type="checkbox"/> DRILL <input checked="" type="checkbox"/> DEEPEN <input type="checkbox"/> PLUG BACK <input type="checkbox"/> SINGLE ZONE <input checked="" type="checkbox"/> MULTIPLE ZONE <input type="checkbox"/>	2. Name of Operator Mobil Producing TX. & N.M. Inc.	3. Address of Operator Nine Greenway Plaza, Suite 2700; Houston, Texas 77046	4. Location of Well UNIT LETTER F LOCATED 1980 FEET FROM THE North LINE AND 1770 FEET FROM THE West LINE OF SEC. 7 TWP. 17-S RGE. 35-E NMPM
--	--	---	---

PROPOSED CASING AND CEMENT PROGRAM

SIZE OF HOLE	SIZE OF CASING	WEIGHT PER FOOT	SETTING DEPTH	SACKS OF CEMENT	EST. TOP
17 1/2"	13-3/8"	48# H-90	0-350'	Circulate	Surface
12 1/2"	9-5/8"	36# & 40# J-55	0-5000'	200 sx	Surface
8-3/4"	7" (liner)	23# S-95	4800-10900'	Circulate over top of liner	4800'

Blowout Preventers: Power or Manually Actuated

Casing String	Equipment Size	API x Series	Number and Type	Test Press. psi
Surface	10"	x 600	1 Hydril	1000
Int.	8"	x 1500	1 Blank & 1 pipe ram & 1 Hydril	5000

APPROVAL VALID FOR 90 DAYS UNLESS DRILLING COMMENCED,

THE COMMISSION MUST BE NOTIFIED 24 HOURS PRIOR TO COMMENCING WORK

EXPIRES 10/23/80

IN ABOVE SPACE DESCRIBE PROPOSED PROGRAM: IF PROPOSAL IS TO DEEPEN OR PLUG BACK, GIVE DATA ON PRESENT PRODUCTIVE ZONE AND PROPOSED NEW PRODUCTIVE ZONE. GIVE BLOWOUT PREVENTER PROGRAM, IF ANY.

I hereby certify that the information above is true and complete to the best of my knowledge and belief.

Signed A. D. Bond A. D. Bond Title Regulatory Engineering Coordinator Date July 14, 1980

(This space for State Use)

APPROVED BY John W. Runyan TITLE Geologist DATE JUL 23 1980

CONDITIONS OF APPROVAL, IF ANY:

RECEIVED

JUL 22 1980

OIL CONSERVATION DIV.

N MEXICO OIL CONSERVATION COMMIS. N
WELL LOCATION AND ACREAGE DEDICATION PLAT

Form C-102
Supersedes C-128
Effective 1-1-65

All distances must be from the outer boundaries of the Section.

Operator Mobil Producing TX. & N.M. Inc.			Lease State ZZ Com		Well No. 1
Unit Letter F	Section 7	Township 17-S	Range 35-E	County Lea	
Actual Footage Location of Well: 1980 feet from the North line and 1770 feet from the West line					
Ground Level Elev. 4007.5	Producing Formation Middle Pennsylvanian	Pool Undesignated		Dedicated Acreage: 1/80 Acres	

1. Outline the acreage dedicated to the subject well by colored pencil or hachure marks on the plat below.
2. If more than one lease is dedicated to the well, outline each and identify the ownership thereof (both as to working interest and royalty).
3. If more than one lease of different ownership is dedicated to the well, have the interests of all owners been consolidated by communitization, unitization, force-pooling, etc?

☒ Yes ☐ No If answer is "yes," type of consolidation: Communitization Pending

If answer is "no," list the owners and tract descriptions which have actually been consolidated. (Use reverse side of this form if necessary.)

No allowable will be assigned to the well until all interests have been consolidated (by communitization, unitization, forced-pooling, or otherwise) or until a non-standard unit, eliminating such interests, has been approved by the Commission. S89° 32'E - 2575.0'

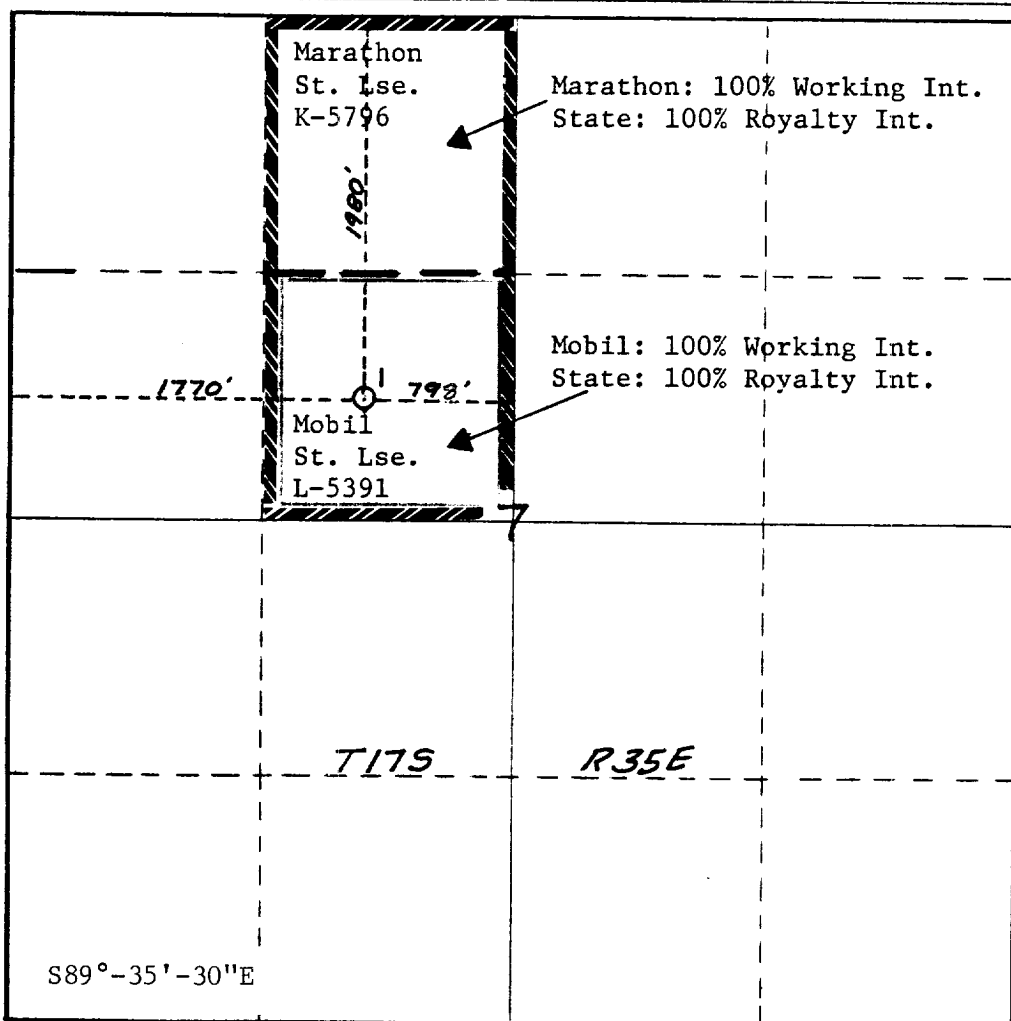

CERTIFICATION

I hereby certify that the information contained herein is true and complete to the best of my knowledge and belief.

A. D. Bond
Name
A. D. Bond
Position Regulatory Engineering Coordinator II
Company Mobil Producing TX. & N.M. Inc.
Date
July 14, 1980

I hereby certify that the well location shown on this plat was plotted from field notes of actual surveys made by me or under my supervision, and that the same is true and correct to the best of my knowledge and belief.

H. A. Carson, Jr.
Date Surveyed
June 27, 1980
Registered Professional Engineer and/or Land Surveyor
H. A. Carson, Jr.
Certificate No.
5063

N. 0°-01'-30" E. 2647.6'



RECEIVED

JUL 22 1980

OIL CONSERVATION DIV.