

mit to Appropriate
trict Office
e Lease - 4 copies
Lease - 3 copies

State of New Mexico
Energy, Minerals and Natural Resources Department

Form C-102
Revised 1-1-89

OIL CONSERVATION DIVISION

P.O. Box 2088
Santa Fe, New Mexico 87504-2088

TRICT I
Box 1980, Hobbs, NM 88240

TRICT II
Drawer DD, Artesia, NM 88210

TRICT III
0 Rio Brazos Rd., Aztec, NM 87410

WELL LOCATION AND ACREAGE DEDICATION PLAT

All Distances must be from the outer boundaries of the section

Operator JFG Enterprise			Lease Tonto State		Well No. 1
Section Letter J	Section 32	Township 19S	Range 33E	County NMPM	County Lea
Well Footage Location of Well:					
1980 feet from the South line and		2200 feet from the East line			
Ground level Elev. 3569.5	Producing Formation Bone Springs		Pool Wildcat Gem Bone Spring	Dedicated Acreage: 40 Acres	

1. Outline the acreage dedicated to the subject well by colored pencil or hachure marks on the plat below.

2. If more than one lease is dedicated to the well, outline each and identify the ownership thereof (both as to working interest and royalty).

3. If more than one lease of different ownership is dedicated to the well, have the interest of all owners been consolidated by communitization, unitization, force-pooling, etc.?

☐ Yes

☒ No

If answer is "yes" type of consolidation only one lease 46.3230

If answer is "no" list the owners and tract descriptions which have actually been consolidated. (Use reverse side of this form if necessary.)

No allowable will be assigned to the well until all interests have been consolidated (by communitization, unitization, forced-pooling, or otherwise) or until a non-standard unit, eliminating such interest, has been approved by the Division.

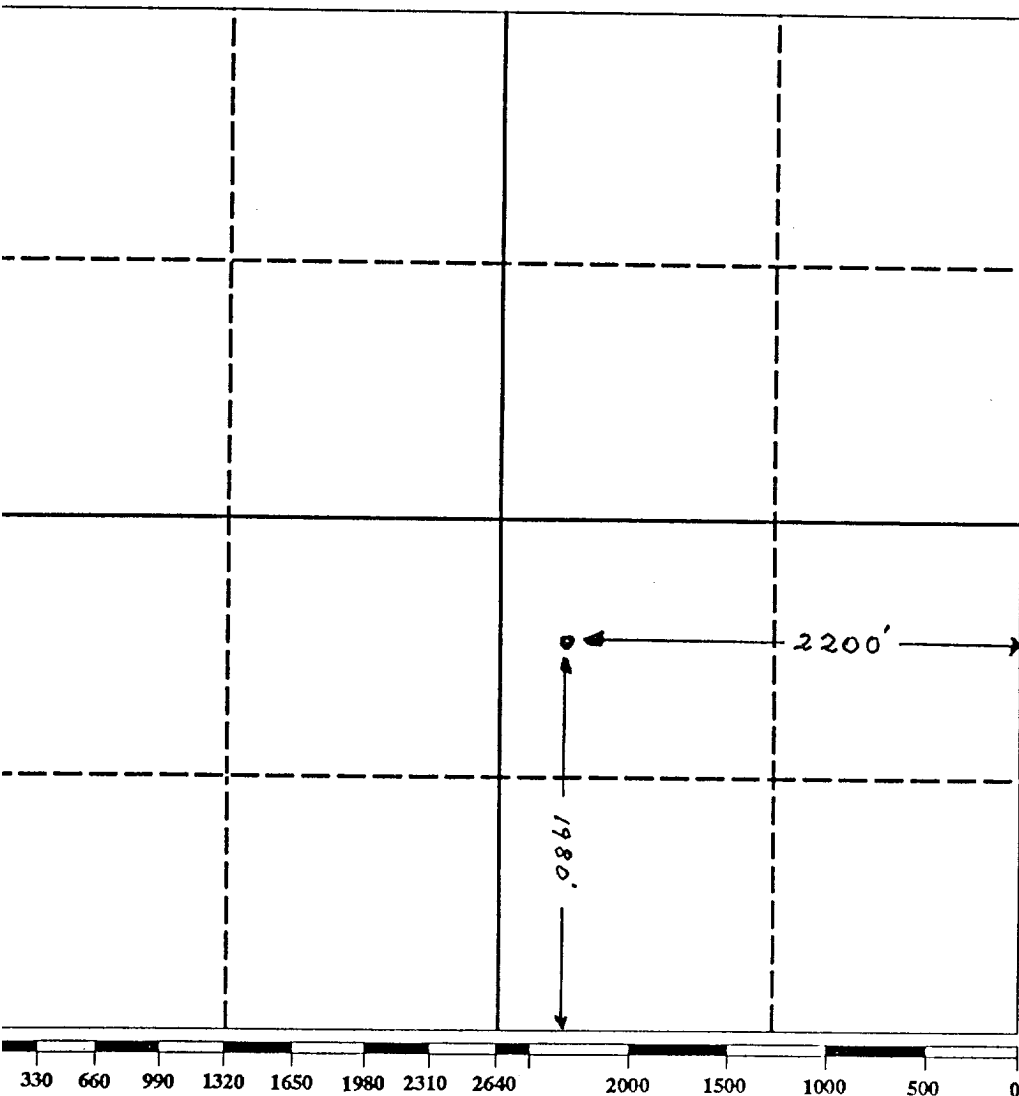

OPERATOR CERTIFICATION

I hereby certify that the information contained herein is true and complete to the best of my knowledge and belief.

Signature

James E. Gray

Printed Name

Partner

Position

JFG Enterprise

Company

January 29, 1990

Date

SURVEYOR CERTIFICATION

I hereby certify that the well location shown on this plat was plotted from field notes of actual surveys made by me or under my supervision, and that the same is true and correct to the best of my knowledge and belief.

July 31, 1980

Date Surveyed

John W. West-676

Ronald J. Eidson- 3279

Signature & Seal of
Professional Surveyor

Internorth Inc.

dated 8/8/80

See original survey
Certificate No.