

N MEXICO OIL CONSERVATION COMMISSION
WELL LOCATION AND ACREAGE DEDICATION PLAT

Form C-102
Supersedes C-128
Effective 1-1-65

All distances must be from the outer boundaries of the Section.

Operator INTERNORTH, INC.			Lease TONTO STATE COM.			Well No. 1		
Unit Letter J	Section 32	Township 19 SOUTH	Range 33 EAST	County LEA				
Actual Footage Location of Well: 1,980 feet from the SOUTH line and 2,200 feet from the EAST line								
Ground Level Elev. 3569.5	Producing Formation MORROW		Pool GEM (MORROW)			Dedicated Acreage: 320 Acres		

1. Outline the acreage dedicated to the subject well by colored pencil or hachure marks on the plat below.
2. If more than one lease is dedicated to the well, outline each and identify the ownership thereof (both as to working interest and royalty).
3. If more than one lease of different ownership is dedicated to the well, have the interests of all owners been consolidated by communitization, unitization, force-pooling, etc?

☐ Yes ☐ No If answer is "yes," type of consolidation COMMUNITIZATION

If answer is "no," list the owners and tract descriptions which have actually been consolidated. (Use reverse side of this form if necessary.) _____

No allowable will be assigned to the well until all interests have been consolidated (by communitization, unitization, forced-pooling, or otherwise) or until a non-standard unit, eliminating such interests, has been approved by the Commission.

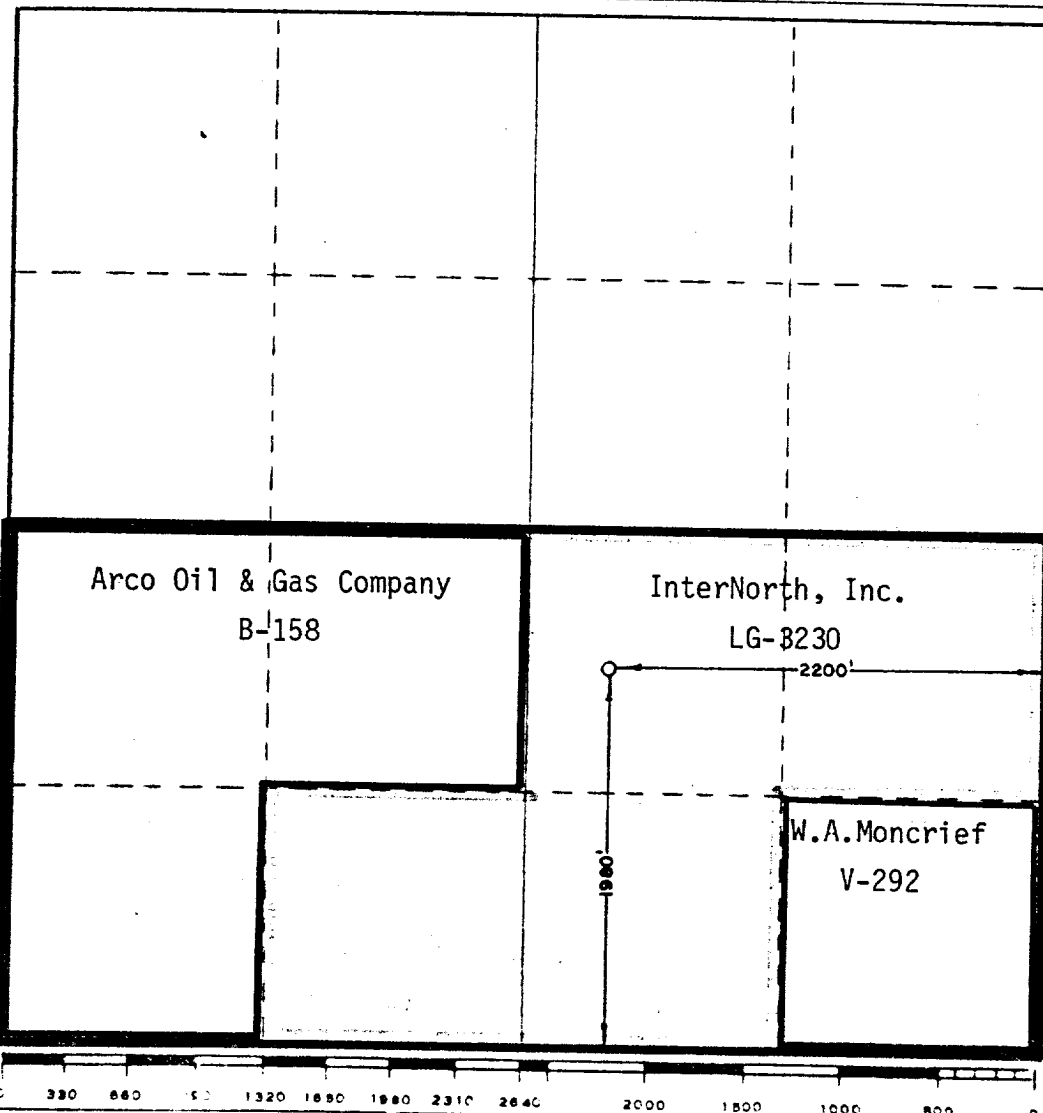

CERTIFICATION	
I hereby certify that the information contained herein is true and complete to the best of my knowledge and belief.	
<i>E. H. Hunt</i>	
Name	District Engineer
Position	InterNorth, Inc.
Company	4-24-81
Date	
I hereby certify that the well location shown on this plat was plotted from field notes of actual surveys made by me or under my supervision, and that the same is true and correct to the best of my knowledge and belief.	
Date	JULY 31ST, 1980
Registered Professional Engineer and a Land Surveyor	
Certificate No.	676
Ronald J. Eidson	