

36-025-26998

NO. OF COPIES RECEIVED	
DISTRIBUTION	
SANTA FE	
FILE	
U.S.G.S.	
LAND OFFICE	
OPERATOR	

NEW MEXICO OIL CONSERVATION COMMISSION

Form C-101
Revised 1-1-65

5A. Indicate Type of Lease
STATE <input checked="" type="checkbox"/> FEE <input type="checkbox"/>

5. State Oil & Gas Lease No.
B-2519

API NO.

APPLICATION FOR PERMIT TO DRILL, DEEPEN, OR PLUG BACK

1a. Type of Work		7. Unit Agreement Name	
b. Type of Well DRILL <input checked="" type="checkbox"/> DEEPEN <input type="checkbox"/> PLUG BACK <input type="checkbox"/>		East Vacuum Gb/SA Unit	
OIL WELL <input checked="" type="checkbox"/> GAS WELL <input type="checkbox"/> OTHER <input type="checkbox"/>		8. Farm or Lease Name	
SINGLE ZONE <input checked="" type="checkbox"/> MULTIPLE ZONE <input type="checkbox"/>		East Vacuum Gb/SA Unit, Tract 3467	
2. Name of Operator		9. Well No.	
Phillips Petroleum Company		002	
3. Address of Operator		10. Field and Pool, or Wildcat	
Room 401, 4001 Penbrook St., Odessa, Texas 79762		Vacuum Gb/SA	
4. Location of Well		12. County	
UNIT LETTER <u>H</u> LOCATED <u>2300</u> FEET FROM THE <u>North</u> LINE		Lea	
AND <u>1250</u> FEET FROM THE <u>East</u> LINE OF SEC. <u>34</u> TWP. <u>17-S</u> RGE. <u>35-E</u> NMPM			
19. Proposed Depth		19A. Formation	20. Rotary or C.T.
4800'		Gb/SA	Rotary
21. Elevations (Show whether DE, RT, etc.)	21A. Kind & Status Plug, Bond	21B. Drilling Contractor	22. Approx. Date Work will start
Ground 3923.0'	blanket	Advise later	Upon approval

PROPOSED CASING AND CEMENT PROGRAM

SIZE OF HOLE	SIZE OF CASING	WEIGHT PER FOOT	SETTING DEPTH	SACKS OF CEMENT	EST. TOP
11"	8-5/8"	24#, K-55	350' (Sufficient quantity of C1 H w/2% CaCl)		
7-7/8"	5-1/2"	14#, K-55	4800' (1/4# Flocele/sx in 1st 150 sxs) circ to surface (Suff. TRLW w/12# salt/sx w/10% DD) (and 1/4# /sx Flocele plus 3# Gil-) (sonite/sx followed by 260 sxs C1) (H cmt w/8# salt/sx to circ to surf)		

(This well is in the same proration unit as Well No. 044.)

Reference NSL. (Applied for by separate letter dated 8-13-80.)

Use mud additives as required for control.

BOP: Series 900, 3000# WP, double w/one set pipe rams and one set blind rams.

APPROVAL VALID
FOR 90 DAYS UNLESS
DRILLING COMMENCED,EXPIRES 11/28/80

NSL-1257

IN ABOVE SPACE DESCRIBE PROPOSED PROGRAM: IF PROPOSAL IS TO DEEPEN OR PLUG BACK, GIVE DATA ON PRESENT PRODUCTIVE ZONE AND PROPOSED NEW PRODUCTIVE ZONE. GIVE BLOWOUT PREVENTER PROGRAM, IF ANY.

I hereby certify that the information above is true and complete to the best of my knowledge and belief.

Signature W. J. Mueller Title Sr. Engineering Specialist Date August 13, 1980
 (This space for State Use)

APPROVED BY [Signature] TITLE BOPM - [Signature] DATE Aug 26 1980
 CONDITIONS OF APPROVAL, IF ANY:

NEW MEXICO OIL CONSERVATION COMMISSION
WELL LOCATION AND ACREAGE DEDICATION PLAT

Form C-102
Supersedes C-128
Effective 1-1-65

All distances must be from the outer boundaries of the Section

Operator Phillips Petroleum Co.			Lease EVGSAU, Tr 3467			Well No. 002		
Section H	Section 34	Township 17 South	Range 35 East	County Lea				
Actual Wellbore Location of Well: 2300 feet from the North line and 1250 feet from the East line								
Ground Level Elev. 3923.0	Producing Formation Gb/SA		Pool Vacuum Gb/SA			Depth from Surface 40		

(unprepared)

- Outline the acreage dedicated to the subject well by colored pencil or hachure marks on the plat below.
- If more than one lease is dedicated to the well, outline each and identify the ownership thereof (both as to working interest and royalty).
- If more than one lease of different ownership is dedicated to the well, have the interests of all owners been consolidated by communitization, unitization, force-pooling, etc?

☐ Yes ☐ No If answer is "yes," type of consolidation _____

If answer is "no," list the owners and tract descriptions which have actually been consolidated. (Use reverse side of this form if necessary.) _____

No allowable will be assigned to the well until all interests have been consolidated (by communitization, unitization, forced-pooling, or otherwise) or until a non-standard unit, eliminating such interests, has been approved by the Commission.

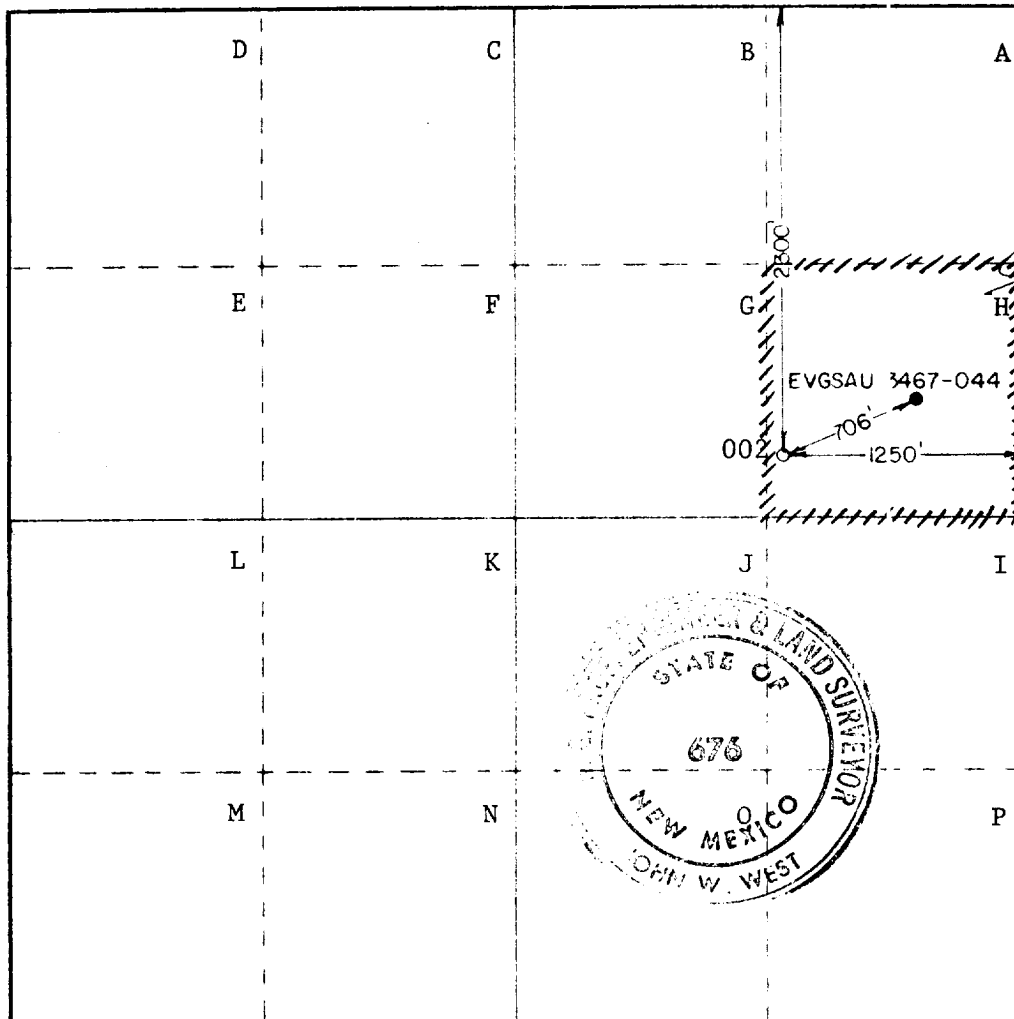

CERTIFICATION

I hereby certify that the information contained herein is true and complete to the best of my knowledge and belief

W. J. Mueller

W. J. Mueller

Sr. Engineering Specialist

Phillips Petroleum Company

August 13, 1980

I hereby certify that the well location shown on this plat was plotted from field notes of actual surveys made by me or under my supervision, and that the same is true and correct to the best of my knowledge and belief

June 19, 1980

Registered Professional Engineer
and Licensed Surveyor

John W. West

Certificate No. **JOHN W. WEST 878**
PATRICK A. ROMERO 6663
Ronald J. Eidson 3239

DOUBLE PREVENTER OPTION

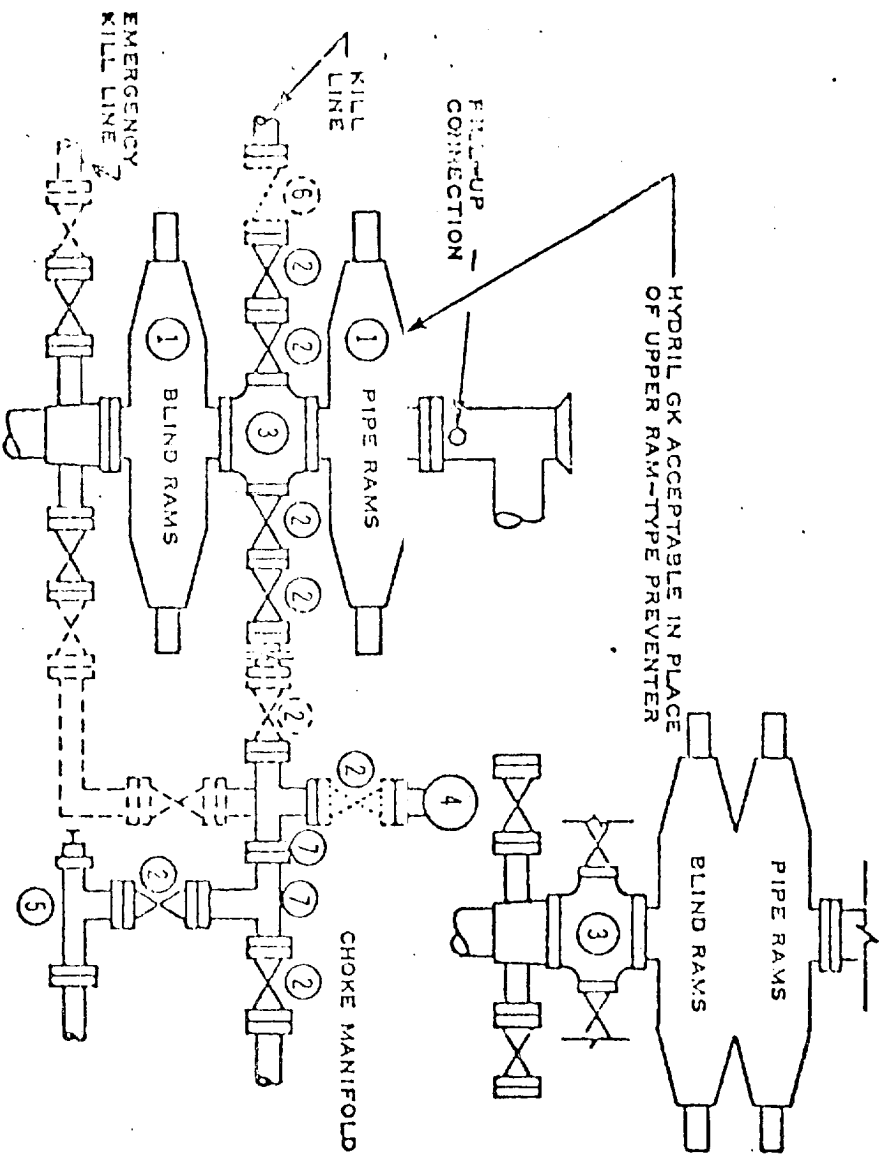

- ① SERIES 900 RAM-TYPE BOP
- ② 2" SERIES 900 VALVE
- ③ SERIES 900 DRILLING SPOOL
- ④ 2" MUD PRESSURE GAUGE
- ⑤ 2" SERIES 900 CHOKE
- ⑥ 2" SERIES 900 CHECK VALVE
- ⑦ 2" SERIES 900 STEEL TEE

NOTES:

1. 3000 PSI WP CLAMP HUBS MAY BE SUBSTITUTED FOR FLANGES
2. VALVES MAY BE EITHER HAND OR POWER OPERATED BUT, IF POWER OPERATED, THE VALVES FLANGED TO THE BOP RUN MUST BE CAPABLE OF BEING OPENED AND CLOSED MANUALLY OR CLOSE ON POWER FAILURE AND BE CAPABLE OF BEING OPENED MANUALLY

..... OPTIONAL EQUIPMENT

PHILLIPS PETROLEUM COMPANY

3000 PSI WORKING PRESSURE
BLOWOUT PREVENTER HOOK-UP
(SERIES 900 FLANGES OR BETTER)

RECEIVED

AUG 15 1980

U.S. CONSERVATION DIV.

