

NO. OF COPIES RECEIVED	
DISTRIBUTION	
SANTA FE	
FILE	
U.S.G.S.	
LAND OFFICE	
OPERATOR	

NEW MEXICO OIL CONSERVATION COMMISSION

Form C-101
Revised 1-1-65

5A. Indicate Type of Lease	
STATE <input checked="" type="checkbox"/> XX	FEE <input type="checkbox"/>
5. State Oil & Gas Lease No.	
A-4096	

APPLICATION FOR PERMIT TO DRILL, DEEPEN, OR PLUG BACK

1a. Type of Work		7. Unit Agreement Name	
b. Type of Well OIL WELL <input checked="" type="checkbox"/> GAS WELL <input type="checkbox"/> OTHER <input type="checkbox"/>		8. Farm or Lease Name	
DEEPEN <input type="checkbox"/> PLUG BACK <input checked="" type="checkbox"/>		Scharb "4"	
SINGLE ZONE <input checked="" type="checkbox"/> MULTIPLE ZONE <input type="checkbox"/>		9. Well No.	
2. Name of Operator		2	
Southland Royalty Company		10. Field and Pool, or Wildcat	
3. Address of Operator		Scharb	
21 Desta Drive, Midland, Texas 79705		Wildcat (Bone Spring Sand)	
4. Location of Well		12. County	
UNIT LETTER F LOCATED 1980 FEET FROM THE North LINE		Lea	
AND 1980 FEET FROM THE West LINE OF SEC. 4 TWP. 19S RGE. 35E NMPM			
		19. Proposed Depth	
		10,740'	
		19A. Formation	
		Bone Spring Sand	
		20. Rotary or C.T.	
		NA	
21. Elevations (Show whether DF, RT, etc.)		22. Approx. Date Work will start	
3911' GR		10-12-88	

PROPOSED CASING AND CEMENT PROGRAM

SIZE OF HOLE	SIZE OF CASING	WEIGHT PER FOOT	SETTING DEPTH	SACKS OF CEMENT	EST. TOP
15"	11 3/4"	42#	410'	400 sx.	Circ.
11"	8 5/8"	24 & 28#	4000'	1825 sx.	Circ.
7 7/8"	5 1/2"	15.5 & 17#	10,740'	800 sx.	TOC @ 8100'

- MIRU PU. ND pmp tea. NU BOP. Rlse TAC & POH w/tbg.
- MIRU WL unit. RIH w/gauge ring & junk basket for 5 1/2" csg to +10,500'. POH. RIH w/5 1/2" CIBP & set @ +10,500'. POH. RIH w/dump bailer & cap CIPB w/35' cmt. POH. Load 8 5/8" x 5 1/2" annulus & press test csg to 4000#. RIH w/4" select fire csg gun & perf Bone Spring Sand @ 9323', 30', 34', 37', 41', 43', 46', 48', 50', 58', 60', 64', 67', 70', 72', 76' 82' & 90' for a total of 18 holes. POH. RDMO WL unit.
- RIH w/5 1/2" treating pkr, SN & 2 3/8" tbg. Set pkr @ +9200' & swb well dwn to SN if possible.
- MIRU stimulation company. NU surf lines & test to 4000#. Place, monitor & maintain 500# on the csg-tbg annulus. Pmp 2000 gals 7 1/2% NEFE HCl. Space out 36- 7/8" RCNBS throught job. Displ acid with 38 bbls of 2% KCl wtr. If ballout occurs, surge balls of perfs & continue displ. Rlse pkr & drop dwn to +9400' to assure balls are off perfs. Pull up to +9200' & set pkr. Load & test annulus to 500#. NU flw meter & gate valve. Pmp 150 bbls 2% KCl wtr.
- Swb test well recording rates & cuts.

-----OVER-----

IN ABOVE SPACE DESCRIBE PROPOSED PROGRAM; IF PROPOSAL IS TO DEEPEN OR PLUG BACK, GIVE DATA ON PRESENT PRODUCTIVE ZONE AND PROPOSED NEW PRODUCTIVE ZONE. GIVE BLOWOUT PREVENTER PROGRAM, IF ANY.

I hereby certify that the information above is true and complete to the best of my knowledge and belief.

Signed Paul Kautz Title Operations Tech III Date 9/28/88

(This space for State Use)
Orig. Signed by
Paul Kautz
Geologist

APPROVED BY _____ TITLE _____ DATE _____

CONDITIONS OF APPROVAL, IF ANY:

NSP 1555
NSP 1554

SEP 30 1988

6. If fluid entry is limited, rlse pkr run thru perfs & POH w/tbg. MIRU stimulation company. NU surf lines & test to 6000#. Pmp 31,000 gals of 40# crosslinked gel w/66,000# 16/30 mesh PRC sand to frac the First Bone Spring Sand dwn 5 1/2" csg. RDMO stimulation company. Shut well in overnight to allow gels to break.
7. Flw well back starting at +16/64" ck increasing size as the press depletes. Obtain flw back fluid & have analyzed.
8. RIH w/notched collar on 2 7/8" tbg & clean out any fill to +9500'. POH.
9. RIH w/prod tbg. ND BOP. NU pmp tee. RIH w/pmp & rods. Set Lufkin 456 pmpg unit & put well on pmp. Pmp depth will be lowered to +9450' after clean up period.

RECEIVED

SEP 11 1979

MEXICO OIL CONSERVATION COMMISSION
WELL LOCATION AND ACREAGE DEDICATION PLAT

Form C-102
Supersedes C-128
Effective 1-1-65

All distances must be from the outer boundaries of the Section.

Operator Southland Royalty Co.		Lease Scharb 4		Well No. 2
Unit Letter F	Section 4	Township 19 South	Range 35 East	County Lea
Actual Footage Location of Well: 1980 feet from the North line and 1980 feet from the West line				
Ground Level Elev. 3911.0	Producing Formation Bone Spring Sand	Pool Wildcat	Dedicated Acreage: 40 Acres	

1. Outline the acreage dedicated to the subject well by colored pencil or hachure marks on the plat below.
2. If more than one lease is dedicated to the well, outline each and identify the ownership thereof (both as to working interest and royalty).
3. If more than one lease of different ownership is dedicated to the well, have the interests of all owners been consolidated by communitization, unitization, force-pooling, etc?

☐ Yes ☐ No If answer is "yes," type of consolidation _____

If answer is "no," list the owners and tract descriptions which have actually been consolidated. (Use reverse side of this form if necessary.) _____

No allowable will be assigned to the well until all interests have been consolidated (by communitization, unitization, forced-pooling, or otherwise) or until a non-standard unit, eliminating such interests, has been approved by the Commission.

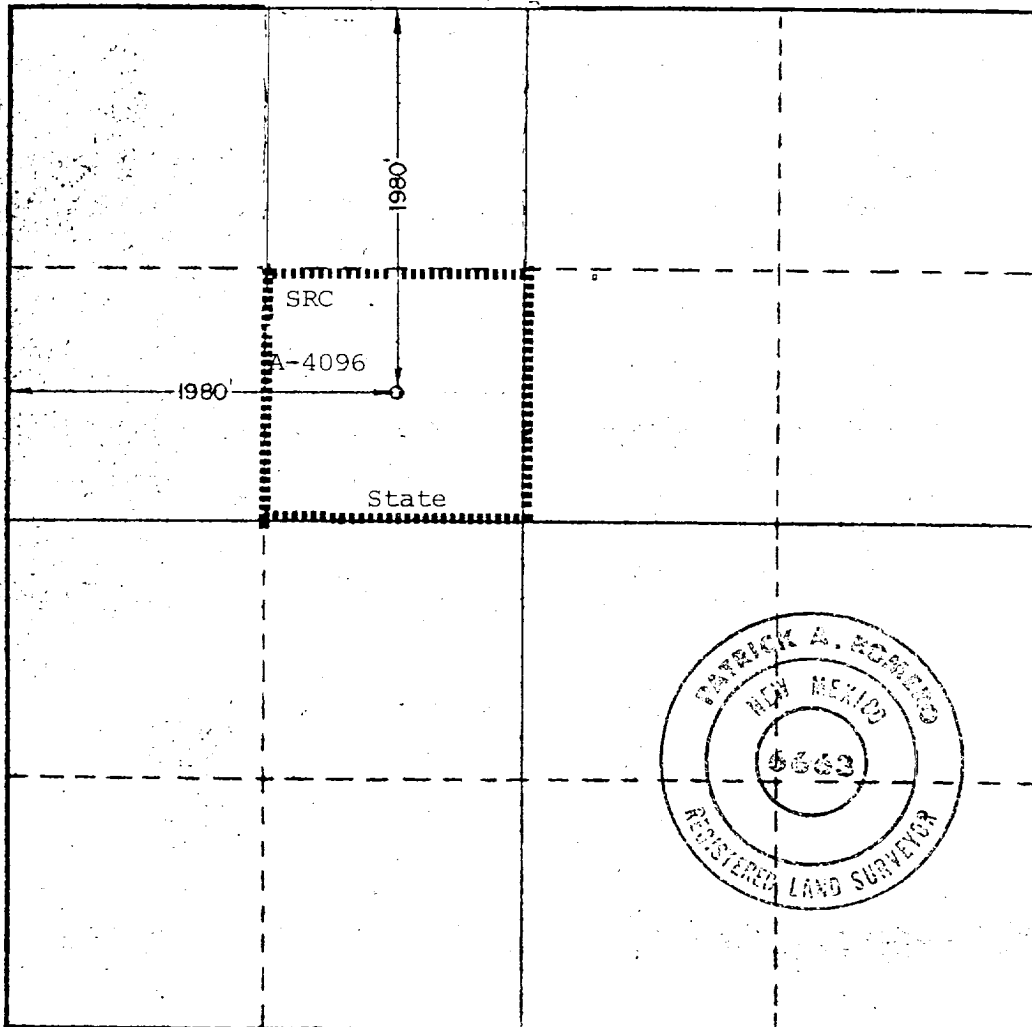

CERTIFICATION

I hereby certify that the information contained herein is true and complete to the best of my knowledge and belief.

Name
Cathy Nokes
Position
Operations Tech III
Company
Southland Royalty Company

Date
9-28-88

I hereby certify that the well location shown on this plat was plotted from field notes of actual surveys made by me or under my supervision, and that the same is true and correct to the best of my knowledge and belief.

Date Surveyed
September 11, 1980

Registered Professional Engineer and/or Land Surveyor

Patrick A. Romero
Certificate No. **JOHN W. WEST 878**
PATRICK A. ROMERO 6643
Ronald J. Eldson 3239

