

MEXICO OIL CONSERVATION COMM'S
WELL LOCATION AND ACREAGE DEDICATION PLAT

Form C-102
 Supersedes C-128
 Effective 1-1-65

All distances must be from the outer boundaries of the Section.

Operator Aminoil USA, Inc.			Lease Fed. 30		Well No. 1
Unit Letter 1	Section 30	Township 19 South	Range 33 East	County Lea	
Actual Footage Location of Well: 1980 feet from the South line and 760 feet from the East line					
Ground Level Elev. 3585.6	Producing Formation MORROW	Pool LEM NARROW		Dedicated Acreage: 320 Acres	

1. Outline the acreage dedicated to the subject well by colored pencil or hatchure marks on the plat below.
2. If more than one lease is dedicated to the well, outline each and identify the ownership thereof (both as to working interest and royalty).
3. If more than one lease of different ownership is dedicated to the well, have the interests of all owners been consolidated by communitization, unitization, force-pooling, etc?

☒ Yes ☐ No If answer is "yes," type of consolidation Unit

If answer is "no," list the owners and tract descriptions which have actually been consolidated. (Use reverse side of this form if necessary.) _____

No allowable will be assigned to the well until all interests have been consolidated (by communitization, unitization, forced-pooling, or otherwise) or until a non-standard unit, eliminating such interests, has been approved by the Commission.

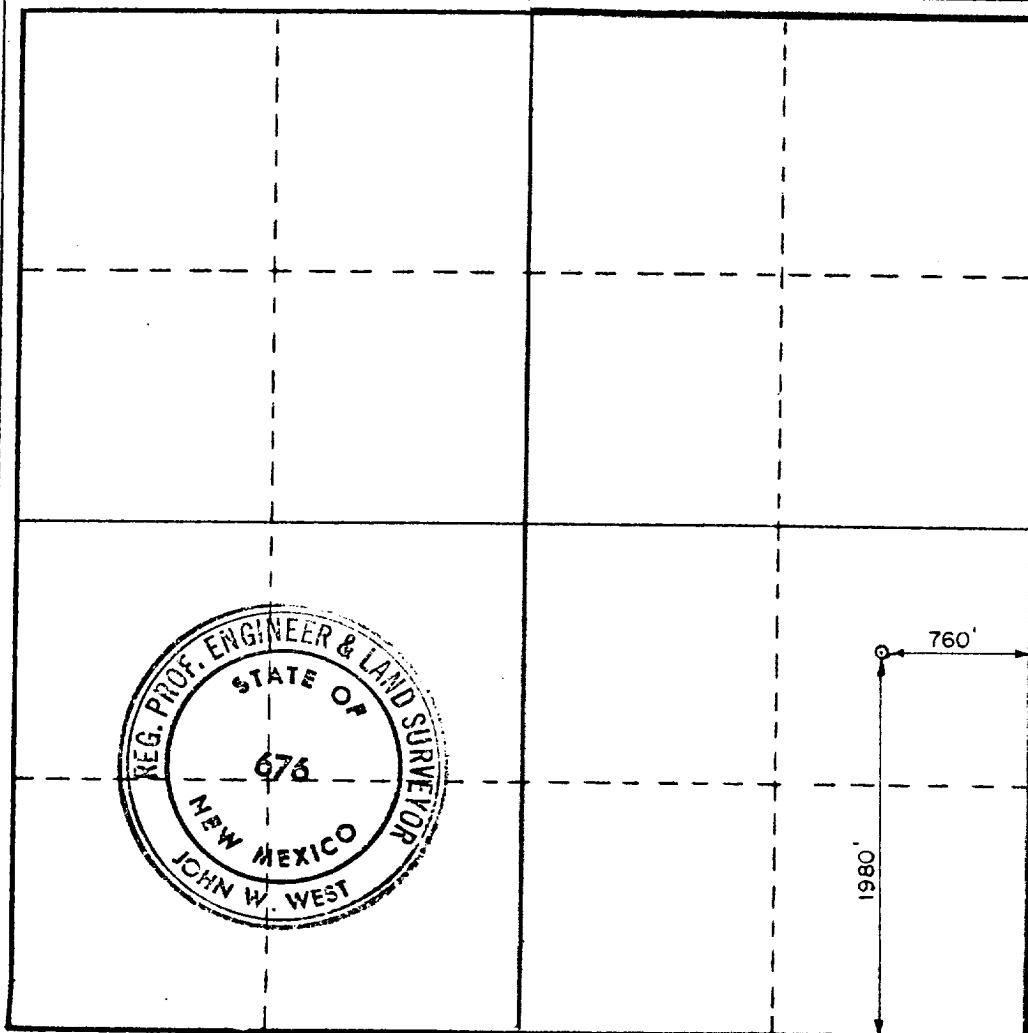

CERTIFICATION

I hereby certify that the information contained herein is true and complete to the best of my knowledge and belief.

Jerry L. Harper
 Name

JERRY L. HARPER
 Position

Operations Superintendent
 Company

Aminoil USA Inc.
 Date

7-17-80

I hereby certify that the well location shown on this plat was plotted from field notes of actual surveys made by me or under my supervision, and that the same is true and correct to the best of my knowledge and belief.

Date Surveyed
7-8-1980

Registered Professional Engineer and/or Land Surveyor

John W. West

Certificate No. **JOHN W. WEST 676**
PATRICK A. ROMERO 6883
Ronald J. Eidson 3239

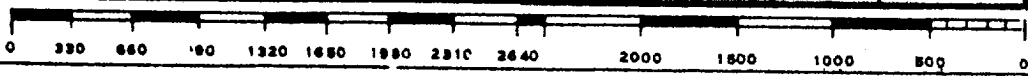

COUNTY LEA FIELD Gem STATE NM
 OPR AMINOIL USA, INC. API 30-025-27069
 NO 1 LEASE Federal "30" MAP
 Sec 30, T19S, R33E COORD
 1980 FSL, 760 FEL of Sec 12-1-32 NM
 16 mi SW/Buckeye SPD 6-19-81 (MP) 9-21-81

CSG	WELL CLASS: INIT WO FIN DG LSE CODE			
	FORMATION	DATUM	FORMATION	DATUM
TD 13,712 (MRRW)		PBD 13,670		

IP (Morrow) Perfs 13,244-561 CAOF 33,621 MCFGPD. GOR 21,366;
 gty (Gas) .6289, (Cond) 53.8; SIWHP 4575; SIBHP 4588

CONTR MGF #22 OPERSTEV 3586 GL sub-s

F.R. 10-6-80
 PD 14,200 RT (Morrow)
 12-5-81 AMEND FIELD : Formerly reported as Wildcat
 6-22-81 TD 790; SDR
 6-29-81 TD 1295; WOC
 7-6-81 Drlg 3890
 7-14-81 Drlg 6422 sh & anhy
 7-21-81 Drlg 8510 lm, sh & sd
 7-27-81 Drlg 10,306 lm & sd
 8-3-81 Drlg 11,285 sh & lm
 8-10-81 TD 11,865; SDR
 8-17-81 Drlg 12,340 lm, sh & sd
 8-24-81 Drlg 13,235 sd & lm
 8-31-81 TD 13,712; DOC
 9-14-81 TD 13,712; PBD 13,670; WOCU

12-1-32 NM

LEA
AMINOIL USA, INC.

Gem
1 Federal "30"

NM
Page 2

10-5-81 TD 13,712; PBD 13,670; WOSP "Tight"
Perf (Morrow) 13,244-561 (overall)
Natural
CAOF 53,621 MCFGPD (13,244-561)

11-30-81 TD 13,712; PBD 13,670; Complete
(Morrow) FOUR POINT GAUGES:
Flwd 3508 MCFGPD, chk (NR), 30 mins, TP 4375
Flwd 5069 MCFGPD, chk (NR), 90 mins, TP 4175
Flwd 7128 MCFGPD, chk (NR), 45 mins, TP 3940
Flwd 9974 MCFGPD, chk (NR), 30 mins, TP 3525
BHT 206 deg @ 13,205
Rig Released 8-31-81

12-5-81 COMPLETION ISSUED

12-1-32 NM
IC 30-025-70482-80