

NO. OF COPIES RECEIVED	
DISTRIBUTION	
SANTA FE	
FILE	
U.S.G.S.	
LAND OFFICE	
OPERATOR	

NEW MEXICO OIL CONSERVATION COMMISSION

Form C-101  
Revised 1-1-65

30-025-27118

5A. Indicate Type of Lease	
STATE <input checked="" type="checkbox"/>	FEE <input type="checkbox"/>
5. State Oil & Gas Lease No.	
B-1840-1	

APPLICATION FOR PERMIT TO DRILL, DEEPEN, OR PLUG BACK

1a. Type of Work		7. Unit Agreement Name	
b. Type of Well OIL WELL <input checked="" type="checkbox"/> GAS WELL <input type="checkbox"/> OTHER <input type="checkbox"/>		East Vacuum Gb/SA Unit	
DRILL <input checked="" type="checkbox"/> DEEPEN <input type="checkbox"/> PLUG BACK <input type="checkbox"/>		8. Farm or Lease Name	
SINGLE ZONE <input checked="" type="checkbox"/> MULTIPLE ZONE <input type="checkbox"/>		East Vacuum Gb/SA Unit, Tract 2739	
2. Name of Operator		9. Well No.	
Phillips Petroleum Company		008	
3. Address of Operator		10. Field and Pool, or Wildcat	
Room 401, 4001 Penbrook St., Odessa, TX 79762		Vacuum Gb/SA	
4. Location of Well		12. County	
UNIT LETTER L LOCATED 2600 FEET FROM THE South LINE		Lea	
AND 50 FEET FROM THE West LINE OF SEC. 27 TWP. 17-S RGE. 35-E NMPM			
19. Proposed Depth		19A. Formation	20. Rotary or C.T.
4800'		Gb/SA	Rotary
21. Elevations (Show whether DE, RT, etc.)	21A. Kind & Status Plug. Bond	21B. Drilling Contractor	22. Approx. Date Work will start
Ground 3944.9'	Blanket	Advise later	Upon approval

PROPOSED CASING AND CEMENT PROGRAM

SIZE OF HOLE	SIZE OF CASING	WEIGHT PER FOOT	SETTING DEPTH	SACKS OF CEMENT	EST. TOP
12-1/4"	9-5/8"	36#, K-55	350' (Sufficient quantity of Cl H w/2% CaCl (1/4# Flocele/sx in 1st 150/sx) circ to sur		
8-5/8"	7"	23#, K-55	4800' (Suff. TRLW w/12# salt/sx w/10% DD and (1/4#/sx Flocele plus 3# Gilsomite/sx followed by 300 sxs Cl H cmt w/8# salt/sx; circ to surface.)		

(This well is in the same proration unit as Well No. 004.)

Reference NSL. 1257

Use mud additives as required for control.

BOP: Series 900, 3000# WP, double w/one set pipe rams and one set blind rams.

APPROVAL VALID  
FOR 90 DAYS UNLESS  
DRILLING COMMENCED,

EXPIRES 1/27/81

IN ABOVE SPACE DESCRIBE PROPOSED PROGRAM: IF PROPOSAL IS TO DEEPEN OR PLUG BACK, GIVE DATA ON PRESENT PRODUCTIVE ZONE AND PROPOSED NEW PRODUCTIVE ZONE. GIVE BLOWOUT PREVENTER PROGRAM, IF ANY.

I hereby certify that the information above is true and complete to the best of my knowledge and belief.

Signed W. J. Mueller Title Sr. Engineering Specialist Date October 23, 1980

(This space for State Use)

APPROVED BY

CONDITIONS OF APPROVAL, IF ANY:

SUPERVISOR DISTRICT I

DATE

OCT 27 1980

**NEW MEXICO OIL CONSERVATION COMMISSION  
WELL LOCATION AND ACREAGE DEDICATION PLAT**

Form C-102  
Supersedes C-128  
Effective 1-1-65

All distances must be from the outer boundaries of the Section

Operator <b>Phillips Petroleum Company</b>			Lease <b>East Vacuum Gb/San Andres Unit 2739</b>		Tr. <b>008</b>
Unit Letter <b>L</b>	Section <b>27</b>	Township <b>T- 17 South</b>	Range <b>R- 35 East</b>	County <b>Lea</b>	
Actual Footage Location of Well: <b>2600</b> feet from the <b>South</b> line and <b>50</b> feet from the <b>West</b> line					
Ground Level Elev. <b>3944.9</b>	Producing Formation <b>Grayburg-San Andres</b>		Pool <b>Vacuum Gb/San Andres</b>		Dedicated Acreage: <b>40</b> Acres

- (unprepared)
- Outline the acreage dedicated to the subject well by colored pencil or hachure marks on the plat below.
  - If more than one lease is dedicated to the well, outline each and identify the ownership thereof (both as to working interest and royalty).
  - If more than one lease of different ownership is dedicated to the well, have the interests of all owners been consolidated by communitization, unitization, force-pooling, etc?

☐ Yes ☐ No If answer is "yes," type of consolidation \_\_\_\_\_

If answer is "no," list the owners and tract descriptions which have actually been consolidated. (Use reverse side of this form if necessary.) \_\_\_\_\_

No allowable will be assigned to the well until all interests have been consolidated (by communitization, unitization, forced-pooling, or otherwise) or until a non-standard unit, eliminating such interests, has been approved by the Commission.

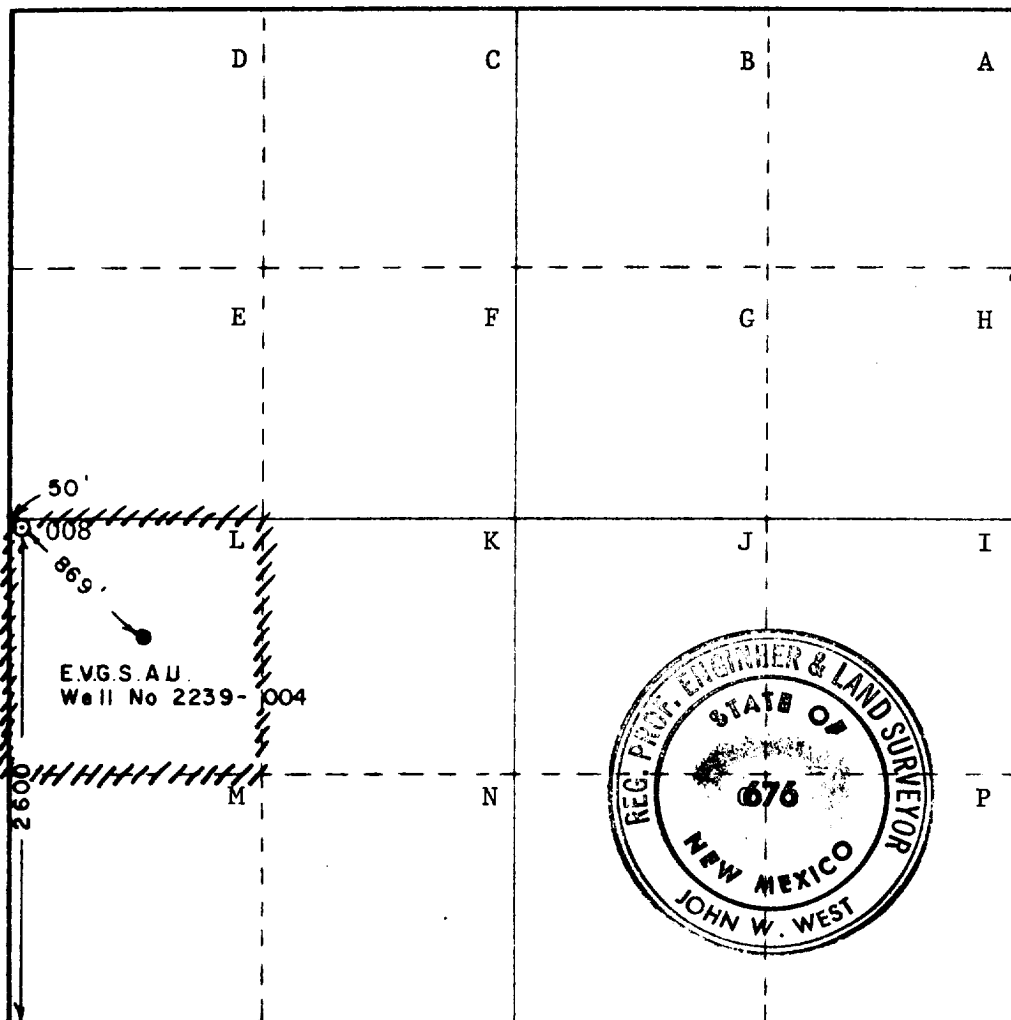

**CERTIFICATION**

I hereby certify that the information contained herein is true and complete to the best of my knowledge and belief.

*W.J. Mueller*  
W.J. Mueller

Position  
**Senior Engineering Specialist**

Company  
**Phillips Petroleum Company**

Date  
**8-13-80**

I hereby certify that the well location shown on this plat was plotted from field notes of actual surveys made by me or under my supervision, and that the same is true and correct to the best of my knowledge and belief.

Date Surveyed  
**June 20, 1980**

Registered Professional Engineer and/or Land Surveyor

*John W. West*  
Certificate No. **JOHN W. WEST 676**  
**PATRICK A. ROMERO 6883**

# DOUBLE PREVENTER OPTION

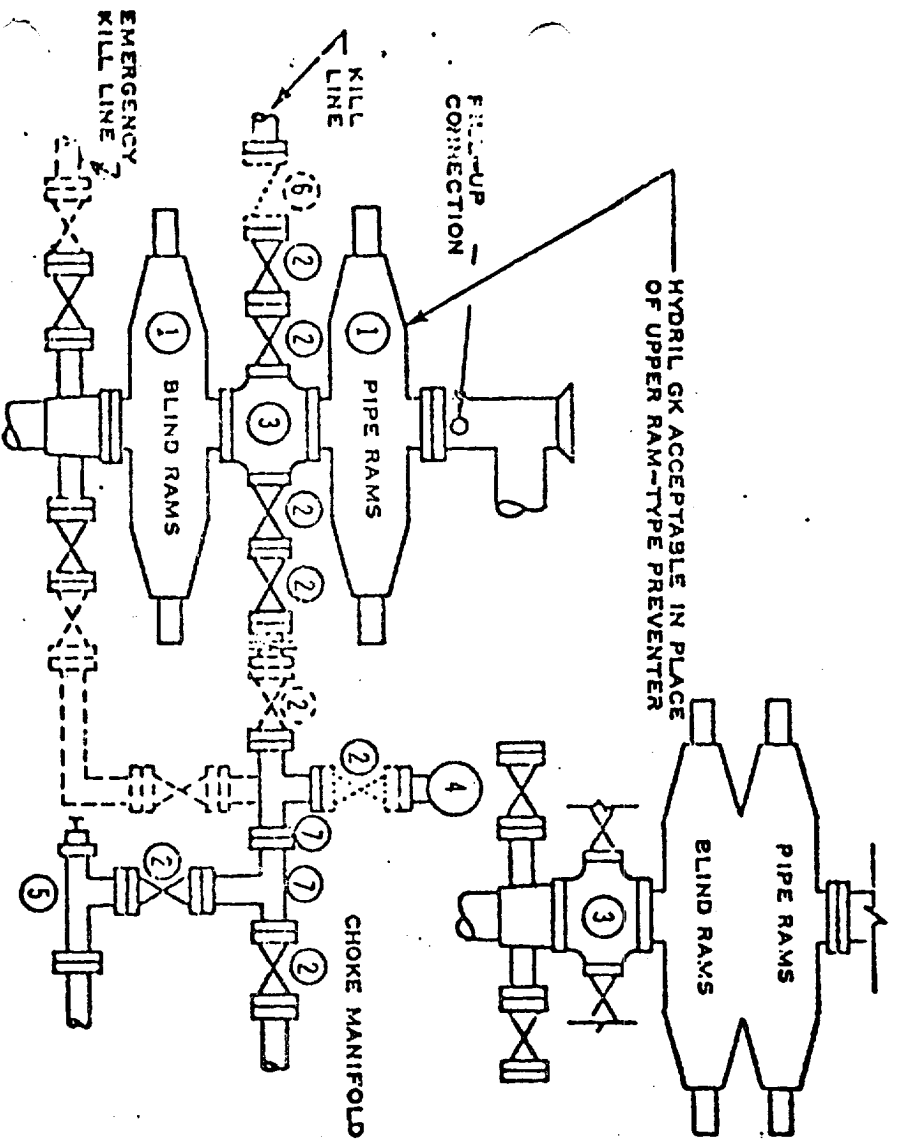

- ① SERIES 900 RAM-TYPE BOP
- ② 2" SERIES 900 VALVE
- ③ SERIES 900 DRILLING SPOOL
- ④ 2" MUD PRESSURE GAUGE
- ⑤ 2" SERIES 900 CHOKE
- ⑥ 2" SERIES 900 CHECK VALVE
- ⑦ 2" SERIES 900 STEEL TEE

## NOTES:

1. 3000 PSI WP CLAMP HUBS MAY BE SUBSTITUTED FOR FLANGES
2. VALVES MAY BE EITHER HAND OR POWER OPERATED BUT, IF POWER OPERATED, THE VALVES FLANGED TO THE BOP RUN MUST BE CAPABLE OF BEING OPENED AND CLOSED MANUALLY OR CLOSE ON POWER FAILURE AND BE CAPABLE OF BEING OPENED MANUALLY

.....OPTIONAL EQUIPMENT

PHILLIPS PETROLEUM COMPANY

3000 PSI WORKING PRESSURE  
BLOWOUT PREVENTER HOOK-UP  
(SERIES 900 FLANGES OR BETTER)

RECEIVED

OCT 27 1990

DEPT. OF COMMERCE

173