

UNITED STATES
DEPARTMENT OF THE INTERIOR
GEOLOGICAL SURVEY

30-025-27122

APPLICATION FOR PERMIT TO DRILL, DEEPEN, OR PLUG BACK

1a. TYPE OF WORK
DRILL ☒ DEEPEN ☐ PLUG BACK ☐

b. TYPE OF WELL
OIL WELL ☒ GAS WELL ☐ OTHER ☐
SINGLE ZONE ☒ MULTIPLE ZONE ☐

2. NAME OF OPERATOR
WALTER W. KRUG dba WALLEN PRODUCTION COMPANY

3. ADDRESS OF OPERATOR
P. O. BOX 1960, MIDLAND, TEXAS 79702

4. LOCATION OF WELL (Report location clearly and in accordance with any State requirements.*)
At surface
430' FSL AND 990' FWL OF SECTION 19
At proposed prod. zone

14. DISTANCE IN MILES AND DIRECTION FROM NEAREST TOWN OR POST OFFICE*
15 MILES SOUTH-SOUTHEAST OF MALJAMAR, NEW MEXICO

15. DISTANCE FROM PROPOSED* LOCATION TO NEAREST PROPERTY OR LEASE LINE, FT.
(Also to nearest drilg. unit line, if any)
430'

18. DISTANCE FROM PROPOSED LOCATION* TO NEAREST WELL, DRILLING, COMPLETED, OR APPLIED FOR, ON THIS LEASE, FT.
1320'

21. ELEVATIONS (Show whether DF, RT, CR, etc.)
3597.7

23. PROPOSED CASING AND CEMENTING PROGRAM

SIZE OF HOLE	SIZE OF CASING	WEIGHT PER FOOT	SETTING DEPTH	QUANTITY OF CEMENT
15"	13-3/8"	61# K-55	110'	SUFFICIENT TO CIRCULATE
12-1/2"	10-3/4"	45.5# K-55	600	MUDDING IN - TO BE PULLED
10"	8-5/8"	32# K-55	1050	MUDDING IN - TO BE PULLED
8"	7"	23# K-55	2890	SUFFICIENT TO CIRCULATE
6"	4-1/2"(liner)	10.5# K-55	3200	SUFFICIENT TO CIRCULATE LINER

5. LEASE DESIGNATION AND SERIAL NO.

NM 077004

6. IF INDIAN, ALLOTTEE OR TRIBE NAME

7. UNIT AGREEMENT NAME

8. FARM OR LEASE NAME

WALLEN 19 FEDERAL

9. WELL NO.

1

10. FIELD AND POOL, OR WILDCAT

SOUTH TONTO YATES SEVEN RIVERS

11. SEC., T., R., M., OR BLK. AND SURVEY OR AREA

SEC. 19, T. 19 S., R. 33 E.

12. COUNTY OR PARISH 13. STATE

LEA

NEW MEXICO

17. NO. OF ACRES ASSIGNED TO THIS WELL
40

20. ROTARY OR CABLE TOOLS
CABLE TOOLS

22. APPROX. DATE WORK WILL START*

UPON APPROVAL

SEE ATTACHED FOR: SUPPLEMENTAL DRILLING DATA
SURFACE USE AND OPERATIONS PLAN

RECEIVED
OCT 6 1980
U. S. GEOLOGICAL SURVEY
HOBBS, NEW MEXICO

IN ABOVE SPACE DESCRIBE PROPOSED PROGRAM: If proposal is to deepen or plug back, give data on present productive zone and proposed new productive zone. If proposal is to drill or deepen directionally, give pertinent data on subsurface locations and measured and true vertical depths. Give blowout preventer program, if any.

24. SIGNED Arthur R. Brown Agent DATE OCTOBER 6, 1980

(This space for Federal or State office use)

PERMIT NO. APPROVAL DATE

(Orig. & 4) GEORGE H. STEWART

ACTING DISTRICT ENGINEER

DATE OCT 22 1980

APPROVED BY
CONDITIONS OF APPROVAL, IF ANY:

NEW MEXICO OIL CONSERVATION COMMISSION
WELL LOCATION AND ACREAGE DEDICATION PLAT

Form O-102
Supersedes O-123
Effective 1-1-65

All distances must be from the outer boundaries of the Section

Operator WALTER W. KRUG dba WALLEN PRODUCTION COMPANY			Lease WALLEN 19 FEDERAL		Well No. 1
Section Letter M	Section 19	Township 19 South	Range 33 East	County Lea	
Approximate Location of Well: 430 feet from the South line and 990 feet from the West line					
Ground Level Elev. 3597.7	Producing Formation YATES-SEVEN RIVERS		Pool SOUTH TONTO YATES SEVEN RIVERS		Acres 41.06

1. Outline the acreage dedicated to the subject well by colored pencil or hatchure marks on the plat below.
2. If more than one lease is dedicated to the well, outline each and identify the ownership thereof (both as to working interest and royalty).
3. If more than one lease of different ownership is dedicated to the well, have the interests of all owners been consolidated by communitization, unitization, force-pooling, etc?

☐ Yes ☐ No If answer is "yes," type of consolidation _____

If answer is "no," list the owners and tract descriptions which have actually been consolidated. (Use reverse side of this form if necessary.) _____

No allowable will be assigned to the well until all interests have been consolidated (by communitization, unitization, force-pooling, or otherwise) or until a non-standard unit, eliminating such interests, has been approved by the Commission.

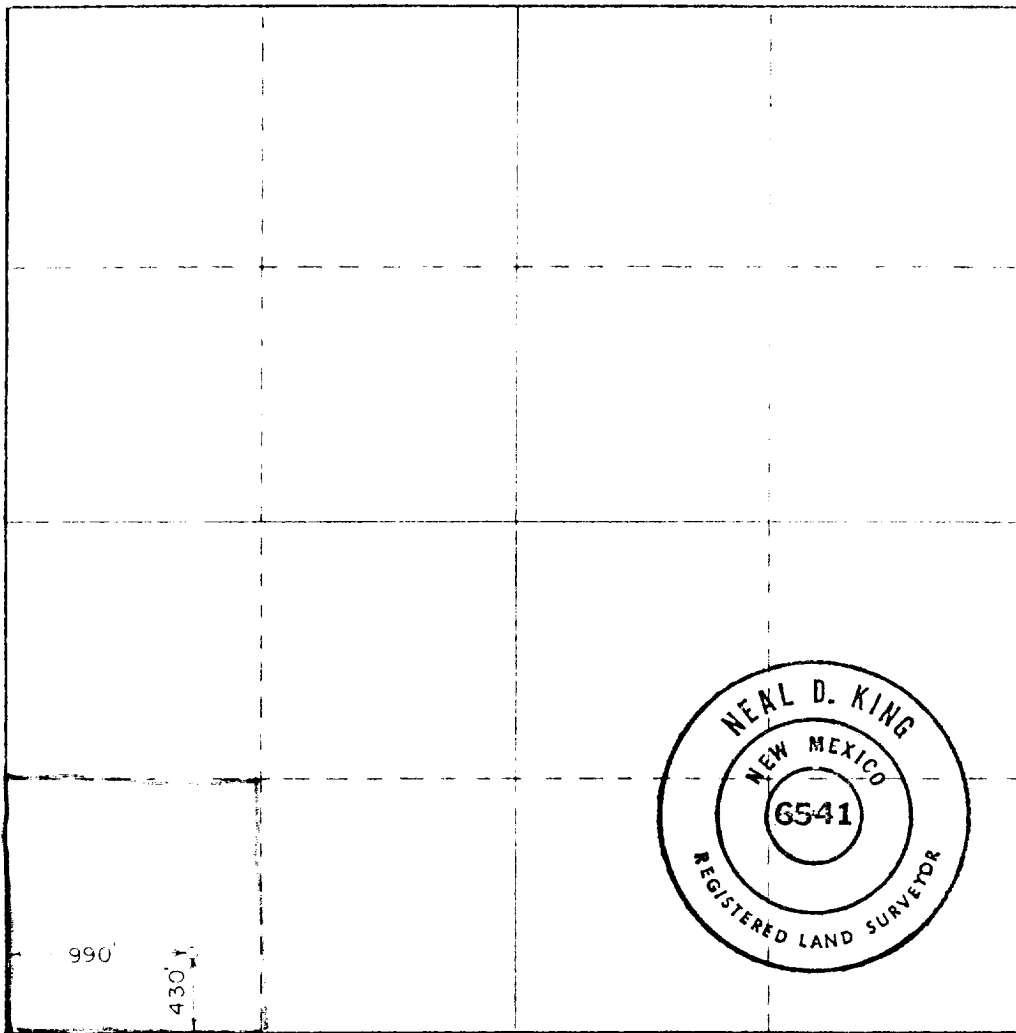

CERTIFICATION

I hereby certify that the information contained herein is true and complete to the best of my knowledge and belief.

Helen R. Krug
Helen R. Krug

co-owner

Walter W. Krug DBA
Wallen Production
Company

9-22-1980

I hereby certify that the well location shown on this plat was plotted from field notes of actual surveys made by me or under my supervision, and that the same is true and correct to the best of my knowledge and belief.

Date Surveyed

September 17, 1980

Registered Professional Engineer
in Land Surveying

Neal D. King
Neal D. King
6541

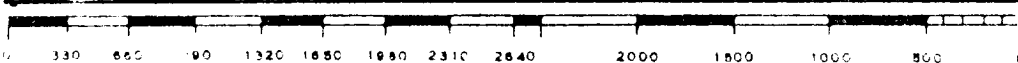

SUPPLEMENTAL DRILLING DATA

WALTER W. KRUG dba
WALLEN PRODUCTION COMPANY
WELL NO.1 WALLEN 19 FEDERAL

1. SURFACE FORMATION: Quaternary.

2. ESTIMATED TOPS OF GEOLOGIC MARKERS:

Rustler Anhydrite	1200
Top of Salt	1330
Base of Salt	2720
Yates	2920
Seven Rivers	3140

3. ANTICIPATED POSSIBLE WATER AND HYDROCARBON BEARING ZONES:

Fresh Water	None anticipated but should be above 100 feet if present.
Gyp Water	Santa Rosa at about 750 feet
Oil	Yates
Oil	Seven Rivers

4. PROPOSED CASING AND CEMENTING PROGRAM:

CASING SIZE	SETTING DEPTH		WEIGHT	GRADE	JOINT
	FROM	TO			
13-3/8"	0	110	61#	K-55	STC
10-3/4"	0	600	45.5#	K-55	STC
8-5/8"	0	1050	32#	K-55	STC
7"	0	2890	23#	K-55	STC
4-1/2"	2700	3200	10.5#	K-55	STC

Above 10-3/4" and 8-5/8" casing strings are cave and/or water shut-off casing strings and, if necessary to be run, will be mudded in and will be pulled before cementing the 7" casing.

13-3/8" surface casing will be cemented to the bottom of the

cellar with approximately 125 sacks of Class "C" cement.

7" casing will be cemented with approximately 1000 sacks of "Light" cement tailed in with 100 sacks of Class "C". Cement to circulate.

4-1/2" liner will be cemented with approximately 60 sacks of Class "C" cement.

Cement quantities and additives may be varied to best suit hole conditions at the time casing is run.

5. PRESSURE CONTROL EQUIPMENT:

Pressure control equipment will consist of 3500 psi working pressure control valve and oil saver. A 1500 psi working pressure master valve is available if needed.

6. CIRCULATING MEDIUM:

This will be a cable tool hole. Water will be the drilling fluid.

7. AUXILIARY EQUIPMENT:

Not applicable.

8. TESTING, CORING AND LOGGING PROGRAM:

Formation tests will be made as warranted by bailing hole down and measuring fluid entry rate.

It is planned that a CNL log with Gamma Ray will be run.

No coring is planned.

9. ABNORMAL PRESSURES, TEMPERATURES OR HYDROGEN SULFIDE GAS:

None anticipated.

10. ANTICIPATED STARTING DATE:

It is planned that drilling operations will commence about October 20, 1980, with operations lasting about 45 days.