



PHILLIPS PETROLEUM COMPANY

ODESSA, TEXAS 79762
4001 PENBROOK

NATURAL RESOURCES GROUP
Exploration and Production

February 24, 1981

Unorthodox Location
East Vacuum Grayburg San Andres Unit
Vacuum Grayburg San Andres Pool
Lea County, New Mexico

New Mexico Department of Energy and Minerals - 3
Oil Conservation Division
P. O. Box 2088,
Santa Fe, New Mexico 87501

Attention: Mr. Joe D. Ramey
Division Director

Gentlemen:

We respectfully request administrative approval of an unorthodox location for the below listed well. Administrative action is provided by Special Order No. R-5897, Section 4, Rule 8, provided the proposed location exceeds 330 feet from the nearest unit boundary. The location for this well meets that condition. A location plat as well as a plat of the entire unit is enclosed.

Tract 2672 -- Well No. 001 (a proposed water injection well)

1175 feet from north and 50 feet from east lines (Unit A),
Section 26, Township 17 South, Range 35 East, NMPM, Lea
County.

Your early consideration and advice will be appreciated.

Very truly yours,

T. Harold McLemore
Regulation and Proration
Supervisor

Attachments
cc: Oil Conservation Division, Hobbs
w/attachments

NEW MEXICO OIL CONSERVATION COMMISSION
WE LOCATION AND ACREAGE DEDICATION PLAT

Form C-102
Supersedes C-128
Effective 1-1-65

All distances must be from the outer boundaries of the Section.

Operator Phillips Petroleum Company			Lease East Vacuum Gb/SA Unit Tract 2672		Well No. 001
Unit Letter A	Section 26	Township T-17-S	Range R-35-E	County Lea	
Actual Footage Location of Well: 1175 feet from the North line and 50 feet from the East line					
Ground Level Elev. Advise Later	Producing Formation Gb/SA		Pool Vacuum Gb/San Andres		Dedicated Acreage: Water Injection Acres

1. Outline the acreage dedicated to the subject well by colored pencil or hachure marks on the plat below.
2. If more than one lease is dedicated to the well, outline each and identify the ownership thereof (both as to working interest and royalty).
3. If more than one lease of different ownership is dedicated to the well, have the interests of all owners been consolidated by communitization, unitization, force-pooling, etc?

☐ Yes ☐ No If answer is "yes," type of consolidation _____

If answer is "no," list the owners and tract descriptions which have actually been consolidated. (Use reverse side of this form if necessary.) _____

No allowable will be assigned to the well until all interests have been consolidated (by communitization, unitization, forced-pooling, or otherwise) or until a non-standard unit, eliminating such interests, has been approved by the Commission.

CERTIFICATION

I hereby certify that the information contained herein is true and complete to the best of my knowledge and belief.

Name *W. J. Mueller*
W. J. Mueller

Position
Senior Engineering Specialist

Company
Phillips Petroleum Company

Date
February 24, 1981

I hereby certify that the well location shown on this plat was plotted from field notes of actual surveys made by me or under my supervision, and that the same is true and correct to the best of my knowledge and belief.

Date Surveyed
February 24, 1981

Registered Professional Engineer and/or Land Surveyor

Certificate No. *1608*
1608

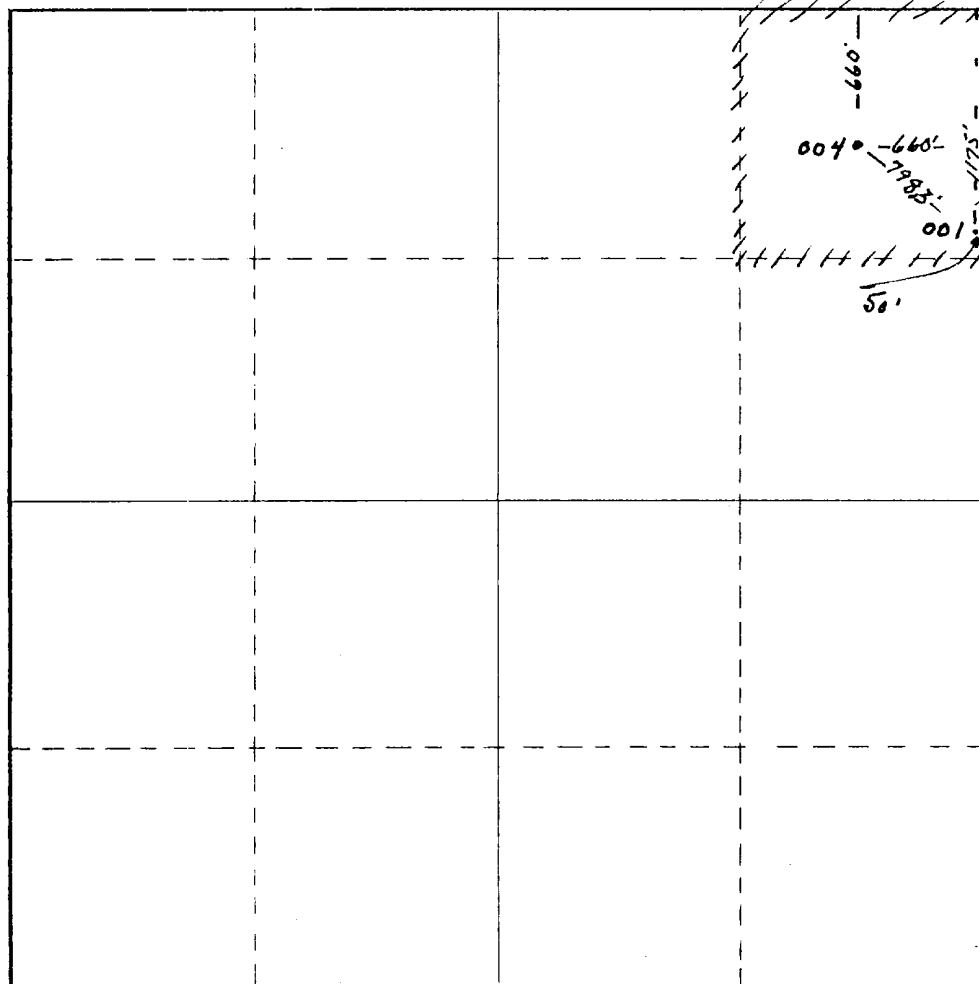

0 330 660 990 1320 1650 1980 2310 2640 2970 3300 3630 3960 4290 4620 4950 5280 5610 5940 6270 6600

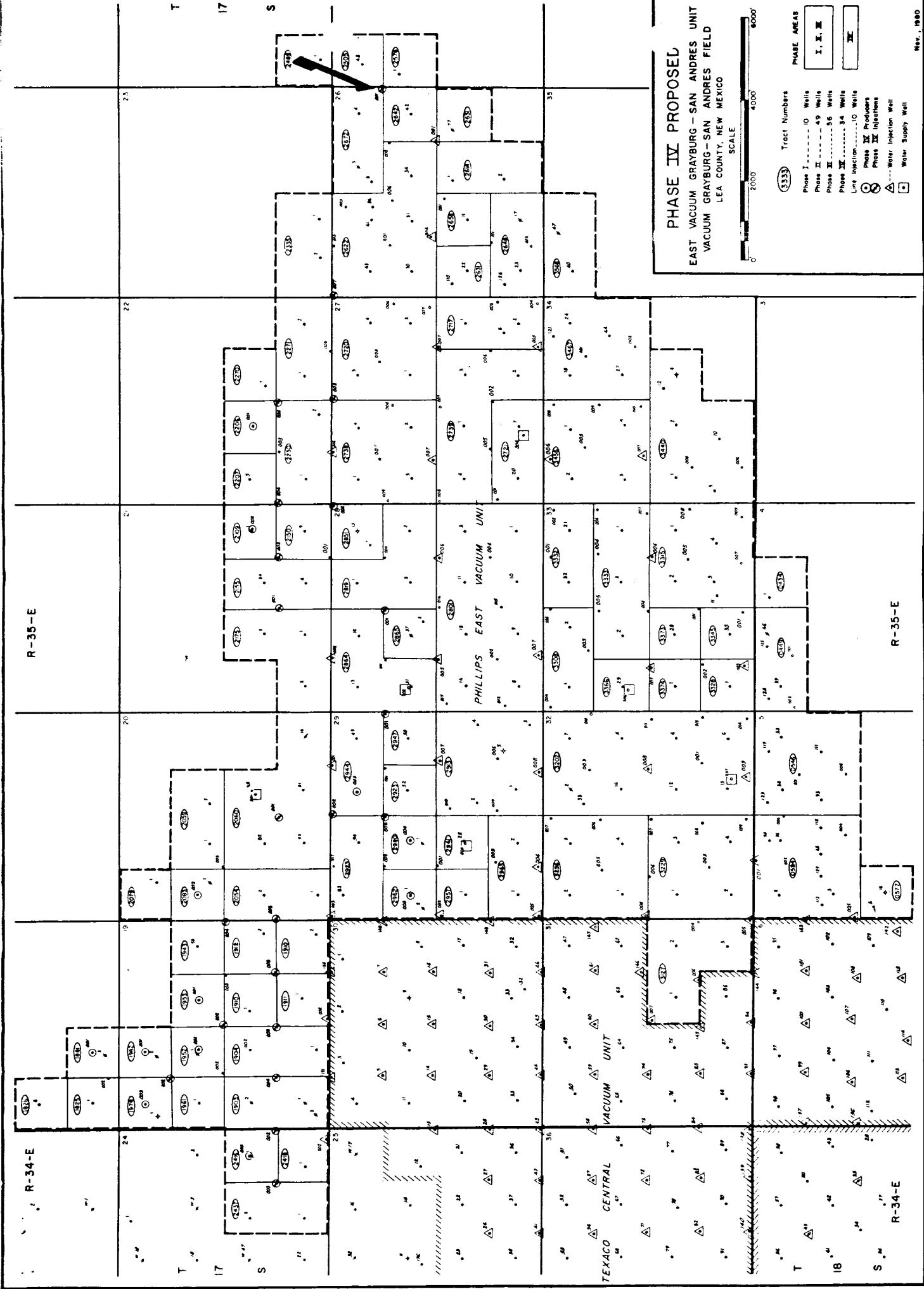

PHASE IV PROPOSEL
EAST VACUUM GRAYBURG - SAN ANDRES UNIT
VACUUM GRAYBURG - SAN ANDRES FIELD
LEA COUNTY, NEW MEXICO

SCALE
0 2000 4000 6000'

PHASE AREAS
I, II, III
IV

Tract Numbers
Phase I 10 Wells
Phase II 49 Wells
Phase III 36 Wells
Phase IV 34 Wells
Line Injection 10 Wells
Phase IV Producers
Phase IV Injection
Water Injection Well
Water Supply Well