

STATE OF NEW MEXICO  
ENERGY AND MINERALS DEPARTMENT

OIL CONSERVATION DIVISION

P. O. BOX 2084

SANTA FE, NEW MEXICO 87501

30-025-27295

Form C-101  
Revised 10-1-78

|                        |  |
|------------------------|--|
| NO. OF COPIES RECEIVED |  |
| DISTRIBUTION           |  |
| SANTA FE               |  |
| FILE                   |  |
| U.S.G.S.               |  |
| LAND OFFICE            |  |
| OPERATOR               |  |

5A. Indicate Type of Lease  
STATE ☒ FEDERAL ☐

5. State Oil & Gas Lease No.  
B-2735

APPLICATION FOR PERMIT TO DRILL, DEEPEN, OR PLUG BACK

|  |  |  |   |
|--|--|--|---|
| 1a. Type of Work<br>DRILL <input type="checkbox"/> DEEPEN <input type="checkbox"/> PLUG BACK <input type="checkbox"/>  |  |  | 7. Unit Agreement Name<br>East Vacuum Gb/SA Unit  |
| b. Type of Well<br>OIL WELL <input type="checkbox"/> GAS WELL <input type="checkbox"/> OTHER Injection <input type="checkbox"/> SINGLE ZONE <input checked="" type="checkbox"/> MULTIPLE ZONE <input type="checkbox"/> |  |  | 8. Form or Lease Name<br>East Vacuum Gb/SA Unit   |
| 2. Name of Operator<br>Phillips Petroleum Company  |  |  | 9. Well No.<br>001                                |
| 3. Address of Operator<br>Room 401, 4001 Penbrook, Odessa, Texas 79762   |  |  | 10. Field and Pool, or Wildcat<br>Vacuum Gb/SA    |
| 4. Location of Well<br>UNIT LETTER <u>A</u> LOCATED <u>1175'</u> FEET FROM THE <u>N</u> LINE<br>AND <u>50'</u> FEET FROM THE <u>E</u> LINE OF SEC. <u>26</u> TWP. <u>T-17-S</u> RCT. <u>R-35-E</u>                     |  |  | 11. County<br>Lea                                 |
| 19. Proposed Depth<br>4800'  |  | 19A. Formation<br>Gb/SA                  | 20. Rotary or C.T.<br>Rotary                      |
| 21. Elevations (show whether D.T., K.I., etc.)<br>3972.5' Advise Later   | 21A. Kind & Status Plug. Bond<br>blanket | 21B. Drilling Contractor<br>advise later | 22. Approx. Date Work will start<br>Upon Approval |

23.

PROPOSED CASING AND CEMENT PROGRAM

| SIZE OF HOLE | SIZE OF CASING | WEIGHT PER FOOT | SETTING DEPTH   | SACKS OF CEMENT | EST. TOP |
|--------------|----------------|-----------------|---|-----------------|----------|
| 11'          | 8-5/8"         | 24# K55         | 350' (Sufficient quantity of C1 H w/2% CaCl (& 1/4# Flocele/sx in 1st 150/sxs) circ surface   |                 |          |
| 7 7/7'       | 5 1/2"         | 17# K-55        | 4800' (Suff. TRW w/12# salt/sx w/10% DD and (1/4#/sx Flocele plus 3# Gilsonite/sx followed (by 260 sxs C1 H cement w/8# salt/sx to circ surface). |                 |          |

Use mud additives as Required for Control.

BOP: Series 900, 3000# WP, double w/one set pipe rams and one set blind rams.

This well will be in the same proation unit as Well #004.

APPROVAL VALID FOR 180 DAYS  
PERMIT EXPIRES 9/27/81  
UNLESS DRILLING UNDERWAY

NSL-1333

IN ABOVE SPACE DESCRIBE PROPOSED PROGRAM; IF PROPOSAL IS TO DEEPEN OR PLUG BACK, GIVE DATA ON PRESENT PRODUCTIVE ZONE AND PROPOSED NEW PRO-  
DUCIVE ZONE. GIVE BLOWOUT PREVENTER PROGRAM, IF ANY.

I hereby certify that the information above is true and complete to the best of my knowledge and belief.

Signed [Signature] W. J. Mueller Title Senior Engineering Specialist Date February 24, 1981

(This space for State Use)

APPROVED BY [Signature] TITLE SUPERVISOR DISTRICT 1 DATE MD  
CONDITIONS OF APPROVAL, IF ANY:

NEW MEXICO OIL CONSERVATION COMMISSION  
W - LOCATION AND ACREAGE DEDICATION PLAT

Form C-102  
Supersedes C-128  
Effective 1-1-65

All distances must be from the outer boundaries of the Section

|  |                                     |   |                                     |  |
|--|-------------------------------------|---|-------------------------------------|--|
| Operator<br><b>Phillips Petroleum Company</b>  |                                     | Lease<br><b>East Vacuum Gb/SA Unit Tract 2672</b> |                                     | Well No.<br><b>001</b>                             |
| Unit Letter<br><b>A</b>  | Section<br><b>26</b>                | Township<br><b>T-17-S</b>                         | Range<br><b>R-35-E</b>              | County<br><b>Lea</b>                               |
| Actual Footage Location of Well:<br><b>1175</b> feet from the <b>North</b> line and <b>50</b> feet from the <b>East</b> line |                                     |   |                                     |  |
| Ground Level Elev.<br><b>Advise Later</b>  | Producing Formation<br><b>Gb/SA</b> |   | Pool<br><b>Vacuum Gb/San Andres</b> | Dedicated Acreage:<br><b>Water Injection</b> Acres |

1. Outline the acreage dedicated to the subject well by colored pencil or hachure marks on the plat below.
2. If more than one lease is dedicated to the well, outline each and identify the ownership thereof (both as to working interest and royalty).
3. If more than one lease of different ownership is dedicated to the well, have the interests of all owners been consolidated by communitization, unitization, force-pooling, etc?

☐ Yes ☐ No If answer is "yes," type of consolidation \_\_\_\_\_

If answer is "no," list the owners and tract descriptions which have actually been consolidated. (Use reverse side of this form if necessary.) \_\_\_\_\_

No allowable will be assigned to the well until all interests have been consolidated (by communitization, unitization, forced-pooling, or otherwise) or until a non-standard unit, eliminating such interests, has been approved by the Commission.

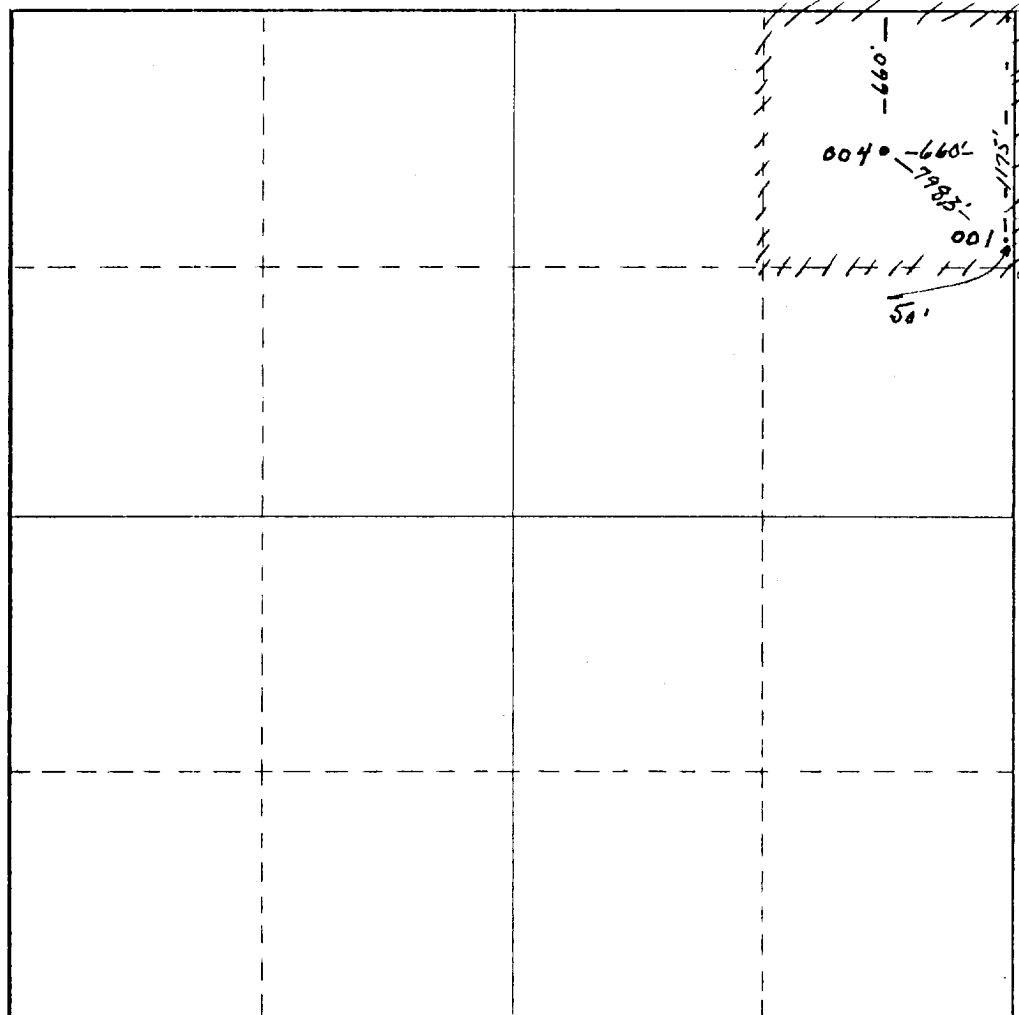

CERTIFICATION

I hereby certify that the information contained herein is true and complete to the best of my knowledge and belief.

Name **W. J. Mueller**

Position  
**Senior Engineering Specialist**

Company  
**Phillips Petroleum Company**

Date  
**February 24, 1981**

I hereby certify that the well location shown on this plat was plotted from field notes of actual surveys made by me or under my supervision, and that the same is true and correct to the best of my knowledge and belief.

Date Surveyed  
**February 24, 1981**

Registered Professional Engineer and/or Land Surveyor

Certificate No.  
**1608**

0 330 660 990 1320 1650 1980 2310 2640 2970 3300 3630 3960 4290 4620 4950 5280 5610 5940 6270 6600

# DOUBLE PREVENTER OPTION

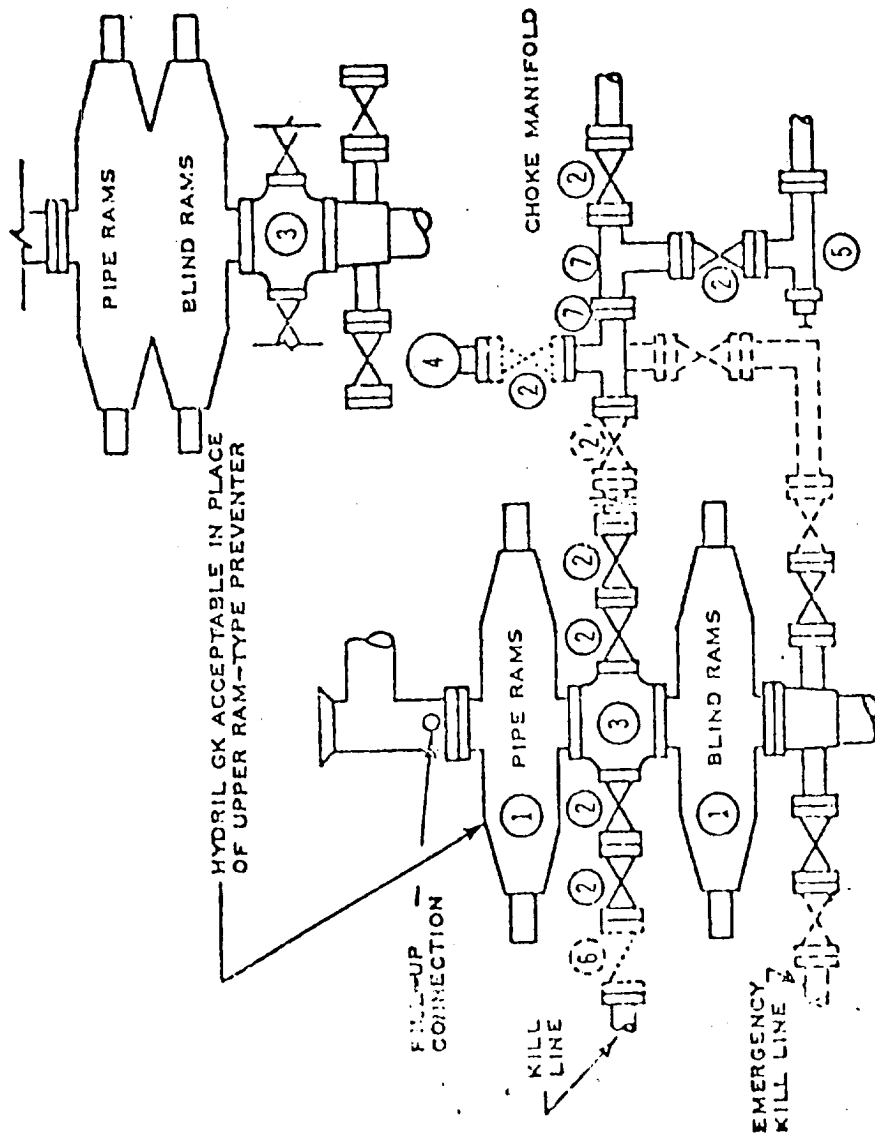

- ① SERIES 900 RAM-TYPE BOP
- ② 2" SERIES 900 VALVE
- ③ SERIES 900 DRILLING SPOOL
- ④ 2" MUD PRESSURE GAUGE
- ⑤ 2" SERIES 900 CHOKE
- ⑥ 2" SERIES 900 CHECK VALVE
- ⑦ 2" SERIES 900 STEEL TEE

## NOTES:

1. 3000 PSI WP CLAMP HUBS MAY BE SUBSTITUTED FOR FLANGES
2. VALVES MAY BE EITHER HAND OR POWER OPERATED BUT, IF POWER OPERATED, THE VALVES FLANGED TO THE BOP RUN MUST BE CAPABLE OF BEING OPENED AND CLOSED MANUALLY OR CLOSE ON POWER FAILURE AND BE CAPABLE OF BEING OPENED MANUALLY

..... OPTIONAL EQUIPMENT

PHILLIPS PETROLEUM COMPANY

3000 PSI WORKING PRESSURE  
BLOWOUT PREVENTER HOOK-UP  
(SERIES 900 FLANGES OR BETTER)

REV 6/73

FIGURE NO. 7