

30-025-27314

Form C-101  
Revised 10-1-78

NO. OF COPIES RECEIVED	
DISTRIBUTION	
SANTA FE	
FILE	
U.S.G.S.	
LAND OFFICE	
OPERATOR	

5A. Indicate Type of Lease  
STATE ☒ FEE ☐  
5. State Oil & Gas Lease No.  
B-2224

APPLICATION FOR PERMIT TO DRILL, DEEPEN, OR PLUG BACK

1a. Type of Work b. Type of Well OIL WELL <input checked="" type="checkbox"/> GAS WELL <input type="checkbox"/> OTHER <input type="checkbox"/> 2. Name of Operator Phillips Petroleum Company 3. Address of Operator Room 401, 4001 Penbrook, Odessa, Texas 79762 4. Location of Well UNIT LETTER P LOCATED 1200 FEET FROM THE South LINE AND 1300 FEET FROM THE East LINE OF SEC. 21 TWP. 17-S RGE. 35-E NMPM 11. Elevations (show whether DF, RT, etc.) Ground (unprepared) 3949.9 21A. Kind & Status Plug. Bond blanket 21B. Drilling Contractor Advise later 22. Approx. Date Work will start Upon approval		7. Unit Agreement Name East Vacuum Gb/SA Unit 8. Form or Lease Name East Vacuum Gb/SA Unit Tract 2150 9. Well No. 002 10. Field and Pool, or Wildcat Vacuum Gb/SA 17. County Lea 19. Proposed Depth 4800' 19A. Formation Gb/SA 20. Rotary or C.T. Rotary	
--	--	---	--

PROPOSED CASING AND CEMENT PROGRAM

SIZE OF HOLE	SIZE OF CASING	WEIGHT PER FOOT	SETTING DEPTH	SACKS OF CEMENT	EST. TOP
12-1/4"	8-5/8"	24#, K-55	350' (Sufficient quantity of C/C w/2% CaCl <sub>2</sub> (& 1/4# Flocele/sx in 1st 150 Sx) circ surface		
7-7/8"	4-1/2"	11.6#, N-80	4800' (Suff. TRLW w/12# salt/sx w/10% DD and (1/4#/sx Flocele plus 3# Gilsonite/sx followed (by 300 sxs Cl C cement w/8# salt/sx to circ (surface).		

(This well is in the same proration unit as Wells Nos. 001 and 009)

Administrative approval, provided by Special Order R-5897, of unorthodox location has been requested by separate letter.

Use mud additives as Required for Control.

BOP: Series 900, 3000# WP, double w/one set pipe rams and one set blind rams.

APPROVAL VALID FOR 180 DAYS  
PERMIT EXPIRES 9/30/81  
UNLESS DRILLING UNDERWAY

NSL-1340

IN ABOVE SPACE DESCRIBE PROPOSED PROGRAM: IF PROPOSAL IS TO DEEPEN OR PLUG BACK, GIVE DATA ON PRESENT PRODUCTIVE ZONE AND PROPOSED NEW PROD. ZONE. GIVE BLOWOUT PREVENTER PROGRAM, IF ANY.

I hereby certify that the information above is true and complete to the best of my knowledge and belief.

Signed W. J. Mueller Title Senior Engineering Specialist Date March 11, 1981

(This space for State Use)

APPROVED BY Leslie A. Combs TITLE State Engineer DATE March 11, 1981

CONDITIONS OF APPROVAL, IF ANY:

**N MEXICO OIL CONSERVATION COMMISS**  
**WELL LOCATION AND ACREAGE DEDICATION PLAT**

Form C-102  
 Supersedes C-128  
 Effective 1-1-65

All distances must be from the outer boundaries of the Section

Operator <b>Phillips Petroleum Co.</b>			Lease <b>EVGSAU Tract 2150</b>		Well No. <b>-002</b>
Unit Letter <b>P</b>	Section <b>21</b>	Township <b>17 South</b>	Range <b>35 East</b>	County <b>Lea</b>	
Actual Footage Location of Well: <b>1200</b> feet from the <b>south</b> line and <b>1300</b> feet from the <b>east</b> line					
Ground Level Elev. <b>3949.9</b>	Producing Formation <b>Grayburg/San Andres</b>	Pool <b>Vacuum Gb/San Andres</b>	Dedicated Acreage: <b>NA-Water injection</b>		

- (Unprepared)
1. Outline the acreage dedicated to the subject well by colored pencil or hatchure marks on the plat below.
  2. If more than one lease is dedicated to the well, outline each and identify the ownership thereof (both as to working interest and royalty).
  3. If more than one lease of different ownership is dedicated to the well, have the interests of all owners been consolidated by communitization, unitization, force-pooling, etc?

☐ Yes    ☐ No    If answer is "yes," type of consolidation \_\_\_\_\_

If answer is "no," list the owners and tract descriptions which have actually been consolidated. (Use reverse side of this form if necessary.) \_\_\_\_\_

No allowable will be assigned to the well until all interests have been consolidated (by communitization, unitization, forced-pooling, or otherwise) or until a non-standard unit, eliminating such interests, has been approved by the Commission.

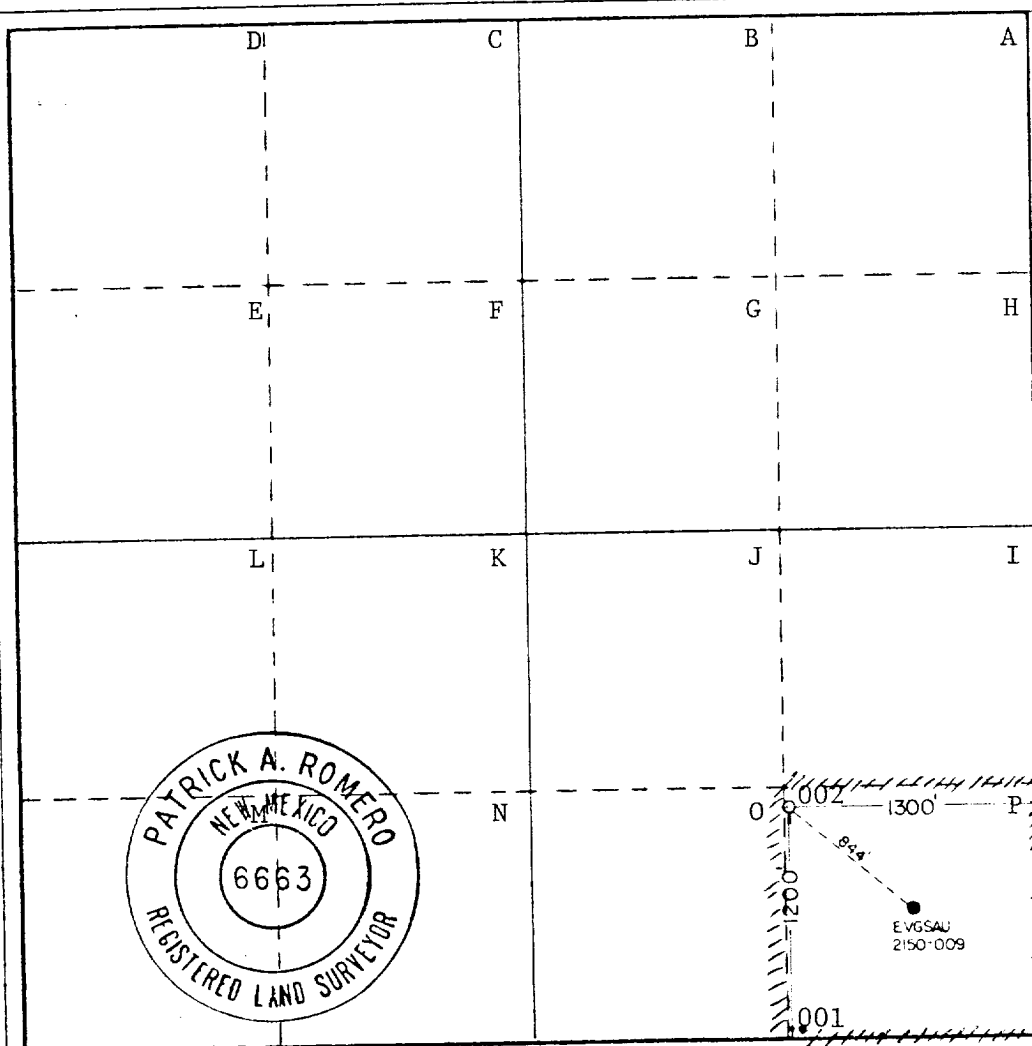

**CERTIFICATION**

I hereby certify that the information contained herein is true and complete to the best of my knowledge and belief.

*[Signature]*  
 Name \_\_\_\_\_

**W. J. Mueller**  
 Position \_\_\_\_\_

**Senior Engineering Specialist**  
 Company \_\_\_\_\_

**Phillips Petroleum Company**  
 Date \_\_\_\_\_

**March 11, 1981**

I hereby certify that the well location shown on this plat was plotted from field notes of actual surveys made by me or under my supervision, and that the same is true and correct to the best of my knowledge and belief.

Date Surveyed **3-2-81**

Registered Professional Engineer and/or Land Surveyor

*[Signature]*  
 Certificate No. \_\_\_\_\_

**JOHN W. WEST 676**  
**PATRICK A. ROMERO 6663**  
**Ronald J. Eidson 3239**