

30-025-27317

Form C-101
Revised 10-1-78

NO. OF COPIES RECEIVED	
DISTRIBUTION	
SANTA FE	
FILE	
U.S.G.S.	
LAND OFFICE	
OPERATOR	

SA. Indicate Type of Lease
STATE ☒ FEE ☐
5. State Oil & Gas Lease No.
B-2498

APPLICATION FOR PERMIT TO DRILL, DEEPEN, OR PLUG BACK

1a. Type of Work
b. Type of Well DRILL ☒ DEEPEN ☐ PLUG BACK ☐
OIL WELL ☒ GAS WELL ☐ OTHER ☐ SINGLE ZONE ☒ MULTIPLE ZONE ☐
2. Name of Operator
Phillips Petroleum Company
3. Address of Operator
Room 401, 4001 Penbrook, Odessa, Texas 79762
4. Location of Well UNIT LETTER F LOCATED 1475 FEET FROM THE North LINE
AND 2600 FEET FROM THE West LINE OF SEC. 28 TWP. 17-S RGT. 35-E
19. Proposed Depth 4800'
19A. Formation Gb/SA
20. Rotary or C.T. Rotary
21. Elevations (Show whether DF, RT, etc.) Ground (Unprepared) 3956.4
21A. Kind & Status Plug. Bond blanket
21B. Drilling Contractor advise later
22. Approx. Date Work will start upon approval

7. Unit Agreement Name
East Vacuum Gb/SA Unit
8. Farm or Lease Name
East Vacuum Gb/SA Unit
Tract 2865
9. Well No.
001
10. Field and Pool, or Wildcat
Vacuum Gb/SA
12. County
Lea

PROPOSED CASING AND CEMENT PROGRAM

SIZE OF HOLE	SIZE OF CASING	WEIGHT PER FOOT	SETTING DEPTH	SACKS OF CEMENT	EST. TOP
12-1/4"	8-5/8"	24#, K-55	350' (Sufficient quantity of C-1 C w/2% CaCl ₂ (& 1/4# Floecel/sx in 1st 150/sx) circ surface		
7-7/8"	4-1/2"	11.6#, N-80	4800' (Suff. TLW w/12# salt/sx w/10% DD and (1/4"/sx Floecel plus 3# Gilsonite/sx followed (by 300 sxs C1 C cement w/8# salt/sx to circ (surface).		

(This well is in the same proration unit as Well No. 002)
Administrative approval, provided by Special Order R-5897, of unorthodox location has been requested by separate letter.
Use mud additives as Required for Control.
BOP: Series 900, 3000# WP, double w/one set pipe rams and one set blind rams.

APPROVAL VALID FOR 180 DAYS
PERMIT EXPIRES 9/3/81
UNLESS DRILLING UNDERWAY

NSL-1340

IN ABOVE SPACE DESCRIBE PROPOSED PROGRAM; IF PROPOSAL IS TO DEEPEN OR PLUG BACK, GIVE DATA ON PRESENT PRODUCTIVE ZONE AND PROPOSED NEW PRODUCTIVE ZONE. GIVE BLOWOUT PREVENTER PROGRAM, IF ANY.

I hereby certify that the information above is true and complete to the best of my knowledge and belief.

Signed W. J. Mueller Title Senior Engineering Specialist Date March 12, 1981

(This space for State Use)

APPROVED BY Leslie A. Clement TITLE OIL & GAS ENGINEER DATE March 12, 1981

CONDITIONS OF APPROVAL, IF ANY:

NEW MEXICO OIL CONSERVATION COMMISSION
WELL LOCATION AND ACREAGE DEDICATION PLAT

Form C-102
Supersedes C-128
Effective 1-1-65

All distances must be from the outer boundaries of the Section

Operator Phillips Petroleum Co.		Lease EVGSAU Tract 2865		Well No. 001
Unit Letter F	Section 28	Township 17 South	Range 35 East	County Lea
Actual Footage Location of Well: 1475 feet from the North line and 2600 feet from the West line				
Ground Level Elev. 3956.4	Producing Formation Grayburg/San Andres	Pool Vacuum Gb/San Andres	Dedicated Acreage: NA Water injection Acres	

(Unprepared)

1. Outline the acreage dedicated to the subject well by colored pencil or hachure marks on the plat below.

2. If more than one lease is dedicated to the well, outline each and identify the ownership thereof (both as to working interest and royalty).

3. If more than one lease of different ownership is dedicated to the well, have the interests of all owners been consolidated by communitization, unitization, force-pooling, etc?

☐ Yes ☐ No If answer is "yes," type of consolidation _____

If answer is "no," list the owners and tract descriptions which have actually been consolidated. (Use reverse side of this form if necessary.) _____

No allowable will be assigned to the well until all interests have been consolidated (by communitization, unitization, forced-pooling, or otherwise) or until a non-standard unit, eliminating such interests, has been approved by the Commission.

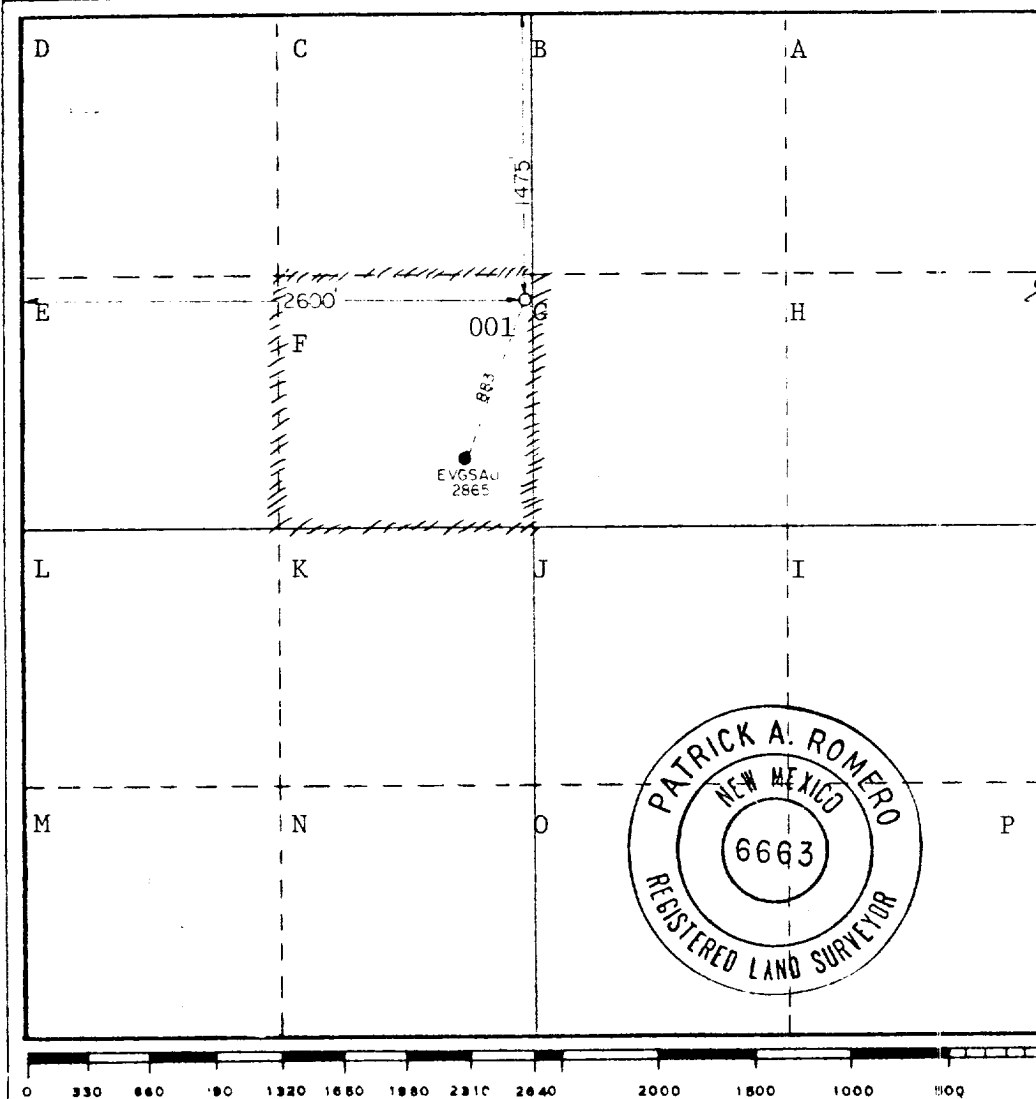

CERTIFICATION

I hereby certify that the information contained herein is true and complete to the best of my knowledge and belief.

W. J. Mueller
W. J. Mueller

Position

Senior Engineering Advisor

Company

Phillips Petroleum Company

Date

March 11, 1981

I hereby certify that the well location shown on this plat was plotted from field notes of actual surveys made by me or under my supervision, and that the same is true and correct to the best of my knowledge and belief.

Date Surveyed

3-2-81

Registered Professional Engineer and/or Land Surveyor

Patrick A. Romero

Certificate No. **JOHN W. WEST 676**
PATRICK A. ROMERO 6663
Ronald J. Eidson 3239