

30-025-27319

Form C-101
Revised 10-1-78

NO. OF COPIES RECEIVED	
DISTRIBUTION	
SANTA FE	
FILE	
U.S.G.S.	
LAND OFFICE	
OPERATOR	

5A. Indicate Type of Lease
STATE <input checked="" type="checkbox"/> FEE <input type="checkbox"/>
5. State Oil & Gas Lease No.
B-2131

APPLICATION FOR PERMIT TO DRILL, DEEPEN, OR PLUG BACK

1a. Type of Work		7. Unit Agreement Name	
DRILL <input checked="" type="checkbox"/> DEEPEN <input type="checkbox"/> PLUG BACK <input type="checkbox"/>		East Vacuum Gb/SA Unit	
b. Type of Well		8. Farm or Lease Name	
OIL WELL <input checked="" type="checkbox"/> GAS WELL <input type="checkbox"/> OTHER <input type="checkbox"/> SINGLE ZONE <input checked="" type="checkbox"/> MULTIPLE ZONE <input type="checkbox"/>		East Vacuum Gb/SA Unit	
2. Name of Operator		9. Well No.	
Phillips Petroleum Company		001	
3. Address of Operator		10. Field and Pool, or Wildcat	
Room 401, 4001 Penbrook, Odessa, Texas 79762		Vacuum Gb/SA	
4. Location of Well		12. County	
UNIT LETTER <u>H</u> LOCATED <u>1500</u> FEET FROM THE <u>North</u> LINE		<u>Lea</u>	
AND <u>50</u> FEET FROM THE <u>East</u> LINE OF SEC. <u>29</u> TWP. <u>17-S</u> RGE. <u>35-E</u> N.M.P.M.			
19. Proposed Depth		19A. Formation	20. Rotary or C.T.
4800'		Gb/SA	Rotary
21. Elevations (Show whether DE, RT, etc.)	21A. Kind & Status Plug. Bond	21B. Drilling Contractor	22. Approx. Date Work will start
Ground (unprepared) 3966.8	blanket	advise later	upon approval

PROPOSED CASING AND CEMENT PROGRAM

SIZE OF HOLE	SIZE OF CASING	WEIGHT PER FOOT	SETTING DEPTH	SACKS OF CEMENT	EST. TOP
12-1/4"	8-5/8"	24#, K-55	350' (Sufficient quantity of Cl C w/2% CaCl ₂ (& 1/4# Flocele/sx in 1st 150/sx) circ surface		
7-7/8"	4-1/2"	11.6#, N-80	4800' (Suff. THW w/12# salt/sx w/10% DD and 1/4#/sx Flocele plus 3# Gilsonite/sx followed (by 300 sxs Cl C cement w/8# salt/sx to circ (surface).		

(This well is in the same proration unit as Well No. 050.)

Administrative approval, provided by Special Order R-5897, of unorthodox location has been requested by separate letter.

Use mud additives as Required for Control.

BOP: Series 900, 3000# WP, double w/one set pipe rams and one set blind rams.

APPROVAL VALID FOR 180 DAYS
PERMIT EXPIRES 9/30/81
UNLESS DRILLING UNDERWAY

NSL-1340

IN ABOVE SPACE DESCRIBE PROPOSED PROGRAM: IF PROPOSAL IS TO DEEPEN OR PLUG BACK, GIVE DATA ON PRESENT PRODUCTIVE ZONE AND PROPOSED NEW PRODUCTIVE ZONE. GIVE BLOWOUT PREVENTER PROGRAM, IF ANY.

I hereby certify that the information above is true and complete to the best of my knowledge and belief.

Signed W. J. Mueller Title Senior Engineering Specialist Date March 12, 1981

(This space for State Use)

APPROVED BY John A. Clement TITLE OIL & GAS INSPECTOR DATE MAR 31 1981

CONDITIONS OF APPROVAL, IF ANY:

NEW MEXICO OIL CONSERVATION COMMISSION
WELL LOCATION AND ACREAGE DEDICATION PLAT

Form C-102
Supersedes C-128
Effective 1-1-65

All distances must be from the outer boundaries of the Section

4

Operator Phillips Petroleum Co.		Lease EVGSAU Tract 2947		Well No. 001
Plot Letter H	Section 29	Township 17 South	Range 35 East	County Lea
Actual Footage Location of Well: 1500 feet from the North line and 50 feet from the East line				
Ground Level Elev. 3966.8 (Unprepared)	Producing Formation Grayburg/San Andres	Pool Vacuum Gb/San Andres	Dedicated Acreage: Water injection NA Acres	

- Outline the acreage dedicated to the subject well by colored pencil or hatchure marks on the plat below.
- If more than one lease is dedicated to the well, outline each and identify the ownership thereof (both as to working interest and royalty).
- If more than one lease of different ownership is dedicated to the well, have the interests of all owners been consolidated by communitization, unitization, force-pooling, etc?

☐ Yes ☐ No If answer is "yes," type of consolidation _____

If answer is "no," list the owners and tract descriptions which have actually been consolidated. (Use reverse side of this form if necessary.) _____

No allowable will be assigned to the well until all interests have been consolidated (by communitization, unitization, forced-pooling, or otherwise) or until a non-standard unit, eliminating such interests, has been approved by the Commission.

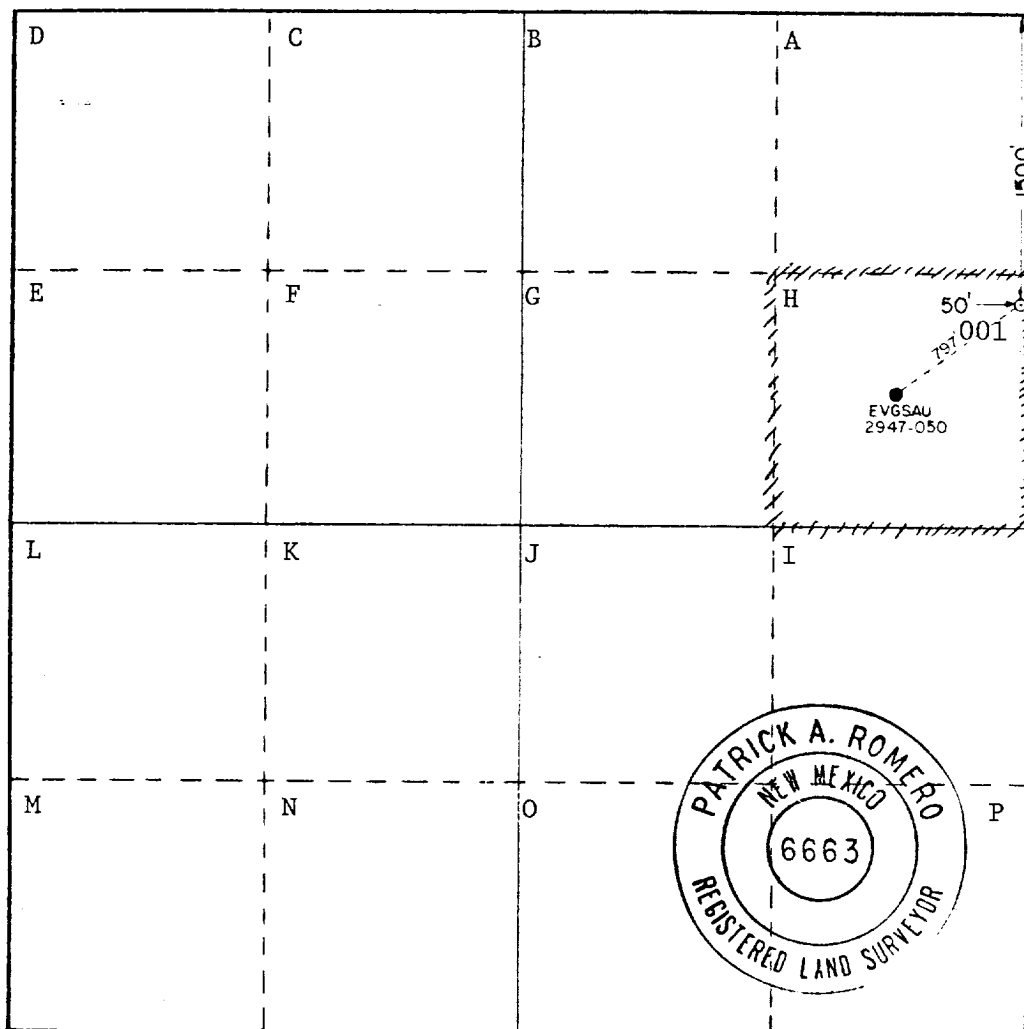

CERTIFICATION

I hereby certify that the information contained herein is true and complete to the best of my knowledge and belief.

[Signature]

Name
W. J. Mueller
Position
Senior Engineering Advisor
Company
Phillips Petroleum Company
Date
March 12, 1981

I hereby certify that the well location shown on this plat was plotted from field notes of actual surveys made by me or under my supervision, and that the same is true and correct to the best of my knowledge and belief.

Date Surveyed
3-2-81

Registered Professional Engineer and/or Land Surveyor

[Signature]

Certificate No. **JOHN W. WEST 678**
PATRICK A. ROMERO 6663
Ronald J. Eidson 3239

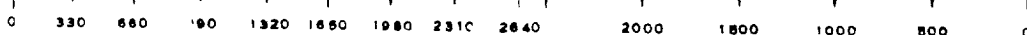

RECEIVED

MAR 16 1981

ON CONGRATULATION

100