

30-025-27320

STATE OF NEW MEXICO
ENERGY AND MINERALS DEPARTMENT

CONSERVATION DIVISION
P. O. BOX 2088
SANTA FE, NEW MEXICO 87501

Form C-101
Revised 10-1-78

NO. OF COPIES RECEIVED	
DISTRIBUTION	
SANTA FE	
FILE	
U.S.G.S.	
LAND OFFICE	
OPERATOR	

5A. Indicate Type of Lease
STATE ☒ FEE ☐
5. State Oil & Gas Lease No.
E-7585

APPLICATION FOR PERMIT TO DRILL, DEEPEN, OR PLUG BACK

1a. Type of Work DRILL <input checked="" type="checkbox"/> DEEPEN <input type="checkbox"/> PLUG BACK <input type="checkbox"/>		7. Unit Agreement Name East Vacuum Gb/SA Unit
b. Type of Well OIL WELL <input checked="" type="checkbox"/> GAS WELL <input type="checkbox"/> OTHER <input type="checkbox"/> SINGLE ZONE <input checked="" type="checkbox"/> MULTIPLE ZONE <input type="checkbox"/>		8. Farm or Lease Name East Vacuum Gb/SA Unit
2. Name of Operator Phillips Petroleum Company		9. Well No. 003
3. Address of Operator Room 401, 4001 Penbrook, Odessa, Texas 79762		10. Field and Pool, or Wildcat Vacuum Gb/SA
4. Location of Well UNIT LETTER <u>F</u> LOCATED <u>1350</u> FEET FROM THE <u>North</u> LINE AND <u>2600</u> FEET FROM THE <u>West</u> LINE OF SEC. <u>29</u> TWP. <u>17-S</u> RGE. <u>35-E</u> NMPM		12. County Lea
19. Proposed Depth 4800'		19A. Formation Gb/SA
20. Rotary or C.T. Rotary		
21. Elevations (Show whether DI, RT, etc.) Ground (unprepared) 3962	21A. Kind & Status Plug. Bond blanket	21B. Drilling Contractor advise later
22. Approx. Date Work will start upon approval		

23. PROPOSED CASING AND CEMENT PROGRAM

SIZE OF HOLE	SIZE OF CASING	WEIGHT PER FOOT	SETTING DEPTH	SACKS OF CEMENT	EST. TOP
12-1/4"	8-5/8"	24#, K-55	350' (Sufficient quantity of C. C w/2% CaCl (& 1/4# Flocele/sx in 1st 150/sx) circ surface		
7-7/8"	4-1/2"	11.6#, N-80	4800' (Suff. TRLW w/12# salt/sx w/10% DD and (1/4#/sx Flocele plus 3# Gilsonite/sx followed (by 300 sxs Cl C cement w/8# salt/sx to circ (surface).		

(This well is in the same proration unit as Wells No. 002 and 004)

Administrative approval, provided by Special Order R-5897, of unorthodox location has been requested by separate letter.

Use mud additives as Required for Control

BOP: Series 900, 3000#WP, double w/one set pipe rams and one set blind rams.

NSL-1340

APPROVAL VALID FOR 180 DAYS
PERMIT EXPIRES 9/30/81
UNLESS DRILLING UNDERWAY

IN ABOVE SPACE DESCRIBE PROPOSED PROGRAM; IF PROPOSAL IS TO DEEPEN OR PLUG BACK, GIVE DATA ON PRESENT PRODUCTIVE ZONE AND PROPOSED NEW PRODUCTIVE ZONE. GIVE BLOWOUT PREVENTER PROGRAM, IF ANY.

I hereby certify that the information above is true and complete to the best of my knowledge and belief.

Signed W. J. Mueller Title Senior Engineering Specialist Date March 12, 1981

(This space for State Use)

APPROVED BY Jesús Clement TITLE Assistant Engineer DATE 3/12/81

CONDITIONS OF APPROVAL, IF ANY:

NEW MEXICO OIL CONSERVATION COMMISSION
WELL LOCATION AND ACREAGE DEDICATION PLAT

Form C-102
Supersedes C-128
Effective 1-1-65

All distances must be from the outer boundaries of the Section

Operator Phillips Petroleum Co.			Lease EVGSAU Tract 2980			Well No. 003		
Section Letter F	Section 29	Township 17 South	Range 35 East	County Lea				
Actual Footage Location of Well: 1350 feet from the North line and 2600 feet from the West line								
Ground Level Elev. 3962.0		Producing Formation Grayburg/San Andres		Pool Vacuum Gb/San Andres			Dedicated Acreage: Water injection NA Acres	

(Unprepared)

- Outline the acreage dedicated to the subject well by colored pencil or hachure marks on the plat below.
- If more than one lease is dedicated to the well, outline each and identify the ownership thereof (both as to working interest and royalty).
- If more than one lease of different ownership is dedicated to the well, have the interests of all owners been consolidated by communitization, unitization, force-pooling, etc?

☐ Yes ☐ No If answer is "yes," type of consolidation _____

If answer is "no," list the owners and tract descriptions which have actually been consolidated. (Use reverse side of this form if necessary.) _____

No allowable will be assigned to the well until all interests have been consolidated (by communitization, unitization, forced-pooling, or otherwise) or until a non-standard unit, eliminating such interests, has been approved by the Commission.

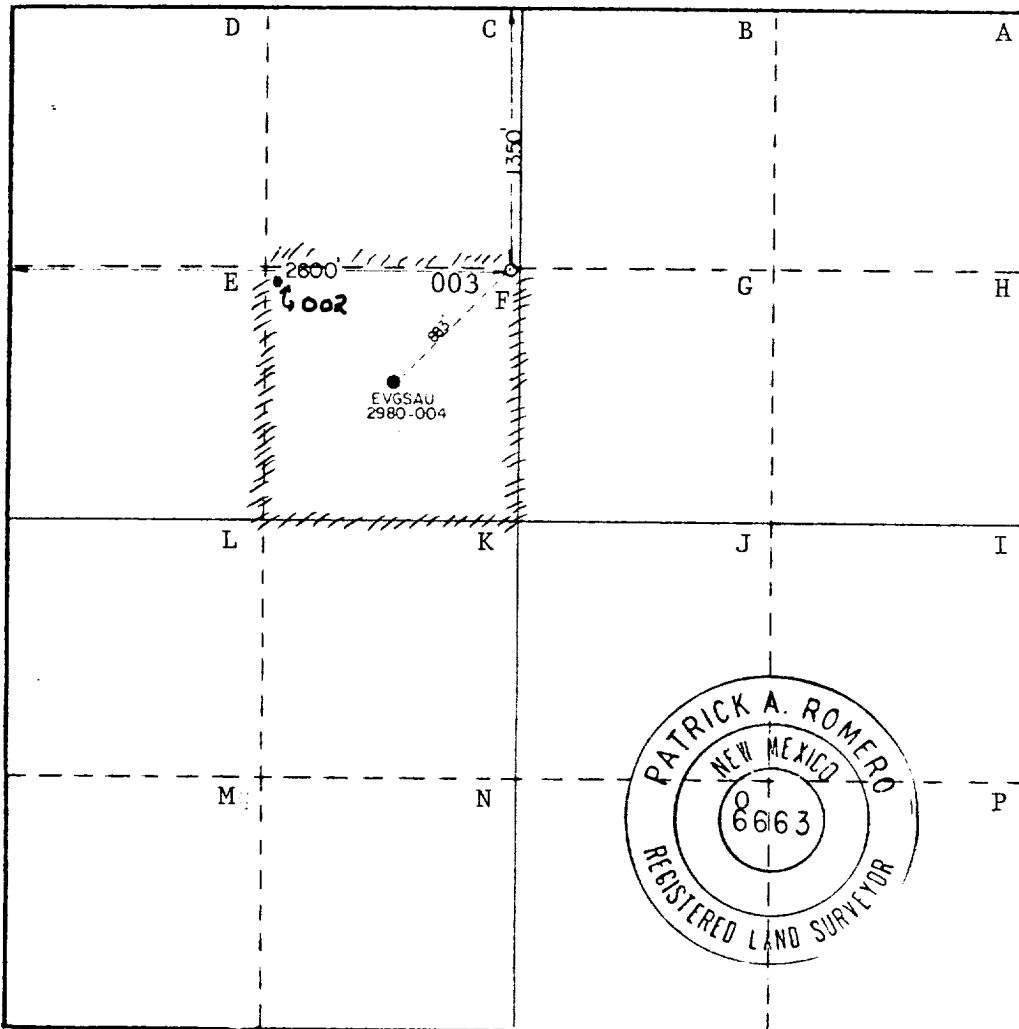

CERTIFICATION

I hereby certify that the information contained herein is true and complete to the best of my knowledge and belief.

W. J. Mueller

Name
W. J. Mueller

Position
Senior Engineering Specialist

Company
Phillips Petroleum Company

Date
March 12, 1981

I hereby certify that the well location shown on this plat was plotted from field notes of actual surveys made by me or under my supervision, and that the same is true and correct to the best of my knowledge and belief.

Date Surveyed
3-2-81

Registered Professional Engineer
and/or Land Surveyor

Patrick A. Romero

Certificate No. **JOHN W. WEST 676**
PATRICK A. ROMERO 6663
Ronald J. Eidson 3239

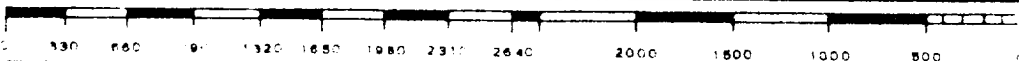

RECEIVED

MAR 16 1981

OPERATION DIV

173