

NO. OF COPIES RECEIVED	
DISTRIBUTION	
SANTA FE	
FILL	
U.S.G.S.	
LAND OFFICE	
OPERATION	

5A. Indicate Type of Lease
STATE <input checked="" type="checkbox"/> FEE <input type="checkbox"/>

5. State Oil & Gas Lease No.
B-936-18

APPLICATION FOR PERMIT TO DRILL, DEEPEN, OR PLUG BACK

1a. Type of Work		7. Unit Agreement Name	
b. Type of Well DRILL <input checked="" type="checkbox"/> DEEPEN <input type="checkbox"/> PLUG BACK <input type="checkbox"/> OIL WELL <input type="checkbox"/> GAS WELL <input type="checkbox"/> OTHER water injection SINGLE ZONE <input checked="" type="checkbox"/> MULTIPLE ZONE <input type="checkbox"/>		East Vacuum Gb/SA Unit	
2. Name of Operator		8. Farm or Lease Name	
Phillips Petroleum Company		East Vacuum Gb/SA Unit, Tract 1904	
3. Address of Operator		9. Well No.	
Room 401, 4001 Penbrook, Odessa, Texas 79762		003	
4. Location of Well		10. Field and Pool, or Wildcat	
UNIT LETTER N LOCATED 1300 FEET FROM THE south LINE		Vacuum Gb/SA	
AND 2625 FEET FROM THE west LINE OF SEC. 19 TWP. 17-S RGE. 35-E NEDESA		12. County	
		Lea	
19. Proposed Depth		19A. Formation	20. Rotary or C.T.
4800'		Gb/SA	Rotary
21. Elevations (Show whether DT, RT, etc.)	21A. Kind & Status Plug. Bond	21B. Drilling Contractor	22. Approx. Date Work will start
Advise later	blanket	Advise later	Upon approval

23.

PROPOSED CASING AND CEMENT PROGRAM

SIZE OF HOLE	SIZE OF CASING	WEIGHT PER FOOT	SETTING DEPTH	SACKS OF CEMENT	EST. TOP
12-1/4"	8-5/8"	24#, K-55	350' (Sufficient quantity of C	"C" w/2% CaCl	
			(& 1/4# Flocele/sx in 1st 150/sx circ surface)		
7-7/8"	4-1/2"	11.6#, N-80	4800' (Suff. THW w/12# salt/sx w/10% DD and		
			(1/4#/sx Flocele plus 3# Gilsonite/sx followed		
			(by 300 sxs C1 "C" cement w/8# salt/sx to circ		
			(surface).		

(This well is in the same proration unit as Well No. 001)

Administrative approval, provided by Special Order R-5897, of unorthodox location has been requested by separate letter.

Use mud additives as Required for Control.

BOP: Series 900, 3000# WP, double w/one set pipe rams and one set blind rams.

APPROVAL VALID FOR 180 DAYS
PERMIT EXPIRES 9/3/81
UNLESS DRILLING UNDERWAY

IN ABOVE SPACE DESCRIBE PROPOSED PROGRAM; IF PROPOSAL IS TO DEEPEN OR PLUG BACK, GIVE DATA ON PRESENT PRODUCTIVE ZONE AND PROPOSED NEW PRODUCTIVE ZONE. GIVE BLOWOUT PREVENTER PROGRAM, IF ANY.

I hereby certify that the information above is true and complete to the best of my knowledge and belief.

Signed W. J. Mueller Title Senior Engineering Specialist Date 3-23-81APPROVED BY Leslie H. Clements TITLE Manager DATE 3-23-81
CONDITIONS OF APPROVAL, IF ANY:

NEW MEXICO OIL CONSERVATION COMMISSION
W LOCATION AND ACREAGE DEDICATION PLAT

Form C-102
Supersedes C-128
Effective 1-1-65

All distances must be from the outer boundaries of the Section

Operator Phillips Petroleum Co.			Lease EVGSAU Tract 1904		Well No. 003
Unit Letter N	Section 19	Township 17. South	Range 35 East	County Lea	
Actual Footage Location of Well: 1300 feet from the South line and 2625 feet from the West line					
Ground Level Elev. later	Producing Formation Grayburg/San Andres		Pool Vacuum Gb/San Andres	Dedicated Acreage: water injection Acres	

1. Outline the acreage dedicated to the subject well by colored pencil or hachure marks on the plat below.
2. If more than one lease is dedicated to the well, outline each and identify the ownership thereof (both as to working interest and royalty).
3. If more than one lease of different ownership is dedicated to the well, have the interests of all owners been consolidated by communitization, unitization, force-pooling, etc?

☐ Yes ☐ No If answer is "yes," type of consolidation _____

If answer is "no," list the owners and tract descriptions which have actually been consolidated. (Use reverse side of this form if necessary.) _____

No allowable will be assigned to the well until all interests have been consolidated (by communitization, unitization, forced-pooling, or otherwise) or until a non-standard unit, eliminating such interests, has been approved by the Commission.

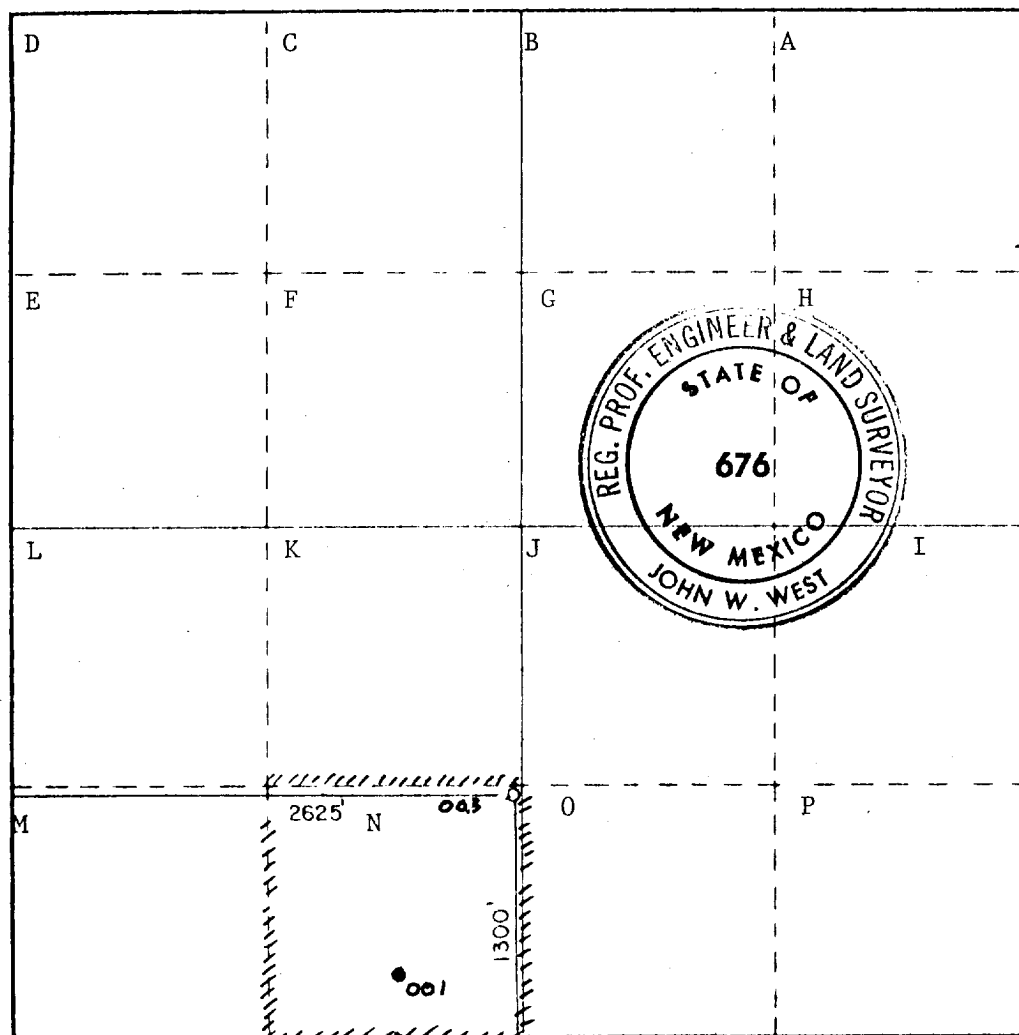

CERTIFICATION

I hereby certify that the information contained herein is true and complete to the best of my knowledge and belief.

W. J. Mueller
Position Sr. Engineering Specialist
Phillips Petroleum Company

Company

March 23, 1981

Date

I hereby certify that the well location shown on this plat was plotted from field notes of actual surveys made by me or under my supervision, and that the same is true and correct to the best of my knowledge and belief.

Date Surveyed

3-6-81

Registered Professional Engineer and/or Land Surveyor

Certificate No. JOHN W. WEST 676
PATRICK A. ROMERO 6483
Ronald J. Eidson 3239

The diagram illustrates a wellhead assembly with the following components and connections:

- HYDRIL GK ACCEPTABLE IN PLACE OF UPPER RAM-TYPE PREVENTER:** A label pointing to the upper ram assembly.
- PIPE RAMS:** Two ram assemblies, each consisting of a central body (1) and two side ram sections (2).
- BLIND RAMS:** Two ram assemblies, each consisting of a central body (1) and two side ram sections (2).
- CHOKE MANIFOLD:** A central manifold with multiple ports, including a top port (4), a bottom port (5), and several side ports (2, 3, 7).
- KILL LINE:** A line connecting the top of the wellhead to the choke manifold.
- EMERGENCY KILL LINE:** A line connecting the bottom of the wellhead to the choke manifold.
- PIPE RAMS BLIND RAMS:** A label pointing to the lower ram assembly.

- NOTES:**

2. VALVES MAY BE EITHER HAND OR POWER OPERATED BUT, IF POWER OPERATED, THE VALVES FLANGED TO THE BOP RUN MUST BE CAPABLE OF BEING OPENED AND CLOSED MANUALLY OR CLOSE ON POWER FAILURE AND BE CAPABLE OF BEING OPENED MANUALLY

PHILLIPS PETROLEUM COMPANY
3000 PSI WORKING PRESSURE
BLOWOUT PREVENTER HOOK-UP
(SERIES 900 FLANGES OR BETTER)