

NO. OF COPIES RECEIVED	
DISTRIBUTION	
SANTA FE	
FILE	
U.S.G.S.	
LAND OFFICE	
OPERATOR	

5A. Indicate Type of Lease	
STATE <input checked="" type="checkbox"/>	FEE <input type="checkbox"/>
5. State Oil & Gas Lease No.	
B-1838-3	
7. Unit Agreement Name	
East Vacuum Gb/SA Unit	
8. Farm or Lease Name	
East Vacuum Gb/SA Unit, Tract 2437	
9. Well No.	
003	
10. Field and Pool, or Wildcat	
Vacuum Gb/SA	
12. County	
Lea	

APPLICATION FOR PERMIT TO DRILL, DEEPEN, OR PLUG BACK

1. Type of Work		2. Type of Well		3. Name of Operator		4. Location of Well		5. Proposed Depth		6. Formation		7. Rotary or C.T.	
DRILL <input checked="" type="checkbox"/> DEEPEN <input type="checkbox"/> PLUG BACK <input type="checkbox"/>		OIL WELL <input type="checkbox"/> GAS WELL <input type="checkbox"/> OTHER water injection SINGLE ZONE <input checked="" type="checkbox"/> MULTIPLE ZONE <input type="checkbox"/>		Phillips Petroleum Company		UNIT LETTER J LOCATED 1350 FEET FROM THE south LINE		4800'		Gb/SA		Rotary	
3. Address of Operator		4. Name of Operator		5. Location of Well		6. Proposed Depth		7. Formation		8. Rotary or C.T.		9. Date Work will start	
Room 401, 4001 Penbrook, Odessa, Texas 79762		Phillips Petroleum Company		UNIT LETTER J LOCATED 1350 FEET FROM THE south LINE		4800'		Gb/SA		Rotary		Upon approval	
1. Elevation (show whether DT, RT, etc.)		2. Kind & Status Plug. Bond		3. Drilling Contractor		4. Approx. Date Work will start		5. Proposed Depth		6. Formation		7. Rotary or C.T.	
3893.5 (Gr. unprepared)		blanket		Advise later		Upon approval		4800'		Gb/SA		Rotary	

PROPOSED CASING AND CEMENT PROGRAM

SIZE OF HOLE	SIZE OF CASING	WEIGHT PER FOOT	SETTING DEPTH	SACKS OF CEMENT	EST. TOP
12-1/4"	8-5/8"	24#, K-55	350' (Sufficient quantity of C1 "C" w/2% CaCl (& 1/4# Flocele/sx in 1st 150/sx circ surface)		
7-7/8"	4-1/2"	11.6#, N-80	4800' (Suff. TRLW w/12# salt/sx w/10% DD and (1/4#/sx Flocele plus 3# Gilsonite/sx followed (by 300 sxs C1 "C" cement w/8# salt/sx to circ (surface).		

(This well is in the same proration unit as Well No. 002)

Administrative approval, provided by Special Order R-5897, of unorthodox location has been requested by separate letter.

Use mud additives as Required for Control.

BOP: Series 900, 3000# WP, double w/one set pipe rams and one set blind rams.

APPROVAL VALID FOR 180 DAYS
PERMIT EXPIRES 3/31/81
UNLESS DRILLING UNDERWAY

IN ABOVE SPACE DESCRIBE PROPOSED PROGRAM; IF PROPOSAL IS TO DEEPEN OR PLUG BACK, GIVE DATA ON PRESENT PRODUCTIVE ZONE AND PROPOSED NEW PRO-
TIV. ZONE. GIVE BLOWOUT PREVENTER PROGRAM, IF ANY.

I hereby certify that the information above is true and complete to the best of my knowledge and belief.

Signed W. J. Mueller Title Senior Engineering Specialist Date 3-23-81

(This space for State Use)

APPROVED BY Lester N. Clement TITLE DATE

CONDITIONS OF APPROVAL, IF ANY:

NEW MEXICO OIL CONSERVATION COMMISSION
 LOCATION AND ACREAGE DEDICAT. PLAT

Form C-102
 Supersedes C-128
 Effective 1-1-85

All distances must be from the outer boundaries of the Section

Operator Phillips Petroleum Co.		Lease EVGSAU		Tract 2437		Well No. 003
Unit Letter J	Section 24	Township 17 South	Range 34 East	County Lea		
Actual Footage Location of Well: 1350 feet from the South line and 1350 feet from the East line						
Ground Level Elev. 3893.5	Producing Formation Grayburg/San Andres		Pool Vacuum Gb/San Andres		Dedicated Acreage: water injection Acres	

- Outline the acreage dedicated to the subject well by colored pencil or hachure marks on the plat below.
- If more than one lease is dedicated to the well, outline each and identify the ownership thereof (both as to working interest and royalty).
- If more than one lease of different ownership is dedicated to the well, have the interests of all owners been consolidated by communitization, unitization, force-pooling, etc?

☐ Yes ☐ No If answer is "yes," type of consolidation _____

If answer is "no," list the owners and tract descriptions which have actually been consolidated. (Use reverse side of this form if necessary.) _____

No allowable will be assigned to the well until all interests have been consolidated (by communitization, unitization, forced-pooling, or otherwise) or until a non-standard unit, eliminating such interests, has been approved by the Commission.

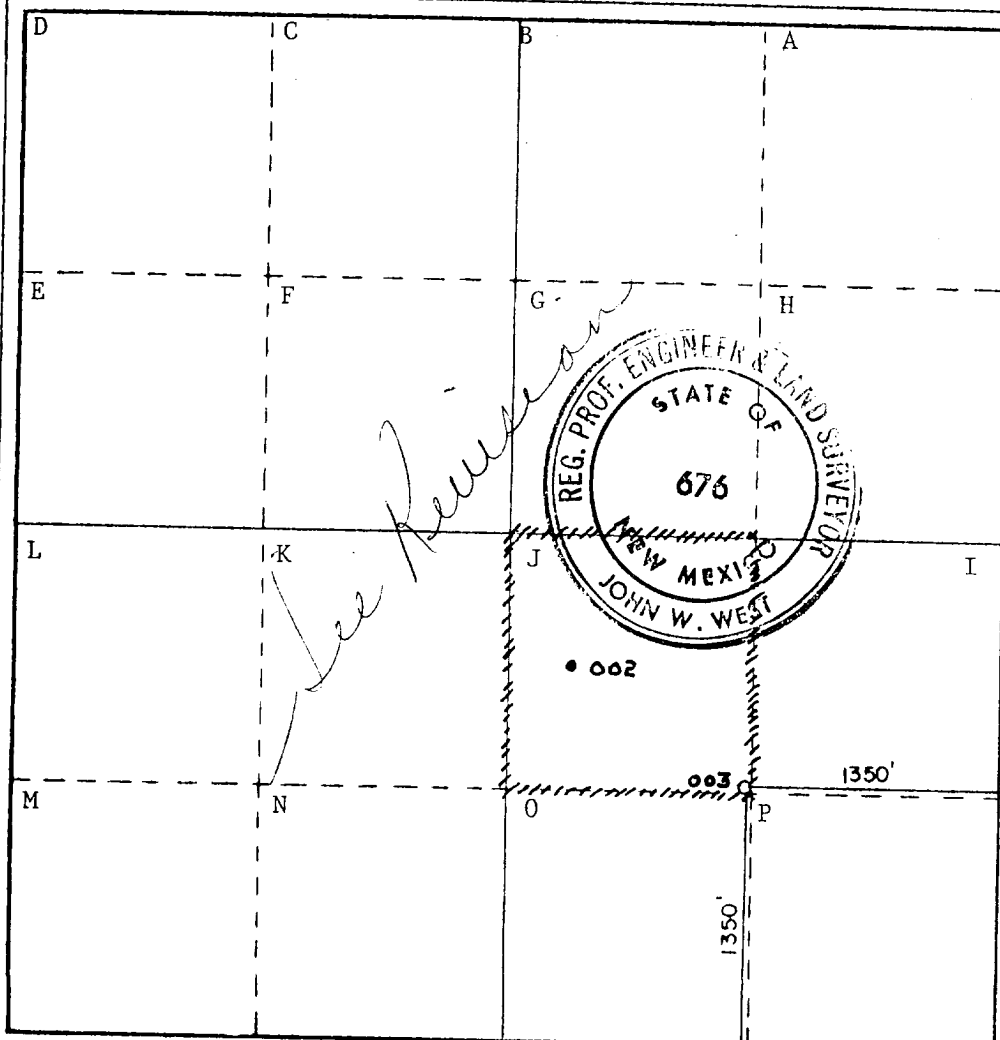

CERTIFICATION

I hereby certify that the information contained herein is true and complete to the best of my knowledge and belief.

W. J. Mueller
 Position
 Senior Engineering Specialist
 Company
 Phillips Petroleum Company
 Date
 March 23, 1981

I hereby certify that the well location shown on this plat was plotted from field notes of actual surveys made by me or under my supervision, and that the same is true and correct to the best of my knowledge and belief.

Date Surveyed
 3-9-81
 Registered Professional Engineer and/or Land Surveyor

Certificate No. JOHN W. WEST 676
 PATRICK A. ROMERO 8683
 Ronald J. Eidson 3239

Diagram illustrating the wellhead assembly and components, including the Kill Line, Pipe Rams, Blind Rams, Emergency Kill Line, and Choke Manifold.

Labels and components shown:

- KILL LINE
- PIPE RAMS
- BLIND RAMS
- EMERGENCY KILL LINE
- CHOKE MANIFOLD
- CHOKE
- MANIFOLD
- HYDRIL GK ACCEPTABLE IN PLACE OF UPPER RAM-TYPE PREVENTER

Numbered components (1-7) are indicated throughout the diagram.

2. VALVES MAY BE EITHER HAND OR POWER OPERATED BUT, IF POWER OPERATED, THE VALVES FLANGED TO THE BOP RUN MUST BE CAPABLE OF BEING OPENED AND CLOSED MANUALLY OR CLOSE ON POWER FAILURE AND BE CAPABLE OF BEING OPENED MANUALLY.

FIGURE NO. 7

100-100000
MAR 25 1968

173