

NO. OF COPIES RECEIVED	
DISTRIBUTION	
SANTA FE	
FILL	
U.S.G.S.	
LAND OFFICE	
OPERATOR	

5A. Indicate Type of Lease  
STATE ☒ YES ☐

5. State Oil & Gas Lease No.  
B-1398-14

APPLICATION FOR PERMIT TO DRILL, DEEPEN, OR PLUG BACK

1a. Type of Work DRILL <input checked="" type="checkbox"/> DEEPEN <input type="checkbox"/> PLUG BACK <input type="checkbox"/>		7. Unit Agreement Name East Vacuum Gb/SA Unit
b. Type of Well OIL WELL <input type="checkbox"/> GAS WELL <input type="checkbox"/> OTHER water injection SINGLE ZONE <input checked="" type="checkbox"/> MULTIPLE ZONE <input type="checkbox"/>		8. Farm or Lease Name East Vacuum Gb/SA Unit, Tract 1910
2. Name of Operator Phillips Petroleum Company		9. Well No. 004
3. Address of Operator Room 401, 4001 Penbrook, Odessa, Texas 79762		10. Field and Pool, or Wildcat Vacuum Gb/SA
4. Location of Well UNIT LETTER P LOCATED 1200 FEET FROM THE south LINE AND 1200 FEET FROM THE east LINE OF SEC. 19 TWP. 17-S RGE. 35-E NMPM		12. County Lea
19. Proposed Depth 4800'		19A. Formation Gb/SA
20. Rotary or C.T. Rotary		
21. Elevations (show whether DT, RT, etc.) 3977.8 (unprepared)	21A. Kind & Status Plug. Bond blanket	21B. Drilling Contractor Advise later
22. Approx. Date Work will start Upon approval		

23.

PROPOSED CASING AND CEMENT PROGRAM

SIZE OF HOLE	SIZE OF CASING	WEIGHT PER FOOT	SETTING DEPTH	SACKS OF CEMENT	EST. TOP
12-1/4"	8-5/8"	24#, K-55	350' (Sufficient quantity of C1 "C" w/2% CaCl (& 1/4# Flocele/sx in 1st 150/sx circ surface).		
7-7/8"	4-1/2"	11.6#, N-80	4800' (Suff. TRW w/12# salt/sx w/10% DD and (1/4#sx Flocele plus 3# Gilsonite/sx followed (by 300 sxs C1 "C" cmenet w/8# salt/sx to circ (surface).		

(This well is in the same proration unit as Well No.002.)

Administrative approval, provided by Special Order R-5897, of unorthodox location has been requested by separate letter.

Use mud additives as Required for Control.

BOP: Series 900, 3000# WP, double w/one set pipe rams and one set blind rams.

APPROVAL VALID FOR 180 DAYS  
PERMIT EXPIRES 10/9/81  
UNLESS DRILLING UNDERWAY

NSL-1349  
J. J. Hill

IN ABOVE SPACE DESCRIBE PROPOSED PROGRAM; IF PROPOSAL IS TO DEEPEN OR PLUG BACK, GIVE DATA ON PRESENT PRODUCTIVE ZONE AND PROPOSED NEW PRODUCTIVE ZONE. GIVE BLOWOUT PREVENTER PROGRAM, IF ANY.

I hereby certify that the information above is true and complete to the best of my knowledge and belief.

Signed J. J. Hill W. J. Mueller Title Senior Engineering Specialist Date MAR 30 1981

(This space for State Use)

APPROVED BY [Signature] TITLE SUPERVISOR IN CHARGE DATE 1981

CONDITIONS OF APPROVAL, IF ANY:

**NEW MEXICO OIL CONSERVATION COMMISSION  
WELL LOCATION AND ACREAGE DEDICATION PLAT**

Form C-102  
Supersedes C-128  
Effective 1-1-65

All distances must be from the outer boundaries of the Section.

Operator <b>Phillips Petroleum Co.</b>		Lease <b>EVGSAU Tract 1910</b>		Well No. <b>004</b>
Unit Letter <b>P</b>	Section <b>19</b>	Township <b>17 South</b>	Range <b>35 East</b>	County <b>Lea</b>

Actual Footage Location of Well:  
**1200** feet from the **South** line and **1200** feet from the **East** line

Ground Level Elev. <b>3977.8 (unprepared)</b>	Producing Formation <b>Grayburg/San Andres</b>	Pool <b>Vacuum Gb/San Andres</b>	Dedicated Acreage: <b>water injection</b> Acres
--	---	-------------------------------------	--

1. Outline the acreage dedicated to the subject well by colored pencil or hachure marks on the plat below.
2. If more than one lease is dedicated to the well, outline each and identify the ownership thereof (both as to working interest and royalty).
3. If more than one lease of different ownership is dedicated to the well, have the interests of all owners been consolidated by communitization, unitization, force-pooling, etc?

☐ Yes    ☐ No    If answer is "yes," type of consolidation \_\_\_\_\_

If answer is "no," list the owners and tract descriptions which have actually been consolidated. (Use reverse side of this form if necessary.) \_\_\_\_\_

No allowable will be assigned to the well until all interests have been consolidated (by communitization, unitization, forced-pooling, or otherwise) or until a non-standard unit, eliminating such interests, has been approved by the Commission.

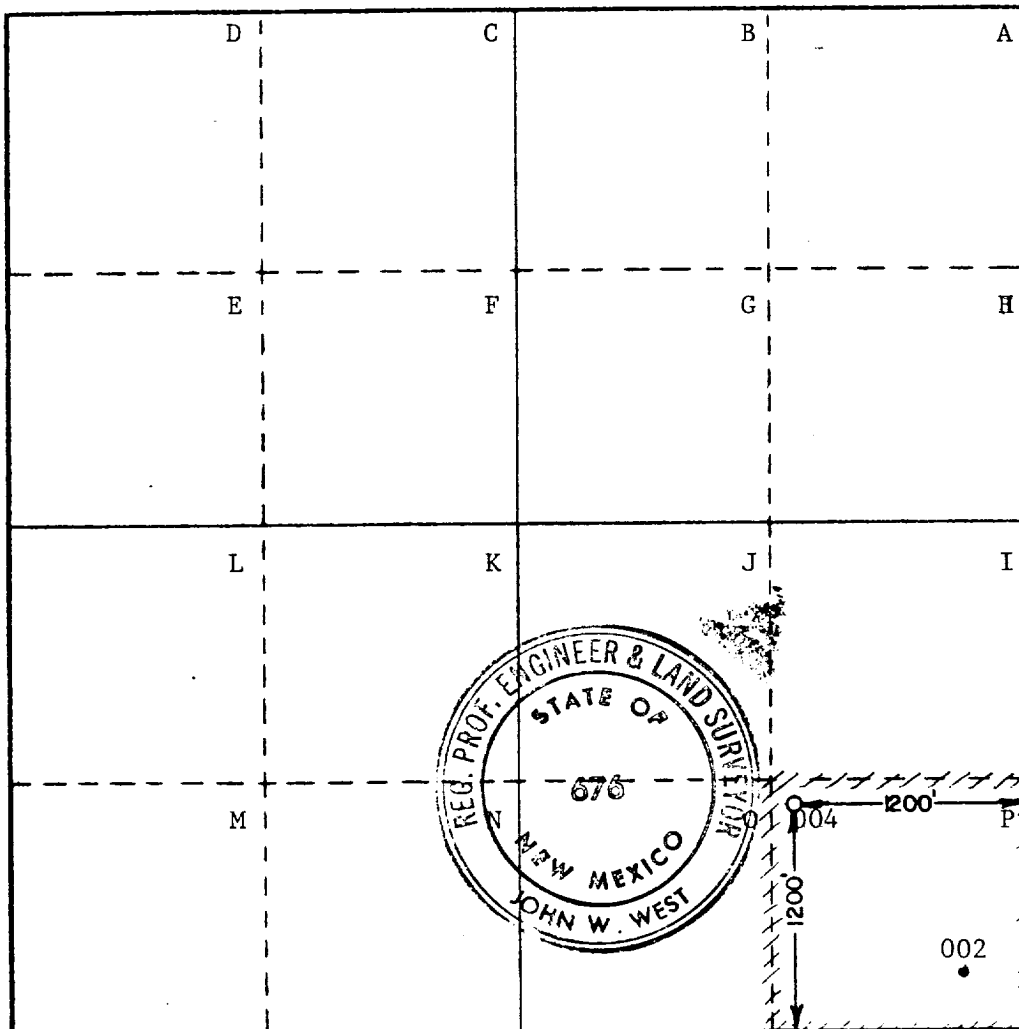

**CERTIFICATION**

I hereby certify that the information contained herein is true and complete to the best of my knowledge and belief.

*[Signature]*  
**W. J. Mueller**  
 Sr. Engineering Specialist  
 Position  
**Phillips Petroleum Company**  
 Company

Date  
**MAR 30 1981**

I hereby certify that the well location shown on this plat was plotted from field notes of actual surveys made by me or under my supervision, and that the same is true and correct to the best of my knowledge and belief.

Date Surveyed  
**3-5-81**

Registered Professional Engineer and/or Land Surveyor

*[Signature]*  
 Certificate No. **JOHN W. WEST 676**  
**PATRICK A. ROMERO 6663**  
**Ronald J. Eidson 3239**

0 320 640 960 1280 1600 1920 2240 2400 2000 1800 1600 1400 1200 1000 800 0

# DOUBLE PREVENTER OPTION

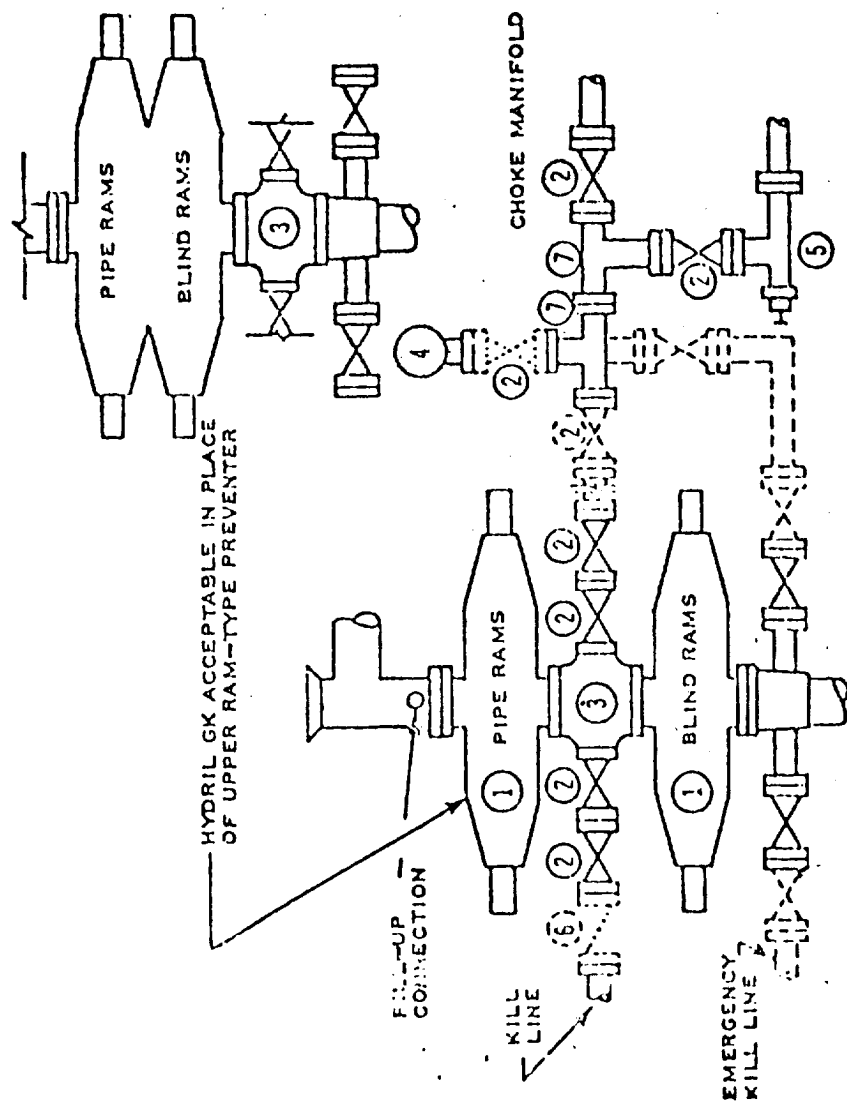

- ① SERIES 900 RAM-TYPE BOP
- ② 2" SERIES 900 VALVE
- ③ SERIES 900 DRILLING SPOOL
- ④ 2" MUD PRESSURE GAUGE
- ⑤ 2" SERIES 900 CHOKE
- ⑥ 2" SERIES 900 CHECK VALVE
- ⑦ 2" SERIES 900 STEEL TEE

## NOTES:

1. 3000 PSI WP CLAMP  
HUSSES MAY BE SUBSTITUTED  
FOR FLANGES

2. VALVES MAY BE EITHER HAND OR POWER  
OPERATED BUT, IF POWER OPERATED,  
THE VALVES FLANGED TO THE BOP RUN  
MUST BE CAPABLE OF BEING OPENED AND  
CLOSED MANUALLY OR CLOSE ON POWER  
FAILURE AND BE CAPABLE OF BEING  
OPENED MANUALLY

..... OPTIONAL EQUIPMENT

PHILLIPS PETROLEUM COMPANY

3000 PSI WORKING PRESSURE  
BLOWOUT PREVENTER HOOK-UP  
(SERIES 900 FLANGES OR BETTER)

REV 6/73

FIGURE NO. 7

RECEIVED

APR 1 1981

OIL CONSERVATION DIV.

173