

STATE OF NEW MEXICO
ENERGY AND MINERALS DEPARTMENT

L CONSERVATION DIVISION
P. O. BOX 2088
SANTA FE, NEW MEXICO 87501

20-005-21075

Form C-101
Revised 10-1-78

NO. OF COPIES RECEIVED	
DISTRIBUTION	
SANTA FE	
FILE	
U.S.G.P.	
LAND OFFICE	
OPERATION	

5A. Indicate Type of Lease
STATE ☒ FEE ☐
5. State Oil & Gas Lease No.
B-1482-3

APPLICATION FOR PERMIT TO DRILL, DEEPEN, OR PLUG BACK

1a. Type of Work b. Type of Well OIL WELL <input type="checkbox"/> GAS WELL <input type="checkbox"/> OTHER <input type="checkbox"/> water injection SINGLE ZONE <input checked="" type="checkbox"/> MULTIPLE ZONE <input type="checkbox"/>		7. Unit Agreement Name East Vacuum Gb/SA Unit 8. Farm or Lease Name East Vacuum Gb/SA Unit, Tract 2720 9. Well No. 008 10. Field and Pool, or Wildcat Vacuum Gb/SA 12. County Lea	
2. Name of Operator Phillips Petroleum Company 3. Address of Operator Room 401, 4001 Penbrook, Odessa, Texas 79762 4. Location of Well UNIT LETTER B LOCATED 50 FEET FROM THE north LINE AND 2500 FEET FROM THE east LINE OF SEC. 27 TWP. 17-S RGE. 35-E NMPM		19. Proposed Depth 4800' 19A. Formation Gb/SA 20. Rotary or C.T. Rotary	
21. Elevations (Show whether DT, RT, etc.) 3937.2 (unprepared)		21A. Kind & Status Plug. Bond blanket 21B. Drilling Contractor Advise later 22. Approx. Date Work will start Upon approval	

PROPOSED CASING AND CEMENT PROGRAM

SIZE OF HOLE	SIZE OF CASING	WEIGHT PER FOOT	SETTING DEPTH	SACKS OF CEMENT	EST. TOP
12-1/4"	8-5/8"	24#, K-55	350' (Sufficient quantity of C1 "C" w/2% CaCl (& 1/4# Flocele/sx in 1st 150/sx circ surface).		
7-7/8"	4-1/2"	11.6#, N-80	4800' (Suff. TRLW w/12# salt/sx w/10% DD and (1/4#/sx Flocele plus 3# Gilsonite/sx followed (by 300 sxs C1 "C" cement w/8# salt/sx to circ (surface).		

(This well is in the same proration unit as Well No.s 003 and 005.)

Administrative approval, provided by Special Order R-5897, of unorthodox location has been requested by separate letter.

Use mud additives as Required for Control.

BOP: Series 900, 3000# WP, double w/one set pipe rams and one set blind rams.

NSL-1349 Inj. Well

APPROVAL DATE 1/80
1/19/81

IN ABOVE SPACE DESCRIBE PROPOSED PROGRAM: IF PROPOSAL IS TO DEEPEN OR PLUG BACK, GIVE DATA ON PRESENT PRODUCTIVE ZONE AND PROPOSED NEW PRODUCTIVE ZONE. GIVE BLOWOUT PREVENTER PROGRAM, IF ANY.

I hereby certify that the information above is true and complete to the best of my knowledge and belief.

Signed W. J. Mueller Title Sr. Engineering Specialist Date MAR 30 1981

(This space for State Use)

APPROVED BY [Signature] TITLE SUPERVISOR DISTRICT DATE 380

CONDITIONS OF APPROVAL, IF ANY:

NEW MEXICO OIL CONSERVATION COMMISSION
WELL LOCATION AND ACREAGE DEDICATION PLAT

Form C-102
Supersedes C-128
Effective 1-1-65

All distances must be from the outer boundaries of the Section.

Operator Phillips Petroleum Co.		Lease EVGSAU Tract 2720		Well No. 008
Unit Letter B	Section 27	Township 17 South	Range 35 East	County Lea
Actual Footage Location of Well: 50 feet from the North line and 2500 feet from the East line				
Ground Level Elev. 3937.2 (unprepared)	Producing Formation Grayburg/San Andres	Pool Vacuum Gb/San Andres	Dedicated Acreage: water injection Acres	

1. Outline the acreage dedicated to the subject well by colored pencil or hatchure marks on the plat below.
2. If more than one lease is dedicated to the well, outline each and identify the ownership thereof (both as to working interest and royalty).
3. If more than one lease of different ownership is dedicated to the well, have the interests of all owners been consolidated by communitization, unitization, force-pooling, etc?

☐ Yes ☐ No If answer is "yes," type of consolidation _____

If answer is "no," list the owners and tract descriptions which have actually been consolidated. (Use reverse side of this form if necessary.) _____

No allowable will be assigned to the well until all interests have been consolidated (by communitization, unitization, forced-pooling, or otherwise) or until a non-standard unit, eliminating such interests, has been approved by the Commission.

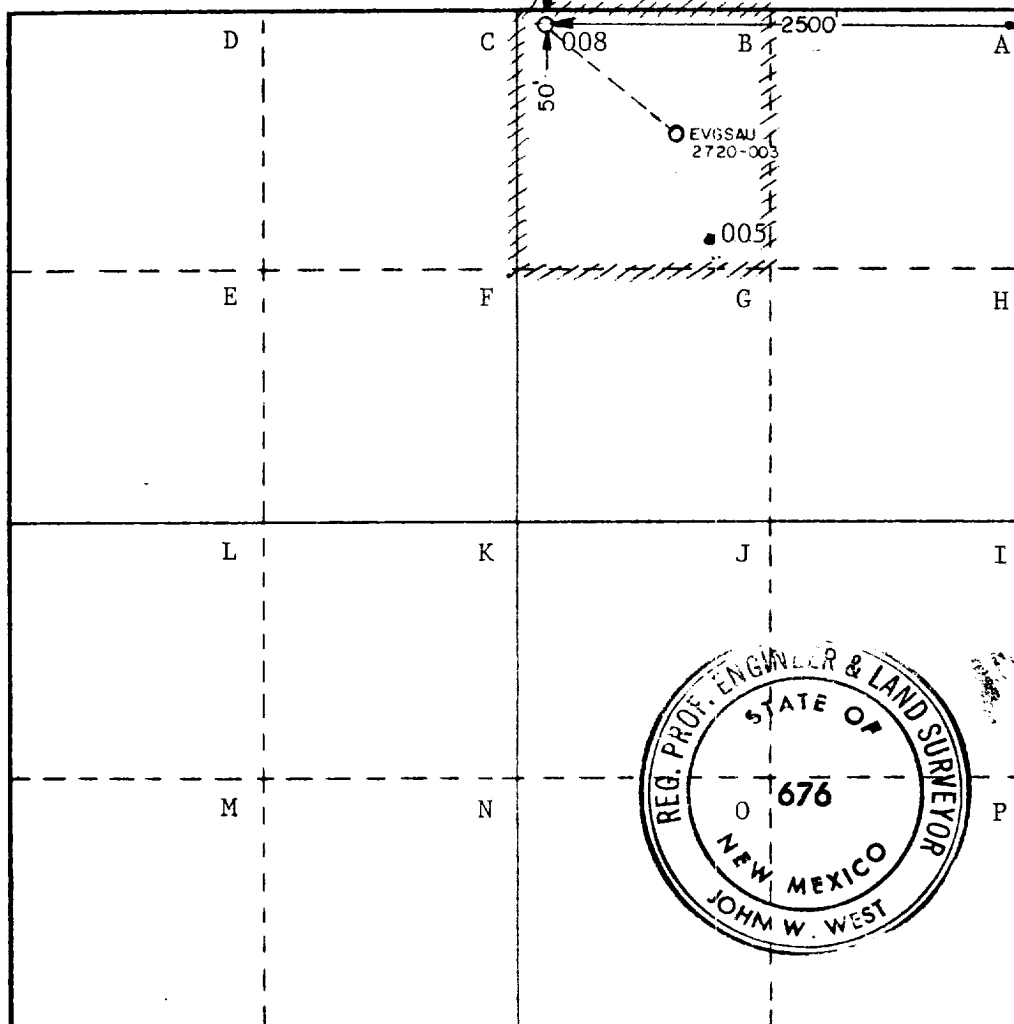

CERTIFICATION

I hereby certify that the information contained herein is true and complete to the best of my knowledge and belief.

W. J. Mueller
Sr. Engineering Specialist
Position
Phillips Petroleum Company
Company

Date
MAR 30 1981

I hereby certify that the well location shown on this plat was plotted from field notes of actual surveys made by me or under my supervision, and that the same is true and correct to the best of my knowledge and belief.

Date Surveyed
3-4-81

Registered Professional Engineer
and/or Land Surveyor

Certificate No. JOHN W. WEST 676
PATRICK A. ROMERO 6863
Ronald J. Eidson 3239

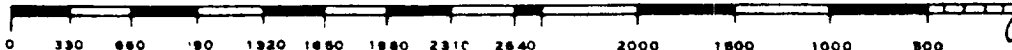
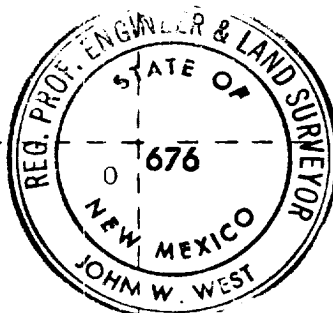

DOUBLE PREVENTER OPTION

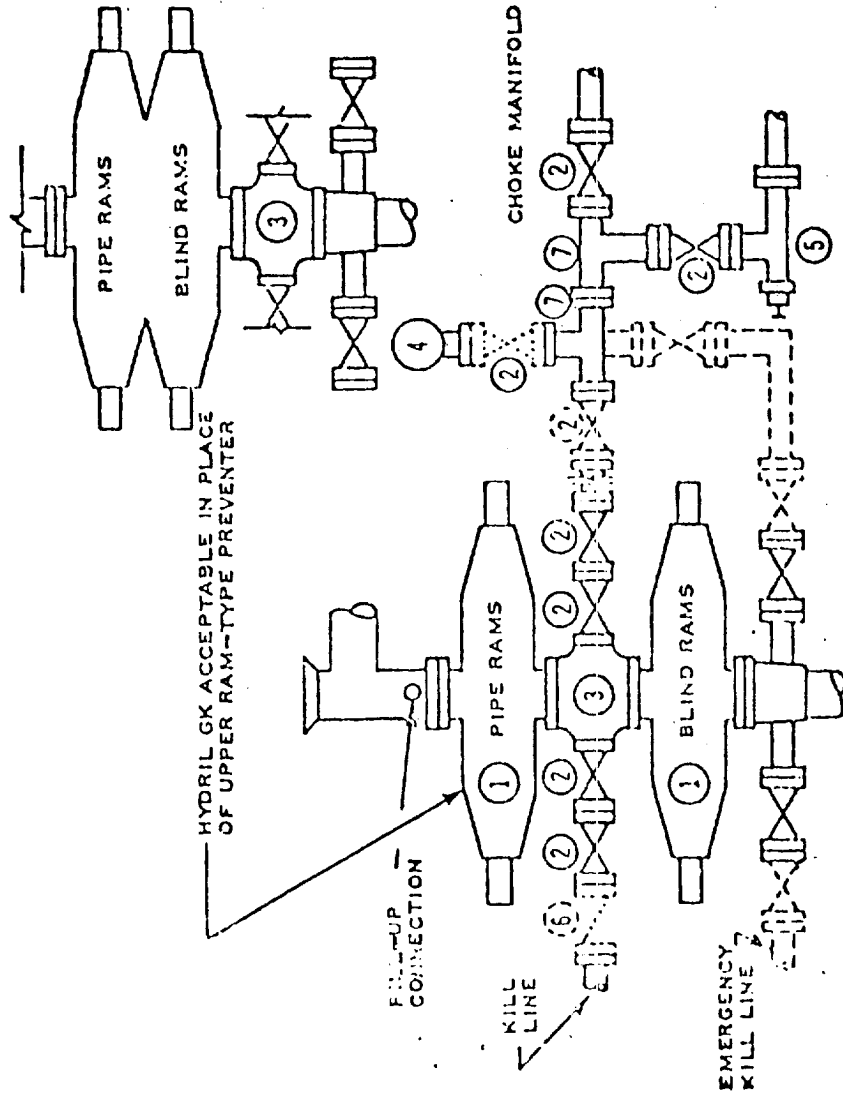

- ① SERIES 900 RAM-TYPE BOP
- ② 2" SERIES 900 VALVE
- ③ SERIES 900 DRILLING SPOOL
- ④ 2" MUD PRESSURE GAUGE
- ⑤ 2" SERIES 900 CHOKE
- ⑥ 2" SERIES 900 CHECK VALVE
- ⑦ 2" SERIES 900 STEEL TEE

NOTES:

1. 3000 PSI WP CLAMP
HUSS MAY BE SUBSTITUTED
FOR FLANGES
2. VALVES MAY BE EITHER HAND OR POWER
OPERATED BUT, IF POWER OPERATED,
THE VALVES FLANGED TO THE BOP RUN
MUST BE CAPABLE OF BEING OPENED AND
CLOSED MANUALLY OR CLOSE ON POWER
FAILURE AND BE CAPABLE OF BEING
OPENED MANUALLY

..... OPTIONAL EQUIPMENT

PHILLIPS PETROLEUM COMPANY

3000 PSI WORKING PRESSURE
BLOWOUT PREVENTER HOOK-UP
(SERIES 900 FLANGES OR BETTER)

REV 6/73

FIGURE NO. 7

RECEIVED

APR 1 1981

OIL CONSERVATION DIV.

173