

STATE OF NEW MEXICO
ENERGY AND MINERALS DEPARTMENT

OIL CONSERVATION DIVISION

P. O. BOX 2088
SANTA FE, NEW MEXICO 87501

Form C-101
Revised 10-1-78

NO. OF COPIES RECEIVED	
DISTRIBUTION	
SANTA FE	
FILE	
U.S.G.S.	
LAND OFFICE	
OPERATOR	

5A. Indicate Type of Lease
STATE ☒ FCC ☐
5. State Oil & Gas Lease No.
B-1404-2

APPLICATION FOR PERMIT TO DRILL, DEEPEN, OR PLUG BACK

1a. Type of Work DRILL <input checked="" type="checkbox"/> DEEPEN <input type="checkbox"/> PLUG BACK <input type="checkbox"/>		7. Unit Agreement Name East Vacuum Gb/SA Unit
b. Type of Well OIL WELL <input checked="" type="checkbox"/> GAS WELL <input type="checkbox"/> OTHER <input type="checkbox"/> SINGLE ZONE <input checked="" type="checkbox"/> MULTIPLE ZONE <input type="checkbox"/>		8. Farm or Lease Name East Vacuum Gb/SA Unit Tract 2416
2. Name of Operator Phillips Petroleum Company		9. Well No. 003
3. Address of Operator Room 401, 4001 Penbrook, Odessa, Texas 79762		10. Field and Pool, or Wildcat Vacuum Gb/SA
4. Location of Well UNIT LETTER <u>I</u> LOCATED <u>1780</u> FEET FROM THE <u>south</u> LINE AND <u>660</u> FEET FROM THE <u>east</u> LINE OF SEC. <u>24</u> TWP. <u>T-17-S</u> RGE. <u>R-34-E</u> NMPM		11. County Lea
15. Proposed Depth 4800'		19A. Formation Gb/SA
21. Elevations (show whether DT, KI, etc.) 3996.5 Ground (unprepared)		20. Rotary or C.T. Rotary
21A. Kind & Status Plug. Bond blanket		22. Approx. Date Work will start Upon approval
21B. Drilling Contractor Advise later		

PROPOSED CASING AND CEMENT PROGRAM

SIZE OF HOLE	SIZE OF CASING	WEIGHT PER FOOT	SETTING DEPTH	SACKS OF CEMENT	EST. TOP
11"	8-5/8"	24#, K-55	350' (Suff. quantity of C1 H w/2% CaCl & (1/4# Flocele/sx in 1st 150/sxs). Circ surf.		
7-7/8"	5-1/2"	17#, K-55	4800' (Suff. TRLW w/12# salt/sx w/10% DD and (1/4#/sx Flocele plus 3# Gilsonite/sx followed (by 260 sxs C1 H cement w/8# salt/sx to circ (surface).		

(This well is in the same proration unit as well(s) No. 002)
Use mud additives as Required for Control.

BOP: Series 900, 3000# WP, double w/one set pipe rams and one set blind rams.

APPROVAL VALID FOR 180 DAYS
UNLESS DRILLING CONTINUED

IN ABOVE SPACE DESCRIBE PROPOSED PROGRAM; IF PROPOSAL IS TO DEEPEN OR PLUG BACK, GIVE DATA ON PRESENT PRODUCTIVE ZONE AND PROPOSED NEW PRODUCTIVE ZONE. GIVE BLOWOUT PREVENTER PROGRAM, IF ANY.

I hereby certify that the information above is true and complete to the best of my knowledge and belief.

Signed W. J. Mueller Title Senior Engineering Specialist Date May 13, 1981
(This space for State Use)

APPROVED BY [Signature] TITLE [Signature] DATE [Signature]
CONDITIONS OF APPROVAL, IF ANY:

NEW MEXICO OIL CONSERVATION COMMISSION
WELL LOCATION AND ACREAGE DEDICATION PLAT

Form C-102
Supersedes C-128
Effective 1-1-65

All distances must be from the outer boundaries of the Section

Operator PHILLIPS PETROLEUM COMPANY			Lease East Vacuum Gb/SA Unit, Tract 2416		Well No. 003
Unit Letter I	Section 24	Township 17 South	Range 34 EAST	County LEA	
Actual Footage Location of Well: 1780 feet from the SOUTH line and 660 feet from the EAST line					
Ground Level Elev. 3996.5 (unprepared)	Producing Formation Grayburg/San Andres		Pool Vacuum Gb/SA	Dedicated Acreage: 40 Acres	

1. Outline the acreage dedicated to the subject well by colored pencil or hatchure marks on the plat below.
2. If more than one lease is dedicated to the well, outline each and identify the ownership thereof (both as to working interest and royalty).
3. If more than one lease of different ownership is dedicated to the well, have the interests of all owners been consolidated by communitization, unitization, force-pooling, etc?

☐ Yes ☐ No If answer is "yes," type of consolidation _____

If answer is "no," list the owners and tract descriptions which have actually been consolidated. (Use reverse side of this form if necessary.) _____

No allowable will be assigned to the well until all interests have been consolidated (by communitization, unitization, forced-pooling, or otherwise) or until a non-standard unit, eliminating such interests, has been approved by the Commission.

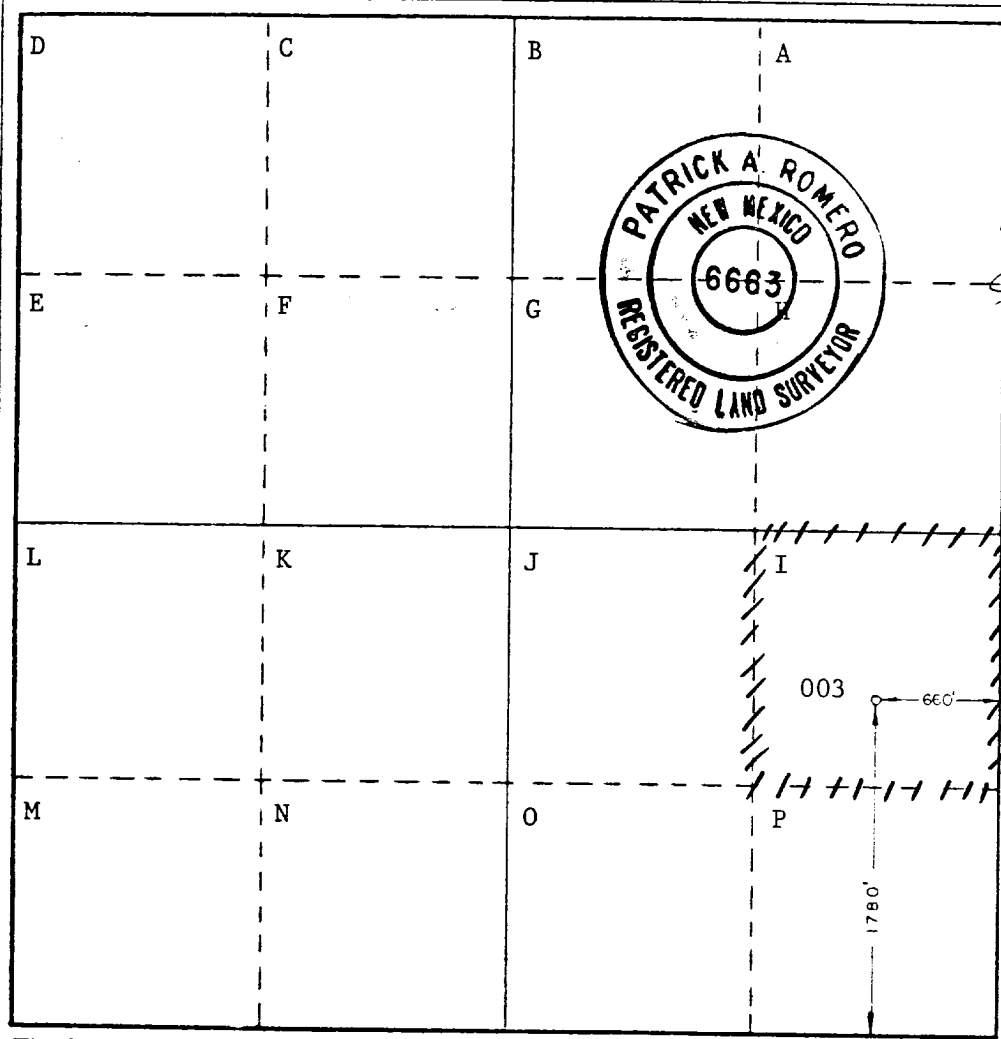

CERTIFICATION

I hereby certify that the information contained herein is true and complete to the best of my knowledge and belief.

Name
W. J. Mueller
Position
Sr. Engineering Specialist
Company
Phillips Petroleum Company
Date
May 13, 1981

I hereby certify that the well location shown on this plat was plotted from field notes of actual surveys made by me or under my supervision, and that the same is true and correct to the best of my knowledge and belief.

Date Surveyed
MAY 4, 1981
Registered Professional Engineer and/or Land Surveyor
Patrick A. Romero
Certificate No. **JOHN W. WEST 676**
PATRICK A. ROMERO 6663

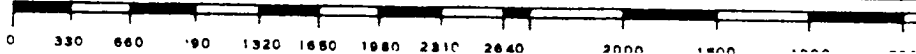

DOUBLE PREVENTER OPTION

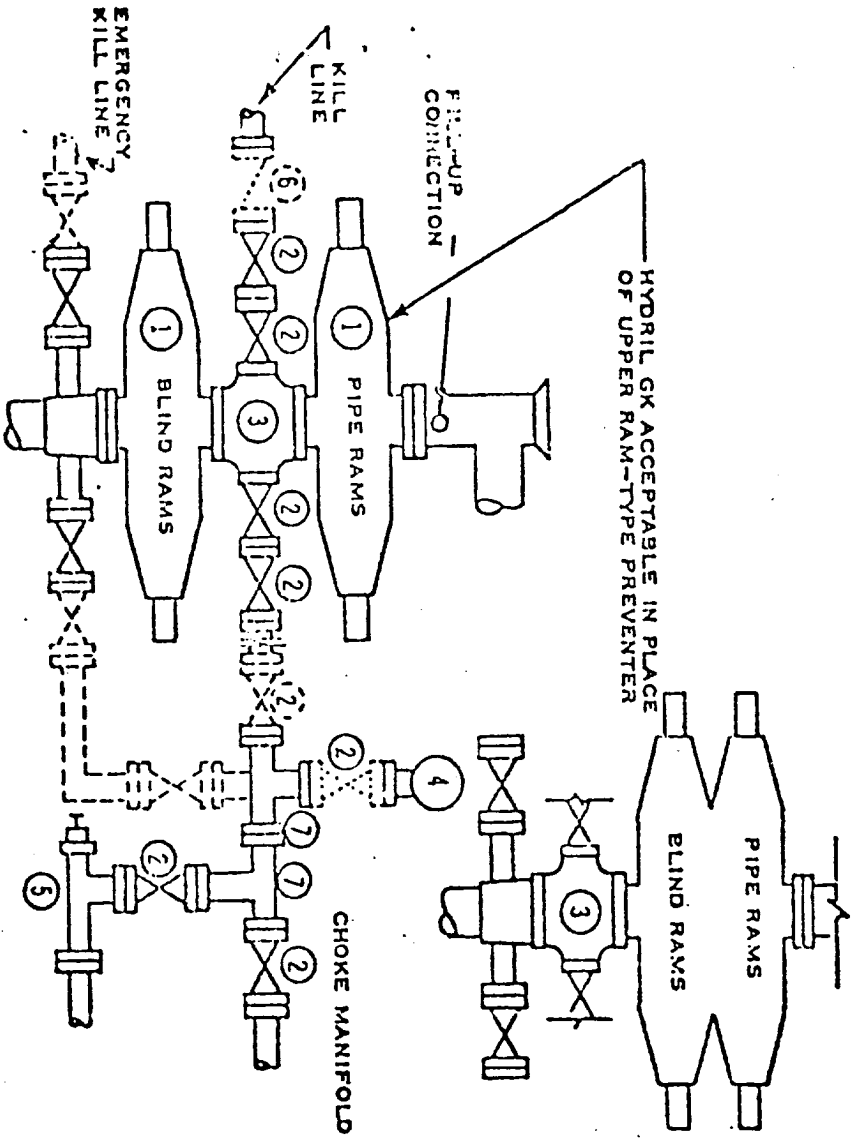

- ① SERIES 900 RAM-TYPE BOP
- ② 2" SERIES 900 VALVE
- ③ SERIES 900 DRILLING SPOOL
- ④ 2" MUD PRESSURE GAUGE
- ⑤ 2" SERIES 900 CHOKE
- ⑥ 2" SERIES 900 CHECK VALVE
- ⑦ 2" SERIES 900 STEEL TEE

NOTES:

1. 3000 PSI WP CLAMP HUBS MAY BE SUBSTITUTED FOR FLANGES
2. VALVES MAY BE EITHER HAND OR POWER OPERATED BUT, IF POWER OPERATED, THE VALVES FLANGED TO THE BOP RUN MUST BE CAPABLE OF BEING OPENED AND CLOSED MANUALLY OR CLOSE ON POWER FAILURE AND BE CAPABLE OF BEING OPENED MANUALLY

..... OPTIONAL EQUIPMENT

PHILLIPS PETROLEUM COMPANY

3000 PSI WORKING PRESSURE
BLOWOUT PREVENTER HOOK-UP
(SERIES 900 FLANGES OR BETTER)

RECEIVED
MAY 15 1981
OIL CONSERVATION DIV.
473