

NO. OF COPIES RECEIVED	
DISTRIBUTION	
SANTA FE	
FILE	
U.S.G.S.	
LAND OFFICE	
OPERATOR	

API# 30-025-27424

5A. Indicate Type of Lease  
STATE ☒ FEE ☐  
5. State Oil & Gas Lease No.  
K-6023-1

APPLICATION FOR PERMIT TO DRILL, DEEPEN, OR PLUG BACK

1a. Type of Work DRILL <input checked="" type="checkbox"/> DEEPEN <input type="checkbox"/> PLUG BACK <input type="checkbox"/>		7. Unit Agreement Name <u>East Vacuum Gb/SA Unit</u>
b. Type of Well OIL WELL <input checked="" type="checkbox"/> GAS WELL <input type="checkbox"/> OTHER <input type="checkbox"/> SINGLE ZONE <input checked="" type="checkbox"/> MULTIPLE ZONE <input type="checkbox"/>		8. Farm or Lease Name <u>East Vacuum Gb/SA Unit Tract 2083</u>
2. Name of Operator <u>Phillips Petroleum Company</u>		9. Well No. <u>002</u>
3. Address of Operator <u>Room 401, 4001 Penbrook, Odessa, Texas 79762</u>		10. Field and Pool, or Wildcat <u>Vacuum Gb/SA</u>
4. Location of Well UNIT LETTER <u>E</u> LOCATED <u>1980</u> FEET FROM THE <u>north</u> LINE AND <u>660</u> FEET FROM THE <u>west</u> LINE OF SEC. <u>20</u> TWP. <u>T-17-S</u> RGE. <u>R-35-E</u> NMPD		11. County <u>Lea</u>
19. Proposed Depth <u>4800'</u>		19A. Formation <u>Gb/SA</u>
20. Rotary or C.T. <u>Rotary</u>		
21. Elevations (Show whether DF, RT, etc.) <u>3977.7' Ground (unprepared)</u>	21A. Kind & Status Plug. Bond <u>blanket</u>	21B. Drilling Contractor <u>Advise later</u>
22. Approx. Date Work will start <u>Upon approval</u>		

23. PROPOSED CASING AND CEMENT PROGRAM

SIZE OF HOLE	SIZE OF CASING	WEIGHT PER FOOT	SETTING DEPTH	SACKS OF CEMENT	EST. TOP
11"	8-5/8"	24#, K-55	350' (Suff. quantity of Cl H w/2% CaCl (& 1/4# Flocele/sx in 1st 150/sx) Circ surface.		
7-7/8"	5-1/2"	17#, K-55	4800' (Suff. TRLW w/12# salt/sx w/10% DD and (1/4#/sx Flocele plus 3# Gilsonite/sx followed (by 260 sxs Cl H cement w/8# salt/sx to circ (surface).		

Use mud additives as Required for Control.

BOP: Series 900, 3000# WP, double w/one set pipe rams and one set blind rams.

IN ABOVE SPACE DESCRIBE PROPOSED PROGRAM: IF PROPOSAL IS TO DEEPEN OR PLUG BACK, GIVE DATA ON PRESENT PRODUCTIVE ZONE AND PROPOSED NEW PRODUCTIVE ZONE. GIVE BLOWOUT PREVENTER PROGRAM, IF ANY.

I hereby certify that the information above is true and complete to the best of my knowledge and belief.

Signed W. J. Mueller Title Senior Engineering Specialist Date May 13, 1981

(This space for State Use)

APPROVED BY [Signature] TITLE SUPERVISOR DISTRICT DATE

CONDITIONS OF APPROVAL, IF ANY:

NEW MEXICO OIL CONSERVATION COMMISSION  
WELL LOCATION AND ACREAGE DEDICATION PLAT

Form C-102  
Supersedes C-128  
Effective 1-4-65

All distances must be from the outer boundaries of the Section.

Operator <b>Phillips Petroleum Co.</b>		Lease <b>East Vacuum Gb/SA Unit, Tract 2083</b>		Well No. <b>002</b>
Unit Letter <b>E</b>	Section <b>20</b>	Township <b>17South</b>	Range <b>35East</b>	County <b>Lea</b>
Actual Footage Location of Well: <b>1980</b> feet from the <b>North</b> line and <b>660</b> feet from the <b>West</b> line				
Ground Level Elev. <b>3977.7'(unprepared)</b>	Producing Formation <b>Grayburg/San Andres</b>		Pool <b>Vacuum Gb/SA</b>	Dedicated Acreage: <b>40</b> Acres

1. Outline the acreage dedicated to the subject well by colored pencil or hachure marks on the plat below.
2. If more than one lease is dedicated to the well, outline each and identify the ownership thereof (both as to working interest and royalty).
3. If more than one lease of different ownership is dedicated to the well, have the interests of all owners been consolidated by communitization, unitization, force-pooling, etc?

☐ Yes ☐ No If answer is "yes," type of consolidation \_\_\_\_\_

If answer is "no," list the owners and tract descriptions which have actually been consolidated. (Use reverse side of this form if necessary.) \_\_\_\_\_

No allowable will be assigned to the well until all interests have been consolidated (by communitization, unitization, forced-pooling, or otherwise) or until a non-standard unit, eliminating such interests, has been approved by the Commission.

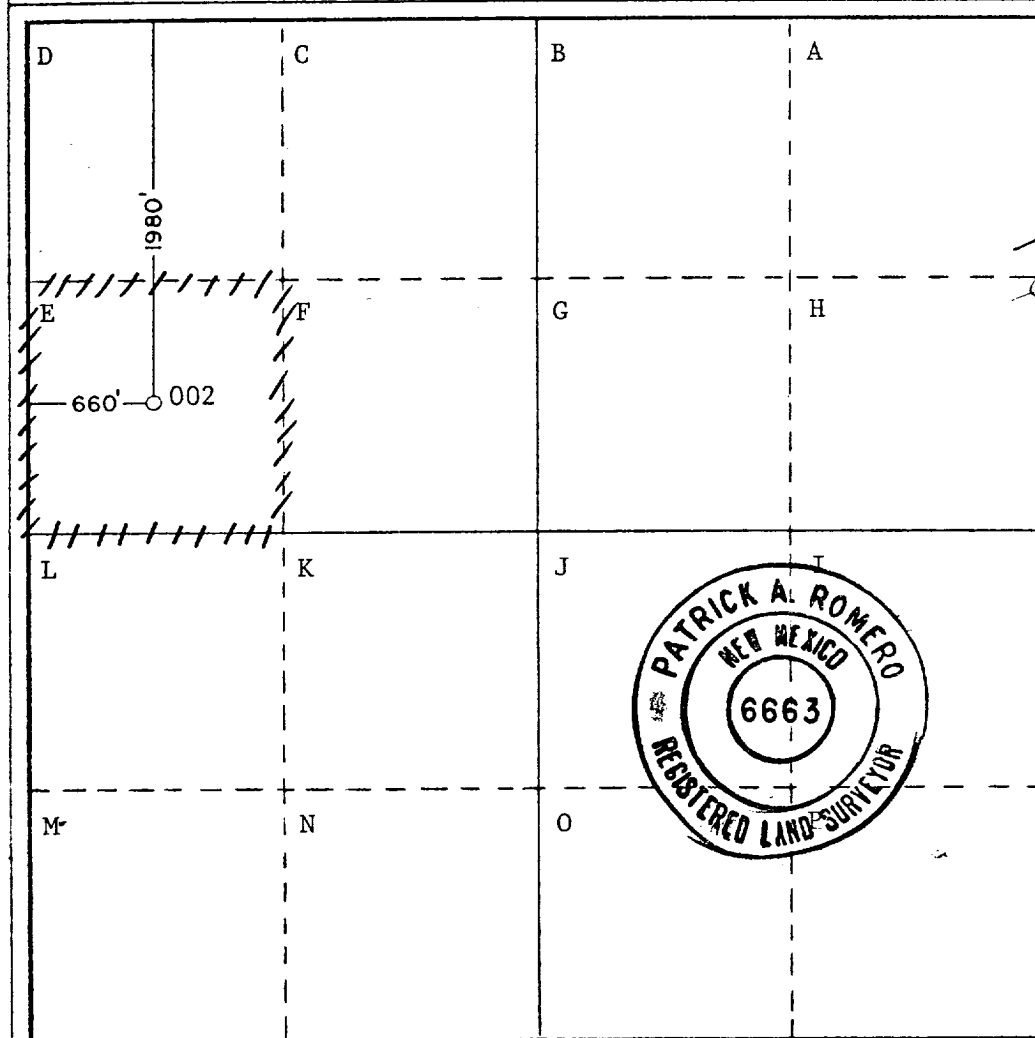

CERTIFICATION

I hereby certify that the information contained herein is true and complete to the best of my knowledge and belief.

*W. J. Mueller*  
W. J. Mueller

Position

Sr. Engineering Specialist

Company

Phillips Petroleum Company

Date

May 13, 1981

I hereby certify that the well location shown on this plat was plotted from field notes of actual surveys made by me or under my supervision, and that the same is true and correct to the best of my knowledge and belief.

Date Surveyed

May 1, 1981

Registered Professional Engineer and/or Land Surveyor

*Patrick A. Romero*  
Certificate No. **JOHN W. WEST 678**  
**PATRICK A. ROMERO 6663**  
**Ronald J. Eidson 3239**

# DOUBLE PREVENTER OPTION

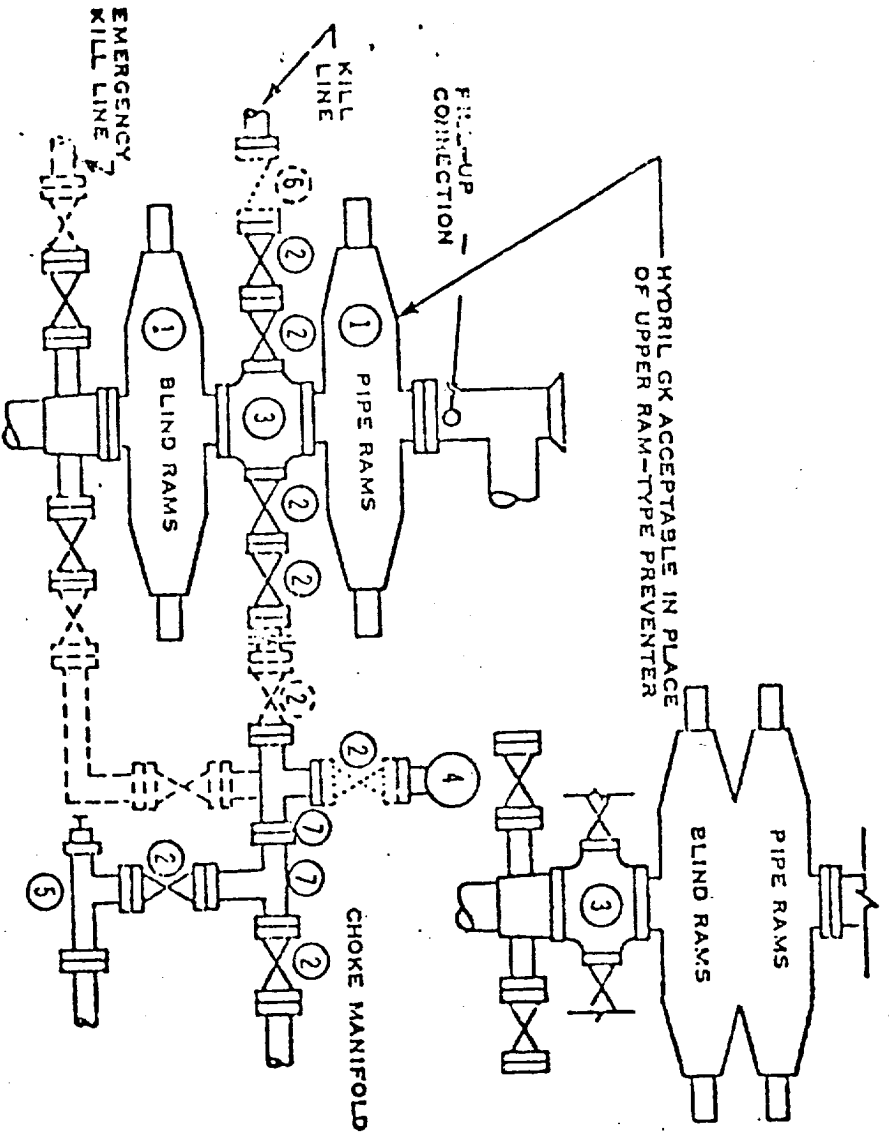

- ① SERIES 900 RAM-TYPE BOP
- ② 2" SERIES 900 VALVE
- ③ SERIES 900 DRILLING SPOOL
- ④ 2" MUD PRESSURE GAUGE
- ⑤ 2" SERIES 900 CHOKE
- ⑥ 2" SERIES 900 CHECK VALVE
- ⑦ 2" SERIES 900 STEEL TEE

## NOTES:

1. 3000 PSI WP CLAMP HUBS MAY BE SUBSTITUTED FOR FLANGES
2. VALVES MAY BE EITHER HAND OR POWER OPERATED BUT, IF POWER OPERATED, THE VALVES FLANGED TO THE BOP RUN MUST BE CAPABLE OF BEING OPENED AND CLOSED MANUALLY OR CLOSE ON POWER FAILURE AND BE CAPABLE OF BEING OPENED MANUALLY

..... OPTIONAL EQUIPMENT

PHILLIPS PETROLEUM COMPANY

3000 PSI WORKING PRESSURE  
BLOWOUT PREVENTER HOOK-UP  
(SERIES 900 FLANGES OR BETTE

RECEIVED

MAY 15 1991

OIL COMPANY

473