

STATE OF NEW MEXICO
ENERGY AND MINERALS DEPARTMENT

C. L. CONSERVATION DIVISION

P. O. BOX 2088
SANTA FE, NEW MEXICO 87501

Form C-101
Revised 10-1-78

NO. OF COPIES RECEIVED	
DISTRIBUTION	
SANTA FE	
FILE	
U.S.G.S.	
LAND OFFICE	
OPERATOR	

5A. Indicate Type of Lease
STATE ☒ FEE ☐

5. State Oil & Gas Lease No.
B-1040-7

APPLICATION FOR PERMIT TO DRILL, DEEPEN, OR PLUG BACK

1a. Type of Work b. Type of Well OIL WELL <input checked="" type="checkbox"/> GAS WELL <input type="checkbox"/> OTHER <input type="checkbox"/> SINGLE ZONE <input checked="" type="checkbox"/> MULTIPLE ZONE <input type="checkbox"/>			7. Unit Agreement Name East Vacuum Gb/SA Unit		
2. Name of Operator Phillips Petroleum Company			8. Farm or Lease Name East Vacuum Gb/SA Unit Tract 2206		
3. Address of Operator Room 401, 4001 Penbrook, Odessa, Texas 79762			9. Well No. 001		
4. Location of Well UNIT LETTER <u>K</u> LOCATED <u>1980</u> FEET FROM THE <u>south</u> LINE AND <u>1980</u> FEET FROM THE <u>west</u> LINE OF SEC. <u>22</u> TWP. <u>T-17-S</u> RGE. <u>R-35-E</u> NADPM			10. Field and Pool, or Wildcat Vacuum Gb/SA		
11. Elevations (Show whether DF, KT, etc.) 3939.2 Ground (unprepared)			12. County Lea		
21A. Kind & Status Plug. Bond blanket			19. Proposed Depth 4800'		19A. Formation Gb/SA
21B. Drilling Contractor Advise later			20. Rotary or C.T. Rotary		
22. Approx. Date Work will start Upon approval					

PROPOSED CASING AND CEMENT PROGRAM

SIZE OF HOLE	SIZE OF CASING	WEIGHT PER FOOT	SETTING DEPTH	SACKS OF CEMENT	EST. TOP
11"	8-5/8"	24#, K-55	350' (Suff. quantity of C1 H w/2% CaCl & (1/4# Flocele/sx in 1st 150/sxs). Circ surf.		
7-7/8"	5-1/2"	17#, K-55	4800' (Suff. TRLW w/12# salt/sx w/10% DD and (1/4#/sx Flocele plus 3# Gilsonite/sx followed (by 260 sxs C1 H cement w/8# salt/sx to circ (surface).		

Use mud additives as Required for Control.

BOP: Series 900, 3000# WP, double w/one set pipe rams and one set blind rams.

APPROVAL VALID FOR 180 DAYS
PERMIT EXPIRES 7/13/81
UNLESS DRILLING UNDERWAY

IN ABOVE SPACE DESCRIBE PROPOSED PROGRAM: IF PROPOSAL IS TO DEEPEN OR PLUG BACK, GIVE DATA ON PRESENT PRODUCTIVE ZONE AND PROPOSED NEW PRODUCTIVE ZONE. GIVE BLOWOUT PREVENTER PROGRAM, IF ANY.

I hereby certify that the information above is true and complete to the best of my knowledge and belief.

Signed W. J. Mueller Title Sr. Engineering Specialist Date May 13, 1981

(This space for State Use)

APPROVED BY [Signature] TITLE SUPERVISOR DISTRICT DATE May 13 1981

CONDITIONS OF APPROVAL, IF ANY:

NEW MEXICO OIL CONSERVATION COMMISSION
WELL LOCATION AND ACREAGE DEDICATION PLAT

Form C-102
Supersedes C-128
Effective 1-1-65

All distances must be from the outer boundaries of the Section.

Operator Phillips Petroleum Co.		Lease East Vacuum Gb/SA Unit, Tract 2206		Well No. 001
Unit Letter K	Section 22	Township 17South	Range 35East	County Lea
Actual Footage Location of Well: 1980 feet from the South line and 1980 feet from the West line				
Ground Level Elev. 3939.2' (unprepared)	Producing Formation Grayburg/San Andres	Pool Vacuum Gb/SA	Dedicated Acreage: 40 Acres	

1. Outline the acreage dedicated to the subject well by colored pencil or hatchure marks on the plat below.
2. If more than one lease is dedicated to the well, outline each and identify the ownership thereof (both as to working interest and royalty).
3. If more than one lease of different ownership is dedicated to the well, have the interests of all owners been consolidated by communitization, unitization, force-pooling, etc?

☐ Yes ☐ No If answer is "yes," type of consolidation _____

If answer is "no," list the owners and tract descriptions which have actually been consolidated. (Use reverse side of this form if necessary.) _____

No allowable will be assigned to the well until all interests have been consolidated (by communitization, unitization, forced-pooling, or otherwise) or until a non-standard unit, eliminating such interests, has been approved by the Commission.

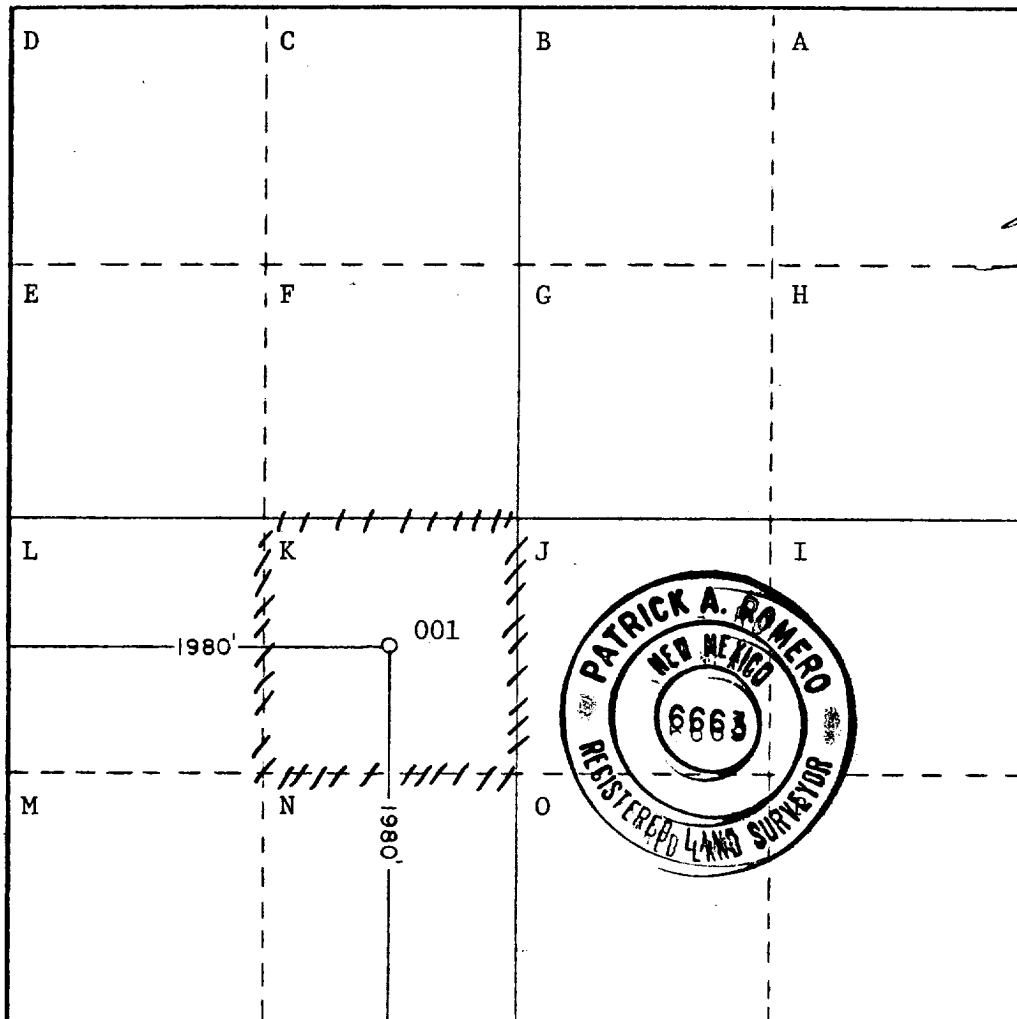

CERTIFICATION

I hereby certify that the information contained herein is true and complete to the best of my knowledge and belief.

W. J. Mueller
Name
W. J. Mueller
Position
Sr. Engineering Specialist
Company
Phillips Petroleum Company
Date
May 15, 1981

I hereby certify that the well location shown on this plat was plotted from field notes of actual surveys made by me or under my supervision, and that the same is true and correct to the best of my knowledge and belief.

Date Surveyed
May 1, 1981

Registered Professional Engineer
and/or Land Surveyor

Patrick A. Romero
Certificate No. **JOHN W. WEST 676**
PATRICK A. ROMERO 6663
Ronald J. Eidson 3239

DOUBLE PREVENTER OPTION

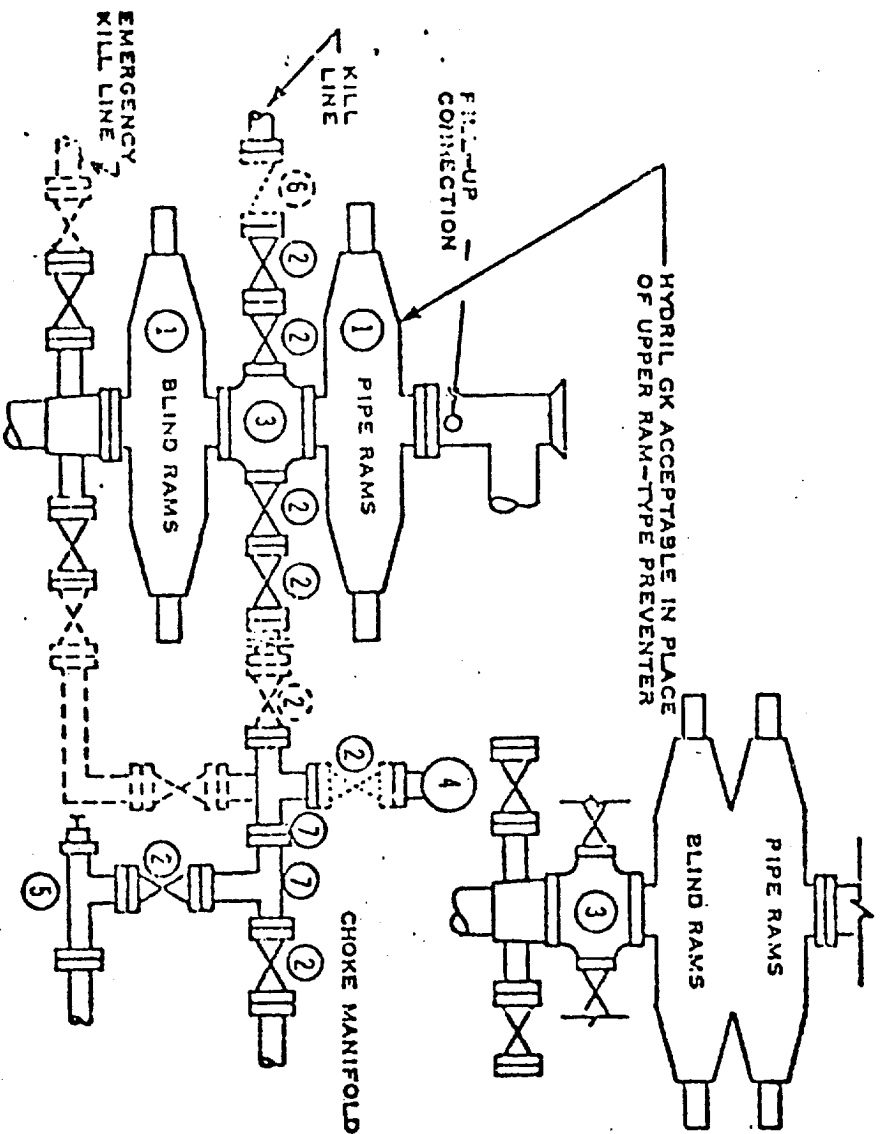

- ① SERIES 900 RAM-TYPE BOP
- ② 2" SERIES 900 VALVE
- ③ SERIES 900 DRILLING SPOOL
- ④ 2" MUD PRESSURE GAUGE
- ⑤ 2" SERIES 900 CHOKE
- ⑥ 2" SERIES 900 CHECK VALVE
- ⑦ 2" SERIES 900 STEEL TEE

NOTES:

1. 3000 PSI WP CLAMP HUBS MAY BE SUBSTITUTED FOR FLANGES
2. VALVES MAY BE EITHER HAND OR POWER OPERATED BUT, IF POWER OPERATED, THE VALVES FLANGED TO THE BOP RUN MUST BE CAPABLE OF BEING OPENED AND CLOSED MANUALLY OR CLOSE ON POWER FAILURE AND BE CAPABLE OF BEING OPENED MANUALLY

.....OPTIONAL EQUIPMENT

PHILLIPS PETROLEUM COMPANY

3000 PSI WORKING PRESSURE
BLOWOUT PREVENTER HOOK-UP
(SERIES 900 FLANGES OR BETTER)

RECEIVED

MAY 15 1981

OIL CONSERVATION DIV.

473