

NEW MEXICO OIL CONSERVATION COMMISSION  
WELL LOCATION AND ACREAGE DEDICATION PLAT

Form C-102  
Supersedes C-128  
Effective 1-1-65

All distances must be from the outer boundaries of the Section.

Operator <del>INEXCO OIL CO.</del> <i>BFC</i>		Lease LOTTIE YORK <del>1</del>		Well No. 1
Unit Letter p	Section 14	Township 17 South	Range 37 East	County Lea County
Actual Footage Location of Well: 990 feet from the South line and 660 feet from the East line				
Ground Level Elev. 3727.10	Producing Formation Mississippian	Pool <i>Southwest Humble City Strawn</i> <del>Wildcat</del>	Dedicated Acreage: <i>40.80</i> Acres	

- Outline the acreage dedicated to the subject well by colored pencil or hatchure marks on the plat below.
- If more than one lease is dedicated to the well, outline each and identify the ownership thereof (both as to working interest and royalty).
- If more than one lease of different ownership is dedicated to the well, have the interests of all owners been consolidated by communitization, unitization, force-pooling, etc?

☐ Yes ☐ No If answer is "yes," type of consolidation \_\_\_\_\_

If answer is "no," list the owners and tract descriptions which have actually been consolidated. (Use reverse side of this form if necessary.) \_\_\_\_\_

No allowable will be assigned to the well until all interests have been consolidated (by communitization, unitization, forced-pooling, or otherwise) or until a non-standard unit, eliminating such interests, has been approved by the Commission.

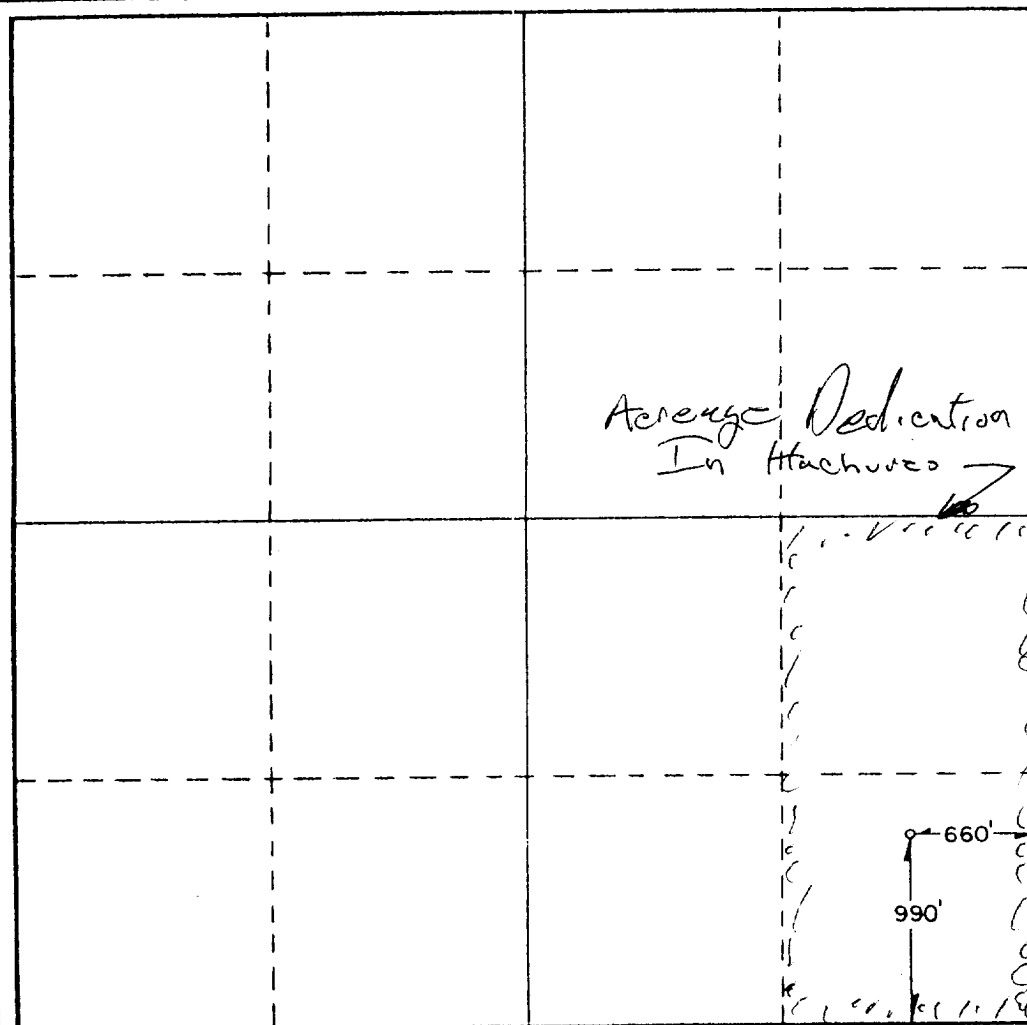

CERTIFICATION

I hereby certify that the information contained herein is true and complete to the best of my knowledge and belief.

Name  
O. H. Routh  
Position  
Agent  
Company  
Inexco Oil Company  
Date  
8/27/81

I hereby certify that the well location shown on this plat was plotted from notes of actual surveys made by me under my supervision, and that the same is true and correct to the best of my knowledge and belief.

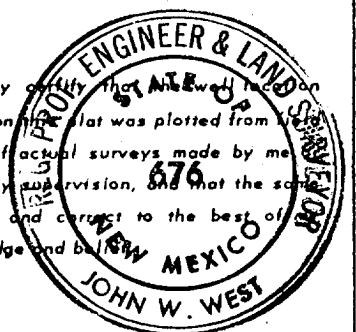

Date Surveyed  
8/21/81  
Registered Professional Engineer and/or Land Surveyor

*John W. West*  
Certificate No. JOHN W. WEST 676  
PATRICK A. ROMERO 6863  
Ronald J. Eldon 3239

0 330 660 990 1320 1650 1980 2310 2640 2970 3300

R.A.