

NEW MEXICO OIL CONSERVATION COMMISSION
WELL LOCATION AND ACREAGE DEDICATION PLAT

Form C-102
Supersedes C-128
Effective 1-1-65

All distances must be from the outer boundaries of the Section.

| | | | | |
|--|--------------------------------------|-----------------------------|--|----------------------|
| Operator AMINOIL USA, INC. | | Lease FEDERAL 30 | | Well No. 2 |
| Tract Letter K | Section 30 | Township 19 SOUTH | Range 33 EAST | County LEA |
| Actual Footage Location of Well: 1880 feet from the WEST line and 1980 feet from the SOUTH line | | | | |
| Ground Level Elev. 3586.6 | Producing Formation MORROW | Pool Wildcat | Dedicated Acreage: 320 Acres | |

1. Outline the acreage dedicated to the subject well by colored pencil or hachure marks on the plat below.
2. If more than one lease is dedicated to the well, outline each and identify the ownership thereof (both as to working interest and royalty).
3. If more than one lease of different ownership is dedicated to the well, have the interests of all owners been consolidated by communitization, unitization, force-pooling, etc?

☒ Yes ☐ No If answer is "yes," type of consolidation Unit

If answer is "no," list the owners and tract descriptions which have actually been consolidated. (Use reverse side of this form if necessary.) _____

No allowable will be assigned to the well until all interests have been consolidated (by communitization, unitization, forced-pooling, or otherwise) or until a non-standard unit, eliminating such interests, has been approved by the Commission.

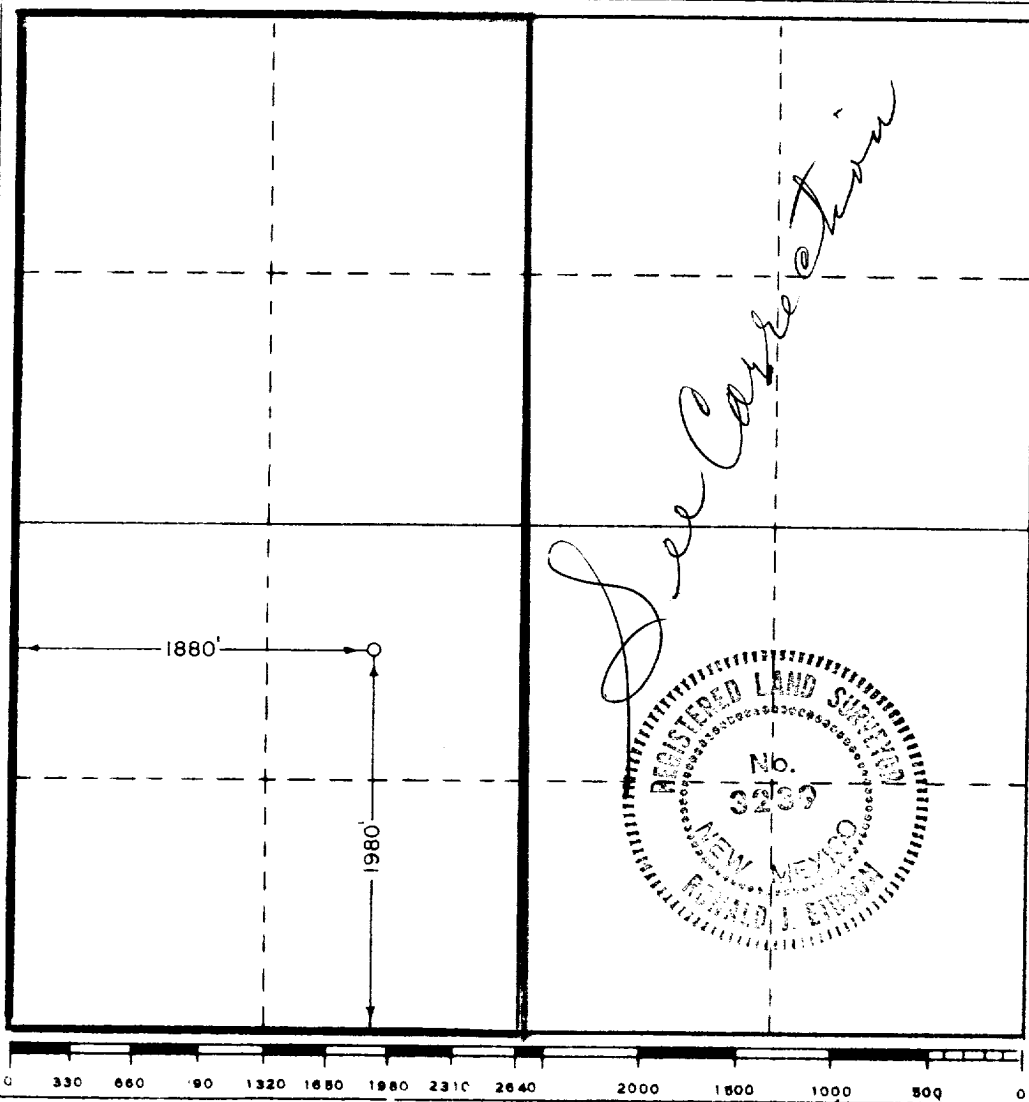

CERTIFICATION

I hereby certify that the information contained herein is true and complete to the best of my knowledge and belief.

Name
Operations Superintendent
Position
AMINOIL USA, INC.
Company
September 14, 1981
Date

I hereby certify that the well location shown on this plat was plotted from field notes of actual surveys made by me or under my supervision, and that the same is true and correct to the best of my knowledge and belief.

Date Surveyed
SEPT. 10, 1981

Registered Professional Engineer
and/or Land Surveyor

Ronald J. Eidson
Certificate No. **JOHN W. WEST 676**
PATRICK A. ROMERO 6663
Ronald J. Eidson 3239