

N. M. OIL CONS. COMMISSION
P. O. BOX 1369
HOBBS, NEW MEXICO 88240
UNITED STATES
DEPARTMENT OF THE INTERIOR
GEOLOGICAL SURVEY

30-025-28748

5. LEASE DESIGNATION AND SERIAL NO.

NM-40451

6. IS INDIAN, ALLOTTEE OR TRIBE NAME

7. UNIT AGREEMENT NAME

8. FARM OR LEASE NAME

Amoco "CP" Federal

9. WELL NO.

1

10. FIELD AND POOL, OR WILDCAT

Wildcat

11. SEC., T., R., M., OR BLK.
AND SURVEY OR AREA

Sec. 8, T-18S, R-32E

12. COUNTY OR PARISH

Lea

13. STATE

NM

1a. TYPE OF WORK

DRILL ☐DEEPEN ☒PLUG BACK ☐

b. TYPE OF WELL

OIL
WELL ☒GAS
WELL ☐

OTHER

SINGLE
ZONE ☒MULTIPLE
ZONE ☐

2. NAME OF OPERATOR

Harvey E. Yates Company

3. ADDRESS OF OPERATOR

P. O. Box 1933, Roswell, New Mexico 88201

4. LOCATION OF WELL (Report location clearly and in accordance with any State requirements.)*

At surface

1980' FSL & 1980' FEL

At proposed prod. zone Same

14. DISTANCE IN MILES AND DIRECTION FROM NEAREST TOWN OR POST OFFICE*

15. DISTANCE FROM PROPOSED*

LOCATION TO NEAREST
PROPERTY OR LEASE LINE, FT.
(Also to nearest drlg. unit line, if any)

1980

16. NO. OF ACRES IN LEASE

160

17. NO. OF ACRES ASSIGNED
TO THIS WELL

40

18. DISTANCE FROM PROPOSED LOCATION*

TO NEAREST WELL, DRILLING, COMPLETED,
OR APPLIED FOR, ON THIS LEASE, FT.

1650

19. PROPOSED DEPTH

9010

20. ROTARY OR CABLE TOOLS

Rotary

21. ELEVATIONS (Show whether DF, RT, GR, etc.)

3775' KB (14' KB)

22. APPROX. DATE WORK WILL START*

6/1/84

23.

PROPOSED CASING AND CEMENTING PROGRAM

SIZE OF HOLE	SIZE OF CASING	WEIGHT PER FOOT	SETTING DEPTH	QUANTITY OF CEMENT
17 1/2	11 3/4		697	425 SXS
11	8 5/8		2428	925 SXS
7 7/8	5 1/2		8859	1545 SXS

See procedure attached.



IN ABOVE SPACE DESCRIBE PROPOSED PROGRAM: If proposal is to deepen or plug back, give data on present productive zone and proposed new productive zone. If proposal is to drill or deepen directionally, give pertinent data on subsurface locations and measured and true vertical depths. Give blowout preventer program, if any.

24.

SIGNED

TITLE

Reservoir Engineer

DATE

5/25/84

(This space for Federal or State office use)

PERMIT NO.

APPROVAL DATE

APPROVED BY

CONDITIONS OF APPROVAL, IF ANY:

TITLE

AREA MANAGER

CARLSBAD RESOURCE AREA

DATE

5-29-84
APPROVAL SUBJECT TO
GENERAL REQUIREMENTS AND
SPECIAL STIPULATIONS
ATTACHED

~~RECEIVED~~

MAY 30 1984

O.C.D.
HOBBS OFFICE

TO: A.J. Deans

DATE: 5/23/84

RE: Reentry of Amoco Prod. Co., 1 Federal "CP"
1980' FSL, 1980' FEL, Sec. 8 T-18S R-32E Lea County New Mexico

CASING: 11 3/4" @ 697' w/425 sxs
8 5/8" @ 2428' w/925 sxs
5 1/2" @ 8859' w/1545 sxs

PLUGS: 1. 10 sx @ surface
2. 25 sx @ 597' to 847'
3. 25 sx @ 2303' to 2553'
4. 25 sx @ 4390' to 4640'
5. CIBP @ 6250' w/25 sx cement on top
6. TD 8860'

REENTRY PROCEDURE

1. Repair road & location. Dig work over pit.
2. Clean out and install 8' x 8' x 6' cellar.
3. Drill out surface plug w/rat hole machine. Set anchors.
4. NU flow line to pit. NU 11 3/4" starting head.
5. RU PU & Reverse Unit. MI 2-7/8" tubing work string.
6. PU 4-3/4 rock bit, drill collars & tubing.
7. Drill out cement plugs and cement off top CIBP @ 6250'.
8. Circulate hole clean and condition mud.
9. Drill out to old TD @ 8860' and condition mud.
10. POH & change out bit & drilling assembly to drill sand & dolomite.
11. Deepen hole to 9010'. SDT open hole from 8860' to 9010'.
12. Based on results of DST complete well for production or plug and abandon.

Peck Hardee
5/23/84

**NEW MEXICO OIL CONSERVATION COMMISSION
WELL LOCATION AND ACREAGE DEDICATION PLAT**

Form C-102
Supersedes C-128
Effective 1-1-65

All distances must be from the outer boundaries of the Section.

Operator Harvey E. Yates Company			Lease Amoco "CP" Federal		Well No. 1
Unit Letter J	Section 8	Township 18S	Range 32E	County Lea	
Actual Footage Location of Well:					
1980	feet from the South line and	1980	feet from the East line		
Ground Level Elev. 3775 KB	Producing Formation Bone Springs	Pool North Youngs Wildcat	Dedicated Acreage 40	Acres	

- Outline the acreage dedicated to the subject well by colored pencil or hatchure marks on the plat below.
- If more than one lease is dedicated to the well, outline each and identify the ownership thereof (both as to working interest and royalty).
- If more than one lease of different ownership is dedicated to the well, have the interests of all owners been consolidated by communitization, unitization, force-pooling, etc?

☐ Yes ☐ No If answer is "yes," type of consolidation _____

If answer is "no," list the owners and tract descriptions which have actually been consolidated. (Use reverse side of this form if necessary.) _____

No allowable will be assigned to the well until all interests have been consolidated (by communitization, unitization, forced-pooling, or otherwise) or until a non-standard unit, eliminating such interests, has been approved by the Commission.

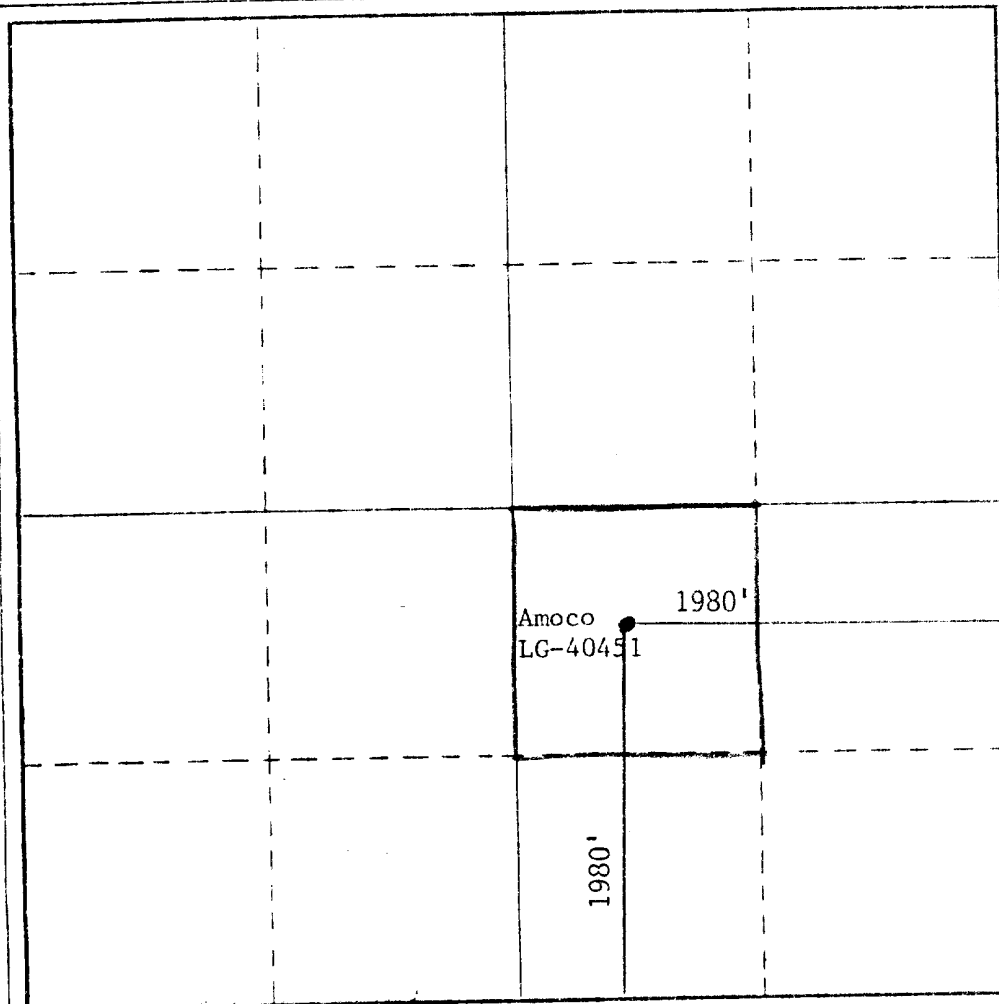

CERTIFICATION

I hereby certify that the information contained herein is true and complete to the best of my knowledge and belief.

Ray F. Nokes

Name
Ray F. Nokes

Position
Reservoir Engineer

Company
Harvey E. Yates Company

Date
May 29, 1984

I hereby certify that the well location shown on this plat was plotted from field notes of actual surveys made by me or under my supervision, and that the same is true and correct to the best of my knowledge and belief.

Date Surveyed

Registered Professional Engineer
in the State of New Mexico

Section No.

0 330 660 990 1320 1650 1980 2310 2640 2970 3300

1

~~RECEIVED~~

MAY 30 1984

O.C.D.
NOBBS OFFICE

SURFACE USE PLAN
HARVEY E. YATES COMPANY
Amoco "CP" Federal #1
Sec. 8, T-18S, R-32E
Lea County, New Mexico

1. EXISTING ROADS:

- A. Exhibit A is a portion of highway map showing the location of the well we plan to re-enter. Leave Artesia on U.S. Highway 82 and travel east to the junction of New Mexico Highway 529. Turn south on Highway 529 and travel 7 miles to the intersection of New Mexico Highway 126. Turn south on Highway 126 for 2 miles then turn west on a caliche road and continue for approximately 1 mile and turn north to location.

2. PLANNED ACCESS ROADS:

- A. We will use the existing roads to reach the location.

3. LOCATION OF EXISTING WELLS:

- A. There is one other well in section 8 along with our reentry well, Namely Maxwell Oil Company's Federal Fox #1 located 660' FSL & 330' FEL.

4. LOCATION OF TANK BATTERIES, ETC.:

- A. In the event we recompleate a producing well, all production facilities will be installed on the existing pad.

5. LOCATION AND TYPE OF WATER SUPPLY:

- A. Water will be obtained from commercial sources, either hauled or pipelined.

6. SOURCE OF CONSTRUCTION MATERIAL:

- A. We will be using all existing roads and existing pad, so there will not be any need for construction material.

7. METHODS OF HANDLING WASTE DISPOSAL:

- A. Waste will be buried in reserve pits at a depth of 24". The wellsite will be cleaned of all waste and this will be done within 30 days after completion of the well.

8. ANCILLARY FACILITIES:

None required.

9. WELLSITE LAYOUT:

- A. Exhibit C shows the relative location and dimensions of the well pad and reserve pits.
- B. There will be no need to cut or fill since we will be using the existing roads and pit. There will be no disturbance of the ground.

10. PLANS FOR RESTORATION OF THE SURFACE:

- A. After finishing drilling and/or other completion operations, all equipment and other material not needed for further operations will be removed. Pits will be filled and the location cleaned of all trash and junk to leave the wellsite as pleasant in appearance as possible.
- B. If the proposed well is non-productive, all restoration and/or vegetation requirements of the Bureau of Land Management will be complied with and will be accomplished as quickly as possible. All pits will be filled and levelled within 90 days after abandonment.

11. OTHER INFORMATION:

- A. The surface is federal. The topography consists of sandy soil with native grasses, catclaw, etc. No wildlife was observed, both the usual inhabitants of this region are jackrabbits, reptiles, coyotes, etc.
- B. There are no ponds, lakes, streams or rivers in this area.
- C. There are no occupied dwellings or windmills in the area of the wellsite.
- D. There is no evidence of any archaeological, historical or cultural sites in the area.

12. OPERATOR'S CERTIFICATION:

- A. The field representatives responsible for assuring compliance with the approved surface use and operations plan are:

Peck Hardee
Harvey E. Yates Company
P. O. Box 1933
Roswell, New Mexico 88201
Office: 505/623-6601
Home: 505/623-8980

Micky Young
Harvey E. Yates Company
P. O. Box 1933
Roswell, New Mexico 88201
Mobil: 505/624-1818 #840
Home: 505/623-8158

13. CERTIFICATION:

I hereby certify that I or persons under my direct supervision have inspected the proposed drillsite and access route; that I am familiar with the conditions which presently exist; that the statements made in this plan are to the best of my knowledge true and correct; and, that the work associated with the operations proposed herein will be performed by Harvey E. Yates Company and its contractors and subcontractors in conformity with this plan and the terms and conditions under which it is approved.

5-29-84
Date

Ray F. Nokes
Ray F. Nokes
Reservoir Engineer

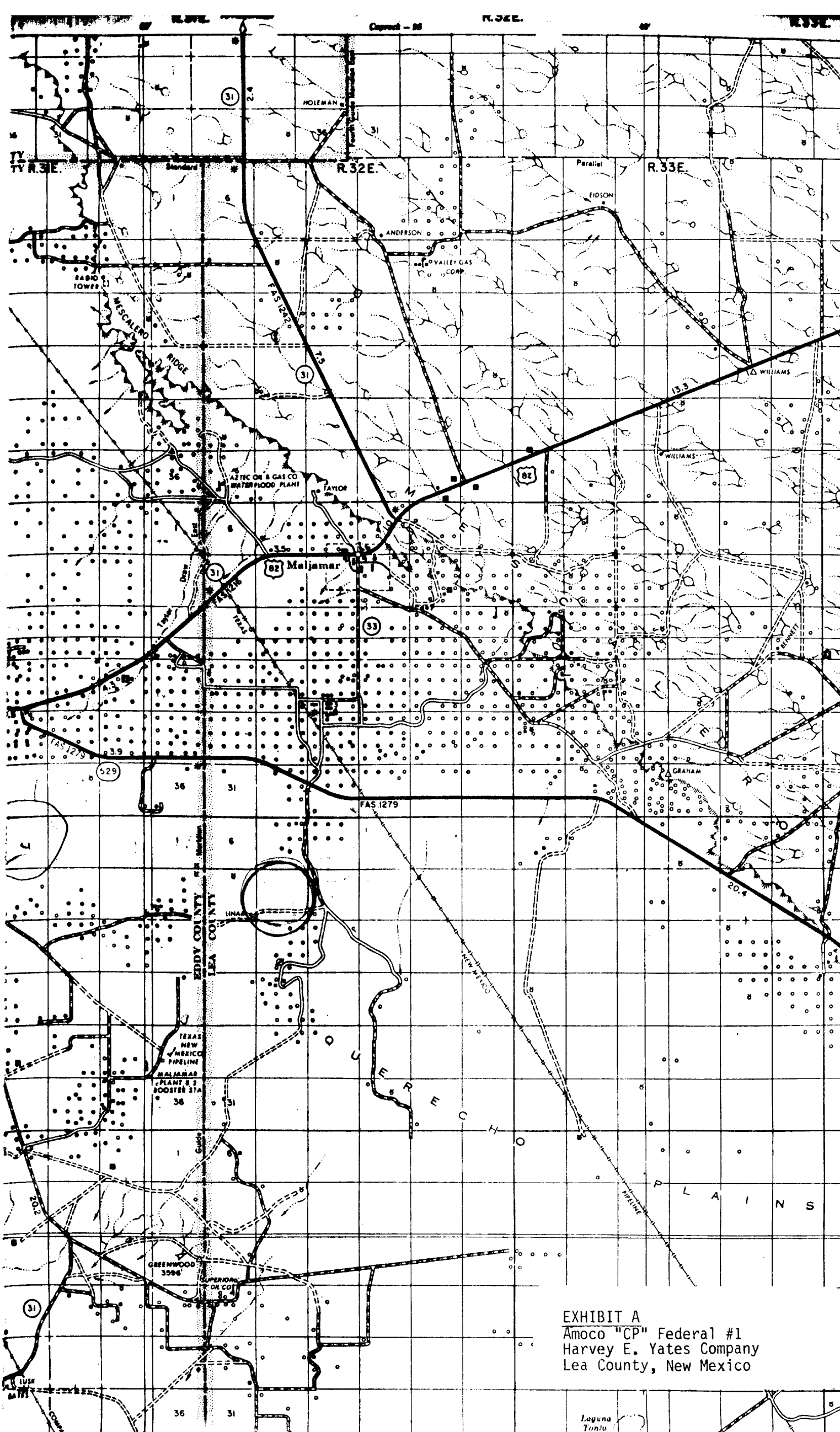

EXHIBIT A
 Amoco "CP" Federal #1
 Harvey E. Yates Company
 Lea County, New Mexico

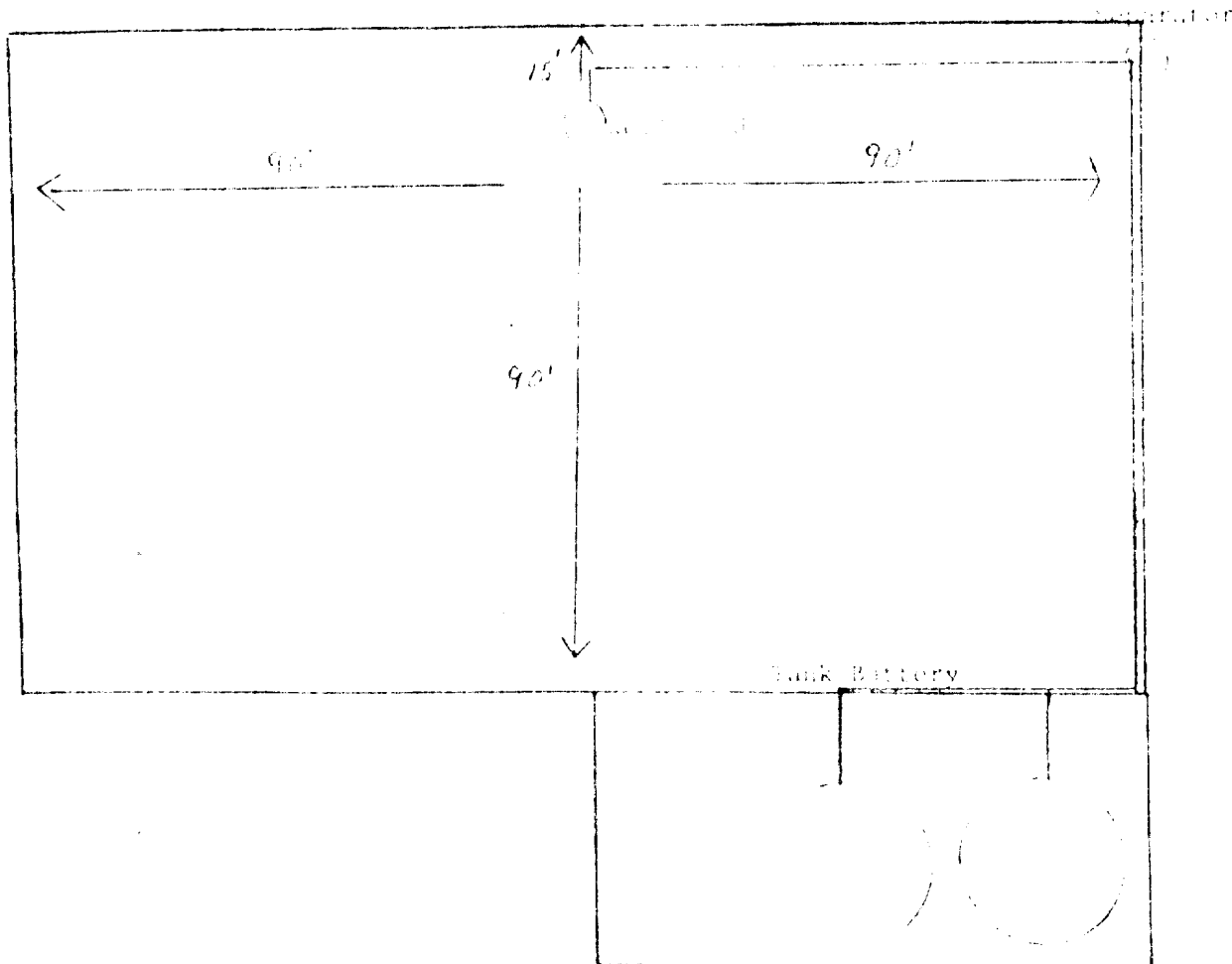
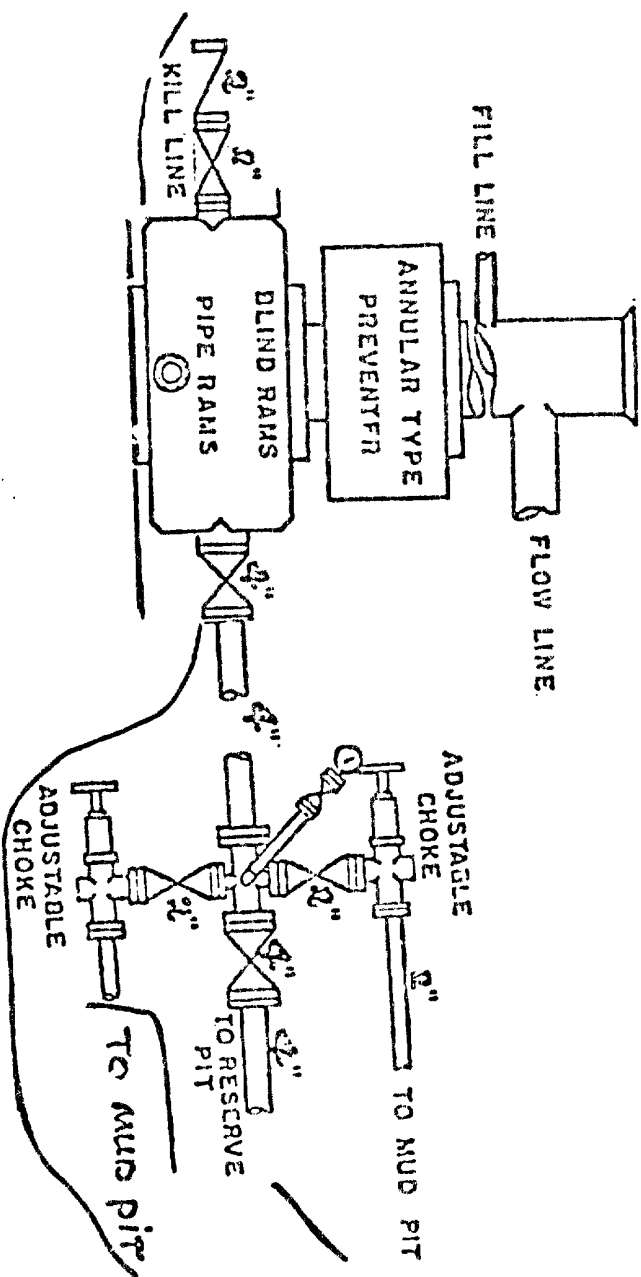

EXHIBIT C
Amoco "CP" Federal #1
Harvey E. Yates Company
Lea County, New Mexico



900 Series

EXHIBIT D
 Amoco "CP" Federal #1
 Harvey E. Yates Company
 Lea County, New Mexico