

Operator Exxon Corporation		Lease NEW MEXICO "DD" STATE		Well No. 3
Unit Letter B	Section 4	Township 19 SOUTH	Range 35 EAST	County LEA

Actual Footage Location of Well:

660 feet from the NORTH line and 1947 feet from the EAST line

Ground Level Elev: 3900'	Producing Formation WOLFCAMP	Pool UNDESIGNATED SCHARB	Dedicated Acreage: 40 39.69 Acres
-----------------------------	---------------------------------	-----------------------------	--------------------------------------

1. Outline the acreage dedicated to the subject well by colored pencil or hachure marks on the plat below.
2. If more than one lease is dedicated to the well, outline each and identify the ownership thereof (both as to working interest and royalty).
3. If more than one lease of different ownership is dedicated to the well, have the interests of all owners been consolidated by communitization, unitization, force-pooling, etc?

☐ Yes ☐ No If answer is "yes," type of consolidation \_\_\_\_\_

If answer is "no," list the owners and tract descriptions which have actually been consolidated. (Use reverse of this form if necessary.) \_\_\_\_\_

No allowable will be assigned to the well until all interests have been consolidated (by communitization, unitization, forced-pooling, or otherwise) or until a non-standard unit, eliminating such interests, has been approved by the Commission.

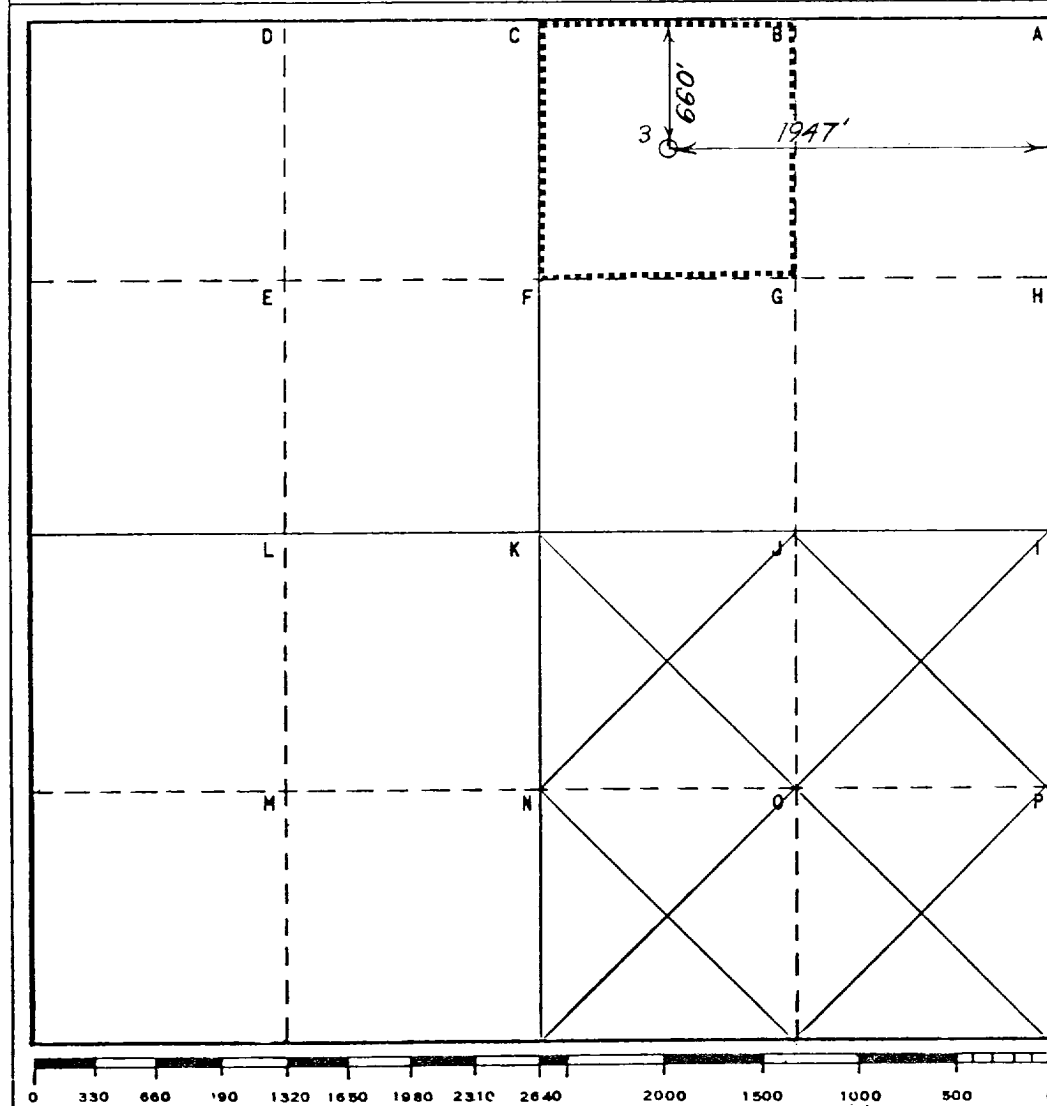

#### CERTIFICATION

I hereby certify that the information contained herein is true and complete to the best of my knowledge and belief.

Name  
*Meiba Knippling*  
Position  
UNIT HEAD

Company Exxon Corporation  
Box 1600 Midland, Texas

Date  
3-16-82

I hereby certify that the well location shown on this plat was plotted from field notes of actual surveys made by me or under my supervision, and that this same is true and correct to the best of my knowledge and belief.

Date Surveyed  
11-12-81

Registered Professional Engineer  
and/or Land Surveyor

*J. J. Heston*

Certificate No.  
1382