

APPROVAL VALID FOR 180 DAYS
PERMIT EXPIRES 5/16/83
UNLESS DRILLING UNDERWAY

30-025 27965

NO. OF COPIES RECEIVED	
DISTRIBUTION	
SANTA FE	
FILE	
U.S.G.S.	
LAND OFFICE	
OPERATOR	

NEW MEXICO OIL CONSERVATION COMMISSION

Texaco Lease # 255100

Form O-101
Revised 1-4-65

1. Indicate Type of Lease	
STATE <input checked="" type="checkbox"/>	FEE <input type="checkbox"/>
2. Lease & Gas Lease No.	

APPLICATION FOR PERMIT TO DRILL, DEEPEN OR PLUG BACK

1a. Type of Work		1. Unit Agreement Name	
b. Type of Well DRILL <input checked="" type="checkbox"/> DEEPEN <input type="checkbox"/> PLUG BACK <input type="checkbox"/> OIL WELL <input type="checkbox"/> GAS WELL <input type="checkbox"/> OTHER Water Injection <input checked="" type="checkbox"/> SINGLE <input checked="" type="checkbox"/> MULTIPLE <input type="checkbox"/>		2. Firm or Lease Name Central Vacuum Unit	
3. Name of Operator Texaco Inc.		4. Well No. 155	
5. Address of Operator P. O. Box 3109 Midland, Texas 79702		6. Field and Pool, or Wildcat Vacuum	
7. Location of Well: UNIT LETTER <u>I</u> LOCATED <u>2580</u> FEET FROM <u>South</u> LINE AND <u>1310</u> FEET FROM THE <u>East</u> CORNER OF SEC. <u>25</u> T-17-S-R-34-E		8. County Lea	
9. Elevation (show whether B.T., H.T., etc.) 3987' Gr		10. Depth of Well 4800	11. Rotary or C.T. Rotary
12. Approx. Date Work will start Immediately			

23.

PROPOSED CASING AND CEMENT PROGRAM

SIZE OF HOLE	SIZE OF CASING	WEIGHT PER FOOT	DEPTH	FEET TO DEPTH	BACKS OF CEMENT	EST. TOP
20"	16"	65#, H-40	350'		650	Circulate
15"	11 3/4"	42#, H-40	1530'		1200	Circulate
*11"	8 5/8"	28#, H-40	2675'		1100	Circulate
		28#, S-80				
7 7/8"	5 1/2"	15.5#, K-55	4800'		2300	Circulate

Surface Casing: 650 sxs Class "H" w/2% CaCl₂ (15.6 ppg, 1.18 ft³/sx).

1st Intermediate Casing: 1000 sxs 50:50 Pozmix Class "H" w/5# gilsonite, 1/4# flocele/sx, & 2% CaCl₂ (13.7 ppg, 1.37 ft³/sx) followed by 200 sxs Class "H" w/1/4# flocele/sx & 2% CaCl₂ (15.6 ppg, 1.18 ft³/sx).

*2nd Intermediate Casing: 1st Stage: 500 sxs 50:50 Pozmix Class "H" w/8.6# salt & 1/4# flocele/sx (14.5 ppg, 1.31 ft³/sx) followed by 200 sxs Class "H" w/7.8# salt & 1/4# flocele/sx (15.9 ppg, 1.22 ft³/sx). DV Tool @ 1540'

2nd Stage 400 sxs Class "H" w/2% CaCl₂ (15.6 ppg, 1.18 ft³/sx).

Production Casing: 2000 sxs 50:50 Pozmix Class "H" w/5# gilsonite & 1/4# flocele/sx (13.7 ppg, 1.37 ft³/sx) followed by 300 sxs Class "H" w/1/4# flocele/sx (15.6 ppg, 1.18 ft³/sx).

NSL-1612

* SECOND INTERMEDIATE CASING TO BE RUN ONLY IF WATERFLOW IS ENCOUNTERED.

IN ABOVE SPACE DESCRIBE PROPOSED PROGRAM, INCLUDING DEPTH OF PRODUCTION ZONE, DEPTH OF PROPOSED NEW PRODUCTION ZONE, GIVE BLOWOUT PREVENTER (BOP) GRADE, ETC.

I hereby certify that the information given is true and correct.

Signed R. S. Lane
R. S. Lane

Asst. Petr. Engr. Manager

September 30, 1982

OIL & GAS INSPECTOR

NOV 16 1982

APPROVED BY

Eddie W. Dean

CONDITIONS OF APPROVAL, IF ANY:

NEW MEXICO OIL CONSERVATION COMMISSION
WELL LOCATION AND ACREAGE DEDICATION PLAT

Form C-102
Supersedes C-128
Effective 1-1-65

All distances must be from the outer boundaries of the Section.

Operator Texaco Inc.			Lease Central Vacuum Unit		Well No. 155
Unit Letter I	Section 25	Township T-17-S	Range R-34-E	County Lea	
Actual Footage Location of Well: 2580 feet from the South line and 1310 feet from the East line					
Ground Level Elev. 3987'	Producing Formation San Andres		Pool Vacuum		Dedicated Acreage: Injection well <small>Acres</small>

Unorthodox Location

1. Outline the acreage dedicated to the subject well by colored pencil or hachure marks on the plat below.
2. If more than one lease is dedicated to the well, outline each and identify the ownership thereof (both as to working interest and royalty).
3. If more than one lease of different ownership is dedicated to the well, have the interests of all owners been consolidated by communitization, unitization, force-pooling, etc?

☐ Yes ☐ No If answer is "yes," type of consolidation _____

If answer is "no," list the owners and tract descriptions which have actually been consolidated. (Use reverse side of this form if necessary.) _____

No allowable will be assigned to the well until all interests have been consolidated (by communitization, unitization, forced-pooling, or otherwise) or until a non-standard unit, eliminating such interests, has been approved by the Commission.

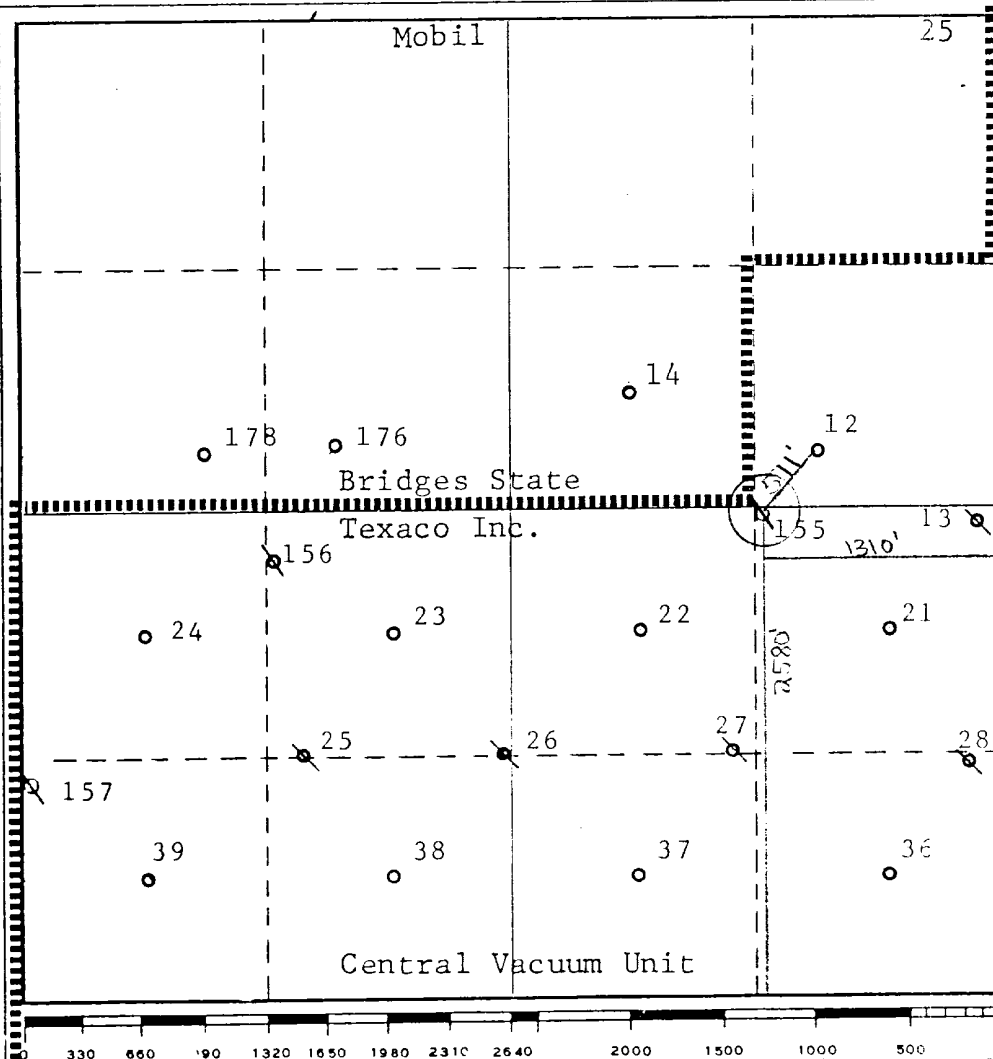

CERTIFICATION

I hereby certify that the information contained herein is true and complete to the best of my knowledge and belief.

B. L. Eiland

Name
B. L. Eiland
Position
Division Surveyor
Company
Texaco Inc.

Date
September 30, 1982

I hereby certify that the well location shown on this plat was plotted from field notes of actual surveys made by me or under my supervision, and that the same is true and correct to the best of my knowledge and belief.

Date Surveyed
September 23, 1982

Registered Professional Engineer
and/or Land Surveyor

B. L. Eiland
B. L. Eiland

Certificate No.
4386

DRILLING CONTROL
CONDITION II-3000 PSI WP

H₂S TRIM REQUIRED
YES _____ NO _____

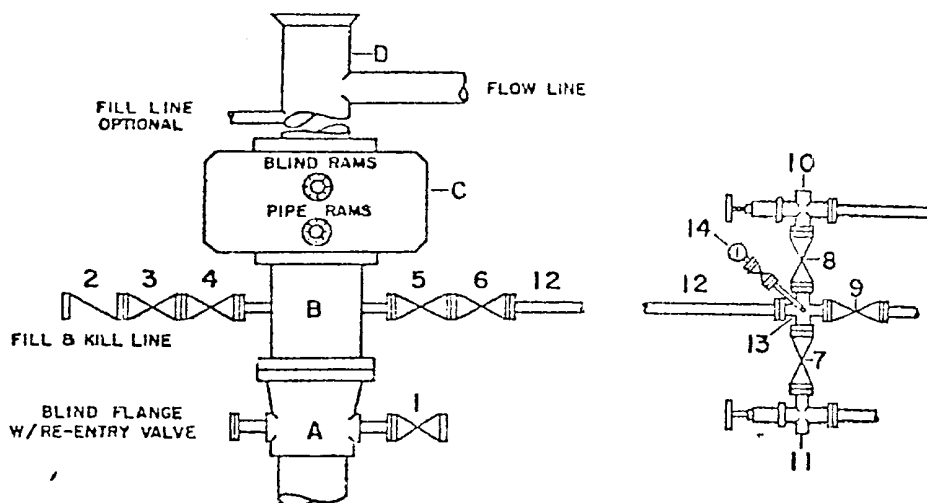

DRILLING CONTROL

MATERIAL LIST - CONDITION II

- | | |
|-----------|---|
| A | Texaco Wellhead |
| B | 3000# W.P. drilling spool with a 2" minimum flanged outlet for kill-line and 3" minimum flanged outlet for choke line |
| C | 3000# W.P. Dual ram type preventer, hydraulic operated with 1" steel, 3000# W.P. control lines (where sub-structure height is adequate, 2-3000# W.P. single ram type preventers may be utilized.) |
| D | Bell nipple with flowline and fill-up outlets. (Kill line may also be used for fill-up line.) |
| 1,3,4,7,8 | 2" minimum 3000# W.P. flanged full opening steel gate valve, or Halliburton Lo Torc Plug valve. |
| 2 | 2" minimum 3000# W.P. back pressure valve |
| 5,6,9 | 3" minimum 3000# W.P. flanged full opening steel gate valve, or Halliburton Lo Torc Plug valve. |
| 12 | 3" minimum schedule 80, Grade "B", seamless line pipe |
| 13 | 2" minimum x 3" minimum 3000# W.P. flanged cross |
| 10, 11 | 2" minimum 3000# W.P. adjustable choke bodies |
| 14 | Cameron Mud Gauge or equivalent (location optional to choke line.) |



TEXACO, INC.
PRODUCING DEPARTMENT U.S.
MIDLAND, TEXAS



SCALE	DATE	EST. NO.	DRG. NO.
DRAWN BY			
CHECKED BY			
APPROVED BY			

EXHIBIT B

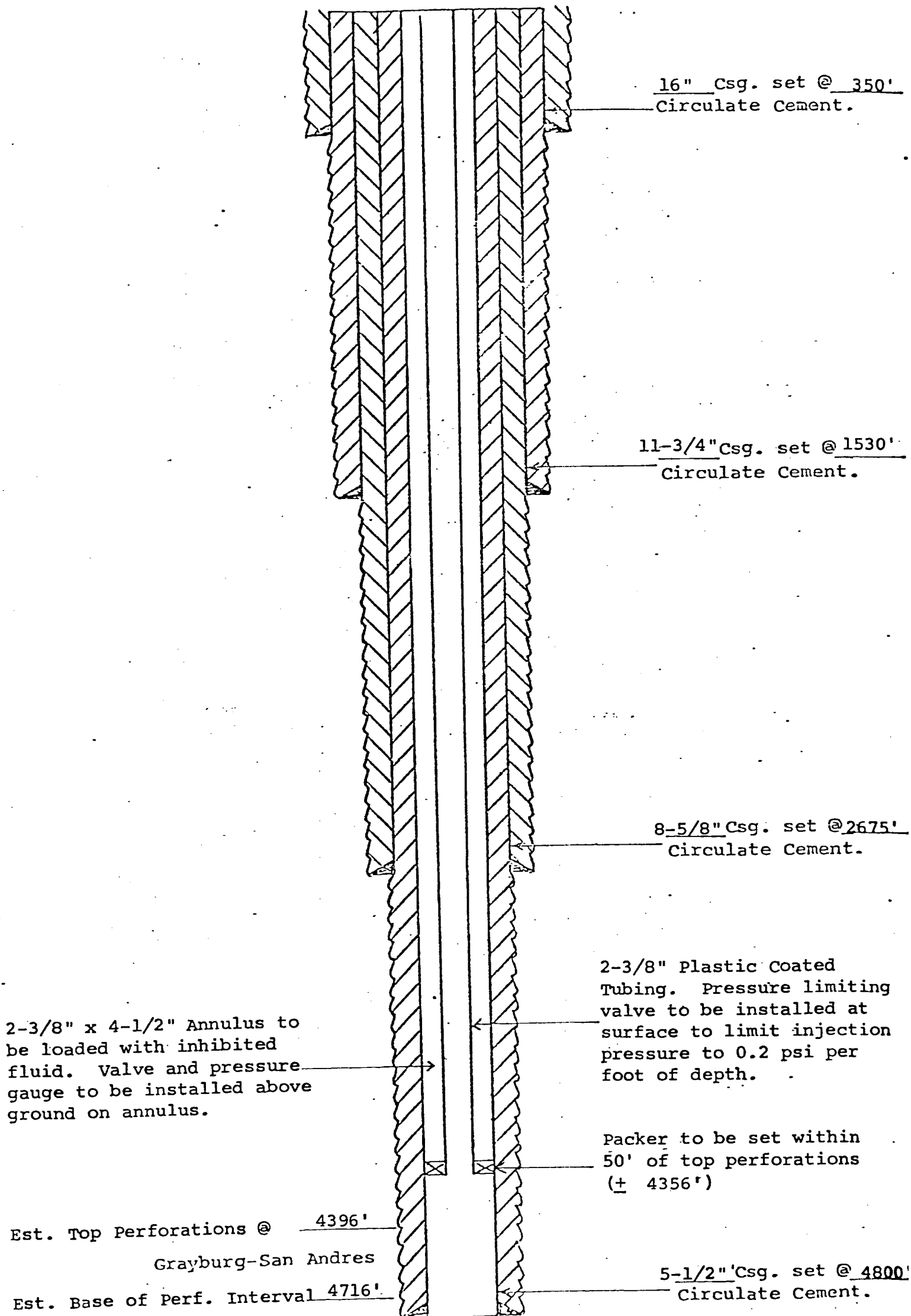

PROPOSED INJECTION WELLS
CENTRAL VACUUM UNIT
WELL NO. 155
VACUUM GRAYBURG-SAN ANDRES FIELD
LEA COUNTY, NEW MEXICO