

30-025-2730

NO. OF COPIES RECEIVED	
DISTRIBUTION	
SANTA FE	
FILE	
U.S.G.S.	
LAND OFFICE	
OPERATOR	

NEW MEXICO OIL CONSERVATION COMMISSION

Texaco Lease # 255100

Form O-101
Revised 11-65

A. Indicate Type of Lease	
STATE <input checked="" type="checkbox"/>	FEE <input type="checkbox"/>
B. State Oil & Gas Lease No.	
C. Unit Agreement Name	
D. Firm or Lease Name	
Central Vacuum Unit	
E. Well No.	
157	
F. Field and Pool, or Wildcat	
Vacuum	
G. County	
Lea	
H. Rotary or C.T.	Rotary
I. Approx. Date Work will start	Immediately

APPLICATION FOR PERMIT TO DRILL, DEEPEN, OR PLUG BACK			
1a. Type of Work			
b. Type of Well			
DRILL <input checked="" type="checkbox"/> DEEPEN <input type="checkbox"/> PLUG BACK <input type="checkbox"/>			
OIL WELL <input type="checkbox"/> GAS WELL <input type="checkbox"/> OTHER Water Injection <input checked="" type="checkbox"/> SINGLE <input type="checkbox"/> MULTIPLE <input type="checkbox"/>			
2. Name of Operator			
Texaco Inc.			
3. Address of Operator			
P. O. Box 3109 Midland, Texas 79702			
4. Location of Well			
UNIT LETTER M LOCATED 1150 FEET FROM THE South LINE			
AND 75 FEET FROM THE West LINE OF SEC. 25 T-17-S R-34-E			
21. Elevations (Show whether DF, RT, etc.)			
4004' Gr			
21A. Kind & Status of Location			
21B. Existing Drilling			
21C. Approx. Date Work will start			
Immediately			

23.

PROPOSED CASING AND CEMENT PROGRAM

SIZE OF HOLE	SIZE OF CASING	WEIGHT PER FOOT	SETTING DEPTH	SACKS OF CEMENT	EST. TOP
20"	16"	65#, H-40	350'	650	Circulate
15"	11 3/4"	42#, H-40	1570'	1200	Circulate
*11"	5 1/2"				
7 7/8"	5 1/2"	15.5#, K-55	4800'	2800	Circulate

Surface Casing: 650 sxs Class "H" w/2% CaCl₂ (15.6 ppg, 1.18 ft³/sx).Intermediate Casing: 1000 sxs 50:50 Pozmix Class "H" w/5# gilsonite, 1/4# flocele & 2% CaCl₂ (13.7 ppg, 1.37 ft³/sx), followed by 200 sxs Class "H" w/1/4# flocele/sx & 2% CaCl₂ (15.6 ppg, 1.18 ft³/sx).Production Casing: 2500 sxs HLW w/15# salt & 1/4# flocele/sx (12.5 ppg, 1.18 ft³/sx) followed by 300 sxs Class "H" w/1/4# flocele/sx (15.6 ppg, 1.18 ft³/sx).

*The 11" hole will permit the running of 8-5/8" intermediate casing should a waterflow be encountered.

APPROVAL VALID FOR 180 DAYS
PERMIT EXPIRES 5/16/83
UNLESS DRILLING UNDERWAY

NSL-1612

IN ABOVE SPACE DESCRIBE PROPOSED PROGRAM IF OTHER THAN DEEPEN, PLUG BACK, OR PLUG BACK AND PROPOSED NEW PRODUCTIVE ZONE. GIVE BLOWOUT PREVENTER PROGRAM, IF ANY.

I hereby certify that the information above is true and complete to the best of my knowledge and belief.

Signed R. S. Lane Asst. Petr. Engr. Manager September 30, 1982
R. S. Lane (This space for State Use)

APPROVED BY Eddie W. Dean TITLE OIL & GAS INSPECTOR DATE NOV 13 1982
CONDITIONS OF APPROVAL, IF ANY:

NEW MEXICO OIL CONSERVATION COMMISSION
WELL LOCATION AND ACREAGE DEDICATION PLAT

Form C-122
Supersedes C-128
Effective 1-1-65

All distances must be from the outer boundaries of the Section.

Operator Texaco Inc.		Lease Central Vacuum Unit		Well No. 157
Unit Letter M	Section 25	Township T-17-S	Range R-34-E	County Lea
Actual Footage Location of Well: 1150 feet from the South line and 75 feet from the West line				
Ground Level Elev. 4004'	Producing Formation San Andres		Pool Vacuum	Dedicated Acreage: Injection Well

1. Outline the acreage dedicated to the subject well by colored pencil or hachure marks on the plat below. **Unorthodox Location**
2. If more than one lease is dedicated to the well, outline each and identify the ownership thereof (both as to working interest and royalty).
3. If more than one lease of different ownership is dedicated to the well, have the interests of all owners been consolidated by communitization, unitization, force-pooling, etc?

☐ Yes ☐ No If answer is "yes," type of consolidation _____

If answer is "no," list the owners and tract descriptions which have actually been consolidated. (Use reverse side of this form if necessary.) _____

No allowable will be assigned to the well until all interests have been consolidated (by communitization, unitization, forced-pooling, or otherwise) or until a non-standard unit, eliminating such interests, has been approved by the Commission.

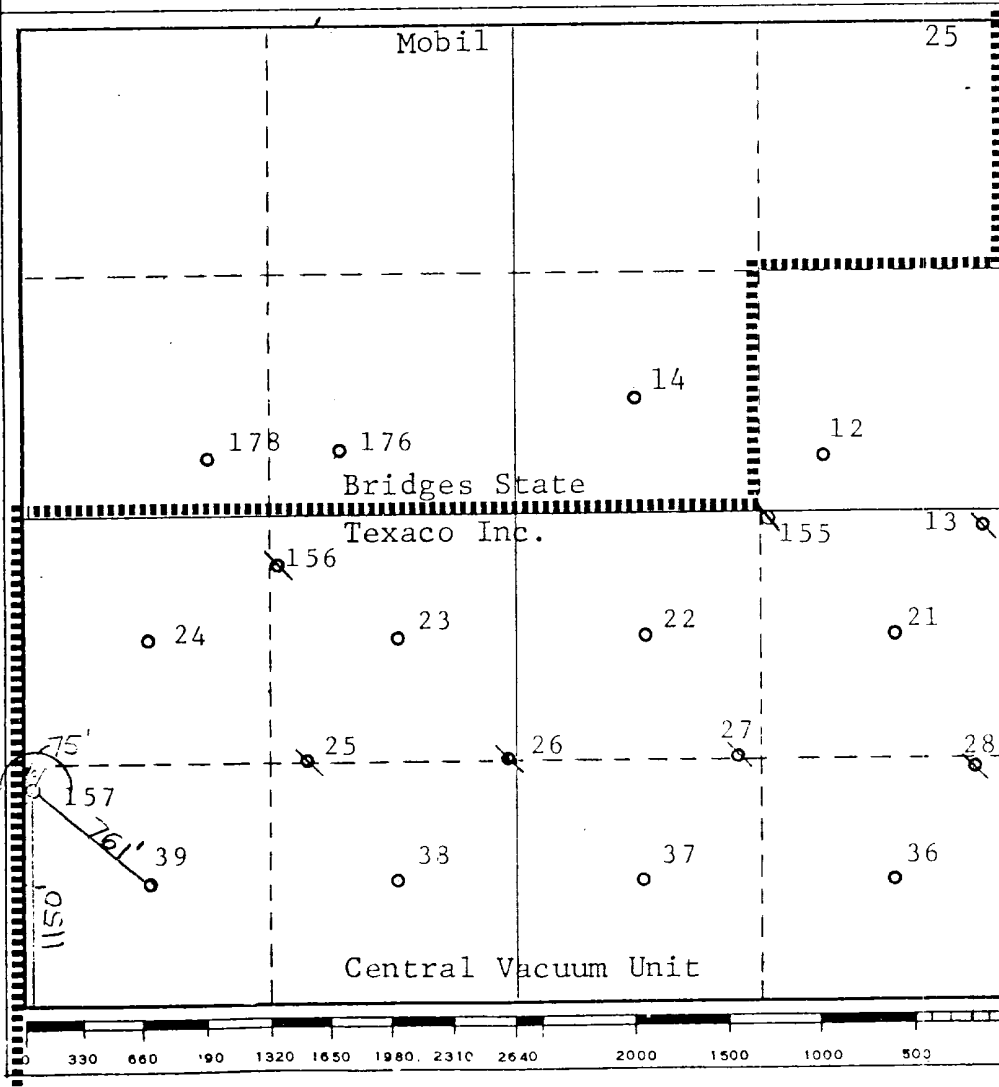

CERTIFICATION

I hereby certify that the information contained herein is true and complete to the best of my knowledge and belief.

Name **B. L. Eiland**

Position
Division Surveyor

Company
Texaco Inc.

Date
September 30, 1982

I hereby certify that the well location shown on this plat was plotted from field notes of actual surveys made by me or under my supervision, and that the same is true and correct to the best of my knowledge and belief.

Date Surveyed
September 30, 1982

Registered Professional Engineer
and/or Land Surveyor

B. L. Eiland

Certificate No.
4386

DRILLING CONTROL
CONDITION II-3000 PSI WP

H₂S TRIM REQUIRED
YES _____ NO _____

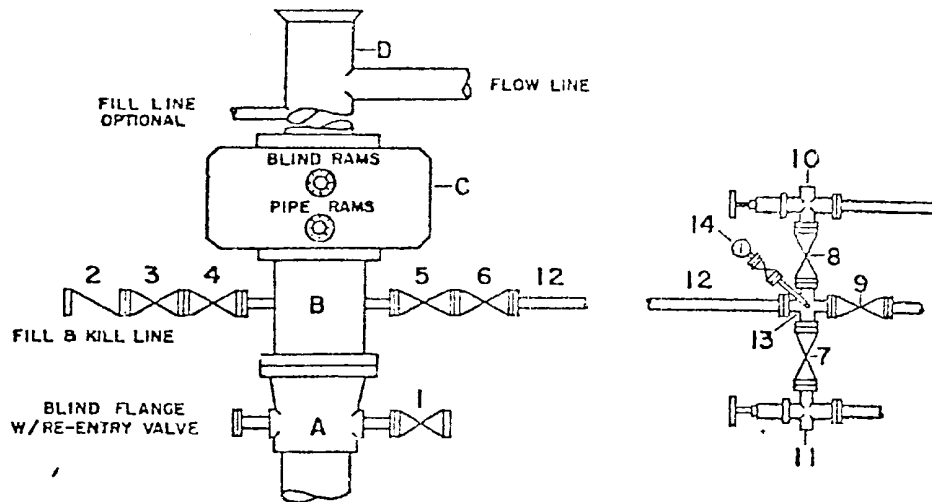

DRILLING CONTROL

MATERIAL LIST - CONDITION II

- | | |
|-----------|---|
| A | Texaco Wellhead |
| B | 3000# W.P. drilling spool with a 2" minimum flanged outlet for kill-line and 3" minimum flanged outlet for choke line |
| C | 3000# W.P. Dual ram type preventer, hydraulic operated with 1" steel, 3000# W.P. control lines (where sub-structure height is adequate, 2-3000# W.P. single ram type preventers may be utilized.) |
| D | Bell nipple with flowline and fill-up outlets. (Kill line may also be used for fill-up line.) |
| 1,3,4,7,8 | 2" minimum 3000# W.P. flanged full opening steel gate valve, or Halliburton Lo Torc Plug valve. |
| 2 | 2" minimum 3000# W.P. back pressure valve |
| 5,6,9 | 3" minimum 3000# W.P. flanged full opening steel gate valve, or Halliburton Lo Torc Plug valve. |
| 12 | 3" minimum schedule 80, Grade "B", seamless line pipe |
| 13 | 2" minimum x 3" minimum 3000# W.P. flanged cross |
| 10, 11 | 2" minimum 3000# W.P. adjustable choke bodies |
| 14 | Cameron Mud Gauge or equivalent (location optional in choke line.) |



TEXACO, INC.
PRODUCING DEPARTMENT 5
MIDLAND, TEXAS



SCALE	DATE	EST. NO.	DRG. NO.
DRAWN BY			
CHECKED BY			
APPROVED BY			

EXHIBIT B

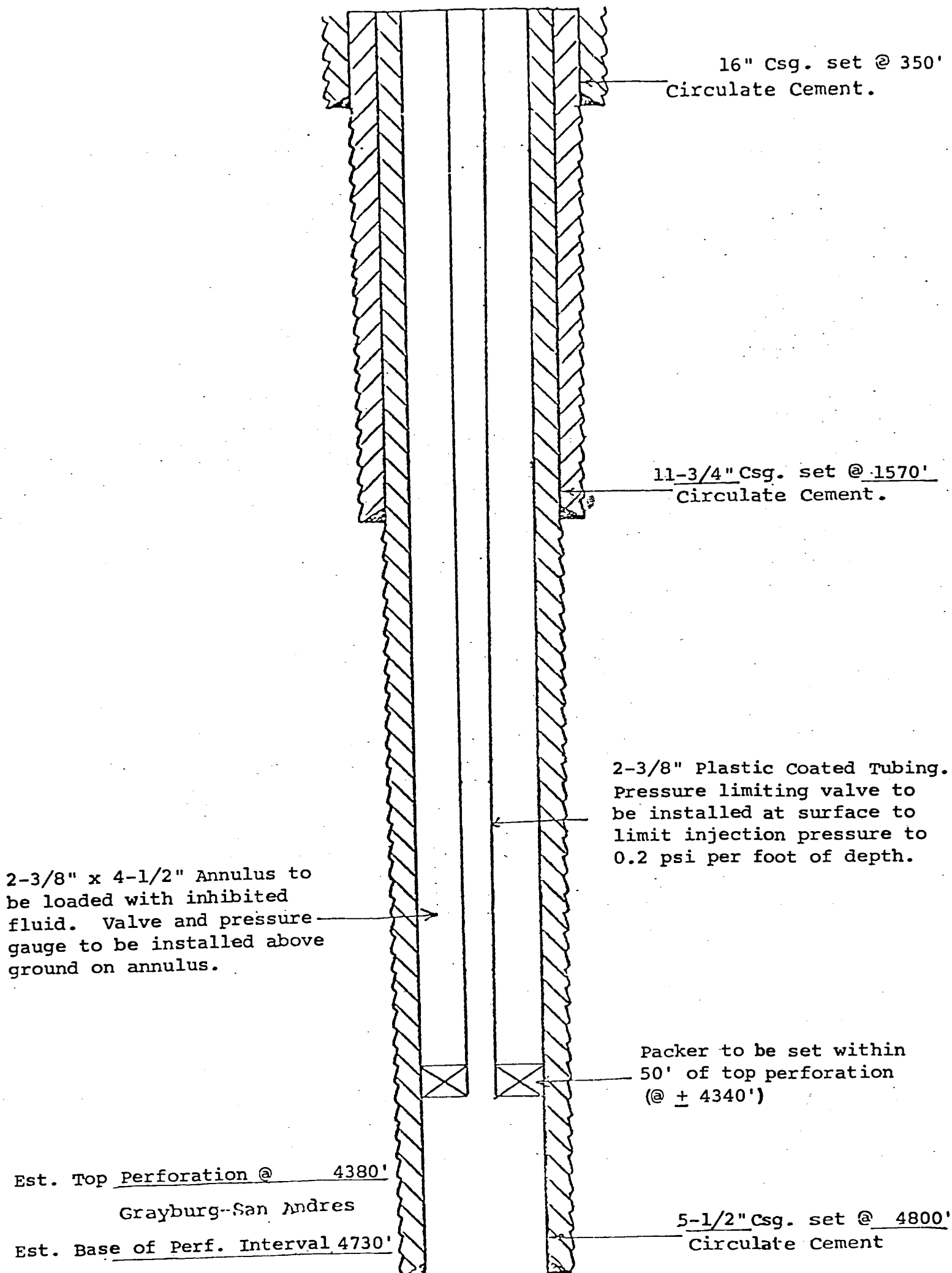

PROPOSED INJECTION WELLS

CENTRAL VACUUM UNIT
WELL NO. 157
VACUUM GRAYBURG-SAN ANDRES FIELD
LEA COUNTY, NEW MEXICO

COUNTY LEA FIELD Vacuum STATE NM
 OPR TEXACO INC. API 30-025-27967
 NO WI-157 LEASE Central Vacuum Unit MAP
Sec 25, T17S, R34E CO-ORD
1150 FSL, 75 FWL of Sec 12-4-41 NM
1 mi W/Buckeye SPD 11-15-82 CMP 11-24-82

CSG	WELL CLASS: INIT D FIN IW LSE CODE			
	FORMATION	DATUM	FORMATION	DATUM
	16-349-550 sx			
	11 3/4-1500-950 sx			
	5 1/2-4800-2000 sx			
	TD	4800 (SADR)	PBD	4775

(San Andres) Perfs 4414-4728 WATER INJECTION WELL

CONTR 4004 GL sub-s

F.R. 10-11-82
 PD 4800 RT (San Andres)
 12-25-82 AMEND WELL NUMBER: Formerly 157
 11-15-82 Drlg 4135
 11-19-82 TD 4800; WOC
 11-29-82 TD 4800; PBD 4775; Inj. began 11-24-82
 Perf (San Andres) 4414-4728 w/35 shots
 Acid (4414-4728) 8750 gals
 12-20-82 TD 4800; PBD 4775; Complete
 LOG TOPS: Yates 2817, Seven Rivers 3148,
 Queen 3726, Grayburg 4090, San Andres 4367
 12-25-82 COMPLETION ISSUED

12-4-41 NM
 IC 30-025-70780-82