

NO. OF COPIES RECEIVED	
DISTRIBUTION	
SANTA FE	
FILE	
U.S.G.S.	
LAND OFFICE	
OPERATOR	

P. O. BOX 2088

SANTA FE, NEW MEXICO 87501

API No. 30-025-

5A. Indicate Type of Lease

STATE ☒ FEE ☐

5. State Oil &amp; Gas Lease No.

B-4118

## APPLICATION FOR PERMIT TO DRILL, DEEPEN, OR PLUG BACK

a. Type of Work		7. Unit Agreement Name	
DRILL <input checked="" type="checkbox"/> DEEPEN <input type="checkbox"/> PLUG BACK <input type="checkbox"/>		-----	
b. Type of Well		8. Farm or Lease Name	
OIL WELL <input checked="" type="checkbox"/> GAS WELL <input type="checkbox"/> OTHER <input type="checkbox"/>		Lea	
SINGLE ZONE <input checked="" type="checkbox"/> MULTIPLE ZONE <input type="checkbox"/>		9. Well No.	
c. Name of Operator		28	
Phillips Petroleum Company		10. Field and Pool, or Wildcat	
d. Address of Operator		Maljamer Gb/SA	
Room 401, 4001 Penbrook, Odessa, Texas 79762			
e. Location of Well		12. County	
UNIT LETTER <u>D</u> LOCATED <u>660</u> FEET FROM THE <u>north</u> LINE		Lea	
NO <u>660</u> FEET FROM THE <u>west</u> LINE OF SEC. <u>19</u> TWP. <u>17-S</u> RGE. <u>34-E</u> NMPM			
		19. Proposed Depth	
		4800'	
		19A. Formation	
		Grayburg/ San Andres	
		20. Rotary or C.T.	
		Rotary	
1. Elevations (Show whether DF, RT, etc.)		21A. Kind & Status Plug. Bond	
4120.8 GR (Unprepared)		Blanket	
		21B. Drilling Contractor	
		advise later	
		22. Approx. Date Work will start	
		upon approval	

## 3. PROPOSED CASING AND CEMENT PROGRAM

SIZE OF HOLE	SIZE OF CASING	WEIGHT PER FOOT	SETTING DEPTH	SACKS OF CEMENT	EST. TOP
12-1/4"	8-5/8"	24#, K-55	350'	400 sx Class C w/2% CaCl. Circ to surface.	
7-7/8"	4-1/2"	11.6#, N-80	4800' (Sufficient quantity, TLW w/10% DD, 12#/sx salt, 1/4#/sx cellophane flakes & 3#/sx gilsonite followed by 250 sx Class H cement w/5#/sx salt. Circ to surface)		

Use mud additives as required for control.

BOP Equipment: Series 900, 3000# WP, per PPCo Standards, Figure No. 7 Schematic Attached.

APPROVAL VALID FOR 180 DAYS

PERMIT EXPIRES 4/14/83

UNLESS DRILLING UNDERWAY

ABOVE SPACE DESCRIBE PROPOSED PROGRAM: IF PROPOSAL IS TO DEEPEN OR PLUG BACK, GIVE DATA ON PRESENT PRODUCTIVE ZONE AND PROPOSED NEW PRODUCTION ZONE. GIVE BLOWOUT PREVENTER PROGRAM, IF ANY.

I hereby certify that the information above is true and complete to the best of my knowledge and belief.

Signed Ralph J. Rogers for W.J. Mueller Title Senior Engineering Specialist Date October 13, 1982

(This space for State Use)

ORIGINAL SIGNED BY

APPROVED BY JERRY SEXTON TITLE \_\_\_\_\_ DATE OCT 15 1982CONDITIONS OF APPROVAL DISTRICT 1 SUPR.

NEW MEXICO OIL CONSERVATION COMMISSION  
WELL LOCATION AND ACREAGE DEDICATION PLAT

Form C-102  
Supersedes C-128  
Effective 1-1-65

All distances must be from the outer boundaries of the Section

Operator <b>PHILLIPS PETROLEUM COMPANY</b>			Lease <b>LEA</b>		Well No. <b>28</b>
Section <b>D</b>	Section <b>19</b>	Township <b>17 SOUTH</b>	Range <b>34 EAST</b>	County <b>LEA</b>	
Actual Well Location of Well:					
<b>660</b>		feet from the <b>NORTH</b>		line and <b>660</b> feet from the <b>WEST</b>	
Ground Level Elev. <b>4120.8</b>	Producing Formation <b>Grayburg/ San Andres</b>		Pool <b>Maljamar Vacuum</b>	Lease Acres <b>34.30-40</b>	

1. Outline the acreage dedicated to the subject well by colored pencil or hatchure marks on the plat below.
2. If more than one lease is dedicated to the well, outline each and identify the ownership thereof (both as to working interest and royalty).
3. If more than one lease of different ownership is dedicated to the well, have the interests of all owners been consolidated by communitization, unitization, force-pooling, etc?

☐ Yes ☐ No If answer is "yes," type of consolidation \_\_\_\_\_

If answer is "no," list the owners and tract descriptions which have actually been consolidated. (Use reverse side of this form if necessary.) \_\_\_\_\_

No allowable will be assigned to the well until all interests have been consolidated (by communitization, unitization, forced-pooling, or otherwise) or until a non-standard unit, eliminating such interests, has been approved by the Commission.

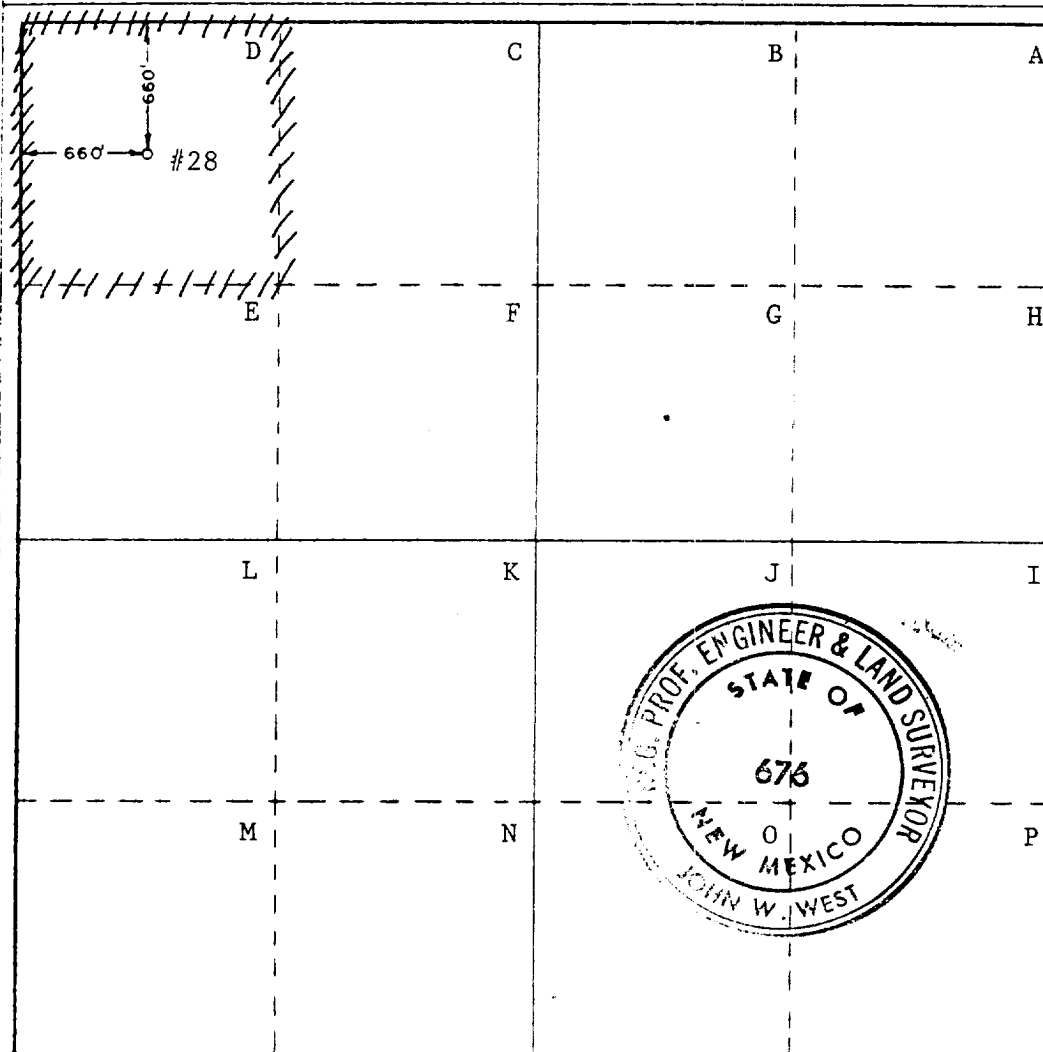

CERTIFICATION

I hereby certify that the information contained herein is true and complete to the best of my knowledge and belief.

*R. J. Mueller*  
Name **W. J. Mueller**  
Senior Engineering Specialist

Position  
**Phillips Petroleum Company**

Company

Date  
**October 13, 1982**

Date

I hereby certify that the well location shown on this plat was plotted from field notes of actual surveys made by me or under my supervision, and that the same is true and correct to the best of my knowledge and belief.

Date Surveyed

**10/04/82**

Registered Professional Engineer and/or Land Surveyor

*John W. West*

Certificate No **JOHN W. WEST 676**  
**PATRICK A. ROMERO 6863**  
**Ronald J. Eidson 3239**

330 660 990 1320 1650 1980 2310 2640 2970 3300 3630 3960 4290 4620 4950 5280 5610 5940 6270 6600

## DOUBLE PREVENTER OPTION

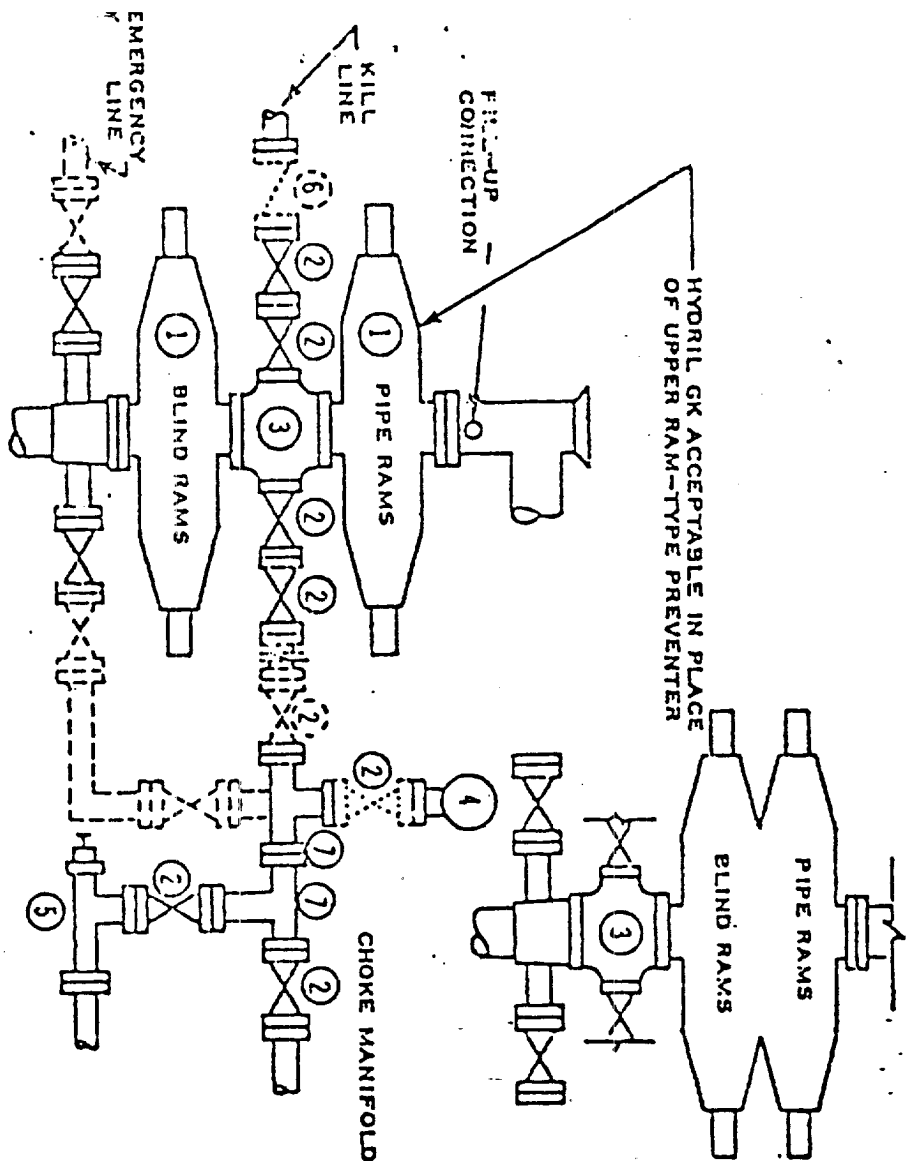

- ① SERIES 900 RAM-TYPE BOP
- ② 2" SERIES 900 VALVE
- ③ SERIES 900 DRILLING SPOOL
- ④ 2" MUD PRESSURE GAUGE
- ⑤ 2" SERIES 900 CHOKE
- ⑥ 2" SERIES 900 CHECK VALVE
- ⑦ 2" SERIES 900 STEEL TEE

### NOTES:

1. 3000 PSI WP CLAMP HUGS MAY BE SUBSTITUTED FOR FLANGES
2. VALVES MAY BE EITHER HAND OR POWER OPERATED BUT, IF POWER OPERATED, THE VALVES FLANGED TO THE BOP RUN MUST BE CAPABLE OF BEING OPENED AND CLOSED MANUALLY OR CLOSE ON POWER FAILURE AND BE CAPABLE OF BEING OPENED MANUALLY

.....OPTIONAL EQUIPMENT

PHILLIPS PETROLEUM COMPANY

3000 PSI WORKING PRESSURE  
BLOWOUT PREVENTER HOOK-UP  
(SERIES 900 FLANGES OR BETTER)

177  
RECEIVED

OCT 14 1982

O.C.D.  
HOBBS OFFICE