

NO. OF COPIES RECEIVED	
DISTRIBUTION	
SANTA FE	
FILE	
U.S.G.S.	
LAND OFFICE	
OPERATOR	

API NO.

5A. Indicate Type of Lease

STATE ☒ FEE ☐

5. State Oil & Gas Lease No.

B-2317

APPLICATION FOR PERMIT TO DRILL, DEEPEN, OR PLUG BACK

a. Type of Work SEE ORDER R-7103.

DRILL ☒

DEEPEN ☐

PLUG BACK ☐

b. Type of Well

OIL WELL ☐

GAS WELL ☐

OTHER Water Injection

SINGLE ZONE ☒

MULTIPLE ZONE ☐

c. Name of Operator

Phillips Petroleum Company

d. Address of Operator

Room 401, 4001 Penbrook Street, Odessa, Texas 79762

e. Location of Well

UNIT LETTER E LOCATED 1330 FEET FROM THE North LINE

NO 110 FEET FROM THE West LINE OF SEC. 35 TWP. 17-S RGE. 34-E N44W

7. Unit Agreement Name

8. Farm or Lease Name

Mable

9. Well No.

5

10. Field and Pool, or Wildcat Vacuum
Grayburg/San Andres

12. County

Lea

19. Proposed Depth

4800'

19A. Formation

Grayburg/San Andres

20. Rotary or C.T.

Rotary

1. Elevations (Show whether DF, RT, etc.)

4024.8' GR (Unprepared)

21A. Kind & Status Plug. Bond

Blanket

21B. Drilling Contractor

Advise Later

22. Approx. Date Work will start

Upon Approval

PROPOSED CASING AND CEMENT PROGRAM

SIZE OF HOLE	SIZE OF CASING	WEIGHT PER FOOT	SETTING DEPTH	SACKS OF CEMENT	EST. TOP
17-1/2"	13-3/8"	48#, H-40	1600'	1400 sx Class "C" w/2% CaCl ₂ & 1/4#/sx Cellophane	Circ to Surface.
** 11"	8-5/8"	32#, K-55	3240'	Circulate to surface in two stages. 1st stage. Caliper volume plus 30% excess HOWCO Light w/15#/sx salt, 1/4#/sx Cellophane & 5#/sx Gilsonite followed by 150sx Class "C" w/2% CaCl ₂ . 2nd stage. 450sx Class "H" w/2% CaCl ₂ .	
7-7/8"	5-1/2"	15.5#, K-55	4800'	Circulate to surface with caliper volume plus 30% excess TLW w/10% Diacel D, 10% salt, 1/4#/sx Cellophane & 3#/sx Gilsonite followed by 300sx Class "C" Neat.	

Use mud additives as required for control.

** If necessary to control salt water flow.

BOP EQUIPMENT: Series 900, 3000 PSI WP, BOP Standards. (See figure 7 attached.)

ABOVE SPACE DESCRIBE PROPOSED PROGRAM; IF PROPOSAL IS TO DEEPEN OR PLUG BACK, GIVE DATA ON PRESENT PRODUCTIVE ZONE AND PROPOSED NEW PRODUCE ZONE. GIVE BLOWOUT PREVENTER PROGRAM, IF ANY.

I hereby certify that the information above is true and complete to the best of my knowledge and belief.

W. J. Mueller Title Senior Engineering Specialist Date 11-23-82

ORIGINAL SIGNED BY

JERRY SEXTON

APPROVED BY TITLE DATE

CONDITIONS OF APPROVAL, IF ANY

DEC 22 1982

APPROVAL VALID FOR 180 DAYS
PERMIT NUMBER 6722133
UNLESS DRILLING UNDERWAY

**NEW MEXICO OIL CONSERVATION COMMISSION
WELL LOCATION AND ACREAGE DEDICATION PLAT**

Form C-102
Supersedes C-128
Effective 1-1-65

All distances must be from the outer boundaries of the Section.

Operator PHILLIPS PETROLEUM COMPANY			Lease MABLE		Well No. 5
Unit Letter E	Section 35	Township 17 SOUTH	Range 34 EAST	County LEA	
Actual Footage Location of Well: 1330 feet from the NORTH line and 110 feet from the WEST line					
Ground Level Elev. 4024.8	Producing Formation Grayburg-San Andres		Pool Vacuum Grayburg-San Andres		Dedicated Acreage: Acres

(Unprepared)

1. Outline the acreage dedicated to the subject well by colored pencil or hachure marks on the plat below.
2. If more than one lease is dedicated to the well, outline each and identify the ownership thereof (both as to working interest and royalty).
3. If more than one lease of different ownership is dedicated to the well, have the interests of all owners been consolidated by communitization, unitization, force-pooling, etc?

☐ Yes ☐ No If answer is "yes," type of consolidation _____

If answer is "no," list the owners and tract descriptions which have actually been consolidated. (Use reverse side of this form if necessary.) _____

No allowable will be assigned to the well until all interests have been consolidated (by communitization, unitization, forced-pooling, or otherwise) or until a non-standard unit, eliminating such interests, has been approved by the Commission.

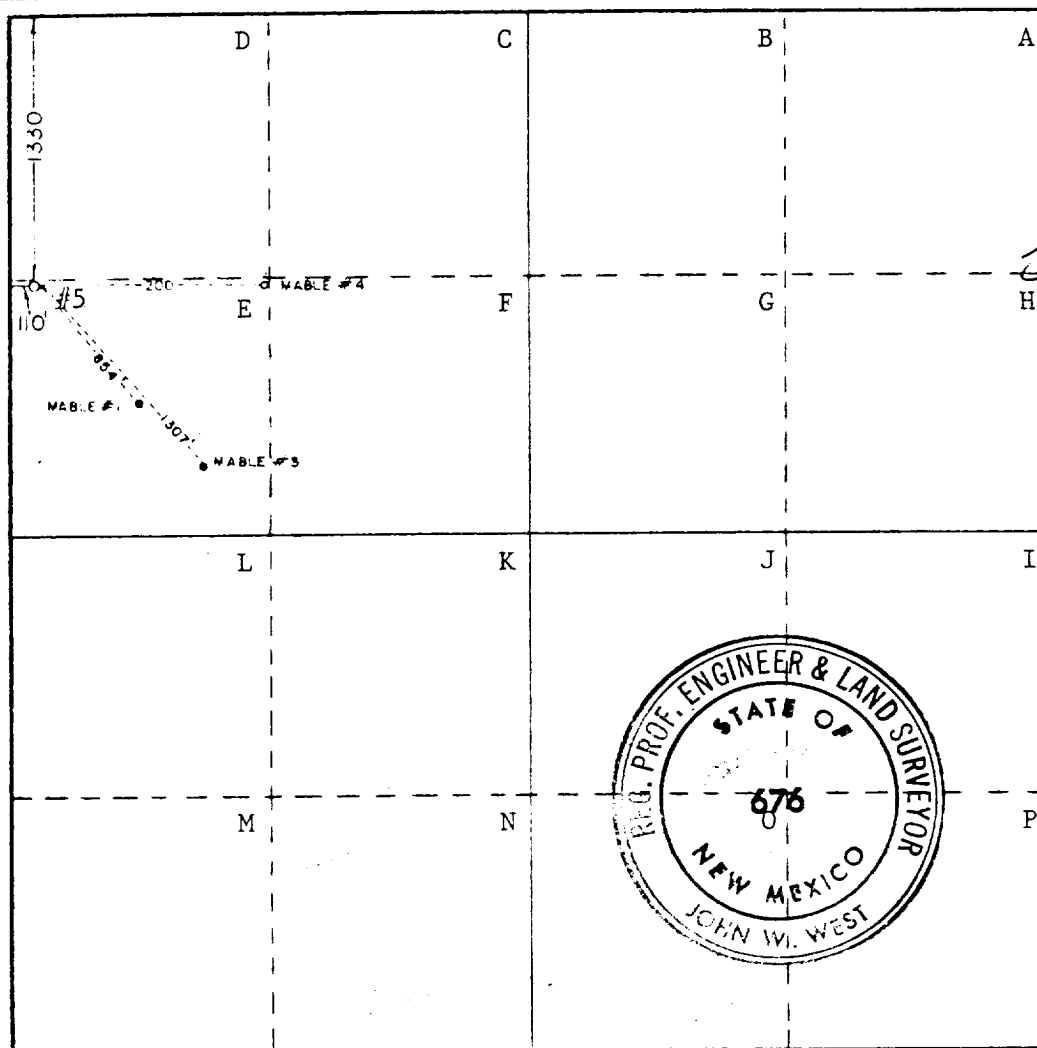

CERTIFICATION

I hereby certify that the information contained herein is true and complete to the best of my knowledge and belief.

[Signature] **W. J. Mueller**
Senior Engineering Specialist

Position
Phillips Petroleum Company
Company

Date
11-23-82

I hereby certify that the well location shown on this plat was plotted from field notes of actual surveys made by me or under my supervision, and that the same is true and correct to the best of my knowledge and belief.

Date Surveyed
10/18/82

Registered Professional Engineer
and/or Land Surveyor

[Signature]
Certificate No.

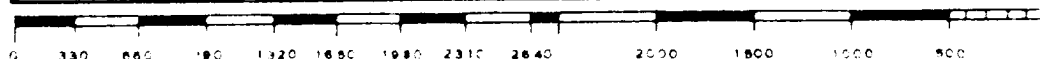

DOUBLE PREVENTER OPTION

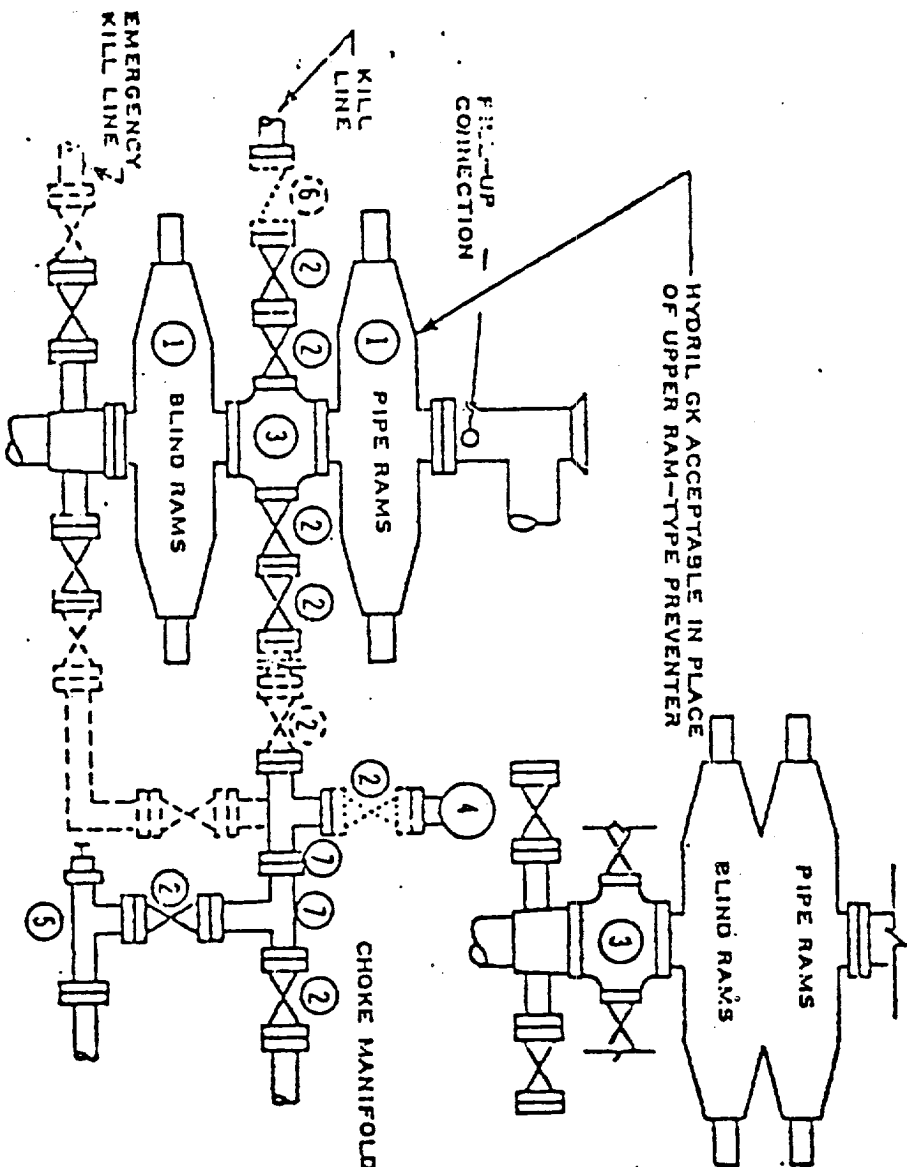

- ① SERIES 900 RAM-TYPE BOP
- ② 2" SERIES 900 VALVE
- ③ SERIES 900 DRILLING SPOOL
- ④ 2" MUD PRESSURE GAUGE
- ⑤ 2" SERIES 900 CHOKE
- ⑥ 2" SERIES 900 CHECK VALVE
- ⑦ 2" SERIES 900 STEEL TEE

NOTES:

- 1. 3000 PSI WP CLAMP HUBS MAY BE SUBSTITUTED FOR FLANGES
- 2. VALVES MAY BE EITHER HAND OR POWER OPERATED BUT, IF POWER OPERATED, THE VALVES FLANGED TO THE BOP RUN MUST BE CAPABLE OF BEING OPENED AND CLOSED MANUALLY OR CLOSE ON POWER FAILURE AND BE CAPABLE OF BEING OPENED MANUALLY

.....OPTIONAL EQUIPMENT

PHILLIPS PETROLEUM COMPANY

3000 PSI WORKING PRESSURE
BLOWOUT PREVENTER HOOK-UP
(SERIES 900 FLANGES OR BETTER)



PHILLIPS PETROLEUM COMPANY

ODESSA, TEXAS 79762
4001 PENBROOK

EXPLORATION AND PRODUCTION GROUP
Permian Basin Region

November 2, 1982

Waiver of Objection to Drill
Lease-Line Injection Wells at
Unorthodox Locations,
Phillips Hale-Mable Vacuum G-SA
Pressure Maintenance Project,
Vacuum Grayburg-San Andres Field,
Lea County, New Mexico

New Mexico Oil Conservation Division
P. O. Box 2088
Santa Fe, New Mexico

Gentlemen:

As an authorized representative of the below named offset operator, I have been duly informed by Phillips Petroleum Company of their application to drill the attached lease-line injection wells. It is understood that the wells will be drilled to a depth of approximately 4,800 feet for the purpose of water injection into the Grayburg and San Andres formations at pressures not to exceed 0.2 psi/ft., at an average rate of 1,500 BWPD/well. I hereby waive any objection to the granting of their request to drill the attached wells.

It is understood that the subject wells are to be located as per attached.

Texaco Inc.
Offset Operator

By

R. L. Lane

Date

11-4-82

DE:1bb



PHILLIPS PETROLEUM COMPANY

ODESSA, TEXAS 79762
4001 PENBROOK

EXPLORATION AND PRODUCTION GROUP
Permian Basin Region

November 2, 1982

Waiver of Objection to Drill
Lease-Line Injection Wells at
Unorthodox Locations,

Phillips Hale-Mable Vacuum G-SA
Pressure Maintenance Project,
Vacuum Grayburg-San Andres Field,
Lea County, New Mexico

New Mexico Oil Conservation Division
P. O. Box 2088
Santa Fe, New Mexico

Gentlemen:

As an authorized representative of the below named offset operator, I have been duly informed by Phillips Petroleum Company of their application to drill the attached lease-line injection wells. It is understood that the wells will be drilled to a depth of approximately 4,800 feet for the purpose of water injection into the Grayburg and San Andres formations at pressures not to exceed 0.2 psi/ft., at an average rate of 1,500 BWPD/well. I hereby waive any objection to the granting of their request to drill the attached wells.

It is understood that the subject wells are to be located as per attached.

CONOCO INC.

Offset Operator

By



Date

NOVEMBER 3, 1982

DH:1bb

PHILLIPS HALE-MABLE VACUUM G-SA
PRESSURE MAINTENANCE PROJECT

<u>Well Name and No.</u>	<u>Location</u>
M. E. Hale Co-op Well No. 14	2630' FSL & 1330' FWL, Section 35, T-17-S, R-34-E, Lea County, New Mexico
M. E. Hale Co-op Well No. 15	2630' FSL & 2630' FWL, Section 35, T-17-S, R-34-E, Lea County, New Mexico
M. E. Hale Co-op Well No. 16	2630' FSL & 1330' FEL, Section 35, T-17-S, R-34-E, Lea County, New Mexico
M. E. Hale Co-op Well No. 17	1310' FSL & 1330' FWL, Section 35, T-17-S, R-34-E, Lea County, New Mexico
M. E. Hale Co-op Well No. 18	1410' FSL & 10' FEL, Section 35, T-17-S, R-34-E, Lea County, New Mexico
M. E. Hale Co-op Well No. 19	10' FSL & 1210' FEL, Section 35, T-17-S, R-34-E, Lea County, New Mexico
Mable Co-op Well No. 4	1330' FNL & 1310' FWL, Section 35, T-17-S, R-34-E, Lea County, New Mexico
Mable Co-op Well No. 5	1330' FNL & 110' FWL, Section 35, T-17-S, R-34-E, Lea County, New Mexico

RECEIVED
NOV 29 1982
O.C.
HOBBS OFFICE

173