

NO. OF COPIES RECEIVED	
DISTRIBUTION	
SANTA FE	
FILE	
U.S.G.S.	
LAND OFFICE	
OPERATOR	

P. O. BOX 2088
SANTA FE, NEW MEXICO 87501

5A. Indicate Type of Lease
STATE ☒ FEE ☐
5. State Oil & Gas Lease No.
B-2317

API NO.

APPLICATION FOR PERMIT TO DRILL, DEEPEN, OR PLUG BACK

a. Type of Work SEE ORDER R-7103.
DRILL ☒ DEEPEN ☐ PLUG BACK ☐
b. Type of Well
OIL WELL ☒ GAS WELL ☐ OTHER ☐ SINGLE ZONE ☒ MULTIPLE ZONE ☐
c. Name of Operator
Phillips Petroleum Company
d. Address of Operator
Room 401, 4001 Penbrook Street, Odessa, Texas 79762
e. Location of Well
UNIT LETTER I LOCATED 1360 FEET FROM THE South LINE

7. Unit Agreement Name

8. Farm or Lease Name
Hale, M. E.
9. Well No.
13
10. Field and Pool, or Wildcat
Grayburg Vacuum
Grayburg/San Andres
12. County
Lea

1210 FEET FROM THE East LINE OF SEC. 35 TWP. 17-S RGE. 34-E

19. Proposed Depth 4800'
19A. Formation Greyburg/San Andres
20. Rotary or C.T. Rotary
21. Elevations (show whether DF, RT, etc.) 4010.4' GR (Unprepared)
21A. Kind & Status Plug. Bond Blanket
21B. Drilling Contractor Advise Later
22. Approx. Date Work will start Upon Approval

23. PROPOSED CASING AND CEMENT PROGRAM

SIZE OF HOLE	SIZE OF CASING	WEIGHT PER FOOT	SETTING DEPTH	SACKS OF CEMENT	EST. TOP
17-1/2"	13-3/8"	48#, H-40	1560'	1400 sx Class "C" w/2% CaCl ₂ & 1/4#/sx Cellophane.	Circ to Surface.
** 12-1/4"	10-3/4"	40.5#, H-40	3200'	Circulate to surface in two stages. 1st stage. Caliper volume plus 30% excess HOWCO Light w/15#/sx salt, 1/4#/sx Cellophane & 5#/sx Gilsonite followed by 150sx Class "C" w/2% CaCl ₂ . 2nd stage. 450sx Class "H" w/2% CaCl ₂ .	
9-1/2"	7"	26#, K-55	4800'	Circulate to surface with Caliper volume plus 30% excess TLW w/10% Diacel D, 10% salt, 1/4#/sx Cellophane & 3#/sx Gilsonite followed by 400 sx Class "C" Neat.	

Use mud additives as required for control.

** If necessary to control salt water flow.

NOTE: This well is to share proration unit with well No. 1.

BOP EQUIPMENT: Series 900, 3000 PSI WP, BOP Standards. (See figure 7 attached.)

APPROVAL VALID FOR 180 DAYS
PERMIT EXPIRES 11-23-82
UNLESS DRILLING UNDERWAY

IN ABOVE SPACE DESCRIBE PROPOSED PROGRAM: IF PROPOSAL IS TO DEEPEN OR PLUG BACK, GIVE DATA ON PRESENT PRODUCTIVE ZONE AND PROPOSED NEW FRACTURE ZONE. GIVE BLOWOUT PREVENTER PROGRAM, IF ANY.

I hereby certify that the information above is true and complete to the best of my knowledge and belief.

W. J. Mueller Title Senior Engineering Specialist Date 11-23-82

(This space for State Use)

ORIGINAL SIGNED BY

APPROVED BY JERRY SEXTON TITLE DATE

CONDITIONS OF APPROVAL: IF DISTRICT 1 SUPR.

JAN 12 1983

RECEIVED
NOV 29 1982
O.C.D.
HOBBS OFFICE

NEW ICO OIL CONSERVATION COMMISSION
WELL LOCATION AND ACREAGE DEDICATION PLAT

Form C-102
Supersedes C-128
Effective 1-1-65

All distances must be from the outer boundaries of the Section

Operator PHILLIPS PETROLEUM COMPANY			Lease M.E. HALE		Well No. 13
Unit Letter I	Section 35	Township 17 SOUTH	Range 34 EAST	County LEA	
Actual Portage Location of Well: 1360 feet from the SOUTH line and 1210 feet from the EAST line					
Ground Level Elev. 4010.4	Producing Formation Grayburg-San Andres		Pool Vacuum Grayburg-San Andres		Dedicated Acreage: 40 Acres

(Unprepared)

- Outline the acreage dedicated to the subject well by colored pencil or hatchure marks on the plat below.
- If more than one lease is dedicated to the well, outline each and identify the ownership thereof (both as to working interest and royalty).
- If more than one lease of different ownership is dedicated to the well, have the interests of all owners been consolidated by communitization, unitization, force-pooling, etc?

☐ Yes ☐ No If answer is "yes," type of consolidation _____

If answer is "no," list the owners and tract descriptions which have actually been consolidated (Use reverse side of this form if necessary.) _____

No allowable will be assigned to the well until all interests have been consolidated (by communitization, unitization, forced-pooling, or otherwise) or until a non-standard unit, eliminating such interests, has been approved by the Commission.

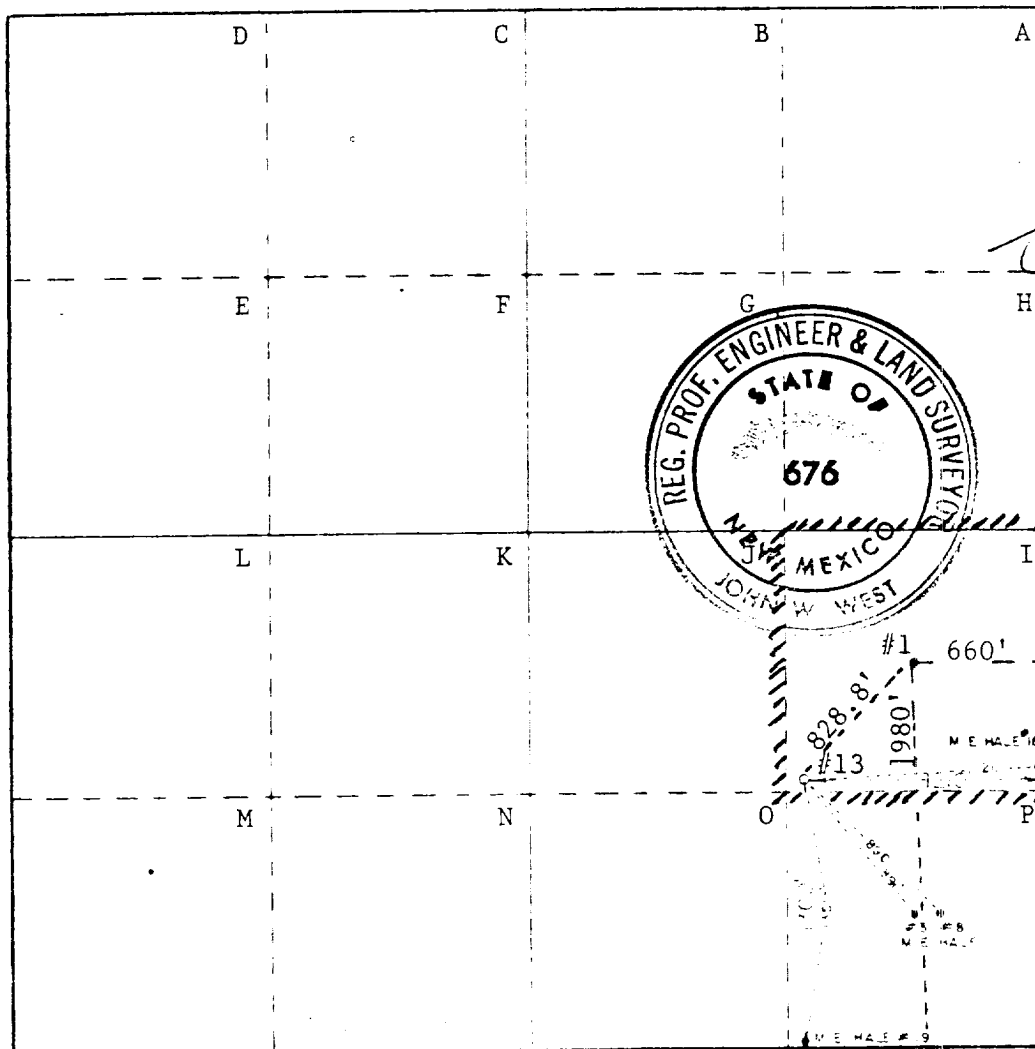

CERTIFICATION

I hereby certify that the information contained herein is true and complete to the best of my knowledge and belief.

[Signature] W. J. Mueller

Senior Engineering Specialist

Phillips Petroleum Company

Date 11-23-82

I hereby certify that the well location shown on this plat was plotted from field notes of actual surveys made by me or under my supervision, and that the same is true and correct to the best of my knowledge and belief.

Date Surveyed 10/16/82

Registered Professional Engineer and Professional Surveyor

[Signature]

Certificate No.

RECEIVED
NOV 29 1982
O.C.D.
HOBBS OFFICE

DOUBLE PREVENTER OPTION

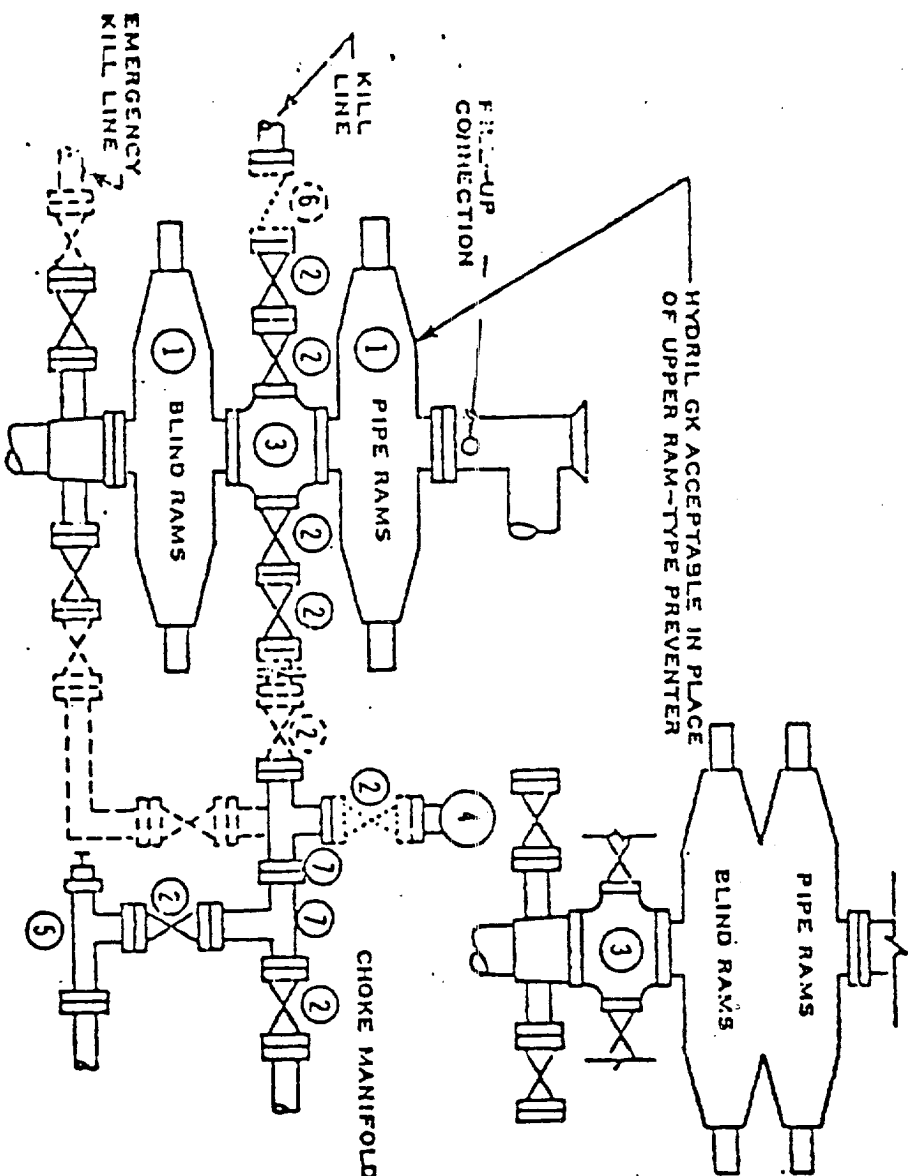

- ① SERIES 900 RAM-TYPE BOP
- ② 2" SERIES 900 VALVE
- ③ SERIES 900 DRILLING SPOOL
- ④ 2" MUD PRESSURE GAUGE
- ⑤ 2" SERIES 900 CHOKE
- ⑥ 2" SERIES 900 CHECK VALVE
- ⑦ 2" SERIES 900 STEEL TEE

NOTES:

- 1. 3000 PSI WP CLAMP HUGS MAY BE SUBSTITUTED FOR FLANGES
- 2. VALVES MAY BE EITHER HAND OR POWER OPERATED BUT, IF POWER OPERATED, THE VALVES FLANGED TO THE BOP RUN MUST BE CAPABLE OF BEING OPENED AND CLOSED MANUALLY OR CLOSE ON POWER FAILURE AND BE CAPABLE OF BEING OPENED MANUALLY

..... OPTIONAL EQUIPMENT

PHILLIPS PETROLEUM COMPANY

3000 PSI WORKING PRESSURE
BLOWOUT PREVENTER HOOK-UP
(SERIES 900 FLANGES OR BETTER)

RECEIVED
NOV 29 1982
C.C.D.
HOBBS OFFICE