

30-025-28133

NO. OF COPIES RECEIVED	
DISTRIBUTION	
SANTA FE	
FILE	
U.S.G.S.	
LAND OFFICE	
OPERATOR	

NEW MEXICO OIL CONSERVATION COMMISSION

Form C-101
Revised 1-1-65

5A. Indicate Type of Lease STATE <input checked="" type="checkbox"/> FEE <input type="checkbox"/>
5. State Oil & Gas Lease No.
7. Unit Agreement Name
8. Farm or Lease Name State G.S. 16
9. Well No. 1
10. Field and Pool, or Wildcat Vacuum North <i>abo</i>
12. County Lea
19. Proposed Depth 9,000'
19A. Formation Abo
20. Rotary or C.T. Rotary
21. Elevations (Show whether DF, RT, etc.) 4087. 1
21A. Kind & Status Plug. Bond Blanket, O.K.
21B. Drilling Contractor Hondo Drilling
22. Approx. Date Work will start 1-27-83

APPLICATION FOR PERMIT TO DRILL, DEEPEN, OR PLUG BACK	
1a. Type of Work b. Type of Well DRILL <input checked="" type="checkbox"/> DEEPEN <input type="checkbox"/> PLUG BACK <input type="checkbox"/> OIL WELL <input checked="" type="checkbox"/> GAS WELL <input type="checkbox"/> OTHER <input type="checkbox"/> SINGLE ZONE <input checked="" type="checkbox"/> MULTIPLE ZONE <input type="checkbox"/>	
2. Name of Operator Samedan Oil Corporation	
3. Address of Operator 600 N. Marienfeld, Suite 320, Midland, Texas 79701	
4. Location of Well UNIT LETTER <u>P</u> LOCATED <u>660</u> FEET FROM THE <u>South</u> LINE AND <u>660</u> FEET FROM THE <u>East</u> LINE OF SEC. <u>16</u> TWP. <u>17S</u> RGE. <u>34E</u> NMPM	
23. PROPOSED CASING AND CEMENT PROGRAM	

SIZE OF HOLE	SIZE OF CASING	WEIGHT PER FOOT	SETTING DEPTH	SACKS OF CEMENT	EST. TOP
17 1/2"	13 3/8"	48#	40'		Surface
12 1/2"	8 5/8"	24#	1700'	800	Surface
7 7/8"	5 1/2"	17# & 15.5#	9000' *	1510	Surface

We plan to drill and run casing according to the above outlined program.

Completion will be made in the Abo Formation if shows and test warrant.

- * 0-800'-5 1/2" 17# K-55 LT&C
800-6350'-5 1/2" 15.5# K-55 LT&C
6350-9000'-5 1/2" 17# K-55 LT&C

DV Tool at 6000'

IN ABOVE SPACE DESCRIBE PROPOSED PROGRAM: IF PROPOSAL IS TO DEEPEN OR PLUG BACK, GIVE DATA ON PRESENT PRODUCTIVE ZONE AND PROPOSED NEW PRODUCTIVE ZONE. GIVE BLOWOUT PREVENTER PROGRAM, IF ANY.

I hereby certify that the information above is true and complete to the best of my knowledge and belief.

Signed Vertis Diamond Title Division Clerk Date 1-23-83

(This space for State Use)

APPROVED BY EDDIE W. SEAY TITLE _____
CONDITIONS OF APPROVAL, IF ANY:

JAN 24 1983
APPROVAL VALID FOR 180 DAYS
PERMIT EXPIRES 7/24/83
UNLESS DRILLING UNDERWAY

RECEIVED

JAN 24 1983

O.C.D.
HOBBS OFFICE

NEW MEXICO OIL CONSERVATION COMMISSION
WELL LOCATION AND ACREAGE DEDICATION PLAT

Form C-102
Supersedes C-128
Effective 1-1-65

All distances must be from the outer boundaries of the Section

Operator SAMEDAN OIL CORP.			Lease STATE G.S. 16			Well No. 1		
Unit Letter P	Section 16	Township 17S	Range 34E	County LEA				
Actual Footage Location of Well: 660 feet from the SOUTH line and 660 feet from the EAST line								
Ground Level Elev. 4087.1	Producing Formation Abo		Pool Vacuum North <i>Ab</i>			Dedicated Acreage: 80 Acres		

1. Outline the acreage dedicated to the subject well by colored pencil or hatchure marks on the plat below.
2. If more than one lease is dedicated to the well, outline each and identify the ownership thereof (both as to working interest and royalty).
3. If more than one lease of different ownership is dedicated to the well, have the interests of all owners been consolidated by communitization, unitization, force-pooling, etc?

☐ Yes ☐ No If answer is "yes," type of consolidation _____

If answer is "no," list the owners and tract descriptions which have actually been consolidated. (Use reverse side of this form if necessary.) _____

No allowable will be assigned to the well until all interests have been consolidated (by communitization, unitization, forced-pooling, or otherwise) or until a non-standard unit, eliminating such interests, has been approved by the Commission.

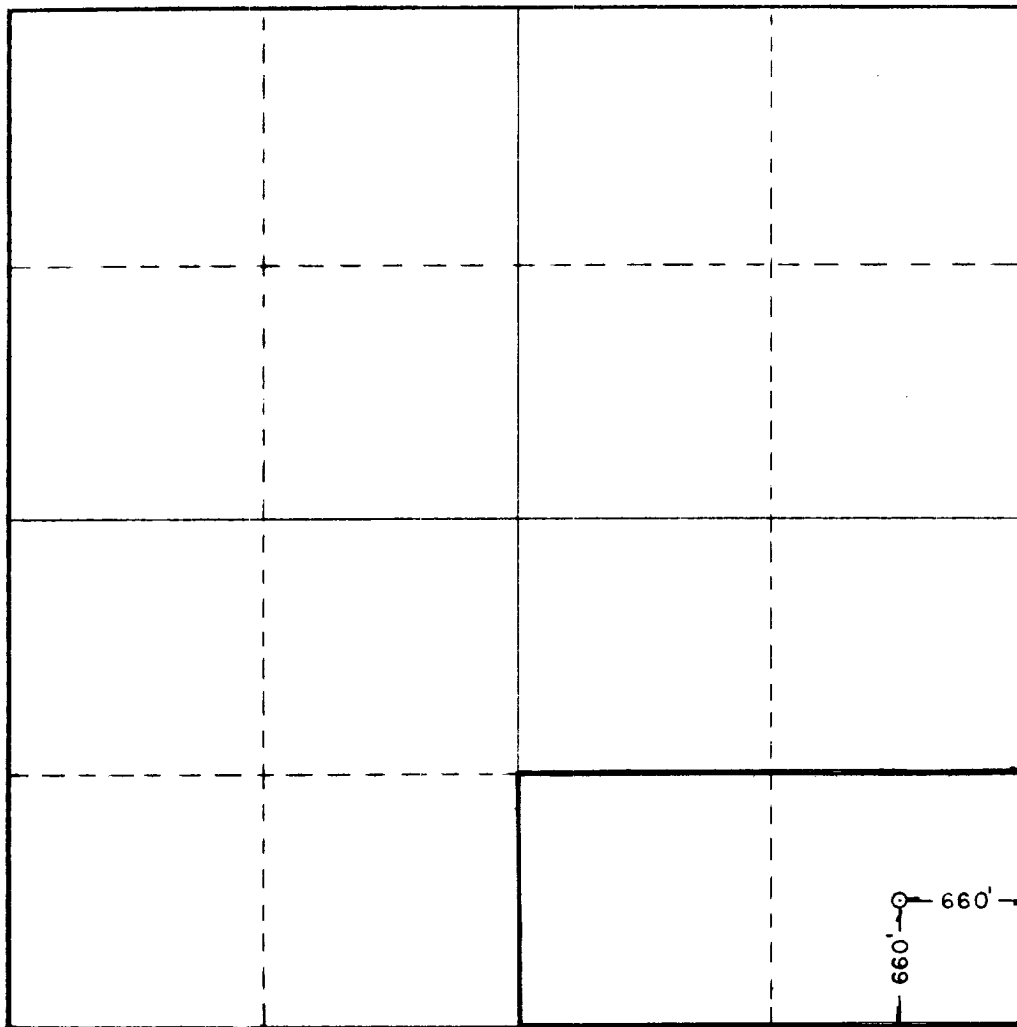

CERTIFICATION

I hereby certify that the information contained herein is true and complete to the best of my knowledge and belief.

John W. West
Name

Position

Company

Date

1-21-83

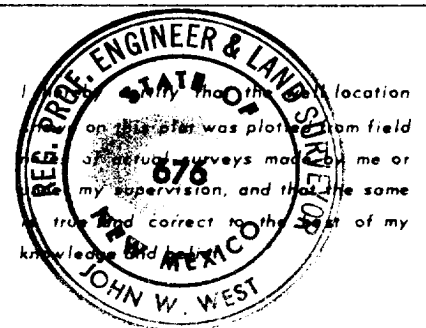

Date Surveyed

1/13/83

Registered Professional Engineer and/or Land Surveyor

John W. West
Certificate No.

JOHN W. WEST N.M. #676

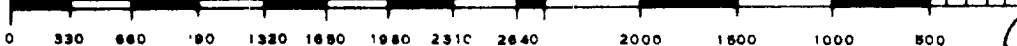

RECEIVED

JAN 24 1983

O.C.D.
HOBBS OFFICE

173