

NO. OF COPIES RECEIVED		
DISTRIBUTION		
SANTA FE		
FILE		
U.S.G.S.		
LAND OFFICE		
OPERATOR		

Form C-101
Revised 1-1-65

5A. Indicate Type of Lease	
STATE <input checked="" type="checkbox"/>	FEE <input type="checkbox"/>
5. State Oil & Gas Lease No. LG 1630	
7. Unit Agreement Name	
8. Farm or Lease Name State "TZ"	
9. Well No. 1	
10. Field and Pool, or Wildcat Scharb Bone Springs	
12. County Lea	
tion	20. Rotary or C.T. Rotary
22. Approx. Date Work will start 3-1-83	

1a. Type of Work			
b. Type of Well		DRILL <input checked="" type="checkbox"/>	DEEPEN <input type="checkbox"/>
OIL WELL <input checked="" type="checkbox"/>	GAS WELL <input type="checkbox"/>	OTHER <input type="checkbox"/>	
2. Name of Operator		PLUG BACK <input type="checkbox"/>	
Gulf Oil Corporation		SINGLE ZONE <input type="checkbox"/>	
3. Address of Operator		MULTIPLE ZONE <input type="checkbox"/>	
P. O. Box 670, Hobbs, NM 88240			
4. Location of Well			
UNIT LETTER	C	LOCATED	660
FEET FROM THE		North	
AND	1980	FEET FROM THE	West
LINE OF SEC.		16	TWP.
19S		RGE.	35E
NMPM			
19. Proposed Depth		19A. Formation	
9900'		Bon	
21. Elevations (Show whether DP, RT, etc.)		21A. Kind & Status Plug. Bond	
3812' GL		Blanket	
21B. Drilling Contractor			
Gulf Rig #4			

PROPOSED CASING AND CEMENT PROGRAM

SIZE OF HOLE	SIZE OF CASING	WEIGHT PER FOOT	SETTING DEPTH	SACKS OF CEMENT	EST. TOP
17½"	13-3/8"	48#	400'	350	surf circ
12¼"	8-5/8"	28#	4200'	1000	tieback to 13-3/8 csg
7-7/8"	5½"	15.5&17#	9900'	500	to be determined by caliper log

Mud Program:	0' - 400'	Fresh water spud mud 8.6ppg
	400' - 4200'	Brine water w/gel sweeps 9.5-10.0ppg
	4200' - 9900'	Cut brine w/possible mud up with gel & starch 8.7-9.3ppg, WL 20-30cc

See Attached BOP Drawing #2

APPROVAL VALID FOR 180 DAYS
PERMIT EXPIRES 8/16/83
UNLESS DRILLING UNDERWAY

IN ABOVE SPACE DESCRIBE PROPOSED PROGRAM: IF PROPOSAL IS TO DEEPEN OR PLUG BACK, GIVE DATA ON PRESENT PRODUCTIVE ZONE AND PROPOSED NEW PRODUCTIVE ZONE. GIVE BLOWOUT PREVENTER PROGRAM, IF ANY.

I hereby certify that the information above is true and complete to the best of my knowledge and belief.

Signed R. C. Under Title Area Production Manager Date 2-10-83

(This space for State Use)

ORIGINAL SIGNED BY JERRY SEXTON

APPROVED BY DISTRICT 1 SUPERVISOR TITLE _____ DATE FEB 11 1983

CONDITIONS OF APPROVAL, IF ANY:

DATE FEB 17 1983

RECEIVED

FEB 16 1983

RECEIVED
O.C.D.
HOBBS OFFICE

FEB 14 1983

O.C.D.
HOBBS OFFICE

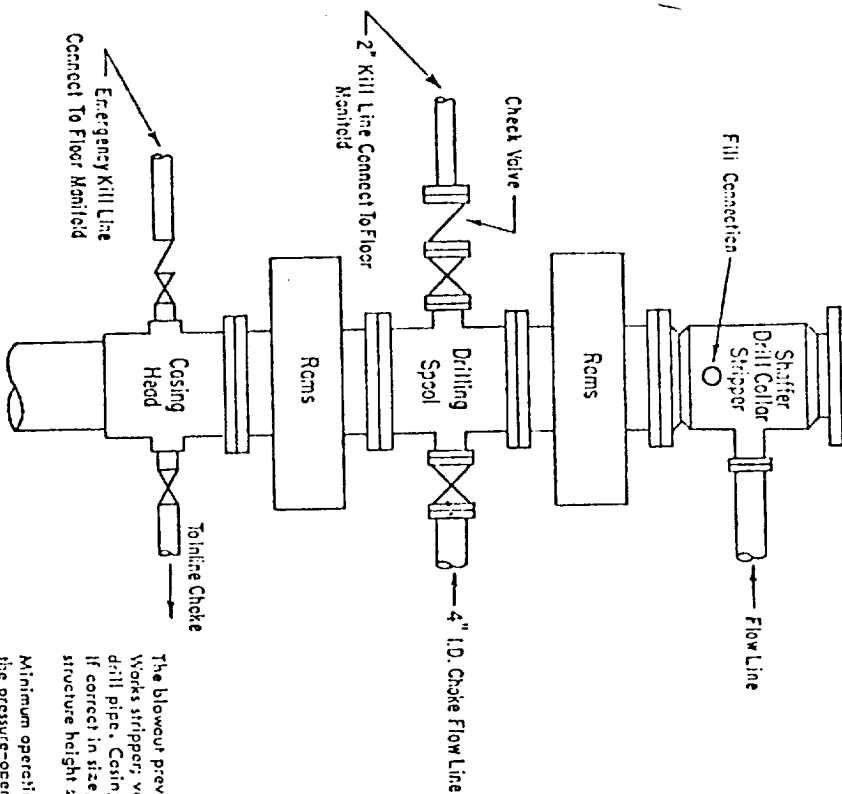

3000 PSI WORKING PRESSURE BLOWOUT PREVENTER HOOK-UP

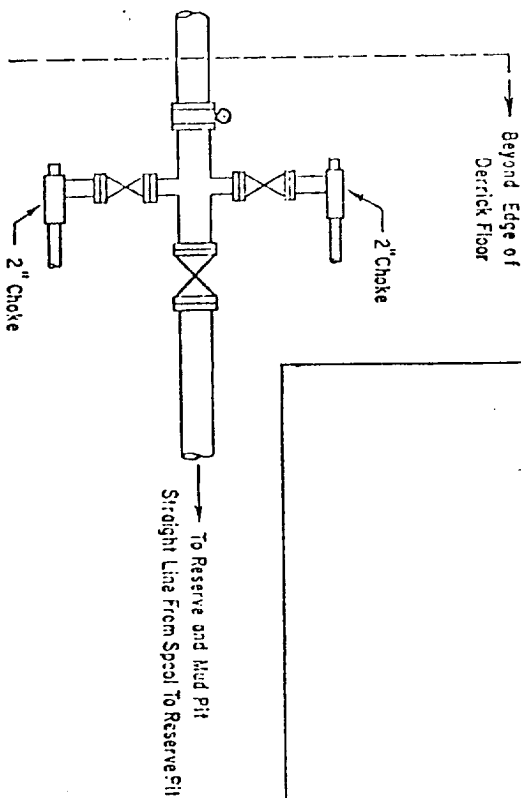

ADDITIONS - DELETIONS - CHANGES
SPECIFY

The blowout preventer assembly shall consist of one blind ram preventer and one pipe ram preventer, both hydraulically operated; a Shafter Tool Works stripper, valves, chokes and connections, as illustrated. If a tapered drill string is used, a ram preventer must be provided for each size of drill pipe. Casing and tubing rams to fit the preventer are to be available as needed. The ram preventers may be two singles or a double type. If correct in size, the flanged outlets of the ram preventer may be used for connecting to the 4-inch I.D. choke flow line and kill line. The substructure height shall be sufficient to install a raising blowout preventer.

Minimum operating equipment for the preventers shall be as follows: (1) Pump (s), driven by a continuous source of power, capable of cycling all the pressure-operated devices simultaneously within _____ seconds. The pump (s) is to be connected to a closed type hydraulic operating system. (2) When requested, accumulators with a precharge of nitrogen of not less than 750 PSI and connected so as to receive a fluid charge from the above pump (s). With the charging pump (s) shut down, the pressurized fluid volume stored in the accumulators must be sufficient to close all the pressure-operated devices simultaneously within _____ seconds; after closure, the remaining accumulator pressure shall be not less than 1000 PSI with the remaining accumulator fluid volume at least _____ percent of the original. (3) When requested, an additional source of power, remote and equivalent, is to be available to operate the above pump (s), or there shall be an additional pump (s) operated by separate power and equal in performance capabilities.

The closing manifold shall have a separate control for each pressure-operated device. Controls are to be labeled, with control handles indicating open and closed positions. A pressure reducer and regulator must be provided if a Hydril preventer is used. Gulf Legion No. 33 hydraulic oil, an equivalent or better, is to be used as the fluid to operate the hydraulic equipment.

The choke manifold, choke flow line, and choke lines are to be supported by metal stands and adequately anchored. The choke flow line and choke lines shall be constructed as straight as possible and without sharp bends. Easy end-of-line access is to be maintained to the choke manifold. All valves are to be selected for operation in the presence of oil, gas and drilling fluids. The choke flow line valve connected to the drilling spool and all ram type preventers must be equipped with stem extensions, universal joints if needed, and hand wheels which are to extend beyond the edge of the derrick substructure. All other valves are to be equipped with handles.

RECEIVED

FEB 16 1983

G.C.D.
HOBBS OFFICE

FEB 14 1983

G.C.D.
HOBBS OFFICE

REVISED
NEW MEXICO OIL CONSERVATION COMMISSION
WELL LOCATION AND ACREAGE DEDICATION PLAT

Form C-102
Supersedes C-128
Effective 1-1-65

All distances must be from the outer boundaries of the Section

Operator GULF OIL CORPORATION			Lease LEA STATE TZ		Well No. 1
Section Letter C	Section 16	Township 19 SOUTH	Range 35 EAST	County LEA	
Actual Well Location of Well:					
660	feet from the NORTH	line and	1980	feet from the WEST	line
Ground Surface Elev. 3811.8	Producing Formation Bone Springs		Pool Scharb Bone Springs	Dedicated Acreage: 80 Acres	

1. Outline the acreage dedicated to the subject well by colored pencil or hachure marks on the plat below.
2. If more than one lease is dedicated to the well, outline each and identify the ownership thereof (both as to working interest and royalty).
3. If more than one lease of different ownership is dedicated to the well, have the interests of all owners been consolidated by communitization, unitization, force-pooling, etc?

☐ Yes ☐ No If answer is "yes," type of consolidation _____

If answer is "no," list the owners and tract descriptions which have actually been consolidated (Use reverse side of this form if necessary.) _____

No allowable will be assigned to the well until all interests have been consolidated (by communitization, unitization, forced-pooling, or otherwise) or until a non-standard unit, eliminating such interests, has been approved by the Commission.

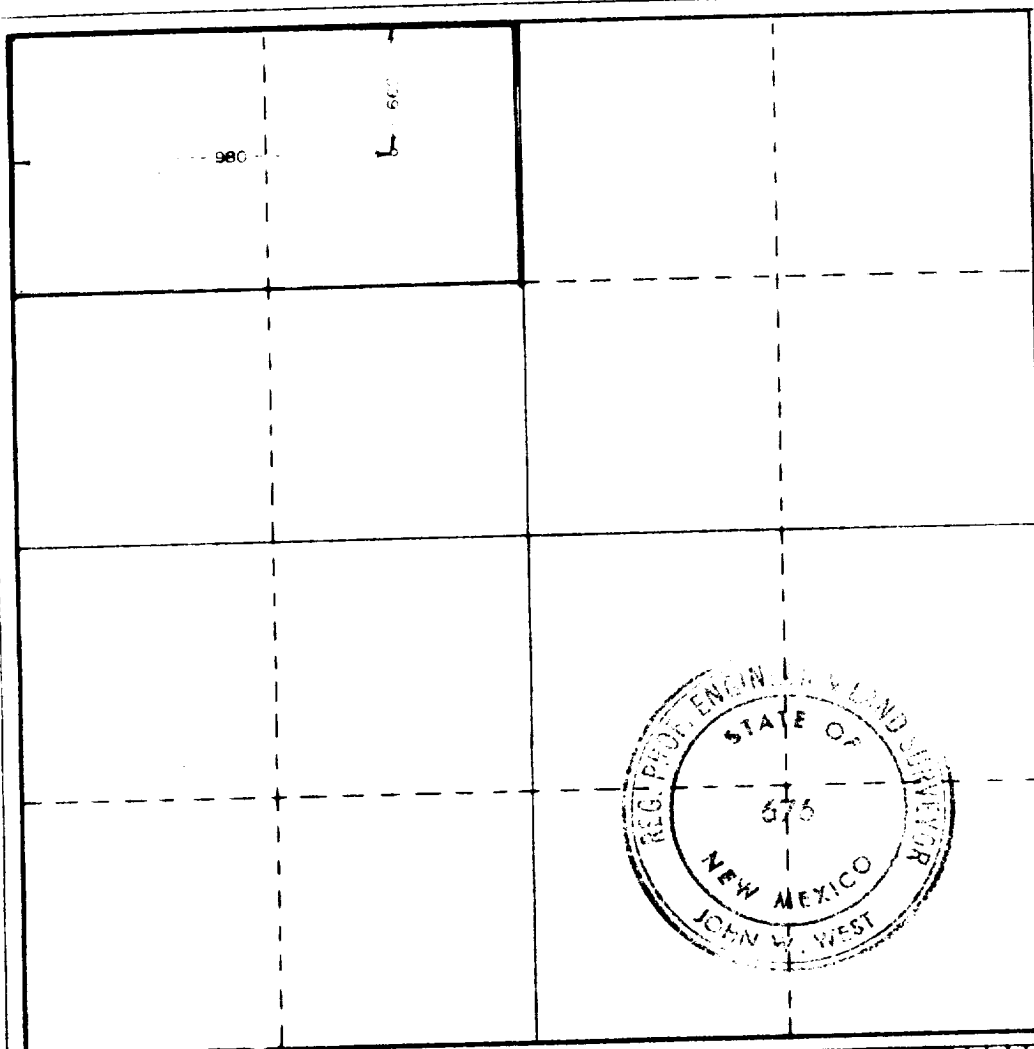

CERTIFICATION

I hereby certify that the information contained herein is true and complete to the best of my knowledge and belief.

R. D. Pitre

Name

R. D. Pitre

Position

Area Engineer

For my

Gulf Oil Corporation

Date

2-15-83

I hereby certify that the well location shown on this plat was plotted from field notes of actual surveys made by me or under my supervision, and that the same is true and correct to the best of my knowledge and belief.

Date Surveyed

2/8/83

Registered Professional Engineer
and/or Land Surveyor

John W. West

Certificate No

JOHN W. WEST NO. 676

330 660 990 1320 1650 1980 2310 2640 2970 3300 3630 3960 4290 4620 4950 5280 5610 5940 6270 6600

RECEIVED

FEB 16 1983

O.C.D.
HOBBS OFFICE

