

STATE OF NEW MEXICO  
ENERGY AND MINERALS DEPARTMENT

OIL CONSERVATION DIVISION  
P. O. BOX 2088  
SANTA FE, NEW MEXICO 87501

Form C-101  
Revised 10-1-78

NO. OF COPIES RECEIVED	
DISTRIBUTION	
SANTA FE	
FILE	
U.S.G.S.	
LAND OFFICE	
OPERATOR	

5A. Indicate Type of Lease  
STATE ☒ FEE ☐

5. State Oil & Gas Lease No.

B-4120-1

APPLICATION FOR PERMIT TO DRILL, DEEPEN, OR PLUG BACK

1a. Type of Work <u>Re-Entry</u>		7. Unit Agreement Name	
b. Type of Well OIL WELL <input checked="" type="checkbox"/> GAS WELL <input type="checkbox"/> OTHER <input type="checkbox"/> DEEPEN <input type="checkbox"/> PLUG BACK <input type="checkbox"/>		8. Farm or Lease Name West Lovington Unit	
2. Name of Operator Texaco Producing Inc.		9. Well No. 64	
3. Address of Operator P. O. Box 728, Hobbs, New Mexico 88240		10. Field and Pool, or Wildcat Lovington San Andres W	
4. Location of Well UNIT LETTER <u>E</u> LOCATED <u>2080</u> FEET FROM THE <u>North</u> LINE AND <u>989</u> FEET FROM THE <u>West</u> LINE OF SEC. <u>8</u> TWP. <u>17-S</u> RGE. <u>36-E</u> NMPM		12. County Lea	
11. Elevations (Show whether DF, RT, etc.) 3895 GR		19. Proposed Depth 5190' PBTD	19A. Formation San Andres
21A. Kind & Status Plug. Bond Blanket	21B. Drilling Contractor	20. Rotary or C.T. Pulling Unit	
22. Approx. Date Work will start April 25, 1988			

PROPOSED CASING AND CEMENT PROGRAM

SIZE OF HOLE	SIZE OF CASING	WEIGHT PER FOOT	SETTING DEPTH	SACKS OF CEMENT	EST. TOP
24"	20"	94#	310'	700	Circulated
17-1/4"	13-3/8"	54.5# & 48#	1950'	2200	Circulated
12-1/4"	8-5/8"	32# & 24#	5200'	2050	1300' (T.S.)

This well was drilled in 1983 as N.M. "AH" State Well No. 13 to test the Abo Drinkard and Glorieta formations. It was plugged when no commercial quantities of oil or gas were found.

1. MIRU. Install BOP.
2. GIH w/7-7/8" bit. Drill out cement plugs at Surface-63', 1783'-1943', 4449'-4619', 5110'-5160', and CIBP @ 5160'.
3. GIH w/CIBP and set at + 5190'. Test casing to 500#.
4. Perf San Andres w/1 JSPI: 5108-14, 24-29, 34-52, 58-62, 73-75'. (40 Holes).
5. GIH w/packer and set at + 5000'. Load backside to 500#.
6. Acidize perfs 5108-5175' w/4000 gallons 15% NEFE.
7. Flow back load.
8. Run production equipment.
9. Pump until good test is obtained.
10. MIRU. Pull production equipment.

Continued on reverse side.

IN ABOVE SPACE DESCRIBE PROPOSED PROGRAM; IF PROPOSAL IS TO DEEPEN OR PLUG BACK, GIVE DATA ON PRESENT PRODUCTIVE ZONE AND PROPOSED NEW PRODUCTIVE ZONE. GIVE BLOWOUT PREVENTER PROGRAM, IF ANY.

I hereby certify that the information above is true and complete to the best of my knowledge and belief.

J. A. Schaffer

Signed J. A. Schaffer Title District Operations Manager Date 4/04/88

(This space for State Use)

Orig. Signed by  
Paul Kautz  
Geologist

APPROVED BY \_\_\_\_\_ TITLE \_\_\_\_\_

CONDITIONS OF APPROVAL, IF ANY:

APR 7 1988

Permit Expires 6 Months From Approval  
Date Unless Drilling Underway.  
workover

Continued from reverse side.

11. GIH w/CIBP. Set at 5080'. Test to 500#.
12. Perf San Andres w/1 JSPF: 4730, 33, 37, 40, 45, 47, 49, 52, 55, 57, 60, 62, 64, 70, 73, 78, 82, 86, 90, 96, 98, 4800, 02, 04, 06, 03, 10, 13, 18, 23, 27, 32, 40, 42, 52, 54, 74, 76, 99, 4903, 06, 15, 17, 29, 33, 38, 63, 79, 81, 87, 90, 95, 97, 5005, 07, 09, 11, 17, 27. (58 holes).
13. GIH w/packer to  $\pm$  4630' and set. Load backside to 500#.
14. Acidize perfs 4730-5027' w/6000 gallons 15% NEFE acid.
15. Repeat steps 7-10.
16. GIH w/7-7/8" bit. Drill out CIBP @ 5080'.
17. Run production equipment.
18. Return to production and obtain test from all perfs.

APR 6 1988  
OCD  
HOBBS OFFICE

RECEIVED

**NEW MEXICO OIL CONSERVATION COMMISSION  
WELL LOCATION AND ACREAGE DEDICATION PLAT**

Form C-102  
Supersedes C-128  
Effective 1-1-65

All distances must be from the outer boundaries of the Section.

Operator <b>Texaco Producing Inc.</b>			Lease <b>West Lovington Unit</b>		Well No. <b>64</b>
Unit Letter <b>E</b>	Section <b>8</b>	Township <b>17 South</b>	Range <b>36 East</b>	County <b>Lea</b>	
Actual Footage Location of Well: <b>2080</b> feet from the <b>North</b> line and <b>989</b> feet from the <b>West</b> line <b>Sec. 8</b>					
Ground Level Elev. <b>3895</b>	Producing Formation <b>San Andres</b>	Pool <b>Lovington San Andres, West</b>		Dedicated Acreage; <b>40</b> Acres	

1. Outline the acreage dedicated to the subject well by colored pencil or hachure marks on the plat below.
2. If more than one lease is dedicated to the well, outline each and identify the ownership thereof (both as to working interest and royalty).
3. If more than one lease of different ownership is dedicated to the well, have the interests of all owners been consolidated by communitization, unitization, force-pooling, etc?

☐ Yes    ☐ No    If answer is "yes," type of consolidation \_\_\_\_\_

If answer is "no," list the owners and tract descriptions which have actually been consolidated. (Use reverse side of this form if necessary.) \_\_\_\_\_

No allowable will be assigned to the well until all interests have been consolidated (by communitization, unitization, forced-pooling, or otherwise) or until a non-standard unit, eliminating such interests, has been approved by the Commission.

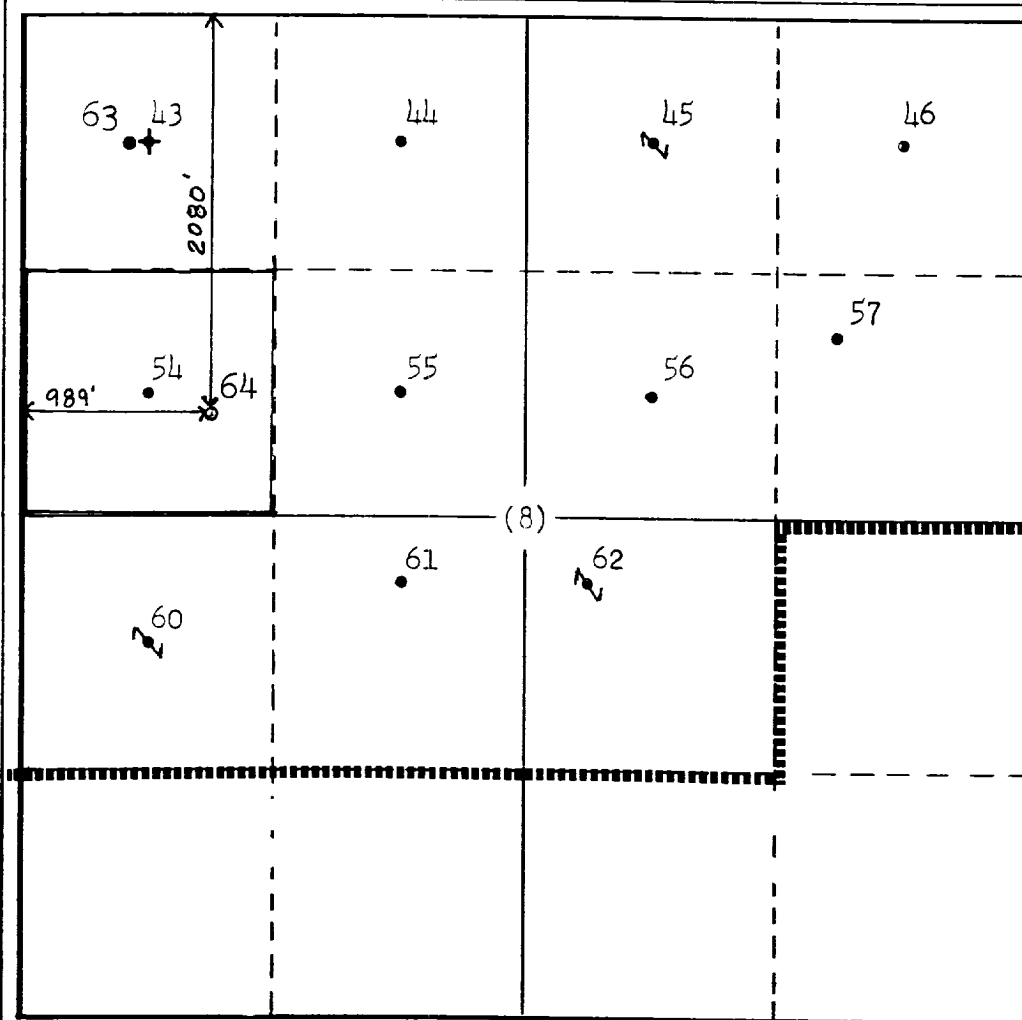

**CERTIFICATION**

*I hereby certify that the information contained herein is true and complete to the best of my knowledge and belief.*

*J. A. Schaffer*  
Name

**J. A. Schaffer**

Position

**Dist. Opr. Mgr.**

Company

**Texaco Producing Inc.**

Date

**April 4, 1988**

*I hereby certify that the well location shown on this plat was plotted from field notes of actual surveys made by me or under my supervision, and that the same is true and correct to the best of my knowledge and belief.*

Date Surveyed

Registered Professional Engineer  
and/or Land Surveyor

Certificate No.