

NO. OF COPIES RECEIVED
DISTRIBUTION
SANTA FE
FILE
U.S.G.S.
LAND OFFICE
OPERATOR

NEW MEXICO OIL CONSERVATION COMMISSION

Texaco Lse # 62721

Form O-101
Revised 1-1-65

5A. Indicate Type of Lease	STATE <input checked="" type="checkbox"/>	FEE <input type="checkbox"/>
5. State Oil & Gas Lease No.		
B-4120-1		

APPLICATION FOR PERMIT TO DRILL, DEEPEN, OR PLUG BACK

1a. Type of Work				7. Unit Agreement Name	
b. Type of Well DRILL <input checked="" type="checkbox"/> DEEPEN <input type="checkbox"/> PLUG BACK <input type="checkbox"/> OIL WELL <input checked="" type="checkbox"/> GAS WELL <input type="checkbox"/> OTHER <input type="checkbox"/> SINGLE ZONE <input type="checkbox"/> MULTIPLE ZONE <input checked="" type="checkbox"/>				8. Firm or Lease Name	
2. Name of Operator				9. Well No.	
Texaco Inc.				13	
3. Address of Operator				10. Field and Pool, or Wildcat	
Box 3109, Midland, Texas				Wildcat	
4. Location of Well				12. County	
UNIT LETTER E LOCATED 2080 FEET FROM THE North LINE				Lea	
AND 989 FEET FROM THE West LINE OF SEC. 8 T40N 17 S R36E					
19. Proposed Depth				18A. Formation	
9000				Glorieta, Tubb, Drinkard, Abo	
21. Elevations (Show whether DE, RL, etc.)				20. Rotary or C.T.	
3896' GR				Rotary	
21A. Kind & Status Plug. Bond				22. Approx. Date Work will start	
				May 1, 1983	

PROPOSED CASING AND CEMENT PROGRAM

SIZE OF HOLE	SIZE OF CASING	WEIGHT PER FOOT	SETTING DEPTH	SACKS OF CEMENT	EST. TOP
20"	16"	65#, H-40	300'	500	Circulate
15"	13 3/8"	48#, H-40	1950'	1100	Circulate
12 1/4"	8 5/8"	54.5#, K-55	5150'	2100	Circulate
		24#, K-55			
		32#, K-55			
		32#, S-80			
7 7/8"	5 1/2"	15.5#, K-55	9000'	1550	Circulate
		17#, K-55			
		17#, N-80			

Surface Casing: 500 sxs Class "H" w/2% CaCl₂ (15.6 ppg, 1.18 ft³/sx).

1ST INTERMEDIATE CASING: 900 sxs Class "H" w/4% gel (14.7 ppg, 1.38 ft³/sx) followed by 200 sxs Class "H" w/2% CaCl₂ (15.6 ppg, 1.18 ft³/sx).

2ND INTERMEDIATE CASING: 1st Stage: 400 sxs HLW w/5# gilsonite & 8# salt/sx (12.4 ppg, 2.01 ft³/sx) followed by 1000 sxs Class "H" w/8# salt/sx (15.9 ppg, 1.22 ft³/sx). DV Tool @ 2900' 2nd Stage 500 sxs HLW w/8# salt/sx (15.9 ppg, 1.22 ft³/sx) followed w/200 sxs Class "H" (15.6 ppg, 1.18 ft³/sx)

Continued page 2

IN ABOVE SPACE DESCRIBE PROPOSED PROGRAM: IF PROPOSED IS TO DEEPEN OR PLUG BACK, GIVE DATA ON PRESENT PRODUCTIVE ZONE AND PROPOSED NEW PRODUCTIVE ZONE. GIVE BLOWOUT PREVENTER PROGRAM, IF ANY.

I hereby certify that the information above is true and complete to the best of my knowledge and belief.

Signed R. S. Lane Asst. Petr. Engr. Manager Date April 19, 1983

R. S. Lane
(This Space for State Use)

APPROVED BY ORIGINAL SIGNED BY JERRY SEXTON TITLE DISTRICT SUPERVISOR

DATE APR 25 1983

CONDITIONS OF APPROVAL, IF ANY:

Page 2

Production Casing: 1st Stage: 350 sxs HLW w/5# gilsonite & 1/4# flocele/sx (12.4 ppg, 200 ft³/sx) followed by 200 sxs Class "H" w/1/4# flocele/sx (15.6 ppg, 1.18 ft³/sx) DV Tool @ 7000'. 2nd Stage: 800 sxs HLW w/5# gilsonite & 1/4# flocele/sx (12.4 ppg, 200 ft³/sx) followed by 200 sxs Class "H" (15.6 ppg, 1.18 ft³/sx).

**NEW MEXICO OIL CONSERVATION COMMISSION
WELL LOCATION AND ACREAGE DEDICATION PLAT**

Form C-102
Supersedes C-128
Effective 1-1-65

All distances must be from the outer boundaries of the Section.

Operator Texaco Inc.			Lease New Mexico "AH" State		Well No. 13
Unit Letter E	Section 8	Township 17-S	Range 36 E	County Lea	
Actual Footage Location of Well: 989 feet from the West line and 2080 feet from the North line					
Ground Level Elev. 3896'	Producing Formation Abo & Glorieta, Tubb, Drinkard			Pool Wildcat	Dedicated Acreage: 40 Acres

1. Outline the acreage dedicated to the subject well by colored pencil or hachure marks on the plat below.
2. If more than one lease is dedicated to the well, outline each and identify the ownership thereof (both as to working interest and royalty).
3. If more than one lease of different ownership is dedicated to the well, have the interests of all owners been consolidated by communitization, unitization, force-pooling, etc?

☐ Yes ☐ No If answer is "yes," type of consolidation _____

If answer is "no," list the owners and tract descriptions which have actually been consolidated. (Use reverse side of this form if necessary.) _____

No allowable will be assigned to the well until all interests have been consolidated (by communitization, unitization, forced-pooling, or otherwise) or until a non-standard unit, eliminating such interests, has been approved by the Commission.

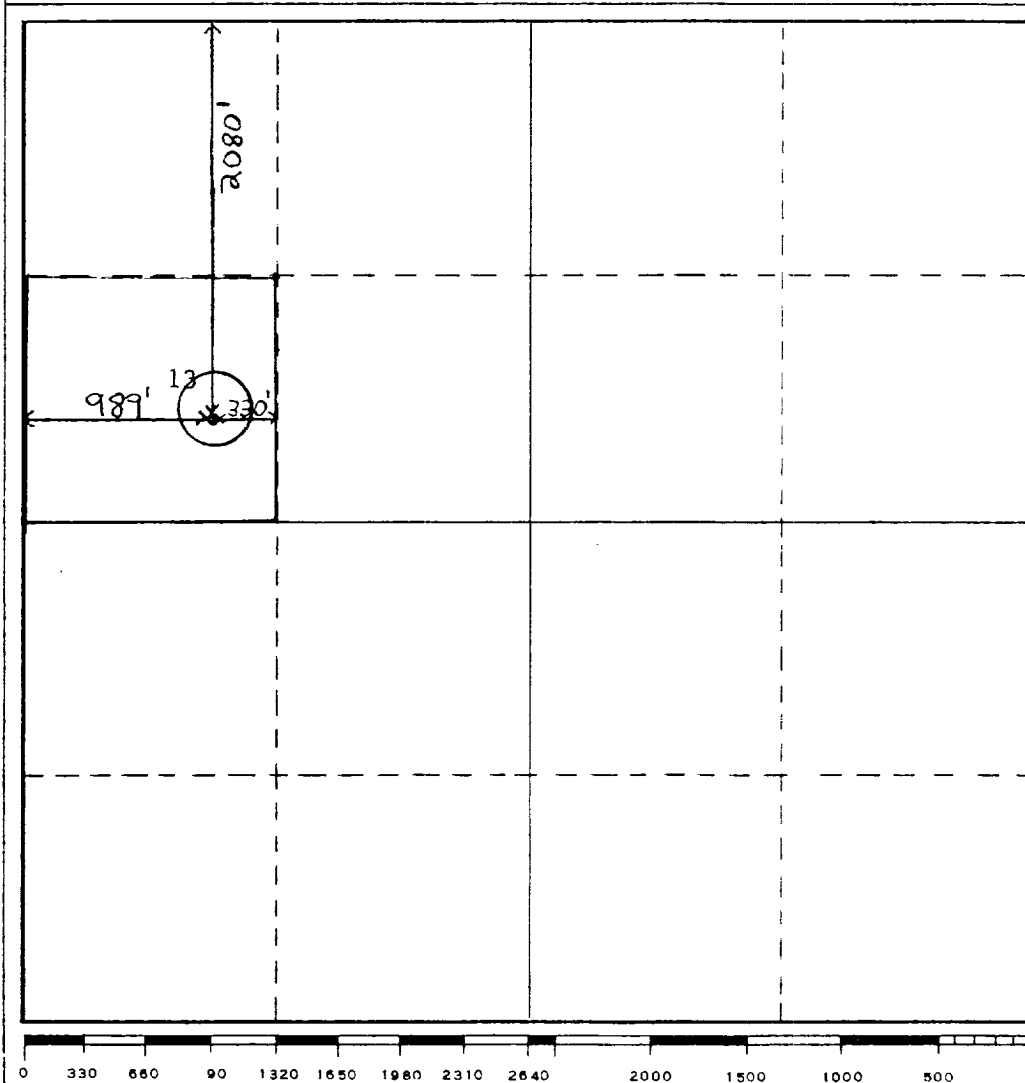

CERTIFICATION

I hereby certify that the information contained herein is true and complete to the best of my knowledge and belief.

B. L. Eiland
Name

B. L. Eiland

Position

Division Surveyor

Company

Texaco Inc.

Date

April 19, 1983

I hereby certify that the well location shown on this plat was plotted from field notes of actual surveys made by me or under my supervision, and that the same is true and correct to the best of my knowledge and belief.

Date Surveyed

April 19, 1983

Registered Professional Engineer
and/or Land Surveyor

B. L. Eiland
B. L. Eiland

Certificate No.

4386

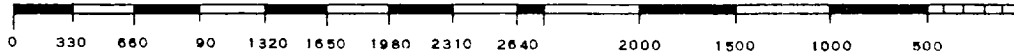

DRILLING CONTROL CONDITION II-3000 PSI WP

H₂S TRIM REQUIRED
YES _____ NO _____

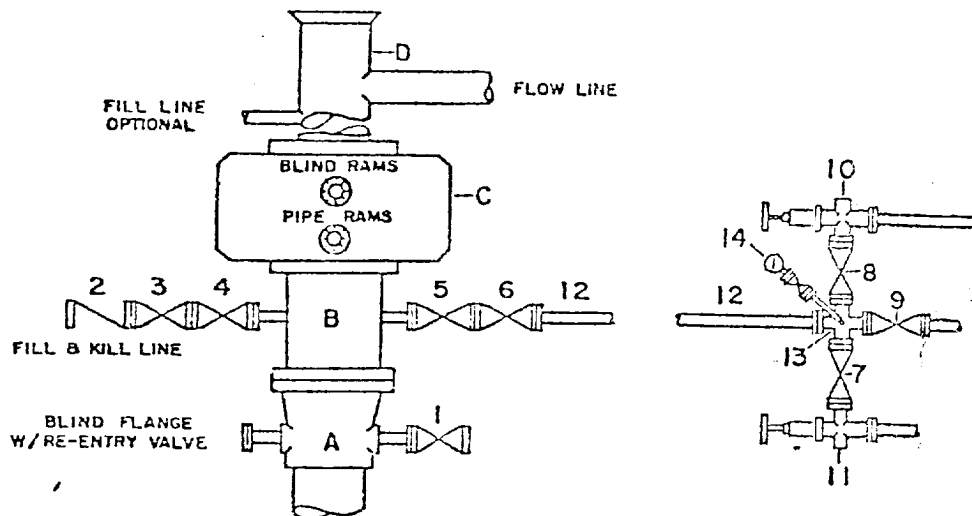

DRILLING CONTROL

MATERIAL LIST - CONDITION II

- | | |
|-----------|---|
| A | Texaco Wellhead |
| B | 3000# W.P. drilling spool with a 2" minimum flanged outlet for kill-line and 3" minimum flanged outlet for choke line |
| C | 3000# W.P. Dual ram type preventer, hydraulic operated with 1" steel, 3000# W.P. control lines (where sub-structure height is adequate, 2-3000# W.P. single ram type preventers may be utilized.) |
| D | Bell nipple with flowline and fill-up outlets. (Kill line may also be used for fill-up line.) |
| 1,3,4,7,8 | 2" minimum 3000# W.P. flanged full opening steel gate valve, or Halliburton Lo Torc Plug valve. |
| 2 | 2" minimum 3000# W.P. back pressure valve |
| 5,6,9 | 3" minimum 3000# W.P. flanged full opening steel gate valve, or Halliburton Lo Torc Plug valve. |
| 12 | 3" minimum schedule 80, Grade "B", seamless line pipe |
| 13 | 2" minimum x 3" minimum 3000# W.P. flanged cross |
| 10, 11 | 2" minimum 3000# W.P. adjustable choke bodies |
| 14 | Cameron Mud Gauge or equivalent (location optional in choke line.) |

SCALE	DATE	EST NO	DRG NO
DRAWN BY			
CHECKED BY			
APPROVED BY			



TEXACO, INC
PRODUCING DEPARTMENT US
MIDLAND, TEXAS



EXHIBIT B

RECEIVED
APR 22 1983
O.C.D.
HOBBY OFFICE

