

NEW MEXICO OIL CONSERVATION COMMISSION
WELL LOCATION AND ACREAGE DEDICATION PLAT

Form O-1-1
Supersedes O-1-8
Effective 1-1-85

All distances must be from the outer boundaries of the Section

Operator POE PROPERTIES INC.			Lessee SPRINKLE FED.			Well No. 1		
Range H	Section 9	Township 19S	Range 35E	County LEA				
Actual Surface Location of Well: 2063 feet from the NORTH line and 841 feet from the EAST line								
Ground Level Elev. 3824.7		Producing Formation Bone Springs		Pool Scharb--Bone Springs			Dedicated Acreage: 80 Acres	

1. Outline the acreage dedicated to the subject well by colored pencil or hatchure marks on the plat below.
2. If more than one lease is dedicated to the well, outline each and identify the ownership thereof (both as to working interest and royalty). Federal Oil & Gas Lease NM-24166 is only lease involved.
3. If more than one lease of different ownership is dedicated to the well, have the interests of all owners been consolidated by communitization, unitization, force-pooling, etc?

☒ Yes ☐ No If answer is "yes," type of consolidation _____

If answer is "no," list the owners and tract descriptions which have actually been consolidated. (Use reverse side of this form if necessary.) _____

No allowable will be assigned to the well until all interests have been consolidated (by communitization, unitization, forced-pooling, or otherwise) or until a non-standard unit, eliminating such interests, has been approved by the Commission.

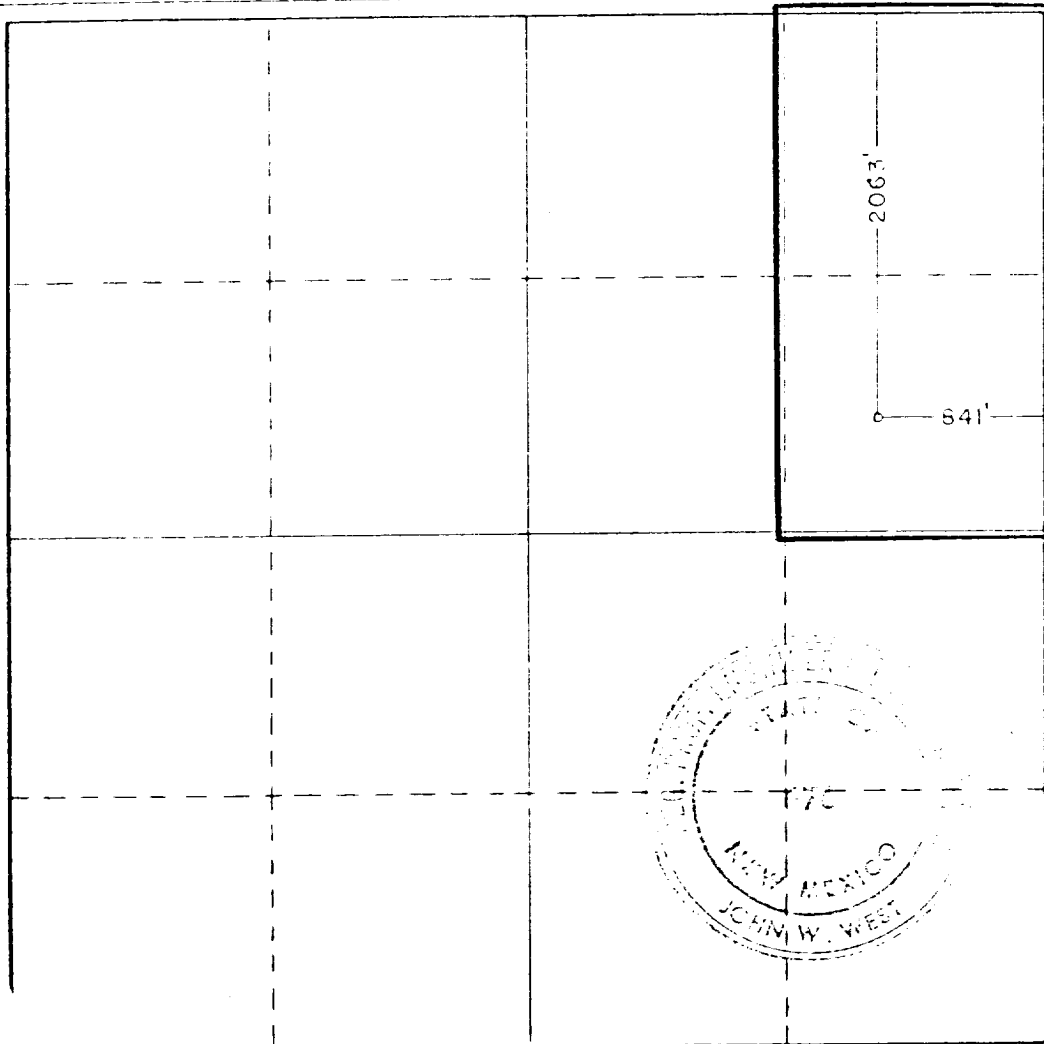

CERTIFICATION

I hereby certify that the information contained herein is true and complete to the best of my knowledge and belief.

James A. Knauf

James A. Knauf
Agent

Operator
POE PROPERTIES INC.

Date
April 28, 1983

I hereby certify that the well location shown on this plat was plotted from field notes of actual surveys made by me or under my supervision, and that the same is true and correct to the best of my knowledge and belief.

Date Surveyed
4/27/83

Registered Professional Engineer
and/or Land Surveyor

John W. West

Certificate No.
JOHN WEST N.M. #676

130 660 190 1320 1650 1980 2310 2640 2000 1800 1000 800 0