

NO. OF COPIES RECEIVED	
DISTRIBUTION	
SANTA FE	
FILE	
U.S.G.S.	
LAND OFFICE	
OPERATOR	

5A. Indicate Type of Lease  
STATE ☒ FEE ☐  
5. State Oil & Gas Lease No.  
E-8712

APPLICATION FOR PERMIT TO DRILL, DEEPEN, OR PLUG BACK

a. Type of Work

DRILL ☒

DEEPEN ☐

PLUG BACK ☐

b. Type of Well

OIL WELL ☒

CAS WELL ☐

OTHER

SINGLE ZONE ☐

MULTIPLE ZONE ☐

Name of Operator

CASA PETROLEUM, INCORPORATED

Address of Operator

105 N. 6 Th. Street, Artesia, New Mexico 88210

Location of Well

UNIT LETTER J

LOCATED 1815

FEET FROM THE South

LINE

ND 2310

FEET FROM THE East

LINE OF SEC. 28

TWP. 17

RCC. 34

NMPM

7. Unit Agreement Name

8. Farm or Lease Name

Casa State

9. Well No.

3

10. Field and Pool, or Wildcat  
Vacuum Grayburg  
San Andres

11. County

LEA

19. Proposed Depth

5200

19A. Formation

San Andres

20. Rotary or C.T.

Rotary

1. Elevations (show whether DF, RT, etc.)

4052. 2

21A. Kind & Status Plug. Bond

Single Well

21B. Drilling Contractor

Salazar Bros.

22. Approx. Date Work will start

June 15, 1983

3.

PROPOSED CASING AND CEMENT PROGRAM

SIZE OF HOLE	SIZE OF CASING	WEIGHT PER FOOT	SETTING DEPTH	SACKS OF CEMENT	EST. TOP
12 1/4	8 5/8	24#	1500	850	
7 7/8	4 1/2	10.5 #	4900	380	

dig up, Drill 12 1/2" Hole to depth of 1500'.

Run 1500' of 8 5/8" Casing

Cement w/850 sx and circulate cmt to Surface WOE 18 Hours

Test Casing to 1000# for 30 minutes, if satisfactory Drill to T.D.

Run 5200' of 4 1/2 Casing, Cement w/380 sx.

Perforating and Treating to be based on Log Evaluation.

APPROVAL VALID FOR 180 DAYS  
PERMIT EXPIRES 12/16/83  
UNLESS DRILLING UNDERWAY

ABOVE SPACE DESCRIBE PROPOSED PROGRAM; IF PROPOSAL IS TO DEEPEN OR PLUG BACK, GIVE DATA ON PREVIOUS PRODUCTIVE ZONE AND PROPOSED NEW PRODUCTIVE ZONE. GIVE BLOWOUT PREVENTER PROGRAM, IF ANY.

I hereby certify that the information above is true and complete to the best of my knowledge and belief.

Signed Jerry Sexton Title Ranger G. Karr, President

Date 6/13/83

(This space for State Use)

ORIGINAL SIGNED BY JERRY SEXTON

APPROVED BY DISTRICT 1 SUPERVISOR TITLE

DATE JUN 16 1983

CONDITIONS OF APPROVAL, IF ANY:

RECEIVED  
JUN 15 1983  
O.C.D.  
HOBBS OFFICE

NEW MEXICO OIL CONSERVATION COMMISSION  
WELL LOCATION AND ACREAGE DEDICATION PLAT

Form C-102  
Supersedes C-128  
Effective 1-1-85

All distances must be from the outer boundaries of the Section

Operator <b>Casa Petroleum, Inc.</b>		Lease <b>Casa State</b>		Well No. <b>3</b>
Unit Letter <b>J</b>	Section <b>28</b>	Township <b>17 South</b>	Range <b>34 East</b>	County <b>Lea County</b>

Actual Footage Location of Well:

**1815** feet from the **South** line and **2310** feet from the **East** line

Ground Level Elev. <b>4052.2</b>	Producing Formation <b>San Andres</b>	Pool <b>Vacuum Gray, Sa</b>	Dedicated Acreage: <b>40</b> Acres
-------------------------------------	--	--------------------------------	---------------------------------------

1. Outline the acreage dedicated to the subject well by colored pencil or hatchure marks on the plat below.
2. If more than one lease is dedicated to the well, outline each and identify the ownership thereof (both as to working interest and royalty).
3. If more than one lease of different ownership is dedicated to the well, have the interests of all owners been consolidated by communitization, unitization, force-pooling, etc?

☐ Yes ☐ No If answer is "yes," type of consolidation \_\_\_\_\_

If answer is "no," list the owners and tract descriptions which have actually been consolidated. (Use reverse side of this form if necessary.) \_\_\_\_\_

No allowable will be assigned to the well until all interests have been consolidated (by communitization, unitization, forced-pooling, or otherwise) or until a non-standard unit, eliminating such interests, has been approved by the Commission.

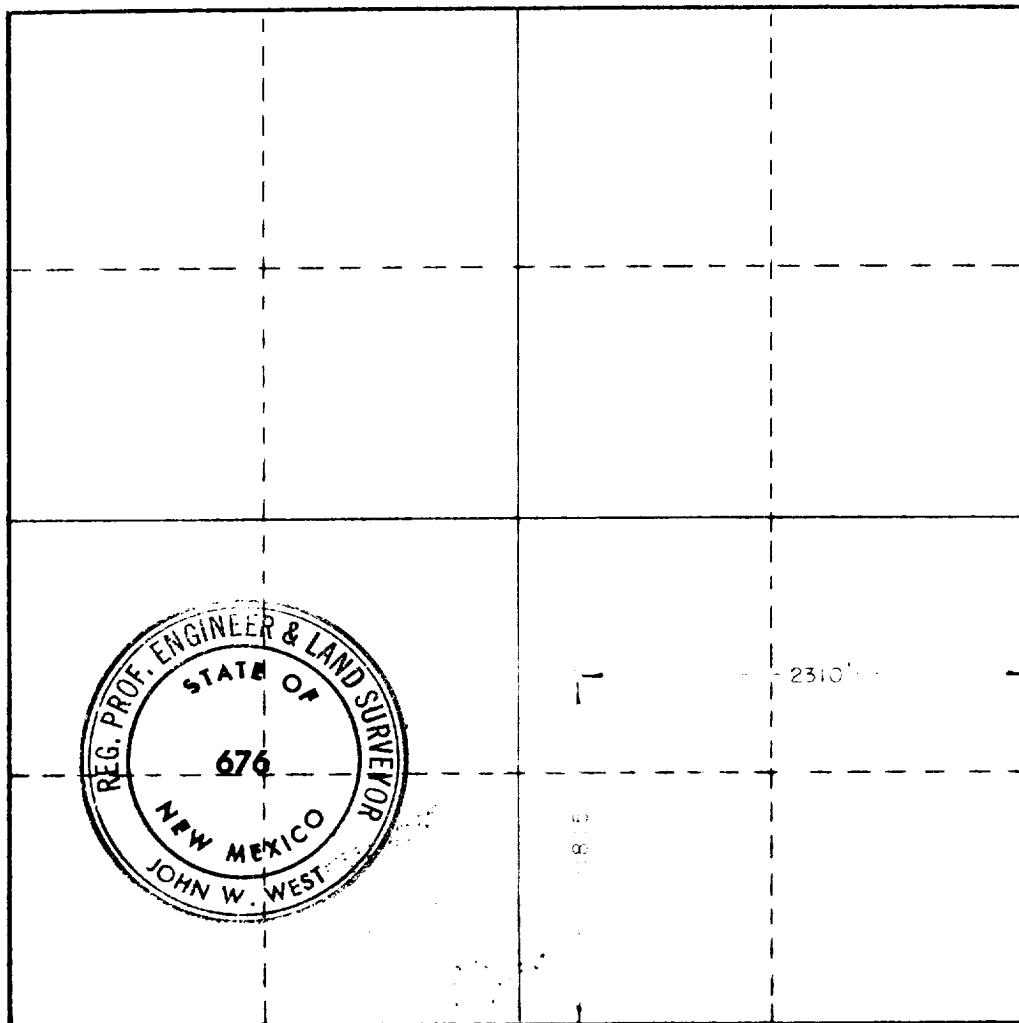

CERTIFICATION

I hereby certify that the information contained herein is true and complete to the best of my knowledge and belief.

*Kangas CK*  
Name

Position  
President

Company  
Casa Petroleum, Inc.

Date  
6/13/83

I hereby certify that the well location shown on this plat was plotted from field notes of actual surveys made by me or under my supervision, and that the same is true and correct to the best of my knowledge and belief.

Date Surveyed  
June 10, 1983

Registered Professional Engineer  
and/or Land Surveyor

*John W. West*  
Certificate No.

JOHN W. WEST NO. 676

0 330 660 990 1320 1650 1980 2310 2640 2970 3300 3630 3960 4290 4620 4950 5280 5610 5940 6270 6600

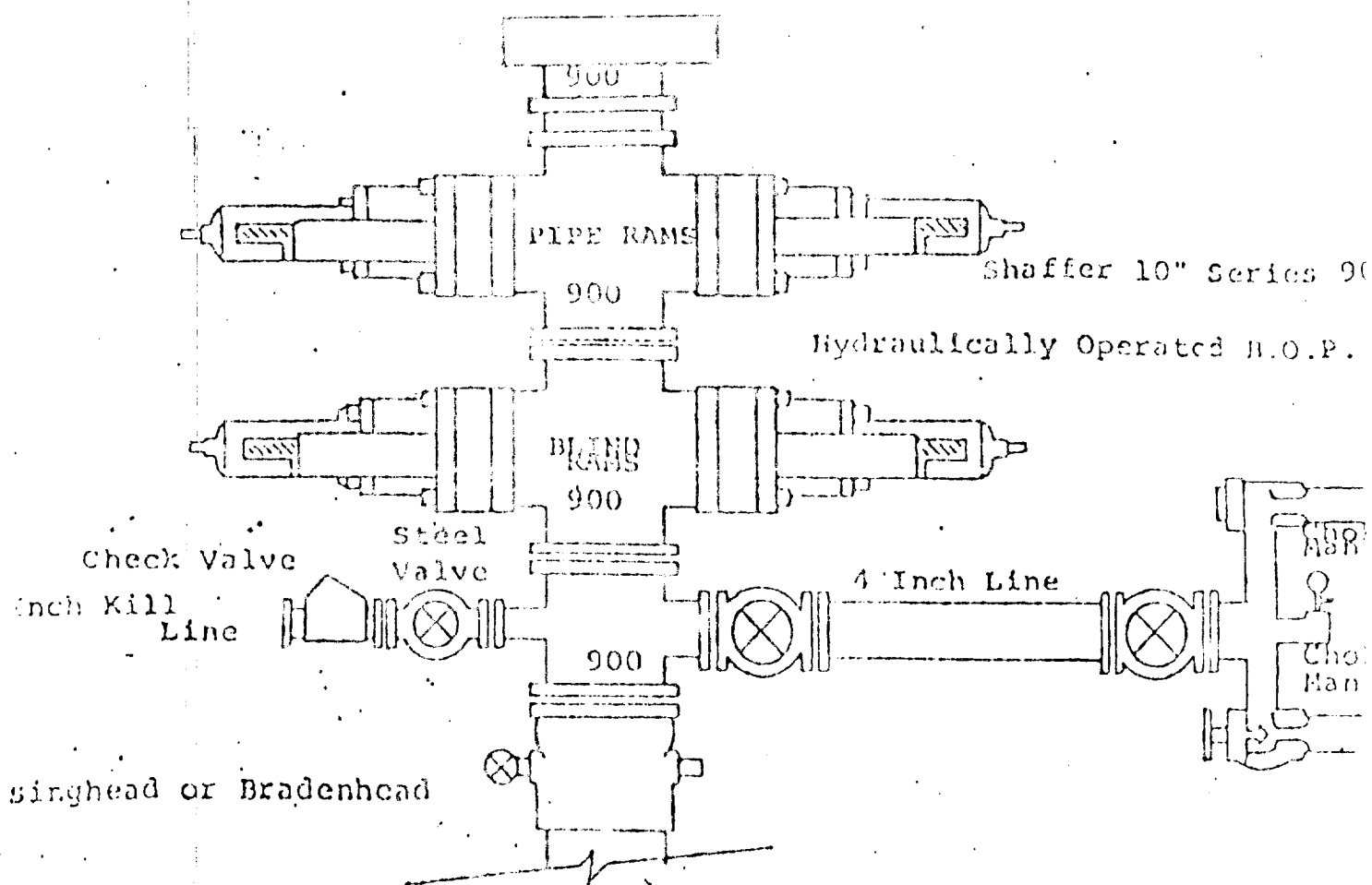

# FOLLOWING CONSTITUTE MINIMUM BLOWOUT PREVENTER REQUIREMENTS

- All preventers to be hydraulically operated with secondary manual control installed prior to drilling out from under casing.
- Choke outlet to be a minimum of 4" diameter.
- Kill line to be of all steel construction of 2" minimum diameter.
- All connections from operating manifolds to preventers to be all steel hole or tube a minimum of one inch in diameter.
- The available closing pressure shall be at least 15% in excess of the required with sufficient volume to operate the B.O.P.'s.
- All connections to and from preventer to have a pressure rating equivalent to that of the B.O.P.'s.
- Inside blowout preventer to be available on rig floor.
- Operating controls located a safe distance from the rig floor.
- Hole must be kept filled on trips below intermediate casing. Operator not responsible for blowouts resulting from not keeping hole full.
- B. P. float must be installed and used below zone of first gas intrusion.

RECEIVED  
JUN 15 1983  
C.C.D.  
HOBBS OFFICE