

NO. OF COPIES RECEIVED	
DISTRIBUTION	
SANTA FE	
FILE	
U.S.G.S.	
LAND OFFICE	
OPERATOR	

5A. Indicate Type of Lease
STATE ☒ FEDERAL ☐
5. State Oil & Gas Lease No.
LG-740

APPLICATION FOR PERMIT TO DRILL, DEEPEN, OR PLUG BACK

1A. Type of Work DRILL <input checked="" type="checkbox"/> DEEPEN <input type="checkbox"/> PLUG BACK <input type="checkbox"/>		7. Unit Agreement Name
6. Type of Well OIL WELL <input checked="" type="checkbox"/> GAS WELL <input type="checkbox"/> OTHER <input type="checkbox"/> SINGLE ZONE <input checked="" type="checkbox"/> MULTIPLE ZONE <input type="checkbox"/>		8. Farm or Lease Name Vacuum State
2. Name of Operator Mesa Petroleum Co.		9. Well No. 5
3. Address of Operator P.O. Box 2009 / Amarillo, Texas 79189		10. Field and Pool, or Wildcat Undes. Scharb-Wolfcamp
4. Location of Well UNIT LETTER <u>XC</u> LOCATED <u>1980</u> FEET FROM THE <u>North</u> LINE AND <u>660</u> FEET FROM THE <u>West</u> LINE OF SEC. <u>3</u> TWP. <u>19S</u> RGE. <u>35E</u> NMDP		12. County Lea
19. Proposed Depth 11,000'		19A. Formation Wolfcamp
20. Rotary or C.T. Rotary		
21. Elevation of Base Whether D.T., H.T., etc. 3885.9' GR	21A. Kind & Status Plug. Bond Blanket	21B. Drilling Contractor Dual Drilling
22. Approx. Date Work will start August 10, 1983		

PROPOSED CASING AND CEMENT PROGRAM

SIZE OF HOLE	SIZE OF CASING	WEIGHT PER FOOT	SETTING DEPTH	SACKS OF CEMENT	EST. TOP
17 1/2"	13 3/8"	48#	500'	300	Surface
11"	8 5/8"	24#	4000'	1000/250	Tieback to 13 3/8"
7 7/8"	5 1/2"	17#	11000'	550/650	Cover all pay

Propose to drill 17 1/2" hole to 500' and set 13 3/8" surface casing and cement to surface. Will then reduce hole to 11", nipple up 3000 psi BOPs and drill to 4000' to set intermediate string of 8 5/8" casing and cement to surface or tie back to 13 3/8" casing. Will then drill 7 7/8" hole to TD of 11,000'.

Operator's gas sales are dedicated.

APPROVAL VALID FOR 180 DAYS
PERMIT EXPIRES 3/8/84
UNLESS DRILLING UNDERWAY

XC: NMOCD-H (O+5), CEN RCDS, ACTG, MIDLAND, ROSWELL, MAT CONT, OPS(FILE), PARTNERS, WOOTTEN

IN ABOVE SPACE DESCRIBE PROPOSED PROGRAM; IF PROPOSAL IS TO DEEPEN OR PLUG BACK, GIVE DATA ON PRESENT PRODUCTIVE ZONE AND PROPOSED NEW PRODUCTIVE ZONE. GIVE BLOWOUT PREVENTER PROGRAM, IF ANY.

I hereby certify that the information above is true and complete to the best of my knowledge and belief.

Signed R.P. Mathis Title Regulatory Coordinator Date 8-5-83

(This space for State Use)

ORIGINAL SIGNED BY JERRY SEXTON

DISTRICT 1 SUPERVISOR

APPROVED BY _____ TITLE _____ DATE _____

CONDITIONS OF APPROVAL, IF ANY:

AUG 8 1983

RECEIVED
AUG 8 1993
O.C.D.
HOBBE OFFICE

**MEXICO OIL CONSERVATION COMMISSION
WELL LOCATION AND ACREAGE DEDICATION PLAT**

Form C-102
Supersedes C-128
Effective 1-1-65

All distances must be from the outer boundaries of the Section

MESA PETROLEUM CO.			Lease VACUUM STATE		Well No. 5
E	3	Township 19 SOUTH	Range 35 EAST	County LEA	
Section 1980		Line and 660		Feet from the WEST	
Well Elev. 3885.9	Production Formation Wolfcamp	Pool Undes. Scharb-Wolfcamp		Estimated Acreage 40 Acres	

1. Outline the acreage dedicated to the subject well by colored pencil or hachure marks on the plat below.
2. If more than one lease is dedicated to the well, outline each and identify the ownership thereof (both as to working interest and royalty).
3. If more than one lease of different ownership is dedicated to the well, have the interests of all owners been consolidated by communitization, unitization, force-pooling, etc?

Yes ☐ No ☐ If answer is "yes," type of consolidation _____

If answer is "no" list the owners and tract descriptions which have actually been consolidated. (Use reverse side of this form if necessary.) _____

No allowable will be assigned to the well until all interests have been consolidated (by communitization, unitization, force-pooling, or otherwise) or until a non-standard unit, eliminating such interests, has been approved by the Commission.

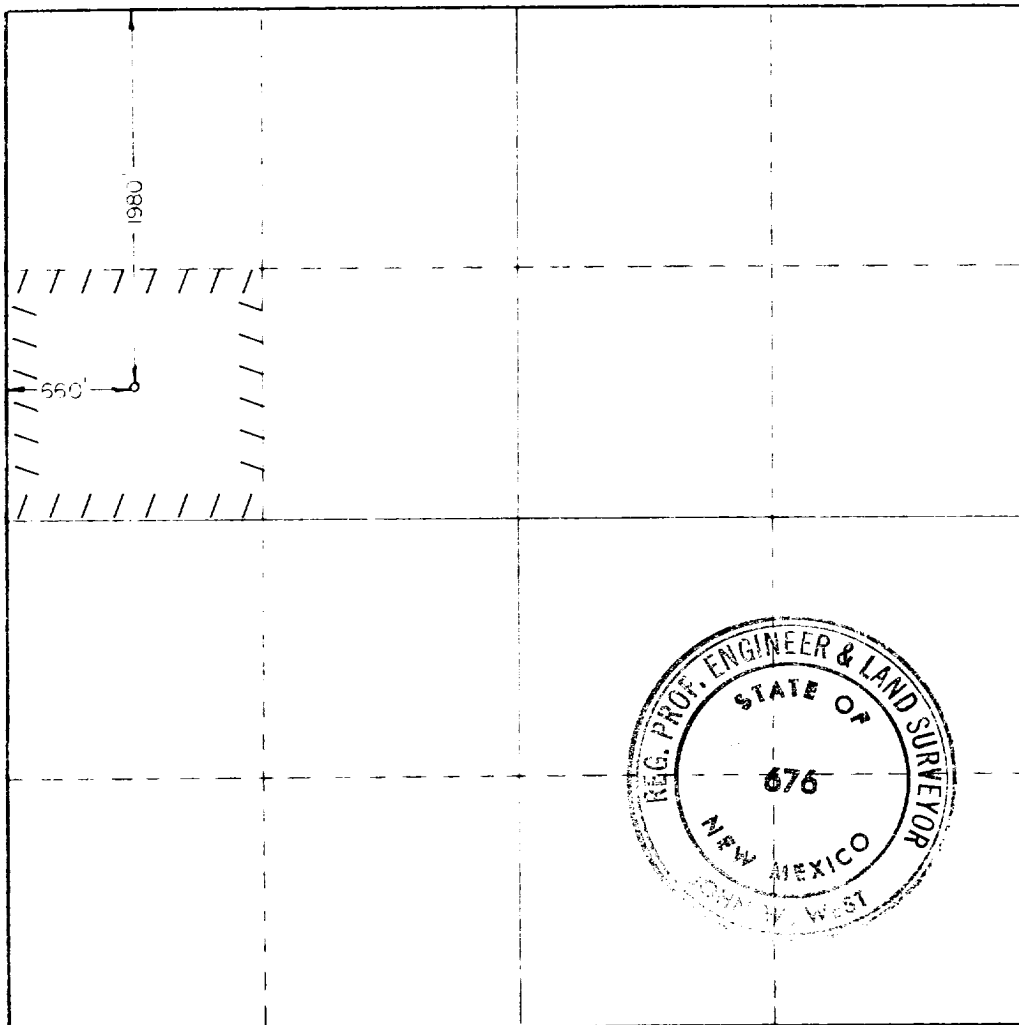

CERTIFICATION

I hereby certify that the information contained herein is true and complete to the best of my knowledge and belief.

R. E. Mathis

R. E. Mathis

Regulatory Coordinator

Mesa Petroleum Co.

8-5-83

I hereby certify that the well location shown on this plat was plotted from field notes of actual surveys made by me or under my supervision, and that the same is true and correct to the best of my knowledge and belief.

AUGUST 2, 1983

Registered Professional Engineer
and Land Surveyor

John W. West

Certificate No. **JOHN W. WEST, 676**
RONALD J. EIDSON, 3239

330 660 90 1320 1650 1980 2310 2640 2000 1500 1000 500

RECEIVED
AUG 8 1983
O.C.D.
HOBBS OFFICE