

NEW MEXICO CONSERVATION COMMISSION  
 WELL LOCATION AND ACREAGE DEDICATION PLAT

Form C-10,  
 Supersedes C-10  
 Effective 1981

All distances must be from the outer boundaries of the Section.

Gulf Oil Corp.			Lease		Lea TZ State	Acres
						3
Section	Range	Township	Range	County		
G	16	19 South	35 East	Lea		

1980		north		1980		east	
feet from the		line and		feet from the		line	
Well Elev.	Producing Formation	Pool	Producing Formation		Pool	Producing Formation	
3788.6'	Bone Springs	Scharh Bone Springs				80	

- Outline the acreage dedicated to the subject well by colored pencil or hatchure marks on the plat below.
- If more than one lease is dedicated to the well, outline each and identify the ownership thereof (both as to working interest and royalty).
- If more than one lease of different ownership is dedicated to the well, have the interests of all owners been consolidated by communitization, unitization, force-pooling, etc?

☐ Yes ☐ No If answer is "yes," type of consolidation \_\_\_\_\_

If answer is "no," list the owners and tract descriptions which have actually been consolidated. (Use reverse side of this form if necessary.) \_\_\_\_\_

No allowable will be assigned to the well until all interests have been consolidated (by communitization, unitization, forced-pooling, or otherwise) or until a non-standard unit, eliminating such interests, has been approved by the Commission.

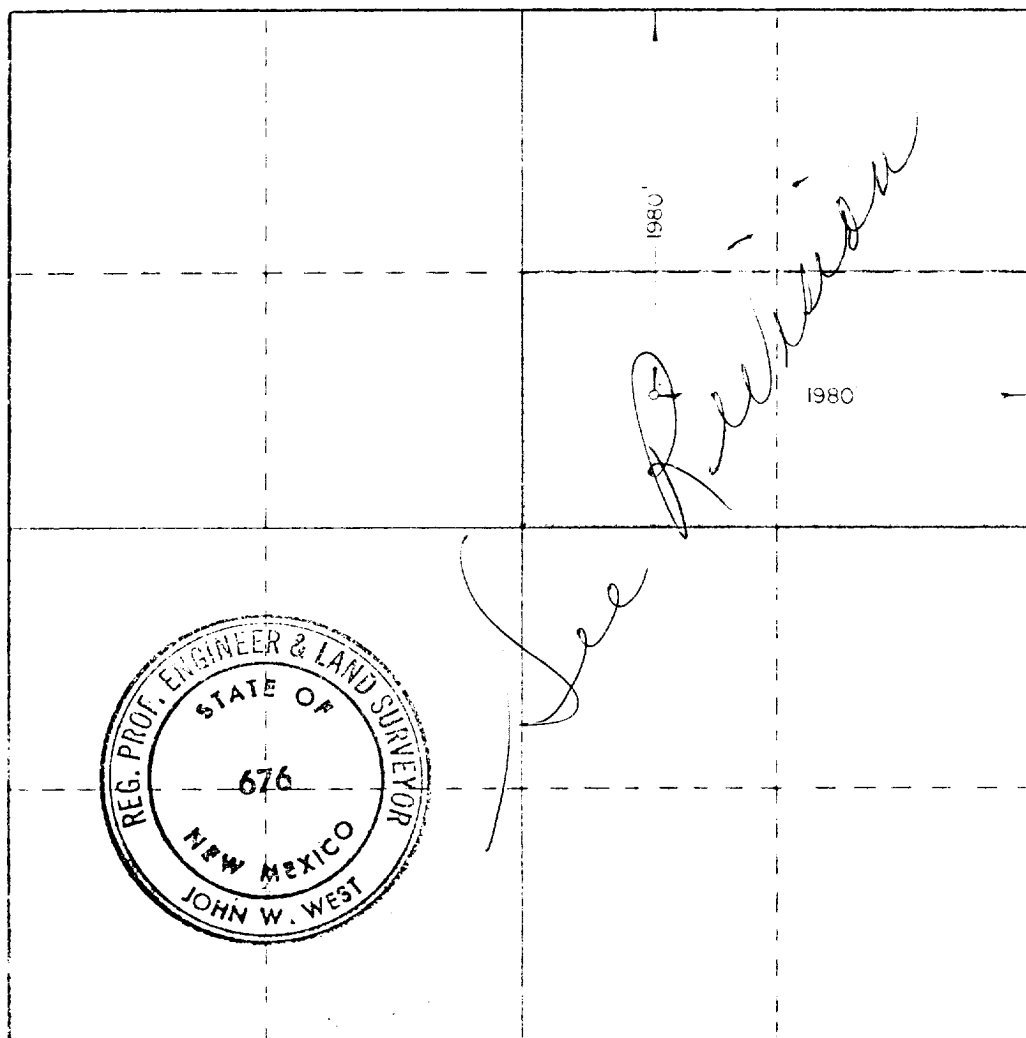

CERTIFICATION

I hereby certify that the information contained herein is true and complete to the best of my knowledge and belief.

*R. C. Anderson*

Name R.C. ANDERSON  
 Position AREA PRODUCTION MANAGER  
 Company GULF OIL CORPORATION  
 Date 8-17-83

I hereby certify that the well location shown on this plat was plotted from field notes of actual surveys made by me or under my supervision, and that the same is true and correct to the best of my knowledge and belief.

Date surveyed August 13, 1983  
 Registered Professional Engineer and/or Land Surveyor

*John W. West*  
 Certificate No. JOHN W. WEST, 676  
RONALD J. EIDSON, 5239

330 660 990 1320 1650 1980 2310 2640 2970 3300 3630 3960 4290 4620 4950 5280 5610 5940 6270 6600 6930 7260 7590 7920 8250 8580 8910 9240 9570 9900

113

RECEIVED  
AUG 18 1983  
O.C.D.  
HOBBS OFFICE