

STATE OF NEW MEXICO  
ENERGY AND MINERALS DEPARTMENT

OIL CONSERVATION DIVISION

P. O. BOX 2088

SANTA FE, NEW MEXICO 87501

30-025-28384

Form C-101  
Revised 10-1-78

NO. OF COPIES RECEIVED	
DISTRIBUTION	
SANTA FE	
FILE	
U.S.G.S.	
LAND OFFICE	
OPERATOR	

5A. Indicate Type of Lease  
STATE ☒ REC ☐  
5. State Oil & Gas Lease No.  
IC-6788

APPLICATION FOR PERMIT TO DRILL, DEEPEN, OR PLUG BACK

1a. Type of Work DRILL <input checked="" type="checkbox"/> DEEPEN <input type="checkbox"/> PLUG BACK <input type="checkbox"/>		7. Unit Agreement Name	
b. Type of Well OIL WELL <input checked="" type="checkbox"/> GAS WELL <input type="checkbox"/> OTHER <input type="checkbox"/> SINGLE ZONE <input type="checkbox"/> MULTIPLE ZONE <input type="checkbox"/>		8. Farm or Lease Name Pioneer State	
2. Name of Operator Great Western Drilling Company		9. Well No. 1	
3. Address of Operator P. O. Box 1659, Midland, Texas 79702		10. Field and Pool, or Wildcat Double "A" South	
4. Location of Well UNIT LETTER N LOCATED 660 FEET FROM THE South LINE AND 1930 FEET FROM THE West LINE OF SEC. 20 TWP. 17-S RGE. 36-E NMPM		12. County Lea	
19. Proposed Depth 9,500'		19A. Formation Abo	20. Rotary or C.T. Rotary
21. Elevations (Show whether DF, KT, etc.) G.L. 3870.3	21A. Kind & Status Plug. Bond Blanket	21B. Drilling Contractor Not Available	22. Approx. Date Work will start Sept. 30, 1983

23.

PROPOSED CASING AND CEMENT PROGRAM

SIZE OF HOLE	SIZE OF CASING	WEIGHT PER FOOT	SETTING DEPTH	SACKS OF CEMENT	EST. TOP
17 1/2"	13-3/8"	48	350'	375	Surface
11 "	8-5/8"	24 & 32	3,400'	900	Surface
7 7/8"	5-1/2"	15.5 & 17	9,500'	500	7,000'

Blowout Preventor: 3,000 psi Hydraulic double, 10" X 900 series with accumulator closing unit. Manifold 4" X 900 series flanged connections, 1-positive & 1-adjustable choke. One Hydril 10" X 900 series.

APPROVAL VALID FOR 10 DAYS  
PERMIT EXPIRES 31/12/83  
UNLESS DRILLING UNDERWAY

IN ABOVE SPACE DESCRIBE PROPOSED PROGRAM; IF PROPOSAL IS TO DEEPEN OR PLUG BACK, GIVE DATA ON PRESENT PRODUCTIVE ZONE AND PROPOSED NEW PRODUCTIVE ZONE. GIVE BLOWOUT PREVENTER PROGRAM, IF ANY.

I hereby certify that the information above is true and complete to the best of my knowledge and belief.

Signed M. H. Meyer Title Ass't to Gen. Supt. Date 9-9-83

(This space for State Use)

SEP 12 1983

APPROVED BY ORIGINAL SIGNED BY JERRY SEXTON TITLE DISTRICT SUPERVISOR DATE

CONDITIONS OF APPROVAL

**NEW MEXICO OIL CONSERVATION COMMISSION  
WELL LOCATION AND ACREAGE DEDICATION PLAT**

Form C-102  
Supersedes C-128  
Effective 1-1-85

All distances must be from the outer boundaries of the Section

Operator <b>GREAT WESTERN DRILLING COMPANY</b>			Lease <b>Pioneer-State</b>		Well No. <b>1</b>
Tract Letter <b>N</b>	Section <b>20</b>	Township <b>17 South</b>	Range <b>36 East</b>	County <b>Lea</b>	
Actual Footage Location of Well:					
<b>660</b> feet from the <b>south</b> line and		<b>1980</b> feet from the <b>west</b> line			
Ground Level Elev. <b>3870.8</b>	Producing Formation <b>ADO</b>	Pool <b>Double "A" South</b>	Dedicated Acreage: <b>40</b> Acres		

1. Outline the acreage dedicated to the subject well by colored pencil or hachure marks on the plat below.
2. If more than one lease is dedicated to the well, outline each and identify the ownership thereof (both as to working interest and royalty).
3. If more than one lease of different ownership is dedicated to the well, have the interests of all owners been consolidated by communitization, unitization, force-pooling, etc?

☐ Yes    ☐ No    If answer is "yes," type of consolidation \_\_\_\_\_

If answer is "no," list the owners and tract descriptions which have actually been consolidated. (Use reverse side of this form if necessary.) \_\_\_\_\_

No allowable will be assigned to the well until all interests have been consolidated (by communitization, unitization, forced-pooling, or otherwise) or until a non-standard unit, eliminating such interests, has been approved by the Commission.

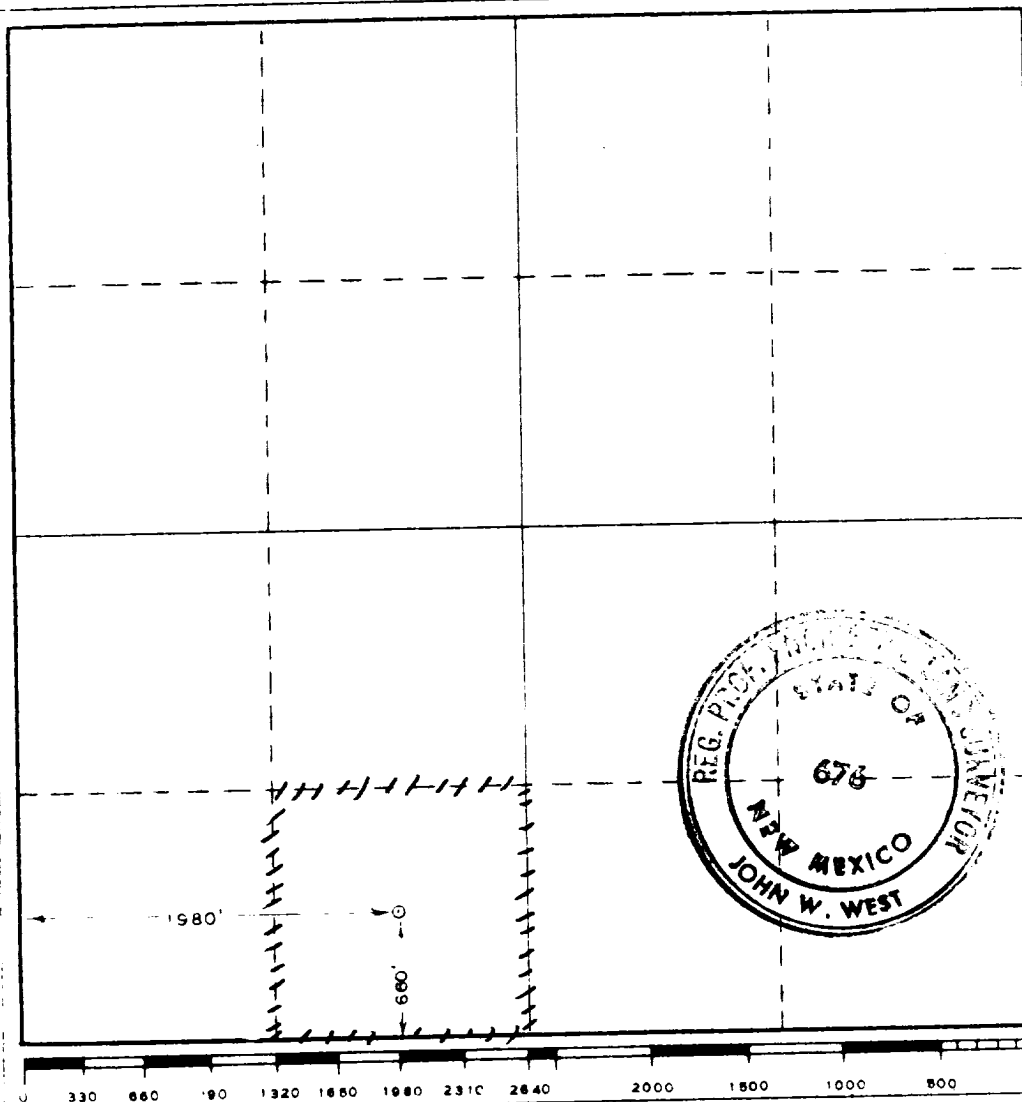

**CERTIFICATION**

I hereby certify that the information contained herein is true and complete to the best of my knowledge and belief.

*M. B. Myers*

Name

**M. B. Myers**

Position

**Asst. to Gen. Supt.**

Company

**Great Western Drilling Co.**

Date

**September 9, 1983**

I hereby certify that the well location shown on this plat was plotted from field notes of actual surveys made by me or under my supervision, and that the same is true and correct to the best of my knowledge and belief.

Date Surveyed

**Sept. 2, 1983**

Registered Professional Engineer and/or Land Surveyor

*John W. West*

Certificate No. **JOHN W. WEST, 676**  
**RONALD J. EIDSON, 3239**

177

RECEIVED  
SEP 12 1983  
O.C.D.  
HOBBS OFFICE