

# NEW MEXICO DEPARTMENT OF MINES WELL LOCATION AND ACREAGE DEDICATION PLAT

Form 1-77  
Supersedes 1-127  
Effective 1-1-77

All distances must be from the outer boundaries of the Section.

INEXCO OIL CO.

Lessee

LEA FARMS, INC.

Acres

1

*EH*

14

Township

17 SOUTH

Range

37 EAST

Section

LEA

1280

feet from the

EAST

line and

2340

feet from the

NORTH

line

Producing Form.

Producing Formation

Pool

S. HUMBLE CITY (STRAWN)

Dedicated Acreage

3732.0

STRAWN

80

Acres

1. Outline the acreage dedicated to the subject well by colored pencil or hatchure marks on the plat below.
2. If more than one lease is dedicated to the well, outline each and identify the ownership thereof (both as to working interest and royalty).
3. If more than one lease of different ownership is dedicated to the well, have the interests of all owners been consolidated by communitization, unitization, force-pooling, etc?

☒ Yes ☐ No If answer is "yes," type of consolidation FORCE-POOLING

If answer is "no," list the owners and tract descriptions which have actually been consolidated. (Use reverse side of this form if necessary.)

No allowable will be assigned to the well until all interests have been consolidated (by communitization, unitization, forced-pooling, or otherwise) or until a non-standard unit, eliminating such interests, has been approved by the Commission.

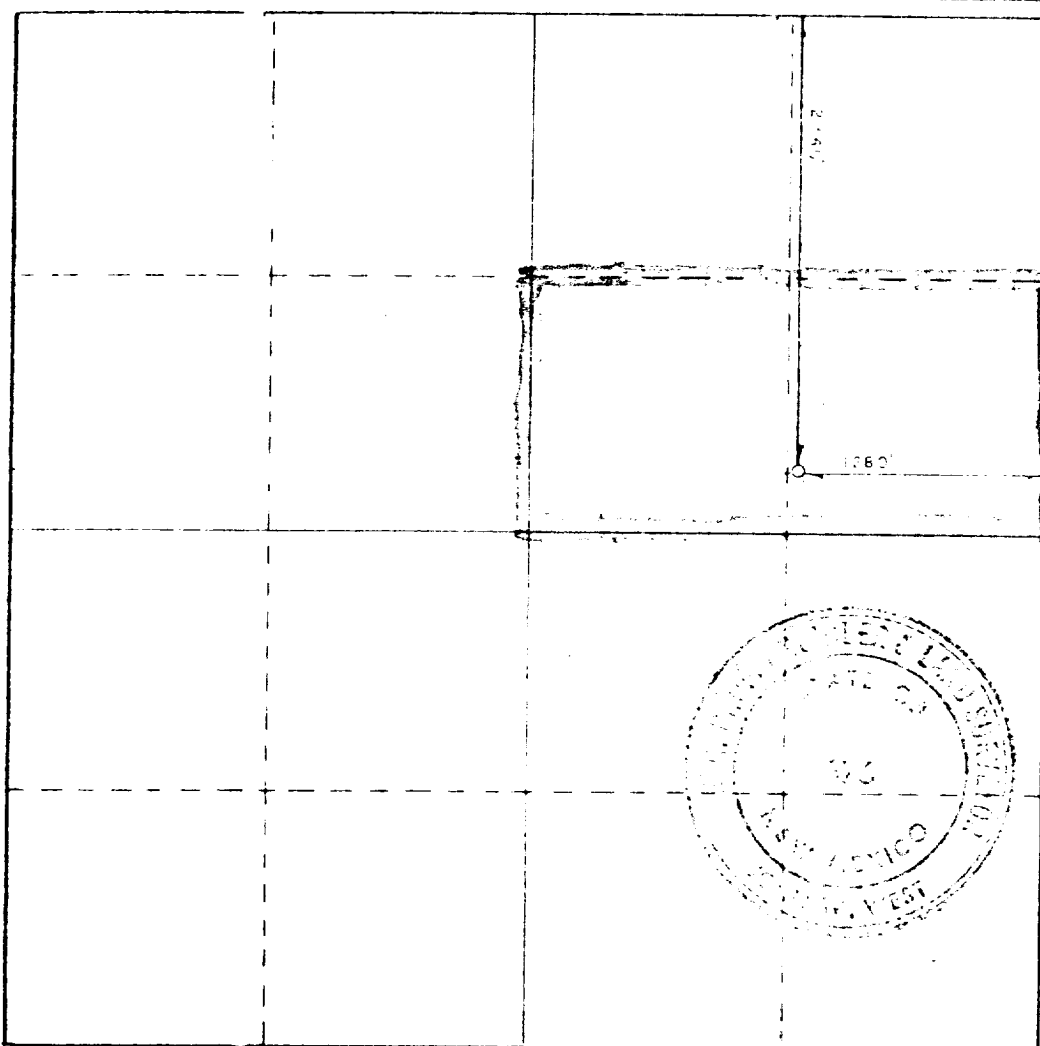

## CERTIFICATION

I hereby certify that the information contained herein is true and complete to the best of my knowledge and belief.

*Alan G. McKnight*

ALAN G. MCKNIGHT

Production Clerk

PRODUCTION CLERK

Company

INEXCO OIL COMPANY

Date

OCTOBER 31, 1983

I hereby certify that the well location shown on this plat was plotted from field notes of actual surveys made by me or under my supervision, and that the same is true and correct to the best of my knowledge and belief.

Date Surveyed

OCTOBER 21, 1983

Registered Professional Engineer and Land Surveyor

*John W. West*

Certificate No. JOHN W. WEST,

676

RONALD J. EIDSON,

3239

330 660 990 1320 1650 1980 2310 2640 2000 1500 1000 500 0

RECEIVED  
NOV 16 1983  
O.C.D.  
HOBBS OFFICE  
NOV 7 1983  
O.C.D.  
HOBBS OFFICE