

NO. OF COPIES RECEIVED		
DISTRIBUTION		
SANTA FE		
FILE		
U.S.G.S.		
LAND OFFICE		
OPERATOR		

G.I.L CONSERVATION DIVISION
P. O. BOX 2088
SANTA FE, NEW MEXICO 87501

Form C-103
Revised 10-1-78

5a. Indicate Type of Lease	
State <input checked="" type="checkbox"/>	Fee <input type="checkbox"/>
5. State Oil & Gas Lease No.	
B-1520-1	

SUNDRY NOTICES AND REPORTS ON WELLS
(DO NOT USE THIS FORM FOR PROPOSALS TO DRILL OR TO DEEPEN OR PLUG BACK TO A DIFFERENT RESERVOIR.
USE "APPLICATION FOR PERMIT" (FORM C-101) FOR SUCH PROPOSALS.)

1. <input checked="" type="checkbox"/> OIL WELL <input type="checkbox"/> GAS WELL <input type="checkbox"/> OTHER-		7. Unit Agreement Name
2. Name of Operator		8. Farm or Lease Name
3. Address of Operator		9. Well No.
4. Location of Well		10. Field and Pool, or Wildcat
UNIT LETTER <u>K</u> <u>1882</u> FEET FROM THE <u>South</u> LINE AND <u>2001</u> FEET FROM		Vacuum Abo, North
THE <u>West</u> LINE, SECTION <u>26</u> TOWNSHIP <u>17S</u> RANGE <u>34E</u> N.M.P.M.		
15. Elevation (Show whether DF, RT, GR, etc.)		12. County
4025 GR		Lea

16. Check Appropriate Box To Indicate Nature of Notice, Report or Other Data
NOTICE OF INTENTION TO:

PERFORM REMEDIAL WORK <input type="checkbox"/>	PLUG AND ABANDON <input type="checkbox"/>
TEMPORARILY ABANDON <input type="checkbox"/>	CHANGE PLANS <input type="checkbox"/>
PULL OR ALTER CASING <input type="checkbox"/>	OTHER <input type="checkbox"/>

SUBSEQUENT REPORT OF:

REMEDIAL WORK <input type="checkbox"/>	ALTERING CASING <input type="checkbox"/>
COMMENCE DRILLING OPNS. <input type="checkbox"/>	PLUG AND ABANDONMENT <input type="checkbox"/>
CASING TEST AND CEMENT JOBS <input checked="" type="checkbox"/>	
OTHER <input type="checkbox"/>	
NEW WELL	

17. Describe Proposed or Completed Operations (Clearly state all pertinent details, and give pertinent dates, including estimated date of starting any proposed work) SEE RULE 1103.

06/02/84 WIH w/ 5-1/2 BOT FS, 1 jt 5-1/2 17# K55 ST&C, HOWCO FC @ 8652, BOT LC @ 8651
17 jts 17#K55 ST&C = 740, 15 centz, 82 jts 5-1/2 15.50# K55 ST&C = 3702',
8-5/8x5-1/2 MOD "C" BOT LH w/6' tieback sleeve, top of 5-1/2 liner @ 4197
on 4-1/2 DP to 8700, circ gas out 1 hr, HOWCO cmtd liner @ 8699, 1' off btm
w/750x Class H cmt .4% gel .3% Halad 9 1/4# FC/x, tail-in w/300x Class H cmt,
.3% Halad 9 1/4# FC/x, PD @ 7:15 PM 6/2/84, POH w/liner setting tool, WIH
w/ 7-7/8 Smith tooth type RR bit, 24 - 6-1/2 cols on 4-1/2 DP, drl hard cmt
3600 to top of 5-1/2 liner @ 4197, press test 8-5/8 csg & 5-1/2 liner top
1000 psi/30 min/held ok.

6/10/84 Press test 8-5/8 csg & 5-1/2 liner to 1000 psi/30 min/held ok.

18. I hereby certify that the information above is true and complete to the best of my knowledge and belief.

SIGNED Paula W. Collins TITLE Authorized Agent DATE 06/12/84

ORIGINAL SIGNED BY JERRY SEXTON
DISTRICT I SUPERVISOR

APPROVED BY _____ TITLE _____ DATE JUN 18 1984

CONDITIONS OF APPROVAL, IF ANY:

NO. OF COPIES RECEIVED	
DISTRIBUTION	
SANTA FE	
FILE	
U.S.G.S.	
LAND OFFICE	
OPERATOR	

OIL CONSERVATION DIVISION
P. O. BOX 2088
SANTA FE, NEW MEXICO 87501

Form C-103
Revised 10-1-78

5a. Indicate Type of Lease	
State <input checked="" type="checkbox"/>	Fee <input type="checkbox"/>
5. State Oil & Gas Lease No.	
B-1520-1	

SUNDRY NOTICES AND REPORTS ON WELLS
(DO NOT USE THIS FORM FOR PROPOSALS TO DRILL OR TO DEEPEN OR PLUG BACK TO A DIFFERENT RESERVOIR.
USE "APPLICATION FOR PERMIT -" (FORM C-101) FOR SUCH PROPOSALS.)

1. OIL WELL <input checked="" type="checkbox"/> GAS WELL <input type="checkbox"/> OTHER <input type="checkbox"/>	7. Unit Agreement Name
2. Name of Operator	North Vacuum Abo Unit
3. Address of Operator	8. Farm or Lease Name
Mobil Producing TX. & N.M. Inc.	
9. Well No.	
Nine Greenway Plaza, Suite 2700, Houston, Texas 77046	241
4. Location of Well	10. Field and Pool, or Wildcat
UNIT LETTER <u>K</u> , <u>1882</u> FEET FROM THE <u>South</u> LINE AND <u>2001</u> FEET FROM	Vacuum Abo, North
THE <u>West</u> LINE, SECTION <u>26</u> TOWNSHIP <u>17S</u> RANGE <u>34E</u> NMPM.	
15. Elevation (Show whether DF, RT, GR, etc.)	12. County
4025 GR	Lea

Check Appropriate Box To Indicate Nature of Notice, Report or Other Data
NOTICE OF INTENTION TO:

PERFORM REMEDIAL WORK <input type="checkbox"/>	PLUG AND ABANDON <input type="checkbox"/>
TEMPORARILY ABANDON <input type="checkbox"/>	CHANGE PLANS <input type="checkbox"/>
PULL OR ALTER CASING <input type="checkbox"/>	OTHER <input type="checkbox"/>

SUBSEQUENT REPORT OF:

REMEDIAL WORK <input type="checkbox"/>	ALTERING CASING <input type="checkbox"/>
COMMENCE DRILLING OPNS. <input type="checkbox"/>	PLUG AND ABANDONMENT <input type="checkbox"/>
CASING TEST AND CEMENT JOB <input checked="" type="checkbox"/>	
OTHER <input type="checkbox"/>	
NEW WELL	

17. Describe Proposed or Completed Operations (Clearly state all pertinent details, and give pertinent dates, including estimated date of starting any proposed work) SEE RULE 1109.

05/21/84 Fin GIH w/bit & on btm @ 8:30 AM, 25-1/4 hrs day work for logging, circ 2 hrs, POH, ran HOWCO type M notched shoe, 1 jt 8-5/8 32# S80 ST&C = 46' FC @ 4952, 12 jts 8-5/8 32# S80 ST&C = 497', 103 jts 8-5/8 32# K55 ST&C = 4457', ran 6 centl, circ 1 hr, HOWCO cmt csg on btm @ 5000 w/3000x Class C + 4% gel + 15# salt/x + 5# gilsonite/x + 1/4# FC/x + 300x Class C + 2% CaCl2 + 1/4# FC/x, PD @ 11:45 PM, cmt circ 250x, estm 86% hole washout, WOC & NU past 7-1/4 hrs.

05/22/84 Press test 8-5/8 csg & BOP w/1500 psi/30 min/held ok, drlg new form @ 3 PM, WOC total 15-1/4 hrs.

18. I hereby certify that the information above is true and complete to the best of my knowledge and belief.

SIGNED Paula W. Collins TITLE Authorized Agent DATE 05/30/84

ORIGINAL SIGNED BY JERRY SEXTON
DISTRICT SUPERVISOR

APPROVED BY _____ TITLE _____ DATE JUN 4 1984

CONDITIONS OF APPROVAL, IF ANY:

STATE OF NEW MEXICO
ENERGY AND MINERALS DEPARTMENT

NO. OF COPIES RECEIVED	
DISTRIBUTION	
SANTA FE	
FILE	
U.S.G.S.	
LAND OFFICE	
OPERATOR	

OIL CONSERVATION DIVISION
P. O. BOX 2088
SANTA FE, NEW MEXICO 87501

Form C-103
Revised 10-1-78

5a. Indicate Type of Lease	
State <input checked="" type="checkbox"/>	Fee <input type="checkbox"/>
5. State Oil & Gas Lease No.	
B-1520-1	

SUNDRY NOTICES AND REPORTS ON WELLS

(DO NOT USE THIS FORM FOR PROPOSALS TO DRILL OR TO DEEPEN OR PLUG BACK TO A DIFFERENT RESERVOIR.
USE "APPLICATION FOR PERMIT -" (FORM C-101) FOR SUCH PROPOSALS.)

1. <input checked="" type="checkbox"/> OIL WELL <input type="checkbox"/> GAS WELL <input type="checkbox"/> OTHER-	7. Unit Agreement Name
2. Name of Operator	North Vacuum Abo Unit
3. Address of Operator	8. Farm or Lease Name
Nine Greenway Plaza, Suite 2700, Houston, Texas 77046	
4. Location of Well	9. Well No.
UNIT LETTER <u>K</u> <u>1882</u> FEET FROM THE <u>South</u> LINE AND <u>2001</u> FEET FROM	241
THE <u>West</u> LINE, SECTION <u>26</u> TOWNSHIP <u>17S</u> RANGE <u>34E</u> NMPM.	10. Field and Pool, or Wildcat
	Vacuum Abo, North
15. Elevation (Show whether DF, RT, GR, etc.)	12. County
4025 GR	Lea

16. Check Appropriate Box To Indicate Nature of Notice, Report or Other Data

NOTICE OF INTENTION TO:

PERFORM REMEDIAL WORK ☐
TEMPORARILY ABANDON ☐
PULL OR ALTER CASING ☐
OTHER ☐

PLUG AND ABANDON ☐
CHANGE PLANS ☐

SUBSEQUENT REPORT OF:

REMEDIAL WORK ☐
COMMENCE DRILLING OPNS. ☒
CASING TEST AND CEMENT JOB ☒
OTHER ☐
NEW WELL ☐

17. Describe Proposed or Completed Operations (Clearly state all pertinent details, and give pertinent dates, including estimated date of starting any proposed work) SEE RULE 1108.

05/05/84 Moranco Drlg Co Rig #9 spud 17-1/2 hole @ 8:30 AM, fin 17-1/2 hole @ 400' @ 12:15 PM, circ 1/2 hr, POH ran 10 jts 13-3/8 48# H40 ST&C csg w/6 cent1 to 400, HOWCO cmt csg on btm @ 400 w/400x Class C + 2% CaCl2 + 1/4# FC/x, PD @ 4:30 PM, cmt circ 70x, estm 24% hole washout, WOC 6 hrs & now NU BOPs.
05/06/84 WOC total of 25 hrs, test 13-3/8 csg & BOP to 1000 psi for 30 min/held ok, drlg new form @ 5:30 PM.

18. I hereby certify that the information above is true and complete to the best of my knowledge and belief.

SIGNED Paula A. Collins

TITLE Authorized Agent

DATE 05/15/84

MAY 21 1984

APPROVED BY ORIGINAL SIGNED BY JERRY SEXTON
DISTRICT SUPERVISOR
CONDITIONS OF APPROVAL, IF ANY:

TITLE

DATE

30-025-28601

NO. OF COPIES RECEIVED	
DISTRIBUTION	
SANTA FE	
FILE	
U.S.G.S.	
LAND OFFICE	
OPERATOR	

NEW MEXICO OIL CONSERVATION COMMISSION

Form C-101
Revised 1-1-65

5A. Indicate Type of Lease STATE <input checked="" type="checkbox"/> FEE <input type="checkbox"/>
5. State Oil & Gas Lease No. B-1520-1

APPLICATION FOR PERMIT TO DRILL, DEEPEN, OR PLUG BACK

1a. Type of Work DRILL <input checked="" type="checkbox"/> DEEPEN <input type="checkbox"/> PLUG BACK <input type="checkbox"/>		7. Unit Agreement Name North Vacuum Abo Unit
b. Type of Well OIL WELL <input checked="" type="checkbox"/> GAS WELL <input type="checkbox"/> OTHER <input type="checkbox"/> SINGLE ZONE <input checked="" type="checkbox"/> MULTIPLE ZONE <input type="checkbox"/>		8. Farm or Lease Name
2. Name of Operator Mobil Producing TX. & N.M. Inc.		9. Well No. 241
3. Address of Operator 9 Greenway Plaza, Suite 2700, Houston, Texas 77046		10. Field and Pool, or Wildcat North Vacuum Abo
4. Location of Well UNIT LETTER K LOCATED 1882 FEET FROM THE South LINE AND 2001 FEET FROM THE West LINE OF SEC. 26 TWP. 17S RGE. 34E NMPM		12. County Lea
19. Proposed Depth 8700'		19A. Formation Abo
20. Rotary or C.T. Rotary		
21. Elevations (Show whether DF, RT, etc.) 4025' GL	21A. Kind & Status Plug. Bond On File	21B. Drilling Contractor Unknown
22. Approx. Date Work will start As soon as possible		

PROPOSED CASING AND CEMENT PROGRAM

SIZE OF HOLE	SIZE OF CASING	WEIGHT PER FOOT	SETTING DEPTH	SACKS OF CEMENT	EST. TOP
17-1/2"	13-3/8"	48.0# H-40	0-400'	Circulate	Surface
12-1/2"	8-5/8"	28.0# S-80	0-5000'	Circulate	Surface
7-7/8"	5-1/2"	15.5# K-55	4800'-7300'	Circulate	Surface
		17.0# N-80	7300'-TD		

BLOWOUT PREVENTOR PROGRAM

Casing String	Equipment Size & API Series	No. & Type	Test Pressure PSI
Surface	13-5/8" x 3000#	1 MG & 1 PR	3000
		1 MG 2 PR & Rotary Head	5000

IN ABOVE SPACE DESCRIBE PROPOSED PROGRAM: IF PROPOSAL IS TO DEEPEN OR PLUG BACK, GIVE DATA ON PRESENT PRODUCTIVE ZONE AND PROPOSED NEW PRODUCTIVE ZONE, GIVE BLOWOUT PREVENTER PROGRAM, IF ANY.

I hereby certify that the information above is true and complete to the best of my knowledge and belief.

Signed A. D. BOND A. D. BOND Title Regulatory Technician Supervisor Date 1/26/84

(This space for State Use)

ORIGINAL SIGNED BY JERRY SEXTON

APPROVED BY DISTRICT 1 SUPERVISOR TITLE _____ DATE _____

CONDITIONS OF APPROVAL, IF ANY:

FEB 6 1984

APPROVAL VALID FOR 180 DAYS
PERMIT EXPIRES 8/6/84
UNLESS DRILLING UNDERWAY

OIL CONSERVATION DIVISION

STATE OF NEW MEXICO
ENERGY AND MINERALS DEPARTMENTP. O. BOX 2088
SANTA FE, NEW MEXICO 87501Form C-102
Revised 10-1-78

All distances must be from the outer boundaries of the Section.

Operator MOBIL PRODUCING TX. & N.M. INC.		Lease NORTH VACUUM ABO UNIT		Well No. 241
Unit Letter K	Section 26	Township 17S	Range 34E	County Lea
Actual Footage Location of Well: 1882 feet from the South line and 2001 feet from the West line				
Ground Level Elev. 4025'	Producing Formation Abo	Pool Vacuum, North-Abo		Dedicated Acreage: (2 wells) 80 Acres

1. Outline the acreage dedicated to the subject well by colored pencil or hachure marks on the plat below.
2. If more than one lease is dedicated to the well, outline each and identify the ownership thereof (both as to working interest and royalty).
3. If more than one lease of different ownership is dedicated to the well, have the interests of all owners been consolidated by communitization, unitization, force-pooling, etc?

☐ Yes ☐ No If answer is "yes," type of consolidation unitized

If answer is "no," list the owners and tract descriptions which have actually been consolidated. (Use reverse side of this form if necessary.) _____

No allowable will be assigned to the well until all interests have been consolidated (by communitization, unitization, forced-pooling, or otherwise) or until a non-standard unit, eliminating such interests, has been approved by the Division.

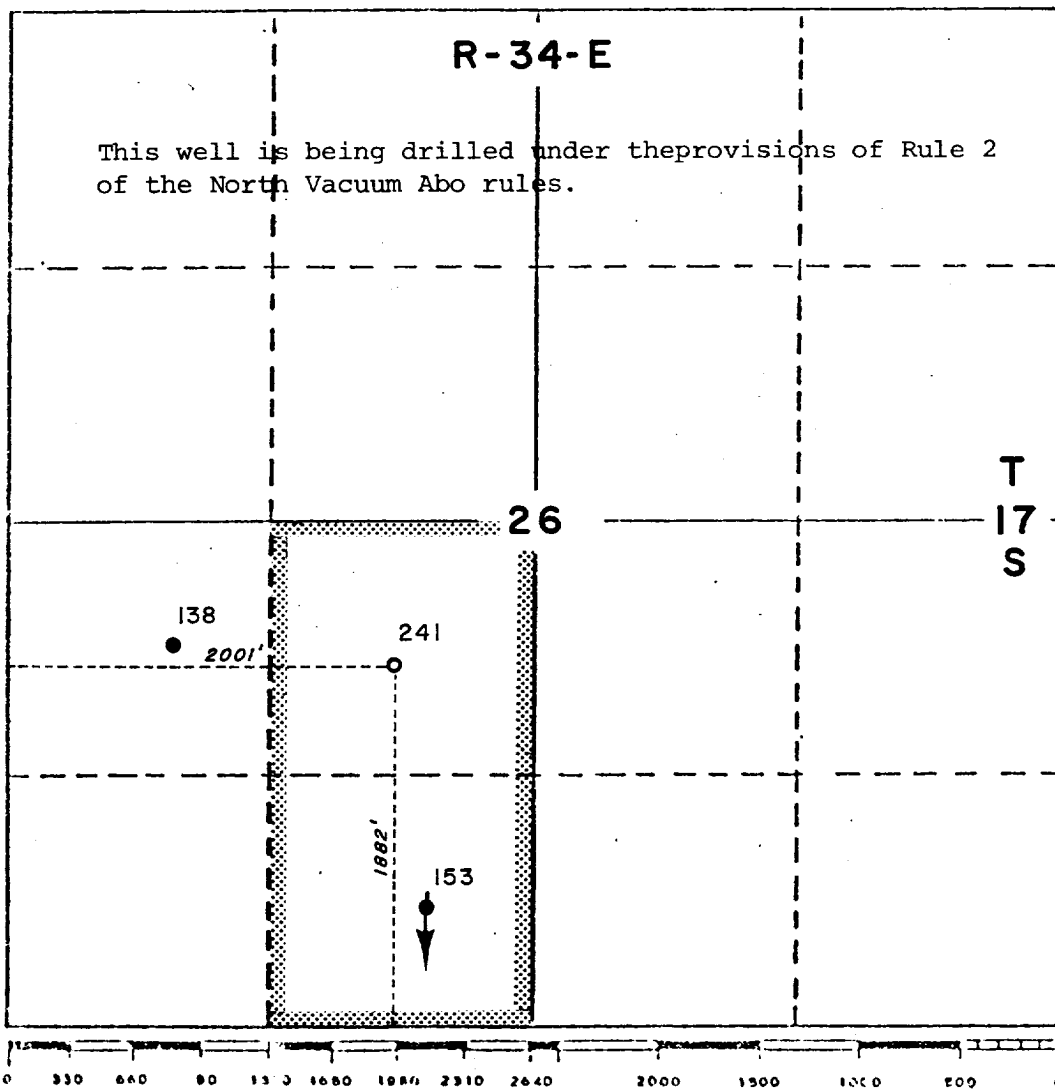

CERTIFICATION

I hereby certify that the information contained herein is true and complete to the best of my knowledge and belief.

Name

A. D. BOND

Position Regulatory
Technician SupervisorCompany Mobil Producing
TX & N.M. INC.

Date

1/26/84

I hereby certify that the well location shown on this plat was plotted from field notes of actual surveys made by me or under my supervision, and that the same is true and correct to the best of my knowledge and belief.

Date Surveyed

1-12-84

Registered Professional Engineer
and/or Land Surveyor

H. A. CARSON, MR.

Certificate No.

5063