

NO. OF COPIES RECEIVED	
DISTRIBUTION	
SANTA FE	
FILE	
U.S.G.S.	
LAND OFFICE	
OPERATOR	

NEW MEXICO OIL CONSERVATION COMMISSION

Form C-101
Revised 1-1-65

5A. Indicate Type of Lease STATE <input checked="" type="checkbox"/> FEE <input type="checkbox"/>
5. State Oil & Gas Lease No. B-1520-1

APPLICATION FOR PERMIT TO DRILL, DEEPEN, OR PLUG BACK

1a. Type of Work b. Type of Well OIL WELL <input checked="" type="checkbox"/> GAS WELL <input type="checkbox"/> OTHER <input type="checkbox"/> SINGLE ZONE <input checked="" type="checkbox"/> MULTIPLE ZONE <input type="checkbox"/>		DRILL <input checked="" type="checkbox"/> DEEPEN <input type="checkbox"/> PLUG BACK <input type="checkbox"/>	
2. Name of Operator Mobil Producing TX. & N.M. Inc.		7. Unit Agreement Name NORTH VACUUM ABO UNIT	
3. Address of Operator 9 Greenway Plaza, Suite 2700, Houston, TX 77046		8. Farm or Lease Name	
4. Location of Well UNIT LETTER <u>G</u> LOCATED <u>1809</u> FEET FROM THE <u>North</u> LINE AND <u>1890</u> FEET FROM THE <u>East</u> LINE OF SEC. <u>26</u> TWP. <u>17S</u> RGE. <u>34E</u> NMPM		9. Well No. 242	
		10. Field and Pool, or Wildcat North Vacuum Abo	
		12. County Lea	
		19. Proposed Depth 8700'	
		19A. Formation Abo	
		20. Rotary or C.T. Rotary	
21. Elevations (Show whether DF, RT, etc.) 4019' GL		21A. Kind & Status Plug. Bond On File	
		21B. Drilling Contractor Unknown	
		22. Approx. Date Work will start As soon as possible	

PROPOSED CASING AND CEMENT PROGRAM

SIZE OF HOLE	SIZE OF CASING	WEIGHT PER FOOT	SETTING DEPTH	SACKS OF CEMENT	EST. TOP
17½"	13-3/8"	48.0# H-40	0-400'	Circulate	Surface
12-¼"	8-5/8"	28.0# S-80	0-5000'	Circulate	Surface
7-7/8"	5-½"	15.5# K-55	4800'-7300'	Circulate	Surface
		17.0# N-80	7300'-TD		

BLOWOUT PREVENTOR PROGRAM

Casing String	Equipment Size & API Series	No. & Type	Test Pressure PSI
Surface	13-5/8" x 3000#	1 MG & 1 PR	3000
		1 MG 2 PR & Rotary Head	5000

IN ABOVE SPACE DESCRIBE PROPOSED PROGRAM: IF PROPOSAL IS TO DEEPEN OR PLUG BACK, GIVE DATA ON PRESENT PRODUCTIVE ZONE AND PROPOSED NEW PRODUCTIVE ZONE. GIVE BLOWOUT PREVENTOR PROGRAM, IF ANY.

I hereby certify that the information above is true and complete to the best of my knowledge and belief.

Signed A.D. Bond A. D. BOND Title Regulatory Technician Supervisor Date 1/26/84

(This space for State Use)

ORIGINAL SIGNED BY JERRY SEXTON

APPROVED BY DISTRICT 1 SUPERVISOR TITLE

CONDITIONS OF APPROVAL, IF ANY:

FEB 6 1984

APPROVAL VALID FOR 180 DAYS
PERMIT EXPIRES 8/6/84
UNLESS DRILLING UNDERWAY

All distances must be from the outer boundaries of the Section.

Operator MOBIL PRODUCING TX. & N.M. INC.			Lease NORTH VACUUM ABO UNIT			Well No. 242
Unit Letter G	Section 26	Township 17S	Range 34E	County Lea		
Actual Postage Location of Well: 1809 feet from the North line and 1890 feet from the East line						
Ground Level Elev. 4019	Producing Formation Abo		Pool Vacuum, North-Abo		Dedicated Acreage: (2 wells) 80 Acres	

1. Outline the acreage dedicated to the subject well by colored pencil or hachure marks on the plat below.
2. If more than one lease is dedicated to the well, outline each and identify the ownership thereof (both as to working interest and royalty).
3. If more than one lease of different ownership is dedicated to the well, have the interests of all owners been consolidated by communitization, unitization, force-pooling, etc?

☒ Yes ☐ No If answer is "yes," type of consolidation unitized

If answer is "no," list the owners and tract descriptions which have actually been consolidated. (Use reverse side of this form if necessary.)

No allowable will be assigned to the well until all interests have been consolidated (by communitization, unitization, forced-pooling, or otherwise) or until a non-standard unit, eliminating such interests, has been approved by the Division.

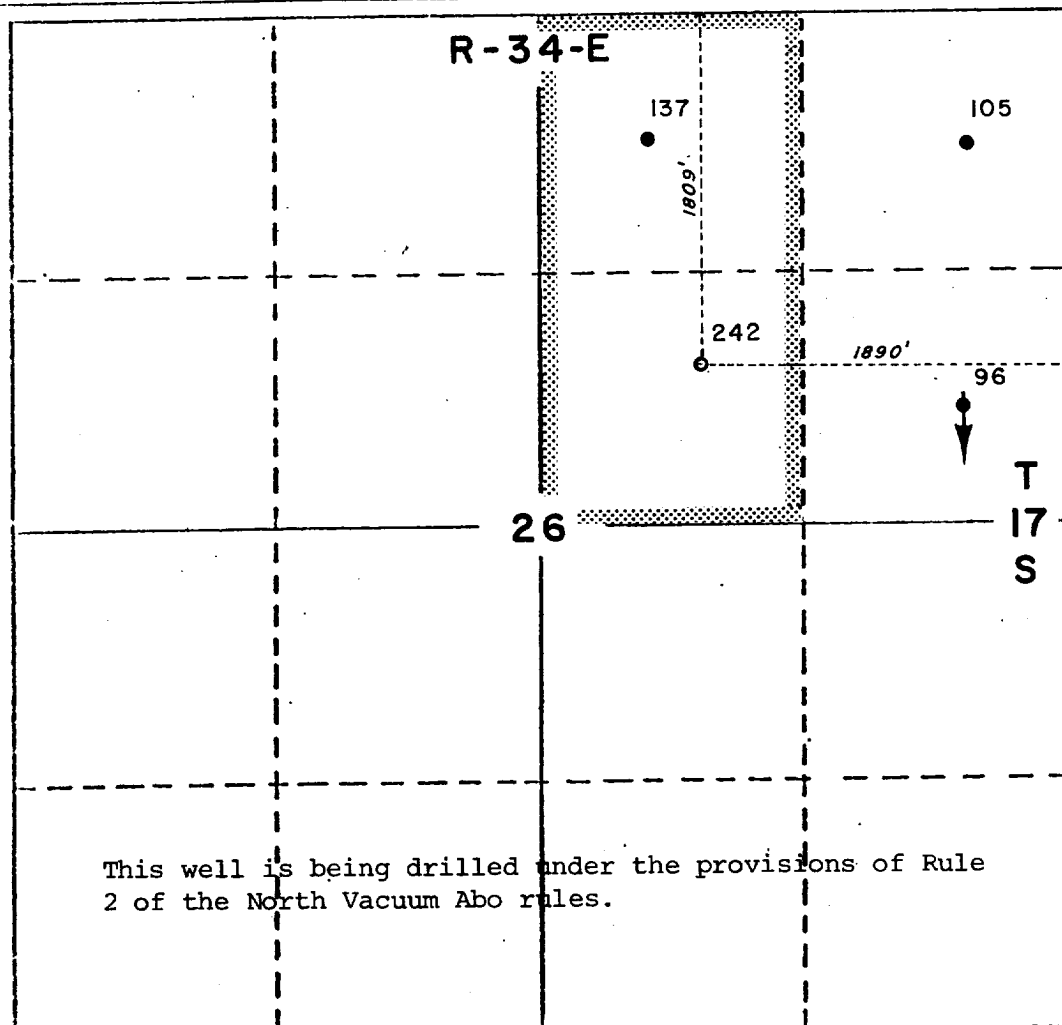

This well is being drilled under the provisions of Rule 2 of the North Vacuum Abo rules.

CERTIFICATION

I hereby certify that the information contained herein is true and complete to the best of my knowledge and belief.

Name

A. D. Bond

A. D. BOND

Position Regulatory

Technician Supervisor

Company Mobil Producing
TX. & N.M. Inc.

Date

1/26/84

I hereby certify that the well location shown on this plat was plotted from field notes of actual surveys made by me or under my supervision, and that the same is true and correct to the best of my knowledge and belief.

Date Surveyed

H. A. Carson, Jr.
1-12-84

Registered Professional Engineer
and/or Land Surveyor

H. A. CARSON, JR.

Certificate No.

5063

